



NOTICE

Ref No: ZOBH/GAD-PREM/TN-138/2018-19

DATE: 25.02.2019

UCO Bank, Zonal Office, Bhagalpur desires to invite sealed offers from reputed Contractor for **execution interior furnishing and electrical work in Makduma Branch as per Bank's specification under supervision of our empanelled architect in TWO PART SYSTEM, PART- I (Pre-Qualification Documents) & PART- II (Bid Documents)** to be submitted to **Zonal Manager, UCO Bank, Zonal Office, Bhagalpur** in two separate envelopes. The eligible and interested contractor may collect the "**Document for Tender**" from the following **Zonal Office, Bhagalpur** by paying non-refundable fee of **Rs. 1000.00** by way of **Cash/Demand Draft payable to ZONAL OFFICE, BHAGALPUR**. The document can also be downloaded from our website. The document submitted without the prescribed fee will be summarily rejected. The duly completed document in the prescribed format with all supporting documents shall be sealed in a cover and super scribed as 'Application for TENDER of (Category name)', (Branch name) and **the same be submitted to ZONAL OFFICE, BHAGALPUR**.

Tender document may be obtained/downloaded from 26.02.2019 to 08.03.2019 from Zonal Office & Bank website (www.ucobank.com)

Date & Place of Submission of Tender: Upto 3.00 PM on 11.03.2019 at the office of the Zonal Manager, UCO Bank Zonal Office, S K TARAFDAR ROAD, ADAMPUR, BHAGALPUR.

Tender will be addressed to: Zonal Manager, UCO Bank Zonal Office, S K TARAFDAR ROAD, ADAMPUR, BHAGALPUR.

Date, Time & Place of opening of Tender : 11.03.2019 at 3.30 PM in Zonal Office, Bhagalpur

UCO BANK reserves its right to reject any / or all the applications without assigning any reasons whatsoever.

-sd/-

**Zonal Manager
Zonal Office, Bhagalpur**



NOTICE OF INVITATION TO TENDER

Sealed tenders on item/rate over estimated cost basis are invited from competent Interior Furnishing, Electrical & Data Cabling contractors having sound technical and financial capacity for Furnishing, Electrical & Data Cabling works of UCO BANK, Makduma BRANCH, BHAGALPUR, and BIHAR.

Parties who have not executed one or two work of similar nature, each costing not less than 75% of the estimated cost satisfactorily during last two or three year & does not have any office/site or presence in the Bihar state need not respond. Contractor must have valid license for Electric work and copy must be attached herewith for reference.

Tender will be submitted in two parts in two separate envelopes

First Part: Application format duly filled by Contractor, Signed Tender Form with EMD amount and Tender Fees.

Second Part: Financial Bid.

Tender collection: - Tender document may be obtained from 26.02.2019 to 08.03.2019 at 10:30 AM to 05:00 PM from following address-

**UCO BANK
ZONAL OFFICE
S K Tarafdar Road, Koyalaghat, Adampur Chowk
Bhagalpur, Bihar**

Tender fee: - 1000.00

Estimated cost of project: - **Rs. 5,50,350.00**

Time of completion: - 25 Days

Earnest Money: - **Rs 11000.00** By crossed demand draft/ Banker's cheque drawn in favour of
ZONAL MANAGER UCO BANK payable at Bhagalpur.

Time and date of

Submission of tender: - Up to 3:00 P.M. on 11.03.2019

**UCO BANK ZONAL OFFICE
S K Tarafdar Road, Koyalaghat,
Adampur Chowk, Bhagalpur.**

Time and date of Opening of tender: at

**UCO BANK, ZONAL OFFICE
S K Tarafdar Road, Koyalaghat,
Adampur Chowk, Bhagalpur**

11.03.2019 at 04.00 PM

Note: Tender may be downloaded from UCO Bank website: www.ucobank.com

The bank will not be bound to accept the lowest tender and reserves the right to accept or reject any or all the tenders without any reason what so ever.

-sd/-

ZONAL MANAGER

ZONAL OFFICE S K Tarafdar Road, Koyalaghat, Adampur Chowk, Bhagalpur



GENERAL RULES AND INSTRUCTION FOR GUIDANCE OF TENDERERS

- (1) Tenders are hereby invited on behalf of **UCO BANK, Bhaglpur ZONE** for Interior Furnishing, Electrical & Data Cabling works of UCO BANK, MAKDUMA BRANCH, BHAGALPUR, BIHAR and estimated cost of Rs. **5,50,350.00**
- (2) Contract documents consisting of the plan, complete specification, the schedule of quantities of the various classes of work to be done, and the set of conditions of contract to be complied with by the persons whose tenders may be accepted, and which will also be found in the form of tenders can be purchased from **UCO BANK ZONAL OFFICE BHAGALPUR** Between the 10:30 AM to 05:00 PM every day, except on Sunday and Bank Holiday.

The site for the work is available/The site for the work shall be made available in parts as specified below.

- (3) Tenders, which should always be placed in sealed cover, with the Name of project written on the envelopes will be received by **UCO BANK ZONAL OFFICE Bhaglpur** up to 3:00 PM on 11.03.2019 and will be opened in Zonal Office on 11.03.2019 at 04.00 PM
- (4) Tenders are to be on the prescribed form which can be obtained from **UCO BANK ZONAL OFFICE BHAGALPUR**. The time allotted for the carrying out of the work will be 25 Days from the next day after the date of written orders to commence work
- (5) The contractors should quote rate and amount in figures as well as in words tendered by them. The amount of each item should be worked out and requisite totals given.
- (6) Contractors should signs & stamp on each page on tender papers and submit it.
- (7) The last date of Issue of tender form will be on 08.03.2019 up to 05:00 PM.
- (8) Earnest money RS. **11000.00** in the form of Bank draft/Banker's cheque in favour of **ZONAL MANAGER UCO BANK must** accompany with each tender and each tender is to be in a sealed Envelopes super scribed on it " **TENDER FOR (Name of the Project)** " and addressed to :-

**ZONAL MANAGER
UCO BANK ZONAL OFFICE,
S K Tarafdar Road, Adampur Chowk, Bhagalpur**

- (8) The **EMD** of the contractor, whose tender is accepted, shall be forfeited in full in case he does not remit the Initial security deposit within the stipulated period or start the work by the stipulated date mentioned in the award letter.
- (10) The acceptance of a tender will rest with the **UCO BANK BHAGALPUR ZONE** which does not bind itself to accept the lowest tender, and reserves to itself the authority

to reject any or all of the tenders received without the assignment of a reason .All tenders in which any of the prescribed condition are not fulfilled or are incomplete in any respect are liable to be rejected.

- (11) The Bank reserves the right to accept the tender in full or in part and the tenders shall have no claim for revision of rates or other conditions if his tender is accepted in part.
- (12) Canvassing in connection with tenders is strictly prohibited and the tenders submitted by the contractors who resort to canvassing will be liable to rejection.
- (13) All rates shall be quoted on the proper form of the tender alone.
- (14) An item rate tender containing percentage below/above will be summarily rejected, However where the tenderer voluntarily offer a rebate for payment within a stipulated period, this may be considered.
- (15) On acceptance of the tender, the name of the accredited representative of the contractor who would be responsible for taking instruction for the Employer/Architect shall be communicated to the employer.
- (16) Special care should be taken to write the rate & amount in figure as well as in words in such a way that interpolation is not possible .The total amount should be written both figures and in words. In case of figures the words Rs. should be written before the figures of rupees and words after the decimal figures. Example Rs. 2.15P ,and in case of words ,the word “Rupees” should precede and the word “paise” should be written at the end, unless the rate is in whole rupees and followed by the words “only”. It should invariably be up to two decimal places. While quoting the rate in schedule of quantities , the word “only” should be written closely following the amount and it should be not be written in the next line.
- (17) The bank does not bind itself to accept the lowest or any tender and reserves to itself the right of accepting the whole or any part of the tender and the tenderer shall be bound to perform the same at the quoted rate.
- (18) The contractor shall give a list of his relatives working with the Bank along with their designation and addresses.
- (19) No employee of the Bank is allowed to work as a contractor for a period of two years of his retirement from the Bank service without the previous permission of the Bank. The contract is liable to be cancelled if either the contractor or any of his employees is found at any time to be such a person who has not obtained the permission of the Bank as aforesaid before submission such a person who has not obtained the permission of the Bank as aforesaid before submission of the tender or engagement in the contractor’s service.
- (20) The tender of works shall remain open for acceptance for a period of two days from the date of opening of tenders if any tenderer with draw his tender before the said



period, then the Bank shall be at liberty to forfeit his earnest money paid along with the tender.

- (21) The tender for the work shall not be witnessed by a contractor or contractors who himself/themselves has/have tendered or who may and had/have tendered for the same work failure to observe this condition would render tenders of the contractors tendering as well as witnessing the tender liable to summary rejection.
- (22) It will be obligatory on the part of the tenderer to tender and sign and tender document for all the component part and that after the work is awarded, he will have to enter into an agreement for each component with the competent Authority in the Bank.
- (23) It may also be noted that entire allotted work should be completed within **25 (Twenty Five) Days** from receipt of this letter, failing which a sum of Rs. **500.00 (Five hundred)** per day, being the amount of default charge, will be recovered from you after the expiry of stipulated period.
- (24) The tenderer, apart from being a competent contractor must associate himself with agencies of the appropriate class who are eligible to tender for (a) Interior (b) sanitary & water supply installation and (c) AC.

Signature of competent Authority

-sd/-

ZONAL MANAGER
UCO BANK



LIST OF APPROVED MATERIALS/MANUFACTURERES

DESCRIPTION

MAKE

Board / Ply (BWP)	:	Green/ Duro/Century
Laminate (1.0mm th)	:	Green/ Sunmica/Formica/ Century
Door Closer / Floor spring	:	Everite,Godrej, Hemaco
Drawer & Keyboard, Slide	:	Ebco (Telescopic)
Glue for fixing	:	Fevicol (Pidilite), Jivanjor
Glass	:	Modi Float, Saint Gobain
Mortice Latch & Lock	:	Godrej, Golden Industries Ltd.
Aluminium Sections	:	Jindal / Indal / Hindalco
False Ceiling	:	Gypsum marked “Gypsteel” , Lafarge
Synthetic Enamel	:	Asian, Nerolac, ICI, Berger
Emulsion Paint/Plastic Paint	:	Asian, Nerolac, ICI , Berger
Screws	:	Nettlefold / G.K.W.
Vitrified Tiles	:	Naveen/Somany/Euro
Ceramic Tiles	:	Naveen/Asian/Euro
Wood	:	IInd Grade teak wood

Note: Material used other than above mentioned items must be approved from the Architects/ Bank.

APPLICATION FORMAT

1. Name of the Applicant :

Address :

Telephone No.

Office :

Residence :

Mobile :

E-Mail :

2.

a) Status of the Firm (Whether company/Partnership / proprietary) :

b) Year of establishment:

3. Whether registered with Registrar of Companies/ firm. If so, No. & Date :

4. Registration with Tax Authorities :

a) PAN NO:

b) GST No :

5. Turnover of the Company/firm (Please attach copy of audited balance sheet and profit and loss account for three years).

Sl. No.	Year	Turnover (In Lacs)
1	2015-16	
2	2016-17	
3	2017-18	

Average :

6. Registration with Government / Public Sector / Banks

SL NO	NAME OF THE ORGANISATION	NATURE OF WORKS	VALUE OF WORKS	DATE OF REGISTRATION

What are your fields of core competence? Mention the fields on preference Basis

1)

2)

7. Details of the qualifying works executed (please mention only such works which qualifies for the category/class for which you have applied)

Sl .No	Name of Work	Work executed for (name of the organization with address, concerned office & telephone no)	Nature of work (in brief)	Location of the work	Actual Value of the works	Stipulated time for completion	Actual time for completion	If work left incomplete or terminated (furnish reasons)
1								
2								
3								

DECLARATION

1. All the information furnished by me / us here above is correct to the best of my knowledge and belief.
2. I / we have no objection if enquiries are made about the work listed by me / us in the accompanying sheets / annexure.
3. I / We agree that the decision of UCO Bank in selection of firms will be final and binding to me / us.
4. I / We have read the instructions appended to the proforma and I / we understand that if any false information is detected at a later date the work order shall be cancelled at the discretion of the bank.

Place :

SIGNATURE OF THE APPLICANT

Date :

NAME & DESIGNATION
SEAL OF ORGANISATION

UCO BANK MAKDUMA BRANCH

ELECTRICAL & LIGHTING WORKS:		QUANTITY	UNIT	RATE	AMOUNT
	LED LIGHT (18/20 W) of PHILIPS, JAQUAR, HAVELLS, OREVA, CROMPTON or equivalent. SUPPLYING, FIXING, INSTALLATION, CHECKING & WIRING WITH POLYCAB, FINOLEX or HAVELLS to be passed through telephonic and PVC pipes of 12 mm dia.	14	Each		
	CEILING FANS.(1200mm or greater dia) of HAVELLS, USHA, OREVA, CROMPTON or equivalent. SUPPLYING, FIXING, INSTALLATION, CHECKING & WIRING WITH POLYCAB, FINOLEX or HAVELLS to be passed through telephonic and PVC pipes of 12 mm dia.	6	Each		
	EXHAUST FANS. of HAVELLS, USHA, OREVA, CROMPTON or equivalent. SUPPLYING, FIXING, INSTALLATION, CHECKING & WIRING WITH POLYCAB, FINOLEX or HAVELLS to be passed through telephonic and PVC pipes of 12 mm dia.	2	Each		
	WALL MOUNTED FANS. of HAVELLS, USHA, OREVA, CROMPTON or equivalent. SUPPLYING, FIXING, INSTALLATION, CHECKING & WIRING WITH POLYCAB, FINOLEX or HAVELLS to be passed through telephonic and PVC pipes of 12 mm dia.	6	Each		
	PANEL BOARD 250 AMP INCOMING & 8 NOS 63-100 AMP OUTGOING ALL THREE PHASE CIRCUIT WITH INDICATOR SUPPLYING, FIXING, INSTALLATION & CHECKING	1	Each		
	UPS DISTRIBUTION BOARD Supply, Installation, Testing and commissioning double door D.B board for UPS POWER point circuit distribution complete with tinned copper bus bars, neutral link, earth bar, din bar, detachable gland plate inter connections including painting, earthing etc. as required. all complete as per instructions of Elec.Er. / Architect. 10A MCB-10 nos	1	Each		

UCO BANK MAKDUMA BRANCH

	<p>LIGHT DISTRIBUTION BOARD: Supply, Installation, Testing and commissioning double door D.B board for Lighting point circuit distribution complete with tinned copper bus bars, neutral link, earth bar, din bar, detachable gland plate inter connections including painting, earthing etc. as required. all complete as per instructions of Elec.Er. / Architect. 10A MCB-10 nos</p>	1	Each		
	<p>CHANGE OVER SWITCH (BETWEEN TWO UPS): Supply and fixing of 32A 415 volt 4 pole change over switch on MS clamp and complete with all interconnection (For change over between two UPS) of Havells/L&T make in sheet steel over between two UPS) of Havells/L&T make in sheet steel enclosure on wall all complete with hardware.</p>	1	Each		
	<p>MODULAR SWITCH BOARD ON WALL(LIGHT & FAN): Supply, Installation, Testing and commissioning of modular switch board with all accessories of approved make on wall/partition for light/fan points on wall/partitions. Each set contain 1 No 6 Amp switch socket including required switch in light control board with suitable size including GI box, board, & face plate. board with suitable size including GI box, board, & face plate.</p>	4	Each		
	<p>MODULAR SWITCH BOARD FOR IT RACK UPS POWER: Supply, Installation, Testing and commissioning of modular switch board for UPS Power with all accessories of approved make on wall. Each set contain(6 Amp Socket- 3 nos + 16 Amp Socket- 3 nos)</p>	8	Each		
	<p>MODULAR SWITCH BOARD ON TABLE(UPS POWER): Supply, Installation, Testing and commissioning of modular switch board with all accessories of approved make on table including each set contain(2 No 5pin 6 Amp socket with seperate switch each set contain(2 No 5pin 6 Amp socket with seperate switch + 1 no 5 pin 6/16Amp socket with seperate socket) with suitable size.</p>	2	Each		

UCO BANK MAKDUMA BRANCH

	<p>15A SWITCH SOCKET ON TABLE(RAW POWER): Supply, Installation, Testing and commissioning of switch board with all accessories of approved make on table/wall including each set contain (1No fuse 10Amp & 1 No indicator 10Amp + 1 each set contain (1No fuse 10Amp & 1 No indicator 10Amp + 1 no 5pin 16A socket with switch) with suitable size and wiring from the Main Panel to each point. Max two number point may be looped.</p>	4	Each		
	<p>METAL CLAD SOCKET (FOR UPS): Supply & Installation of Industrial type Metal Clad socket 32A TPN, Flush Type with MCB & socket of approved make for UPS.</p>	4	Each		
	<p>MODULAR METAL CLAD SOCKET(FOR AC): Supply & Installation of Industrial type modular Metal Clad socket 25A Flush Type with MCB & socket of approved make for AC concealed in the wall as per drawing and instructions.</p>	4	Each		
	<p>DATA POINT: Supply, Installation, Testing and commissioning of RJ 45 modem Jack in modular IO box including patch cord of required length for Computer including making connection , soldering etc as required and as per drawing and instructions.</p>	7	Each		
	<p>DATA WIRING (FROM IT RACK TO DATA POINT AT TABLE): Supply, Installation, Testing and commissioning of Concealed Data wiring from Server to each computer with CAT-6 wire including supply of 25mm dia heavy duty PVC conduit of reputed make in floor/wall/ceiling as required. (from IT Rack to each computer)</p>	220	Rmt		

UCO BANK MAKDUMA BRANCH

	<p>EARTH STATION EACH:</p> <p>Supply, Installation, Testing & Commisioning of ground Earth Pit with 2'X2'x1/4" copper plate buried at a depth of 10' feet below with 2'X2'x1/4" copper plate buried at a depth of 10' feet below from the ground surface and 1"x8' long GI pipe with arrow socket, funnel 8 SWG copper wire in 1/2" GI pipe, nut & bolt etc and covering with 2" x12" heavy duty C.I earth cover including chambering and filling the boring area with charcoal and salt (40 Kgs each) as per IS 3043 specification including wiring from earthpit to the UPS & Panel and Earth Bus bar.(Earth resistance should not exceed 2 ohm at the earth terminal at UPS.</p>	2	Each		
--	--	---	------	--	--

UCO BANK MAKDUMA BRANCH

<p>DATA RACK 24-PORT D-LINK:</p> <p>Configuration for standard racks are welded frame integrated with side panels and vented top cover with fan mounting provision, while front glass with lock & key provides the visibility & security, rear side of the Rack is provided with the wall mounting slots for your equipment. Racks are available from 4U to 15U Variants with 400mm, 450mm, 500mm and 600mm deep configuration.</p>	1	Each		
<p>TUBE LIGHT</p> <p>Supply installation and fixing of 1x36 watt make Philips/ havells tube light fitting / led light 28 watt with complete fitting.</p>	10	Each		
<p>WIRING</p> <p>. MAIN WIRING (FROM ENERGY METER TO PANEL)</p> <p>Supply, Installation, Testing and commissioning of Sub main wiring with (3X10SQM+1X2.5 SQM)PVC insulated copper conductor 600V Grade stranded flexible wires of approved make Polycab / Finolex wires through 25mm dia heavy duty PVC conduit with accessories of reputed make like Standard / Precision / BEC as per drawing and instructions.</p>	20	Rmt		
<p>. SUB MAIN WIRING-1(FOR INTERNAL WIRING)</p> <p>Supply, Installation, Testing and commissioning of Sub main wiring with (3X6SQM+1X2.5 SQM)PVC insulated copper conductor 600V Grade stranded flexible wires of approved make Polycab / Finolex wires through 25mm dia heavy duty PVC conduit with accessories of reputed make like Standard / Precision / BEC as per drawing and instructions. (Panel to UPS+Panel to DB's + UPS to UPS DB)</p>	40	Rmt		
<p>. CIRCUIT WIRING (LIGHTING DB TO SWITCH BOX):</p> <p>Supply, Installation, Testing and commissioning of concealed Circuit wiring for Raw power Switch box included with (2x2.5 Sq.mm+1x1.5 sqmm) PVC insulated copper conductor 600V</p>	325	Rmt		

UCO BANK MAKDUMA BRANCH

Grade stranded flexible wires of approved make Polycab / Finolex wires through 25mm dia heavy duty PVC conduit with accessories of reputed make like Standard / Precision / BEC / Vimco in wall, floor, ceiling, partition wall and furnitures as per drawing and instruction.	320	Rmt		
<p>. CIRCUIT WIRING (UPS DB TO UPS POINT ON TABLE/WALL):</p> <p>Supply, Installation, Testing and commissioning of concealed Circuit wiring for UPS Power Switch box in the tables included with (2x2.5 Sq.mm+1x1.5 sqmm) PVC insulated copper conductor 600V Grade stranded flexible wires of approved make Polycab / Finolex wires through 25mm dia heavy duty PVC conduit with accessories of reputed make like Standard / Precision / BEC / Vimco in wall, floor, ceiling, partition wall and furnitures as per drawing and instruction.</p>	150	Rmt		
<p>. CIRCUIT WIRING (PANEL TO AC POINT):</p> <p>Supply, Installation, Testing and commissioning of concealed Circuit wiring for UPS Power Switch box in the tables included with (2x4.0Sq.mm+1x2.5 sqmm) PVC insulated copper conductor 600V Grade stranded flexible wires of approved make Polycab / Finolex wires through 25mm dia heavy duty PVC conduit with accessories of reputed make like Standard / Precision / BEC / Vimco in wall, floor, ceiling, partition wall and furniture as per drawing and instruction. (From Main Panel to AC point)</p>	38	Rmt		
<p>. POINT WIRING (SWITCH BOARD TO LIGHT/FAN POINT)</p> <p>Supply, Installation, Testing and commissioning of concealed Point wiring included with (2x1.5 Sq.mm) sqm PVC insulated copper conductor 600V Grade stranded flexible wires of approved make wires through 25mm dia heavy duty PVC conduit with accessories of reputed make like including supply and fixing of 6A Modular switch with all accessories of approved</p>				

UCO BANK MAKDUMA BRANCH

	make and approved colour and design as per Architect in wall, Furniture as per drawing. (from Switch Board to Light Point)				
	TOTAL				

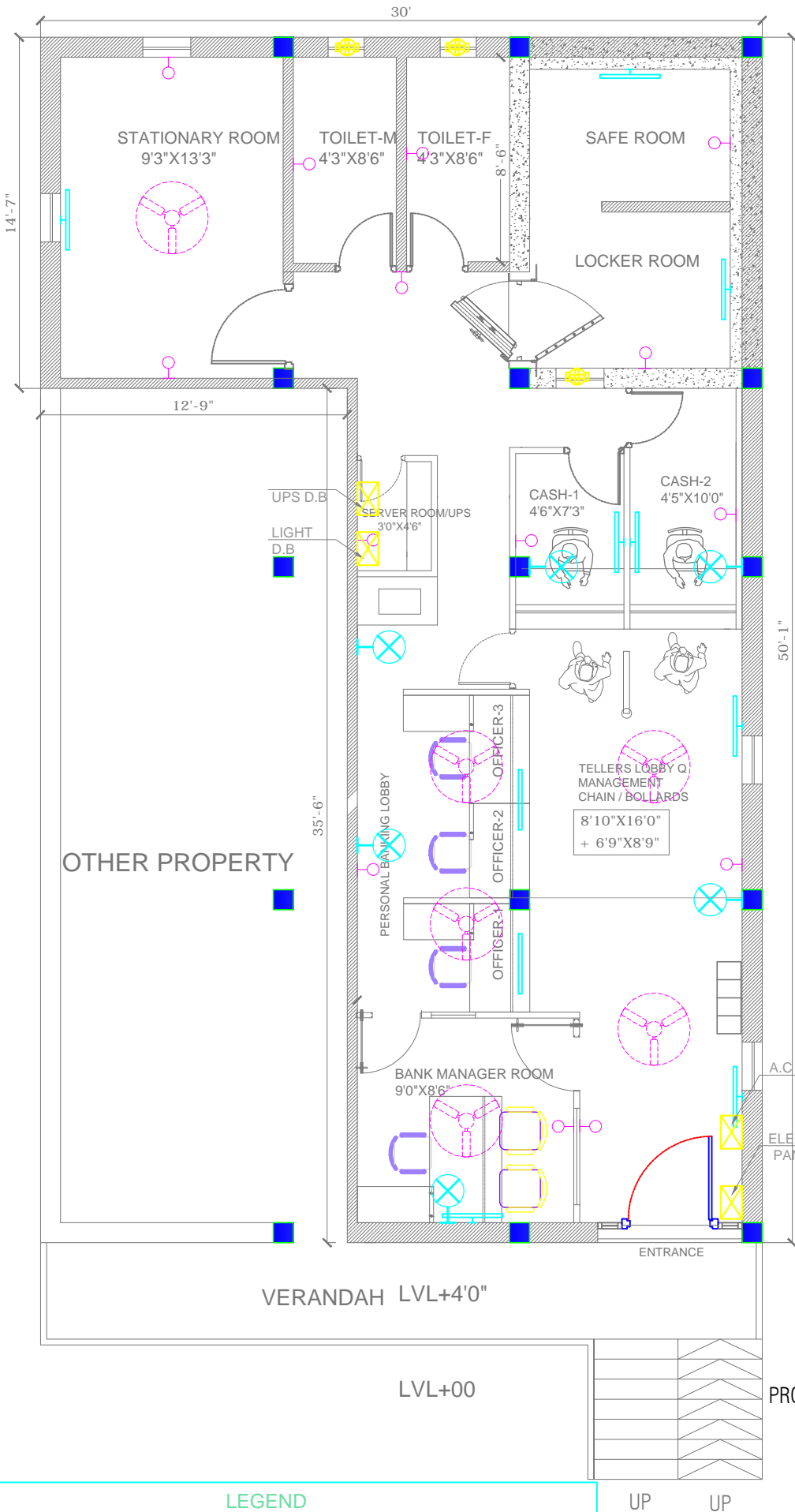

PURPOSED ELECTRICAL LAYOUT
PLAN OF MAKDUMA BRANCH,
UCO BANK - CARPET AREA -825
SQFT
B/W AREA=1049 SQFT

NOTES:
ALL DIMENSIONS ARE TO BE CHECKED AND CO-RELATED WITH THE RELEVANT ARCHITECTURAL & STRUCTURAL DRAWINGS AND ANY AMBIGUITY SHALL BE IMMEDIATELY BROUGHT TO THE NOTICE OF THE ARCHITECTS BEFORE COMMENCEMENT OF THE WORK. THIS DRAWING IS THE PROPERTY OF ATTIK ARCHITECTS AND IS NOT TO BE COPIED OR USED WITHOUT THEIR PERMISSION.

REVISIONS :				
Suffix	Date	Initials	change	

Client :

Architects :
ATTIK ARCHITECTS
architect
1BS BUILDING, SITHLA ASTHAN ROAD, NEAR
TILKAMANJHI THANA, BHAGALPUR, PH. NO. 7503821328
9430540484, 9899677289

Consultants :

Job Title :
**PROPOSED ELECTRICAL
LAYOUT PLAN OF UCO
BANK, MAKDUMMA BRANCH**

Drawing Title :
ELECTRICAL LAYOUT

Date 21-02-2019	Chkd. by : AR.VIKASH KR	NORTH :
Scale NTS	DEALTY BY :	
DRG NO. -		R 0

ATTIK ARCHITECTS
This drawing/design is property of Attik architects. No part of this may be reproduced or implemented in any form without prior permission in writing from Architects. Any person doing so, shall be liable to criminal prosecution and civil claims for damages.

LEGEND

SYMBOL	DESCRIPTION		SYMBOL	DESCRIPTION	
	15 AMP POWER POINT	@ 500mm from floor finish		GEYSER POINT	@ 1200mm from floor finish
	5 AMP POWER POINT	@ 1000mm from floor finish		LED LIGHT	@ 2400mm from floor finish
	TELEPHONE POINT	@ 550mm from floor finish		CEILING FAN	@ as per site ceiling ht.
	T.V. POINT	@ 1800mm from floor finish		EXHAUST FAN	@ 2400mm from floor finish
	SWITCH BOARD	@ 1000mm from floor finish		A.C. POINT	@ 1200mm from floor finish
	MCB	@ 2400mm from floor finish		WALL MOUNTED FAN	@ 2400mm from floor finish
	CALL BELL	@ 2400mm from floor finish		TUBE LIGHT	@ 2400mm from floor finish

SCHEDULE OF TABLES CHAIRS & OTHER LOOSE FURNITURE ITEMS TO BE PROVIDED FOR UCO BANK MAKDUMA BRANCH**TOTAL CARPET AREA= 890 SQFT****ESTIMATED FURNITURE WORK COST -****ESTIMATED ELECTRICAL WORK COST -****TOTAL -**

S.L	ITEM DESCRIPTION	UNIT	QTY	RATE (Rs)	AMOUNT (Rs)
1.0	<u>WOODEN TABLE FOR MANAGER</u> MANAGER'S TABLE: Providing and Placing Manager Table of L-shaped size (5'6" X 3'0" & 2'-9" X 1'-6") edged with teakwood beading of 2"x2" (approx) cut to required shape, top of table to have 1.0mm thick laminates and teakwood beading to be polished to required colour. Table to have a vertical modesty panel of 19 mm thick blockboard covered with laminates (1.0mm thick) from the outer side and (0.8mm thick) laminates on the inner side including supply and fixing of sliding keyboard of approved make and provision of 1 no.s drawer & 1 no file cabinet with lock & all fitting. In all these tables/counters provision shall be made so that the CPU of the computer can be kept under the table and only the monitor shall be visible. Also there shall be neat hole in the tabletop for the wire.	Each	1		
2	<u>NOTICE BOARD</u> Providing & Fixing in position notice board as per drawing and confirming to the following specifications <u>Basic Frame Work</u> Well seasoned hard wood section treated with two coats of wood preservatives minimum 0'-2" x 0'-1" at suitable horizontal vertical spacing not exceeding 2'-0" c/c <u>Skin Membrane</u> 4 mm thick BWR grade ply wood over which 12 mm thick approved quality soft board clayed with fabric of approved shade and quality <u>Edge Molding</u> All free edges shall have polished 2 nd class teak wood moulds of approved shape (finished 0'-2" x 0'-1" sections) with equal spirit polish in mat finish	Each	1		
3					

4	<p><u>PRINTER TABLE</u></p> <p>Providing and fixing printer table made out of approved 19 mm thick BWP ply frame work for side bottom. A pedestal made of 19 mm thick BWP ply wood for sides shelf and bottom and 6 mm thick BWP ply wood of approved make for the back finished with 1 mm thick laminate of approved make and shade and back side shall be provided underneath .Skirting shall be provided in 1 mm thick laminate of approved make and shade. Pedestal/printer table 3'-0" x 2'-6"</p> <p><u>GLASS FOR MANAGER TABLE TOP</u></p> <p>Providing and fixing 12 mm thick floating Glass with polished crystal edge finished etc on Manager table top as per direction of Architect Size (5'-6" x 3'-0" x 1 no)</p>	No			
5	<p><u>WOODEN/COLUMN/WALL PANELLING</u></p> <p>Wall paneling/column encasing (up to table height) works as per drawing & conforming to the following specification (Quantity/location should be restricted only to the central pillars in Banking Hall or any prime location)</p>	sqft	18		

6	<p><u>Basic Frame Work:</u> Well seasoned hardwood sections, treated with two coats of wood preservatives, minimum 0'-2" x 0'-1", at suitable horizontal/vertical spacing not exceeding 2'-0" c/c.</p> <p><u>Skin Membrane:</u> 6 mm thick BWR grade plywood with grooves formed as desired as per drawing/instructions</p> <p><u>Finishing :</u> 1 mm thick laminate sheet of same or combination shades as per instructions.</p> <p><u>Skirting :</u> 0'-4" high x 0'-1/2" thick polished 2nd class teak wood skirting with NC lacquer finish Quoted rates teak shall include all necessary materials, accessories & labor & also allow provisions for electrical/telephone/computer wiring conduits & switch boxes .(Material for wiring conduits & switch boxes shall separately paid for.) Columns paneling –10'X5'X2 No. Wall paneleing-10'x8'</p> <p><u>PARTLY GLAZED FULL HEIGHT WOODEN PARTITION WITH DOOR FOR MANAGER CHAMBER</u></p> <p>Supplying & erecting full height door partly glazed wooden door for Manager Chamber as per drawing and conforming to the following specifications</p> <p><u>Basic Frame Work</u> Well seasoned Malaysian hard wood section treated with two coats of wood preservatives 2 ½" x 1 ¾" (minimum) at maximum 2'-0" horizontal or vertical spacing as per site conditions. Vertical Members shall be suitably anchored at floor & ceiling level to ensure rigidity. Exposed frame members in the glazed portions shall be wider spacing (approx 6'-0") or as per instructions Exposed members shall be finished with 1 mm thick laminate sheet of same or combination shade over 12 mm BWR plywood facing including 4 x 6 mm grooves at location as per instructions</p> <p><u>Skin Membrane</u> Opaque portion up to 3'-0" from floor level and from false ceiling from floor level with 2 x 6 mm thick BWR grade plywood on each face. With Groove formed at the top layer as per drawing/ instructions</p> <p><u>Finishing</u> 1 mm thick laminate sheet of same or combination shades as per instructions.</p> <p><u>Skirting</u> 0'-4" high x 0'-1/2" thick polished teak wood skirting with NC lacquer finish</p>	Sft.	180		
	<p><u>Basic Frame Work</u> Well seasoned Malaysian hard wood section treated with two coats of wood preservatives 2 ½" x 1 ¾" (minimum) at maximum 2'-0" horizontal or vertical spacing as per site conditions. Vertical Members shall be suitably anchored at floor & ceiling level to ensure rigidity. Exposed frame members in the glazed portions shall be wider spacing (approx 6'-0") or as per instructions Exposed members shall be finished with 1 mm thick laminate sheet of same or combination shade over 12 mm BWR plywood facing including 4 x 6 mm grooves at location as per instructions</p> <p><u>Skin Membrane</u> Opaque portion up to 3'-0" from floor level and from false ceiling from floor level with 2 x 6 mm thick BWR grade plywood on each face. With Groove formed at the top layer as per drawing/ instructions</p> <p><u>Finishing</u> 1 mm thick laminate sheet of same or combination shades as per instructions.</p> <p><u>Skirting</u> 0'-4" high x 0'-1/2" thick polished teak wood skirting with NC lacquer finish</p>	Sft.	176		

<p><u>Glazing</u> 6 mm thick clear float glass fixed with continuous steam beech wood glazing beads of approved shape (finished 0'-1 ¼" x 0'-1") all round polished and coated with NC lacquer finish. The rate should also include cost for decorative itching on one side of the glass</p> <p><u>Hardware</u> Providing & Fixing door closer & mortise lock with 4" kabja & other misc. hardware.</p> <p><u>FULL HEIGHT NON GLAZED PARTITION:</u> Providing and fixing full height wooden partition (server room & near locker room gate) with frame of 2"x2" (finished size) seasoned hard wood member at max intervals of 1'-6" x 1'-6" c/c with provision of bigger at skirting, fixing to the ceiling, slab, beams etc including the door of size 3'-0"x7'-0". All woodwork to be treated with 1st quality anti termite paint and should be covered with 12 mm thick ply Board of approved make finished by 1.0 mm thick laminate of approved. Size: location-ups room- 12'x8'</p> <p><u>LOW HIGHT PARTITION WITH FLAP DOOR</u> Made out of Sal Wood /ghamar Wood frame 0'-2" x 0'-2" and 12 mm thick BWR plywood on its both sides finished with 1 mm thick laminate pasted with fevicol Edges of the top gate finished with teak wood beading polished in natural shade. The gate shall be provided with Oxidized M S hinges and door springs. Skirting and bands shall be provided in 1 mm thick laminate of approved make and shade as directed by Architect. Size:</p> <p><u>CASH COUNTERS AND SINGLE WINDOW</u> Made out of 19 mm thick BWR plywood for working top keyboard shelf and vertical sides of counter and stronger unit front apron of 19 mm thick BWR ply with four 1'-6" wide drawers (of equal height) on the right side shall be provided. Division shall be made in appropriate sizes in drawers to store currency notes of different denominations and different sizes. Customer hand rest 1'-3" wide and 1'-0" high made of 12 mm thick BWR plywood for the vertical surface and the top shall be provided. ¾" thick polished jet black granite with beveled edges shall be provided above the working top and customer top. 19 mm thick and 2'-0" wide</p>	Sft	60		
	Sft	36		
	Rft	9		

10	<p>plywood of approved make shall be provided 0'-3" above floor level and across the counter for CPU shelf and foot rest. All exposed visible surfaces of counter like working top, front apron, drawers etc shall be finished with 1 mm thick laminate of approved make and shade. The key board shelf shall be 2'-0" x 2'-0" size and provided with teak wood beading polished natural. (0.8mm thick) laminates on the inner side. Height and width of the writing top shall be 2'-6". Height of the customer hand rest shall be provided with Godrej Multipurpose locks, metal telescopic channels and S S finished oxidized handles(0'-3") and hardware Skirting and bands shall be provided in 1 mm thick laminate of approved make and shade as directed by Architect</p> <p><u>OFFICERS COUNTERS (EXECUTIVE TABLES)</u></p> <p>Made out of 19 mm thick BWR plywood for working top keyboard shelf and vertical sides of counter and stronger unit front apron of 19 mm thick BWR ply with four 1'-6" x 0'-6" wide drawers (clear dimension) removable shelf and cupboard with shutter on the right side shall be provided. The writing top shall be provided with ¾" thick polished jet black granite with beveled edges shall be provided above the working top and customer top. 19 mm thick and 2'-0" wide plywood of approved make shall be provided 0'-3" above floor level and across the counter for CPU shelf and foot rest. All exposed visible surfaces of counter like working top, front apron, drawers cupboard fascia etc shall be finished with 1 mm thick laminate of approved make and shade. The key board shelf shall be 2'-0" x 2'-0" size and provided with teak wood beading polished natural. (0.8mm thick) laminates on the inner side including supply and fixing of sliding keyboard of approved make. Height and width of the writing top shall be 2'-6" and 2'-9" each The Drawers and shutters shall be provided with Godrej Multipurpose locks, metal telescopic channels and S S finished oxidized handles(0'-3") and hardware Skirting and bands shall be provided in 1 mm thick laminate of approved make and shade as directed by Architect</p> <p>Officer (4'-6" x 2'-6"x 2nos.),4'0"x2'6"x1 No.</p> <p>Curvilinear Counter</p>	each	3		
----	--	------	---	--	--

	Credenza (2'6"X2'6")x2 no.				
11.0	<p><u>CASH CABIN PARTITION</u></p> <p>Made out of 2" x2"(clear size) Sal wood chill wood members placed at not more than 2'-0" distance both ways and 12 mm thick BWR ply board of approved make finished with 1 mm thick laminate of approved make and shade on both sides. Skirting and bands shall be provided in the partition as directed by Architect</p> <p>An opening of 8" x 4" at 3'-0" height with 8" x 8" tray made of 12 mm thick BWR plywood of approved make finished with 1 mm thick laminate of approved make and shade on all four sides shall be provided wherever required</p> <p>The partition shall have aluminum grill # 009/101 of approved make and powder coated in approved colour in wooden frame from 3'-9" height to 7'-0" height</p> <p>A Door shutter made of same specification and finished with 1 mm thick laminate of approved make and shade shall be provided in the partition with Godrej make S S finished cylindrical lock S S heavy duty hinges and door closer of approved make shall be provided in the shutter.</p> <p>Size: 8'0"x8'0"x1Nos. , 10'0"x8'0"x1 Nos. ,4'6"x8'0"[include door]</p> <p>Door size : 2'6"x7'0"x 2Nos.</p>	Sft.	180		
12.0	<p><u>FRONT PARTITION FOR CASH CABIN AND SINGLE WINDOW</u></p> <p>12 mm thick clear float glass partition from top of the customer hand rest to 6'-9" height fixed with the side wooden partition. A semicircular opening (0'-8" dia) and 0'-2" wide slit shall be provided along with aluminum mesh in the partition as directed by the Architect</p>	Sft.	54		
13.0	<p><u>FRONT PARTITION FOR COUNTERS</u></p> <p>12 mm thick clear float glass partition along with 1'-0" wide 12 mm thick clear float glass horizontally placed above it shall be provided in front of the clerical counters. 0'-2" wide slit shall be provided in the partition at the bottom. Total height of partition along with the horizontal glass member and slit is 1'-3". The glass partition shall be fixed with 0'-2" x 0'-2" wooden posts 1'-3" high and finished with 1 mm thick</p>	Sft	14		

	laminate of approved make and shade Size: 6'10"x1'3"x1nos , 7'5"x1'3"x1nos.	Sft	52		
14.0	<u>ROLING SHUTTER BOX.</u> Providing and fixing Rolling shutters boxes made out of 2" x 1 ½" size teak wood frame work. 19 mm thick BWR plywood open able door etc, complete with enamel paint finish of approved quality & shade as per instruction 9'x1'6"x2Nos. , 9'x2'0"x1Nos. , 2'0"x1'6"x2Nos.				
15.0	<u>A.Providing Factory made Aluminum Main Entrance Door</u> of INDAL / Jindal sections minimum section thickness of 2.5 mm all complete with swing door, fixed portion all 12 mm thick glass, coloured anodized / powder coated as per standard approved sections,with logo of UCO BANK made with eatching on glass neatly. All complete with all necessary hardware and fittings, including floor springs, door lock etc. Door size- 7'x3'	Sft	60		
		Each	1		
16.0	<u>CHEQUE DROP BOX</u> Providing and fixing one suggestion box, made with 12 mm ply as per standard design and specification of the Bank fully complete with lock, lettering on top etc.	Each	1		
17.0	<u>Providing and fixing Cheque writing / slip rack projected/</u> supported from wall 6'-0" x 1'-3" and a C T as per design with suggestion box first aid box.	Each	1		
18.0	<u>SUGGESTION BOX</u> Providing and fixing one suggestion box made with 12 mm ply as per standard design and specification of the Bank fully complete with enamel painting, lock, lettering on top etc	Sft	No		
19.0	<u>ALLUMINIUM WINDOW</u> Providing and fixing aluminum sliding window with 5mm float glass with all channel and hardware complete in all respect. Including manager chamber window.	sqft	No		
20.0	<u>BLINDS:</u> Providing and fixing LUXAFLEX/VISTA LEVELOR brand Venetian Providing and fixing LUXAFLEX/VISTA LEVELOR brand Venetian blinds with 4" wide woven fabric coated blinds mechanism housed in head rail 1" wide high extruded from aluminium and louvers to be hung extruded from aluminium and louvers to be hung on superior quality runners with				

	attached stainless steel spacer to obtain over lapping of 15 mm between the louvers				
	TOTAL-				
21.0	BUY BACK (RESALE): Sale of old 0 furniture's and appliances as per availability and condition. Items include old furniture, ply, counters, wires etc. (except chairs)				As per direction of bank officials

--	--	--	--	--	--

--	--	--	--	--	--

[illegible]

