

ZOB/GAD/2016-17/

Date: - 02.08.2016

**TENDER NOTICE**

**Sealed items rate tenders are invited for the works noted here under.**

SL.NO	Name of work	Place	Estimated cost
1	Furniture work	Khaira	3.18
2	electrical work		2.78
	Total work order		5.96

**Terms and condition:-**

1. Time of completion of work :- 30 days
2. 1% Earnest money deposit: - 1% of estimated value at the time of submission of tender in the form of pay order/DD/Banker's cheque.
3. 2% initial security deposit: 2% of the contract value including the EMD by successful bidder.
4. The EMD and ISD so deposited by the successful bidder will be adjusted with the security deposit/ retention money for the contract.
5. Defect liability period: one year from the virtual completion of work.
6. Time and last date of submission of tender : 5PM on 01.09.2016
7. Date of opening of the tender Application : 5PM on 03.09.2016
8. Place of submission: UCO Bank, Zonal Office, S.K.Tarafdar Road, Adampur , Bhagalpur 812001.
9. Bank reserve its right to postpone/ reject any or all the tenders without assigning any reason what so ever. All tenders in whom any of the prescribed condition are not fulfilled or are incomplete in any respect are liable to be rejected.
10. Service tax applicable as per norms.
11. Only empanelled contractors can submit tenders.
12. Cost of Form is Rs 1,000 (Rupees one thousand only) non refundable favouring UCO BANK ZONAL OFFICE BHAGALPUR payable at Bhagalpur.

---Sd-----

**Zonal Manager**

**TENDER FORM**

TO

\_\_\_\_\_

\_\_\_\_\_

\_\_\_\_\_

Tender notice no: \_\_\_\_\_

Date: \_\_\_\_\_

Name of work: proposed electrical and Civil work / furnishing of branch/furnishing of Branch.

Sir,

I/we the undersigned have examined the tender document and the site of works as hereby submit this tender amounting the sum of RS.....and should the same be accepted hereby undertake to execute complete and maintain all works as set forth in the schedule of quantities and specifications in accordance with the conditions of tendering, general conditions of contract, and the rates quoted by us in the aforesaid schedule of quantities all here to annexed or in default thereof to forfeit and pay to UCO BANK the sum of money mentioned in the aforesaid documents.

I/We agree to abide by this tender for the period of one year from the date fixed for opening of the same.

I/We undertake to complete and deliver the whole of the works covered under this tender within a period of 30 calendar days from the date of issue of work order.

I/We shall be bound by the terms and conditions of the tender documents and our accepted tender.

Signature of tenderer

Name

Address

Date:-

<b>BILL OF QUANTITY</b> <b>ELECTRICAL WORKS FOR UCO BANK AT- KHAIRA BRANCH.</b>					
A.	SUB HEAD-I (WIRING)				
B.	SUB HEAD-II (DISTRIBUTION BOARDS & PANELS)				
C.	SUB HEAD-III (SUPPLY OF FIXTURES & FANS)				
D.	SUB HEAD-IV (SUPPLY OF CABLE MAIN & SUBMAIN)				
E.	TOTAL SUB HEAD-V (SUPPLY & MAKING OF EARTHPITS)				
	<b>TOTAL</b>				
<b>TOTAL</b>					
<b>SL. NO.</b>	<b>ITEM OF WORK</b>	<b>UNIT</b>	<b>QTY</b>	<b>RATE</b>	<b>AMOUNT</b>
<b>SUB HEAD - I (WIRING)</b>					
1	Wiring for light point/ fan point/ exhaust fan point/ call bell point with 1.5 sq mm FR PVC insulated copper condtr single core cable in surface/ recessed PVC conduit with modular switch, modular plate, suitable GI box and earthing the 3rd point with 1.5 sqmm FR PVC insulated copper conductor single core cable etc as reqd.	Each	30		
2	Wiring for A.C. Point with 2 x 4 sqmm FR PVC insulated copper conductor single core cable in surface/ recessed PVC conduit / PVC Casing - n Capping along with one no 4 sq mm FR PVC insulated copper conductor single core cable for loop earthing as required.	Mtr.	65		
3	Sub main wiring for UPS to UPS feed DB with 2 x 6 sqmm FR PVC insulated copper conductor single core cable in surface/ recessed PVC conduit / PVC Casing - n Capping along with one no 6 sq mm FR PVC insulated copper conductor single core cable for loop earthing as required.	Mtr.	19		
4	Sub Main wiring from LT Panel to RAW Power D.B. with 4 x 6 sqmm FR PVC insulated copper conductor single core cable in surface/ recessed PVC conduit / PVC Casing - n Capping along with two no 6 sq mm FR PVC insulated copper conductor single core cable for loop earthing as required.	Mtr.	12		
5	Sub Main wiring from LT Panel to UPS Panel with 4 x 6 sqmm FR PVC insulated copper conductor single core cable in surface/ recessed PVC conduit / PVC Casing - n Capping along with two no 6 sq mm FR PVC insulated copper conductor single core cable for loop earthing as required.	Mtr.	20		

6	Wiring for UPS & RAW Power feed computer point with 2 x 2.5 sqmm FR PVC insulated copper conductor single core cable in surface/ recessed PVC conduit / PVC Casing - n Capping along with one no 2.5 sq mm FR PVC insulated copper conductor single core cable for loop earthing as required. ( 3 outlets, i.e 3 points each with 1 switch and 3 sockets shall be under one circuit	Mtr.	145		
7	Sub main for Light point Distribution Board with 4 x 4 sqmm FR PVC insulated copper conductor single core cable surface/ recessed PVC conduit / PVC Casing - n Capping along with one no 4 sq mm FR PVC insulated copper conductor single core cable for loop earthing as required.	Mtr.	23		
8	Light Circuit wiring with 2 x 2.5 sqmm FR PVC insulated copper conductor single core cable surface/ recessed PVC conduit / PVC Casing - n Capping along with one no 2.5 sq mm FR PVC insulated copper conductor single core cable for loop earthing as required.	Mtr.	95		
9	Wiring for 15 amp power socket 2 x 2.5 sqmm FR PVC insulated copper conductor single core cable surface/ recessed PVC conduit / PVC Casing - n Capping along with one no 2.5 sq mm FR PVC insulated copper conductor single core cable for loop earthing as required.	Mtr.	28		
10	S/F suitable size GI box with modular plate and cover in front on surface/ in recess i/c pvdg & fixing 5 pin 5/6 amp modular socket outlet and 5/6 amps modular switch, connection, painting etc as reqd.	Set	5		
11	S/F suitable size GI box with modular plate and cover in front on surface/ in recess i/c pvdg & fixing 6 pin 15/16 amp modular socket outlet and 15/16 amps modular switch, connection, painting etc as reqd.	Set	1		
12	S/F AC controller unit consisting of one no 25 amp AC controller having overload protection starter, one no 20/25 amp SPN MCB and socket outlet, all fixed on a modular plate complete with metal box and recessed in wall as reqd.	Set	4		
13	S/F remote controlled call bell buzzer suitable for 230 V AC/ Battery operated with remote type bell push as reqd.	Nos.	1		
14	SITC of computer point with 3 no. 5 pin 5/6 amp modular socket with modular type switch for UPS Power and 2 no. 5 pin 5/6 amp modular socket with modular type switch phenolic laminated sheet suitable size PVC/G.I. box. As per instruction of Bank/Elc.Er./as required.	nos.	5		
15	S/F of approved make including square face plate and M.S. housing box with RJ-45 socket etc complete in all respect including cat-6 Data cable conduits, identification of the hub				
	a) RJ-45 socket	Set.	5		
	b) Cat-6 Data cable with PVC conduit	Mtr.	110		
16	S/F of approved make including square face plate and M.S. housing box with RJ-11 socket etc complete in all respect including cat-6 Data cable conduits as required.				
	a) RJ-11 socket	Set.	7		
	b) Supplying and drawing 10 pair 0.5 sqmm FR PVC insulated annealed copper conductor, unarmored telephone cable in the existing surface/PVC conduit as required.	Mtr.	95		
17	Supplying and drawing fixing 8 SWG copper conductor wire for loop earthing as required.	Mtr.	30		

18	Supplying, installation, testing & fixing of 08 Line EPABX with two line telephone one set.	Each	1		
19	Supply and fixing of following sizes of PVC conduit along with accessories in surface/ recess i/c cutting the wall and making good the same in case of recessed conduit as reqd.				
	a) 20 mm	Mtr.	20		
	b) 25 mm	Mtr.	25		
<b>TOTAL SUB HEAD-I</b>					
<b>SUB HEAD - II (DISTRIBUTION BOARDS &amp; PANELS)</b>					
1	Supplying & Fixing following ways three pole and neutral sheet steel MCB DB, 415 volts on surface/ recessed complete with tinned copper busbar, neutral busbar, earth bar din bar detachable gland plate interconnections, phosphatised and powder painted i/c earthing etc as reqd. (But without MCB / RCCB/Isolator)				
	a) 8 Way double door SPN DISTRIBUTION BOARD.	Each	2		
	b) 8 Way double door TPN DISTRIBUTION BOARD.	Each	1		
2	S/F 5 amps to 32 amps rating 240 V 'C' series MCB suitable for inductive load of following poles in the existing MCB DB complete with connections, testing and commissioning etc as reqd.				
	a) 6/10 A 10 KA SP MCB "C"	Each	19		
	b) 40 A 10 KA FP MCB "C"	Each	2		
	c) 40 A 10 KA DP MCB "C"	Each	1		
	SITC of indoor cubicle extensible type fully compartmentalized Distribution panel suitable for operation on 415 volts 50 Hz 3 phase 4 wire AC distribution system, suitable for 35 KA short circuit rating, conforming to IP:42 degree of protection, made up of 1.6 mm thick CRCA sheet, wall/ floor mounted, dust & vermin proof enclosure, having hinged and earthed cover on front, having neoprene gasket/ katings stuck to the doors, duly painted with 65- 75 microns thick dry epoxy powder paint after 7 tank process of degreasing, derusting etc comprising of the following switchgears complete with all interconnections with suitable size of copper strip/hard drawn PVC insulated copper cable i/c keeping the panel in position, minor civil works as necessary, painting, sign writing etc complete as required (as per specifications of Panel attached)				
	<b>INCOMING:</b>				
	a) 100 amp 4 pole MCCB not less than 25 KA having Thermo magnetic type release for a range of 80% to 100% for Overload and short circuit complete with rotary handle etc as reqd.: 1 no				
	b) 63 amp 4 pole heavy duty I-II-I type cubicle changeover switch: 1 no				
	<b>METERING:</b>				
	a) Multifunctional meter displaying A/V/PF & Hz along with 3 nos Suitable size CTs & HRC type protection fuse etc as reqd: 1 nos				
	b) LED type phase indicationg lamp in phase distinguishing colors with HRC fuse : 6nos				
	<b>BUS BAR:</b>				
	Main Bus Bar: 4 strip 200 amp bus bar made of electrical grade copper strip enclosed in separate bus bar chamber, provided with DMC/ SMC bus bar support duly insulated with heat shrinkable sleeves in distinct colours as reqd: 1 set				

	<b>OUTGOINGS:</b>				
	a) 40 amp FP 10 KA MCB "D" Series: 3 nos. (FOR Light D.B., UPS Panel and RAW D.B.)				
	b) 40 amp SPN 10 KA MCB "D" Series: 3 nos.				
	c) 25 amp SPN MCB 10 KA "D" Series: 4 nos.				
3	d) 16 amp SPN MCB 10 KA "D" series: 2 nos.	nos.	1		
	SITC of indoor cubicle type UPS panel suitable for operation on 415 volts 50 Hz, 3 phase 4 wire AC distribution system, AC supply, suitable for 35 KA short circuit rating, confirming to IP:42 degree of protection, made up of 1.6 mm thick CRCA sheet, wall/ floor mounted, dust & vermin proof enclosure, having hinged and earthed cover on front, having neoprene gasket/ katings stuck to the doors, duly painted with 65- 75 microns thick dry epoxy powder paint after 7 tank process of degreasing, derusting etc comprising of the following switchgears complete with all interconnections with suitable size of copper strip/hard drawn PVC insulated copper cable i/c keeping the panel in position, minor civil works as necessary, painting, sign writing etc complete as required. (as per specifications of				
	<b>INCOMING:</b>				
	a) 40 amp FP MCB 10 KA D series.: 1 no				
	b) 40 Amp Phase selector: 1 no				
	<b>METERING:</b>				
	a) Digital Volt meter displaying voltage with 3 nos HRC type protection fuse etc as reqd: 1 nos				
	<b>UPS INPUT &amp; OUT PUT</b>				
	1 no 40 A SPN MCB 10KA with 1 no 40 amp Industrial type socket out let and Top with connection for input switch from selector switch and between out put switch to o/g MCB with PVC insulated copper condtr wire as reqd: 3 sets ( for UPS input & Output from UPS)				
	<b>OUTGOINGS:</b>				
4	a) 40 amp SPN MCB 10 KA B Series: 2 nos	Nos.	1		
<b>TOTAL SUB HEAD-II</b>					
<b>SUB HEAD - III (SUPPLY OF FIXTURES &amp; FANS)</b>					
1	Supplying, installation, testing & fixing of 1x18-60W CFL/Bulk head Luminaries with tube/bulb (FL800/320) make PHILIPS / approved equivalent.	Each	6		
2	Supplying, installation, testing & fixing of stepped type electronic fan regulator on the existing modular plate switch box i/c connection but excluding modular plate etc as reqd.	Each	6		
3	Supplying, installation, testing & fixing of 1X20-24 W high quality LED luminaire of linear suspended / recess mounted /mounted on surface type of make- Philips / HPL/Wipro	Each	1		
4	Supplying, installation, testing & fixing (or suspended) of 1X36 W (TMS021 1XTL-D36-28W , MAKE-PHILIPS) tube light fitting powder coated batten with PC tube (1XTL-36W, MAKE-Philips)	Each	15		
5	Supplying, installation, testing & fixing of Exhaust fan 300mm sweep HEAVY DUTY EXHAUST approved equivalent.	Each	2		
6	Supplying, installation, testing & fixing of 1200 mm sweep energy efficient ceiling fan, connection with 1.5 sqmm PVC ins copper condtr, testing, commissioning etc as reqd.	Each	6		
7	Supplying, installation, testing & fixing of oscillating and tilting type wall bracket fan of 250 mm sweep i/c fixing the same on wall, connection with 1.5 sqmm PVC insulated copper conductor, testing, commissioning etc as required.	Each	4		
<b>TOTAL SUB HEAD-III</b>					

<b>SUB HEAD -IV (SUPPLY OF CABLE MAIN &amp; SUBMAIN)</b>					
1	Supply & laying for sub main from L.T line & DG line following sizes and core PVC/XLPE insulated PVC sheathed, heavy duty, armored electrical cable with copper conductor for working voltage up to and including 1100 volts.(Conforms to IS:1554,part-1) with 8 no. SWG die bare copper conductor wire for loop earthing, proper laying on wall or roof, thumbnail clipping and use proper size cable gland for cable sport etc. as required. all complete as per instructions of Elec.Er. / Architect.				
	(i) 35sq mm,3.5 core(L.T. Main)	Mtr.	35		
	(ii)16sq mm,4 core Copper conductor (For Main Line & D.G. Line)	Mtr.	25		
<b>TOTAL SUB HEAD-IV</b>					
<b>SUB HEAD - V (SUPPLY &amp; MAKING OF EARTHPIES)</b>					
1	Earthing with GI earth plate 600mm x 600mm x 6 mm thick accessories and pdg masonry enclosure with cover plate having locking arrangement and watering pipe etc ( but without charcoal or coke and salt) complete as required.	set	2		
2	Extra for using charcoal and sal for GI / copper earth plate electrode as required ( 96 Kg charcoal & 5 Kg salt)	set	2		
3	Providing & laying earth connection from earth electrode with 6 SWG dia GI wire in 15 mm dia. GI pipe from earth electrode as required.	Mtr	20		
4	S/L 6 SWG G.I.wire on surface or in recess as reqd.	Mtr	20		
5	Earthing with CU earth plate 600mm x 600mm x 3 mm thick accessories and pdg masonry enclosure with cover plate having locking arrangement and watering pipe etc ( but without charcoal or coke and salt) complete as required.	Set	2		
6	Extra for using charcoal and sal for GI / copper earth plate electrode as required	Set	2		
7	Providing & laying earth connection from earth electrode with 4 mm dia copper wire in 15 mm dia. GI pipe from earth electrode as required.	Mtr.	20		
8	S/L 4 mm dia copper wire on surface or in recess as reqd.	Mtr.	20		
<b>TOTAL SUB HEAD-V</b>					

<b>BILL OF QUANTITY</b>					
<b>INTERIOR WORKS FOR UCO BANK,KHAIRA BRANCH</b>					
<b>Sl. No.</b>	<b>DESCRIPTION</b>	<b>UNIT</b>	<b>QTY.</b>	<b>RATE</b>	<b>AMOUNT</b>
	Note-I: Anti-termite with Chloropyrphos of approved band and make to be done on all wooden surfaces.				
	Note-II: Wherever painting items are mentioned, these always include the base coats of primer required and a minimum of 2 coats of the Final paint. Anti-termite with Chloropyrphos of approved brand and make to be done on all wooden surfaces.				
1	<b>(FULL HEIGHT &amp; SOLID PARTITION)</b> Providing and fixing fullheight double skin partitions in cabins etc, with frames of 2" x 2" (finished size) seasoned hardwood members (hollock / malaysian sal) at max. intervals of 2'-0" x 2'-0" c/c with provision of bigger members at skirting, fixing to door frames, etc, all wood work to be treated with 1st quality anti-termite paint, and covered with 6 mm thick Plywood (Green,Century) covered with various finishing layers as per design and details including 1 mm thick laminate. (All visible wood to be of 1st quality "ghambhar") and shall be painted with Premium 1st quality paint / polished as per instructions of Bank. The partition above 3' ht shall have 8mm thick plain glass with CRYSTAL engraved etching film/ 8mm thk.plain glass panel as an insert with 3 1/4"x1" thk.beach wood (BW) beading with melamine spray polish including all hardwares etc. complete.				
	<b>IN SEMI-GLAZED FULL HEIGHT PARTITION</b> Providing and fixing fullheight double skin partitions The partition above 3' ht shall have 8mm thick glass with CRYSTAL engraved etching film/ 8mm thk.plain glass panel as an insert with 3 1/4"x1" thk.beach wood (BW) beading with melamine spray polish including all hardwares etc. complete.				
	Laminates shall have a number of horizontal / vertical grooves and the ply under such grooves shall be painted with approved colours.				

	Opening for communication / conversation shall be provided as required as per detailed design and nothing extra shall be paid / deduction for the same.				
	The height of the partition shall be measured upto the R.C.C. Roof, if applicable.				
	<b>All doors including sliding doors / openable doors, with all fittings including ISI Marked Floor Springs, Hinges, Bolts, etc., shall be included in the same price. Doors shall be of heavy sections matching the partition, and shall have 8.0 mm thick glass as per design.</b>				
	All items necessary for completing the above mentioned work are deemed to be included in the scope of work, whether or not they are specifically mentioned in the B.O.Q / tender documents / drawings.	S.Ft.	272.00		
2	<b>(HALF HEIGHT PARTITIONS-FULLY PANELLED- ( 4'6" HT)</b> Providing and fixing half height double skin partitions in cabins etc, with frames of 2" x 2" (finished size) seasoned hardwood members (hollock / malaysian sal) at max. intervals of 2'-0" x 2'-0" c/c with provision of bigger members at skirting, fixing to door frames, etc, all wood work to be treated with 1st quality anti-termite paint, and 6 mm thick Plywood (Greenply,Century) laminated/Plain covered with various finishing layers as per design and details including 1 mm thick laminate. (All visible wood to be of 1st quality "gamhar") and shall be painted with Premium 1st quality paint / polished as per instructions of Bank.				
	<b>Provide 12 mm thick glass (MODIGUARD/ASAHI) With Etching, above 3'-6" ht. and beading above in Manager Cabin.</b>				
	Ghambhar Frame shall be neatly painted / polished to a glossy finish with premium quality paint / polish. All necessary hardware such as hinges, bolts, etc, and any other hardware required for the wicket door, shall be included in the price.				
	Laminates shall have a number of horizontal / vertical grooves and the ply under such grooves shall be painted with approved colours.				
	Openings for communication / conversation shall be provided as required as per detailed design and nothing extra shall be paid / deduction for the same.				
	All electrical wires, accessories, telephone wires, etc, shall be run in the partition without any extra charges for the same.				
	All items necessary for completing the above mentioned work are deemed to be included in the scope of work, whether or not they are specifically mentioned in the B.O.Q / tender documents / drawings.				

	All exposed wooden surfaces are to be painted with Premium quality paint as per Specifications.	S.Ft.	102.00		
3	<b>(COMPUTER CASH AND CASH CAGE PARTITIONS - FRONT)</b> Providing and fixing cash cage glazed partition on top of cash counter facing the customer with 12 mm thick clear float glass (Modiguard) fixed in a frame of 2" x3" teakwood on all three sides, duly polished, all beading etc. as required, all cutting of glass as required, all complete. <b>(4'-6" high above cash counter)</b>	S.Ft.	22.00		
4	<b>(COMPUTER CASH AND CASH CAGE PARTITIONS - SIDES &amp; REAR)</b> Providing and fixing cash cage partition, as per specifications given in Item No. 1 above, modified in height and the openings required to suit the requirements of cash cages, with the exception that in addition to 5.0 mm glass, aluminium mesh shall be given in all cash cage partitions, etc, from 4'-0" to 7'-0", along with supporting members all doors, as per specifications given in Item No. 1 above, all hardware for doors excluding door closers, godrej night latches which shall be paid for separately, all complete. The front of the cash cage shall be done in a decorative design. <b>( Height= 7'-0")</b>	S.Ft.	77.00		
5	<b>(ALUMINIUM MESH ON TOP OF CASH CAGE)</b> Providing and fixing aluminium mesh cage on top of cash cage area, all complete with polished gambhar wood frame, duly supported at regular intervals to prevent sagging, all complete.	S.Ft.	30.00		
6	<b>(HYDRAULIC DOOR CLOSER)</b> Providing and fixing Hydraulic door closers of specified brand ( <b>Yale / Godrej, Everite Hyper or equivalent</b> ), all complete as per instructions of Architect / Employer.	Each	2.00		
7	<b>(LOCKS)</b> Providing and fixing " <b>Godrej Night Latch</b> " / " <b>Godrej Mortice Lock</b> " in required places, all complete with fixing, fitting, etc. <b>(For SW)</b>	Each	3.00		
8	<b>Planter</b> -size 1'6"x1'6"x1'3" with <b>19mm board BWR (Century / Green)</b> ,1mm laminated & 12mm rubber wood all as per design	NOS	0.00		

9	<b>(CASH COUNTERS)</b> Providing and fixing COMPUTER COUNTERS made out of 19 mm thick BWR Blockboard (Greenply,Century) and as per the attached drawing, all complete with 1.0 mm thick laminate (Greenlam/Century) on all visible surface, tabletops, customer top, etc, and all drawers etc. to be painter with 1 coat of primer and 2 coats of 1st quality enamel paint). 12 mm thick glass, MODIGUARD/ASAHI, branded, to be used in front. Keyboard Tray to be provided on telescopic channel Keyboard wristrest to be given. Drawer Slides on telescopic channel to be used for all drawers. All locks to be of Godrej / Linc. All drawers, cabinets, Keyboard, etc. to be lockable. Footrest to be provided.	R.FT.	4.50		
10	<b>(NOTICE BOARD)</b> Providing and fixing a notice board near the Waiting area, frame to be made of 1st quality hardwood, and infill of 12 mm thick 'Celotex, board, duly covered with "Matte" quality cloth of approved colour and make. Visible surfaces of Frame to be painted with "Premium 1st Quality Paint" in approved colour and shade, and internal frames and internal surface of celotex board to be painted with priming coat. The frame is to be securely fixed to the wall, all complete as per directions for the Architect / Employer. Size: 3'-6" x 2'-0".	S.Ft.	14.00		
11	<b>(EXECUTIVE TABLES)</b> Providing and Placing new executives tables alongwith matching credenza of plan size (basic) as given below and credenza of plan size as given below, table top to be made of 19 mm thick BWR Blockboard (Greenply,Century), edged with beading of 2" x 1-12" approx), cut to required shape, top of table to have 1.0 mm thick laminte, and teakwood beading to be polished to required colour and finish. Table to have a vertical modesty panel of 19 mm thick BWR Blockboard (Greenply,Century) laminated/Plain with laminate (1.0 mm thick) from the outer side and painted with minimum 2 coats of premium 1st quality paint on the inner side. Modesty partition to have 1st quality beading on top as per design and specifications and Quality Enamel paint over appropriate priming coat on the internal surface.				

	Laminate to have a no. of grooves as per design and drawings. A chest of drawers shall support the table on 1 side (except in the case of staff tables of 4'-0" width, where the table shall be supported on one side by the credenza unit) integrally connected to the modesty partition, made of 19 mm thick bwp commercial blockboard, drawers to slide on drawer slides (EBCO / Equivalent), and made of 19 mm thick grade bwp board for all sides and bottom cabinet shutters of 19 mm thick bwp board, cabinet hinges to be t-type, self closing, EBCO / Equivalent, all edges of all blockboard / plywood to be sealed with 1st quality teakwood edging, including blockboard members touching the ground.				
	Drawers and cabinet shutters to be laminated on all external surfaces with 1.0 mm thick laminate, and painted on all visible internal surfaces with premium 1st quality enamel paint as Specified above.				
	All drawers and cabinets (both in tables and credenza) to be provided with high quality 'Gogrej' locks, and high quality handles as per Item No. B above.				
	The other end of the table to be supported / integrated with a credenza unit of basic 2'-6" height, or as required, top, back and sides made out of 19 mm thick BWR Blockboard (Greenply, Century), top to be finished with 1.0 mm thick laminate and teakwood beading o/o 1" x 1", carved as per design, and finished as per table Specifications above.				
	Drawers and cabinets, cabinet shutters, etc. to be as described in table specifications above, including all finishing details, and one glazed cabinet shutter in 1st Quality Teakwood frame, finished with laminate also to be laminated with 1.0 mm thick laminate grooves as / design.				
	Keyboard unit as per design and specification to be included in the rate.				
a	Manager (5'-0" x 3'-0")	Each	1.00		
b)	Officer (4'6"x2'6")	Each	3.00		
d	Credenza (1'3"x3'0")	Each	3.00		
e	Credenza (1'3"x2'9")	Each	1.00		
e	Credenza (1'3"x2'6")	Each	1.00		

c)	Full Ht cabinet (7'0" Height)	SFT	0.00		
c)	Sill Ht cabinet (2'6" Height)	SFT	10.00		
12	<b>(SOFA)</b> Providing and Placing sofas of a contemporary design, the basic frame of which is to be made of 1st class hardwood, supports of 19 mm thick marine grade bwp plywood, covered with thick layers of hi-density foam, shaped to the required design, and covered with hi-quality fabric of the basic range of Rs. 250/- per metre. Each sofa seat to be approximately 2'-0" x 2'-0" in size, the overall sofa to be a highly luxurious look and feel, and to be comfortable to sit. <b>2 Seater sofa.</b>	Each	0.00		
13	Providing Factory Made Aluminium <b>Main Entrance Door</b> of INDAL / Jindal sections, minimum section thickness of 2.5 mm all complete with swing door, fixed portion all 12mm thick glass, coloured anodized / powder coated, with etching as per standard approved sections, all complete with all necessary hardware and fittings, including floor springs, door locks, etc.	S.Ft.	105.00		
14	<b>(SUGGESTION BOX)</b> Providing and fixing one suggestion box, made with 12 mm thick BWR ply (Green / Century) as per standard design and specifications of the Bank, fully complete, with enamel painting, lock, lettering on top, etc.	Each	1.00		
15	Providing and fixing wooden Cheque writing/slip rack projected/supported from wall 4'0" x 1'-3" and Slip rack below as per design with suggestion box, first aid box, suggestion box.	Each	1.00		
16	<b>(CHECK DROP BOX)</b> Providing and fixing one suggestion box, made with <b>12 mm thick BWR ply ( Green / Century)</b> as per standard design and specifications of the Bank, fully complete, with enamel painting, lock, lettering on top, etc.	Each	1.00		
17	Providing and fixing vertical blinds <b>(Vista, Universal or equivalent)</b> at conference hall and over window.	S.FT.	0.00		
	<b>TOTAL</b>				
	<b>Notes:-</b>				
	Contractor to Note that:-				
a)	<b>Make plywood - Century , Green , Make laminate - Green , century , sunmica</b>				
b)	Footrests to be provided (laminated) with each table / counter without any extra charges, @ 1 per person.				
c)	Extra members, wherever required for stability / otherwise, to be provided with the required finish without any extra charges.				

# NOTES

- All dimensions to be read not to be scaled.
- This drawing supersedes all other previous drawings.
- Dimensions are in inches except otherwise.
- This drawing should be read in conjunction with relevant structural drawing and any discrepancy noticed should be got clarified before execution.
- The drawing is the property of the architect.
- Any copying or reproduction of this drawing should only be done after a written permission of the architect.
- Any default is liable to be sued for the violation of the copyright act.

## AREA CALCULATION

## LEGEND:-

- FULL HT. PARTITION (SEMI-GLAZED & GLAZED)
- HALF HT. PARTITION
- FULL HT. PARTITION (SOLID)

## PROJECT

PROPOSED INTERIOR LAYOUT OF  
KHAIRA BRANCH

## CLIENT

UCO BANK

## DRAWN BY

NIRAJ KUMAR

## CHECKED BY

Ar. Surendra Kumar

## SCALE

NOT TO SCALE

## DATE

20-05-16

## REVISION

01/24-05-16

## SHEET TITLE

## DRAWING TITLE

INTERIOR LAYOUT

## STAMP

## ARCHITECT

**VastuKriti**

326, 3rd Floor, Adison Arcade,  
Fraser Road, Patna - 01  
Mo: - 9805282793  
email: - vastukriti326@gmail.com



architecture  
interior  
landscaping  
planning

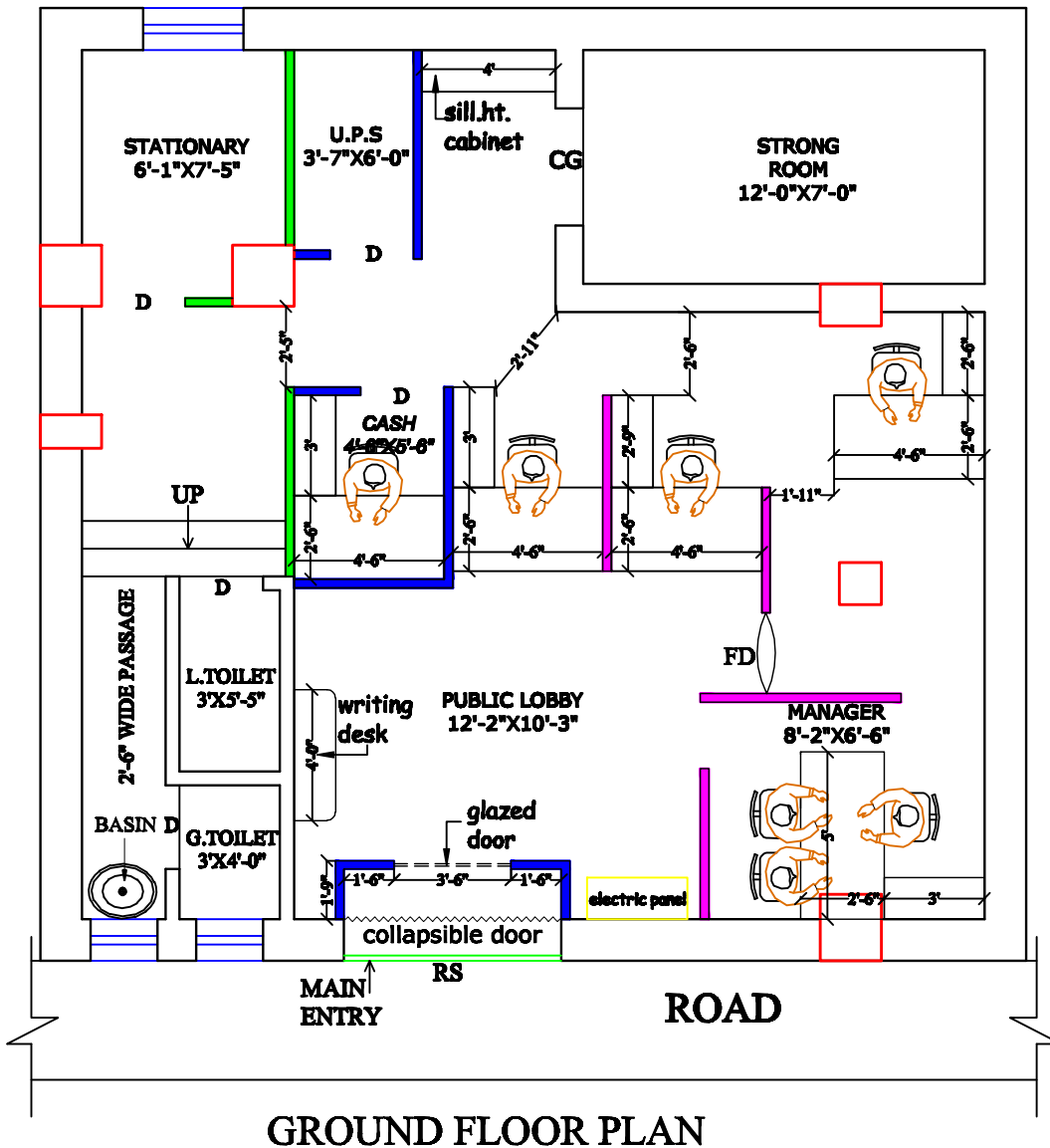

**GROUND FLOOR PLAN**

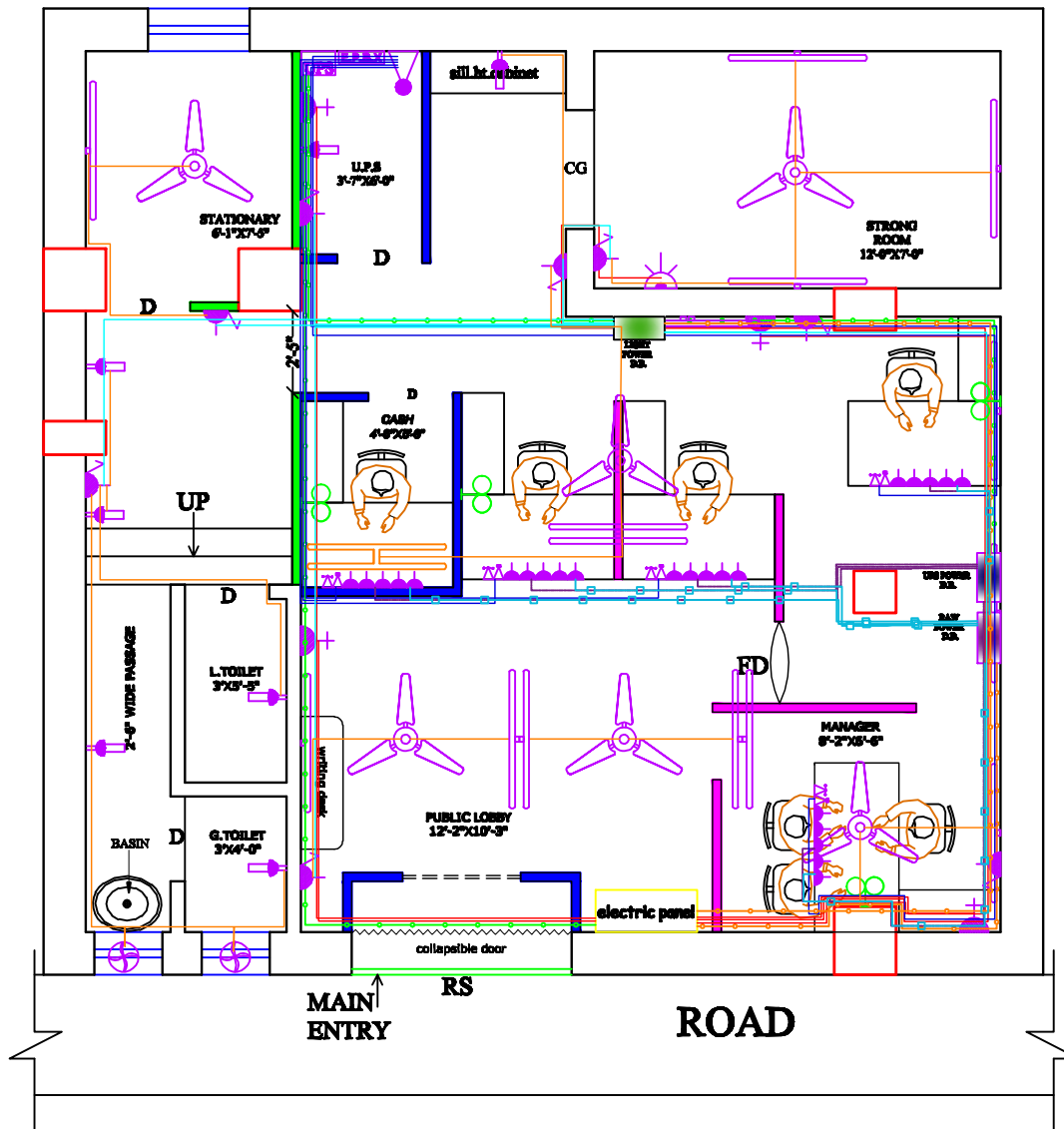

**GROUND FLOOR PLAN**

**NOTES**

- THIS DRAWING IS PROPERTY OF P.V.E. IT MUST NOT BE RETAINED, COPIED OR REPRODUCED IN ANY FORM WITHOUT WRITTEN PERMISSION OF P.V.E.
- USE ARCHITECTURAL DIMENSIONS FOR DETAIL DIMENSIONS.
- IN CASE OF ANY DISCREPANCY IN THIS DRAWING OR DIFFICULTY AT SITE THIS OFFICE SHOULD BE REFERRED.
- DIAMETER OF SUB MAIN CONDUIT IS 1" AND REMAINING ARE OF 0.75".

**SCHEDULE OF LEGEND**

SYMBOL	DESCRIPTION
	10/25 WATT CFL LIGHT
	EXHAUST FAN POINT
	NETWORKING HUB
	S.P.D.X (TELEPHONE HUB)
	2-00 WATT FLUORESCENT TUBE (TUBE LIGHT)
	30 WATT FLUORESCENT TUBE (TUBE LIGHT)
	CEILING FAN
	5/15 AMP. 3 PIN SWITCH & SOCKET
	WALL FAN POINT (5/15 AMP. 3 PIN SOCKET)
	20 AMP. A.C. POWER SOCKET
	15 AMP. 3 PIN POWER SOCKET
	SWITCH BOARD WITH 3 AMP. SOCKET
	DISTRIBUTION BOARD (LIGHT/FAN/UPS)
	L.T. MAIN CONTROL PANEL
	CALL BELL
	UPS PRIMARY & SECONDARY PANEL
	WAY FOR POINT WIRING
	WAY FOR NETWORKING & TELEPHONE
	WAY FOR SUB MAIN WIRING
	WAY FOR POWER POINT WIRING
	WAY FOR CIRCUIT WIRING
	WAY FOR RAW POWER WIRING
	WAY FOR UPS POWER WIRING
	WAY FOR POINT WIRING

**COMPUTER POINT DETAILS**

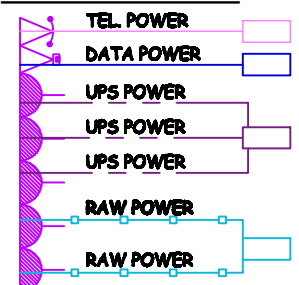

**PROJECT:**  
ELECTRICAL LAYOUT PLAN OF UCO BANK AT  
KHAIRA BRANCH)

**PROJECT TEAM:**

**SCALE:** N.T.S. **DATE:** 08.07.16 **DRAWN BY:** **CHECKED BY:**

**NORTH**

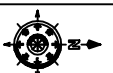

**ARCHITECT**

**VastuKriti**

326, 3rd Floor, Adison Arcade,  
Fraser Road, Patna - 01  
Mo :- 9905292793  
email :- vastukriti326@gmail.com



architecture  
interior  
landscape  
planning