



ZOL/GAD/2022-23/197

Date: 19.11.2022



UCO Bank
Zonal Office
B-1/122, 1st Floor, Vineet Khand
Gomtinagar, Lucknow – 226010
Phone-0522-493-7657, 0522-493-7661
Email - Zolucknow.gad@ucobank.co.in

RFP for renovation work at Aliganj Shopping Complex, Sector- B, Aliganj
Lucknow

Part – I (Technical Bid)

The information provided by the bidders in response to this RFP Document will become the property of the Bank and will not be returned. The Bank reserves the right to amend, rescind or reissue this RFP Document and all amendments will be advised to the bidders and such amendments will be binding on them. The Bank also reserves its right to accept or reject any or all the responses to this RFP Document without assigning any reason whatsoever.

This document is prepared by UCO Bank for renovation work at Aliganj Shopping Complex, Sector- B, Aliganj Lucknow. It should not be reused or copied or used either partially or fully in any form.



INDEX

Sl.No.	Particulars	Page No.
1	Notice Inviting Tender	1-3
2	Eligibility Criteria & Evaluation Criteria	4
3	REJECTION OF BID	4
4	GENERAL TERMS & CONDITIONS	5-15
5	ANNEXURE-I(DECLARATION)	16
6	ANNEXURE-II (TECHNICAL SPECIFICATION)	17
9	FINANCIAL BID-BOQ	18-48

Disclaimer

While the document has been prepared in good faith, no representation or warranty , express or implied, is or will be made, and no responsibility or liability will be accepted by UCO BANK or any of its employees, in relation to the accuracy or completeness of this document and any liability thereof expressly disclaimed. The RFP is not an offer by UCO BANK, but an invitation for bidder's responses. No contractual obligation on behalf of UCO BANK, whatsoever, shall arise from the offer process unless and until a formal contract is signed and executed by duly authorized officials of UCO BANK and the selected Bidder.



Notice Inviting Tender

- A)** UCO Bank invites sealed tender offers (technical and financial offer) from our empanelled contractors **for renovation work at Aliganj Shopping Complex, Sector- B, Aliganj Lucknow.**
- B)** The bidder (also called the vendor or bidder through this document) selected through this bidding process shall own the single point responsibility for fulfilling all obligations and providing all deliverables and services required for successful implementation of the project.

C) Salient Features

Tender Reference	ZOL/GAD/2022-23/151 dated 06.10.2022
Name of the work	Renovation work at Aliganj Shopping Complex, Sector- B, Aliganj Lucknow
EMD	<p>EMD: a) EMD of</p> <ol style="list-style-type: none"> 1) Rs.10,000/- for furnishing and civil work 2) Rs.5,000/- each for electrical and AC Works. <p>DD must be submitted with Technical Bid (Part-I) in the form of pay order /demand draft in favour of UCO Bank, payable at Lucknow.Not Applicable for MSME(Document related MSME to be furnished Under Part-I).</p> <p>b) EMD of unsuccessful bidders will be released (without any interest).</p> <p>c) EMD of L-1 bidders will be released (without any interest) after submission of Performance Bank Guarantee.</p> <p>d) However, if Successful tenderer withdraws their acceptance before completion of Work, UCO Bank will have the right to forfeit the Earnest Money Deposit without making reference .</p>



Last date and time for submission of tender	Off line original hard copy of Part-I and Part-II of tender document to be submitted by 24/11/2022 upto 17:00 hrs at UCO Bank, GAD, Lucknow Zonal Office, B-1/122, 1st Floor, Vineet khand, Gomtinagar, Lucknow – 226010
Date of opening of tender	25/11/2022 at 12:00 hrs
Time for completion	30 Days from issuance of work order
Address of communication	UCO Bank Lucknow Zonal Office General Administration Department B-1/122, 1 st Floor, Vineet khand, Gomtinagar, Lucknow – 226010
Email	Zolucknow.gad@ucobank.co.in
Phone No.	0522-4622973
Architect for technical clarifications and drawings	M/s Mohit and Associates Contact - 9582218092
Mode of submission	Offline hard copy
Contents of technical bid (Part-1)	<ul style="list-style-type: none"> a. Original Demand Draft of EMD (Not Applicable for MSME(Document related MSME to be furnished). b. Bidder's Covering letter (Annexure 1) c. Documents in support of all eligibility criteria e. All pages of this RFP as downloaded from the website should be duly signed by the authorized representative of the company on all pages including all Annexures.
Validity of tender	90 (Ninety) days from date of opening

D) Submission of tender

1. The envelope containing Part-I of tender should be super scribed clearly " Part-I (Technical Bid)" with the name of work and will be addressed to 'The Zonal Manager, UCO Bank Lucknow Zonal Office'



and must be submitted on or before the stipulated date & time of submission of tender.

2. The financial bid should be submitted in one big non window-envelope in the same envelope containing envelope of Technical Bid. The sealed envelope should be super-scribed as '**Renovation work at Aliganj Shopping Complex, Sector- B, Aliganj Lucknow**'.
3. The documents should be submitted to UCO Bank Lucknow Zonal Office General Administration Department ,B-1/122, 1st Floor, Vineet khand, Gomtinagar, Lucknow – 226010 within stipulated time frame.

E) Miscellaneous items

1. Vendor's representatives will be allowed to be present during opening of bids at their cost.
2. In case date of pre-bid meeting, last date of receipt or opening of tender are declared as holiday, the respective date shall be treated as deferred and will be re-scheduled to next working day correspondingly.
3. It may be noted that the requirement given in this RFP is indicative only.
4. Tenders/offers through email will not be accepted.
5. Bank reserves the authority to accept or cancel any or all tenders without assigning any reason.
6. All tenders in which any of the prescribed conditions are not fulfilled or are incomplete in any respect or there is any correction in Price Bid is not duly signed and dated by the bidder are liable to be rejected.

**Zonal Head
Lucknow Zonal Office**



Eligibility Criteria

1. The contractor must be empanelled contractor of Bank under Lucknow Zone.
2. The contractors empanelled in furnishing works are eligible to apply for civil works.
3. The contractor must apply only in that trade (furnishing, electrical or air conditioning works) in which he has been empanelled in the Bank under Lucknow Zone.

Evaluation Criteria

Lowest Bid Value will be evaluated on lowest price offered by the bidder against Financial Bid.

Rejection of Bids

The bid is liable to be rejected summarily if:

- i) Tenders are not received in two parts in separate envelopes.
- ii) It is not in conformity with the instruction mentioned in this tender document.
- iii) If it is not accompanied by requisite tender cost and EMD as stated above.
- iv) It is received after expiry of the due date and /or time.
- v) It is evasive and contains incorrect information.
- vi) If there is canvassing of any kind.
- vii) It is submitted anywhere other than the tender box or to the addressee.
- viii) If any indication of price/rate/charges is being found in Part-I of the tender.



General terms and conditions

1. Prices and taxes

- i) The price shall be firm and binding without any escalation throughout the contract period i.e (Till Completion of Work).The prices (in Indian Rupees) should indicate All-inclusive Price of the equipment [i.e. basic price, transportation, insurance (to cover equipment during the transit, installation at site and handing it over to the Bank), Duties, installation charges, comprehensive onsite warranty of one year covering all parts, consumables, labour etc]GST should be shown separately . If the Bidders fails to include them in the tender, no claim thereof will be considered by the Bank afterwards.

ii) Additional terms & conditions on GST

- Supplier/service provider to confirm that the GST amount charged in invoice is declared in its returns and payment of taxes is also made.
- The Supplier/ Service Provider agrees to comply with all applicable GST laws, including GST acts, rules, regulations, procedures, circulars & instructions there under applicable in India from time to time and to ensure that such compliance is done within the time prescribed under such laws. Supplier/Service Provider should ensure that accurate transaction details, as required by GST laws, are timely uploaded in GSTN1. In case there is any mismatch between the details so uploaded in GSTN by Supplier/ Service Provider and details available with UCO Bank, then payments to Supplier/Service Provider to the extent of GST relating to the invoices/s under mismatch may be retained from due payments till such time the accurate tax amount is finally reflected in the GSTN to UCO Bank's Account and is finally available to UCO Bank in terms of GST laws and that the credit of GST so taken by UCO Bank is not required to be reversed at a later date along with applicable interest.



- UCO Bank has the right to recover monetary loss including interest and penalty suffered by it due to any non-compliance of tax laws by the supplier/service provider. Any loss of input tax credit to UCO Bank for the fault of supplier shall be recovered by UCO Bank by way of adjustment in the consideration payable or otherwise.
- Supplementary invoices/debit note/credit note for price revisions to enable UCO Bank to claim tax benefit on the same shall be issued by Vendor for a particular year before September of the succeeding financial year.

The purchase order/ work order shall be void, if at any point of time Vendor are found to be a black listed dealer as per GSTN rating system and further no payment shall be entertained.

2. Terms of payment

Bank will not pay any advance. Final payment will be released against Vendor's bill after satisfactory completion of the project of the full quantity, subject to compliance of terms of contract by the contractor and statutory deductions as per Rule. Interim payment will be released after delivery of all materials at site. Minimum value of works for claiming interim payment will be Rs.10.00Lakh considering delivery of materials at site upon production of proper documentary evidence.

3. Defect liability period

Defect liability period will be 1 (One) year from the date of submission of payment recommendation from the Architect. The Bank will keep 10% of the bill recommended by Architect which will be released after defect liability period is over. The vendor will have to attend the entire defect arising during the defect liability period within 2 (Two) days from the date of reporting of such defect to the vendor. If the vendor fails to do so, the Bank will get the defects rectified from any other external agency and the cost of same shall be deducted from the retention money of the vendor.

4. Taxes and duties



The bidder will be entirely responsible to pay all taxes whatsoever in connection with delivery of the services at the sites including incidental services and commissioning. Wherever the laws and regulations require deduction of such taxes at the source of payment, Bank shall effect such deductions from the payment due to the vendor. The remittance details of amount so deducted and issue of certificate for such deductions shall be made by Bank as per the laws and regulations in force.

Nothing in the contract shall relieve the vendor from his responsibility to pay any tax that may be levied in India/abroad on income and profits made by the vendor in respect of this contract.

5. Clarifications on and amendments to RFP Documents

Prospective bidders may seek clarification on the RFP document by letter/fax/e-mail till the date and time mentioned in this RFP. Further, at least 7 days prior to the last date for bid-submission, the Bank may, for any reason, whether at its own initiative or in response to clarification(s) sought from prospective bidders, modify the RFP contents by amendment. Clarification /Amendment, if any, will be notified on Bank's website and such notification shall be deemed to be sufficient notice to all. No individual communication will be sent to any bidder in this regard. On the issue of any such notice regarding modification of contents of RFP, this RFP shall be read as if such modification were part of the original RFP.

6. Liquidated damages

In case of failure to complete the work within the stipulated period of time by fault of the successful vendors, liquidated damage @ 1% of the accepted contract sum for delay of each week or part thereof shall be recovered from successful vendors. The total of liquidated damage shall be subject to a maximum of 10% of the accepted contract value, accrual of which entitles us to rescind the contract.

7. Termination for default



Bank reserves its right to cancel the work/purchase order and/ or terminate this Agreement by giving 15 days prior notice in writing to the Vendor without prejudice to its rights and contentions available under this Agreement or under the Law (s) for the time being in force in the following circumstances:

- a) Unnecessary or unwarranted delay in execution of the work allotted.
- b) Delay in providing the requisite manpower at the Bank's site.
- c) The vendor violates any Laws, Rules, Regulations, Bye-Laws, Guidelines, and Notifications etc.
- d) Breach of trust is noticed during any stage of the consultancy assignment.
- e) The selected bidder commits a breach of any of the terms and conditions of the bid.
- f) The selected bidder goes in to liquidation voluntarily or otherwise.
- g) If it is found at any stage that the bidder has concealed any important information or has submitted any false information or declaration particularly regarding any pending legal action or blacklisting status.
- h) If there is any conflict of interest.
- i) If fails to complete the assignment as per the time lines prescribed in the Purchase order/ Agreement and/or within the extension, if any allowed.

In addition to the cancellation of work order/termination of the master contract, the Bank reserves the right to appropriate the damages from the earnest money deposit (EMD) provided by the selected bidder and/or forfeit the Performance Bank guarantee furnished by the vendor or otherwise. The Bank also reserves the right to recover any dues payable by the selected bidder from any amount outstanding to the credit of the selected bidder, including the pending bills and security deposit, if any, under this contract or any other contract/order.

Notwithstanding anything contained hereinbefore, Bank shall have the right to terminate the contract at any time at its own convenience by serving a prior written notice of 15 days to the vendor without assigning any reason and without cost or compensation thereof.



8. Date of commencement of work

The work shall be deemed to be commenced immediately from the date of receipt of work order. The work should be started in consultation with ZO-GAD.

9. Time for completion

30 Days from the stipulated date of issuance of work order.

10. Responsibility for completeness

Any supplies and services which might not have been specifically mentioned in this R.F.P/tender / contract but are necessary for the design, manufacture, supply, testing, handing over, operationalizing, performance or completeness of the contract, shall be provided / rendered by contractor preferably as per the time schedule for the efficient and smooth operation and maintenance of the system under Indian conditions. The approval by the Bank at any stage for any supplies by the vendor shall not relieve the vendor of his obligation.

11. Dispute resolution Mechanism

The Vendor and The Bank shall endeavor their best to amicably settle all disputes arising out of or in connection with the Contract in the following manner:

- a) The Party raising a dispute shall address to the other Party a notice in writing requesting an amicable settlement of the dispute within seven (7) days of receipt of the notice.
- b) The matter will be referred for negotiation between designated officials of the Bank /Purchaser and the Authorised Official of the Bidder. The matter shall then be resolved between them and the agreed course of action documented within a further period of 15 days.

In case any dispute between the Parties, does not settle by negotiation in the manner as mentioned above, the same shall be resolved exclusively by arbitration and such dispute may be submitted by either party for arbitration within 20 days of the failure



of negotiations. Arbitration shall be held in Lucknow and conducted in accordance with the provisions of Arbitration and Conciliation Act, 1996 or any statutory modification or re-enactment thereof. Each Party to the dispute shall appoint one arbitrator each and the two arbitrators shall jointly appoint the third or the presiding arbitrator.

The "Arbitration Notice" should accurately set out the disputes between the parties, the intention of the aggrieved party to refer such disputes to arbitration as provided herein, the name of the person it seeks to appoint as an arbitrator with a request to the other party to appoint its arbitrator within 45 days from receipt of the notice. All notices by one party to the other in connection with the arbitration shall be in writing and be made as provided in this tender document. The arbitrators shall hold their sittings at Lucknow. The arbitration proceedings shall be conducted in English language. Subject to the above, the courts of law at Lucknow alone shall have the jurisdiction in respect of all matters connected with the Contract/Agreement. The arbitration award shall be final, conclusive and binding upon the Parties and judgment may be entered thereon, upon the application of either party to a court of competent jurisdiction. Each Party shall bear the cost of preparing and presenting its case, and the cost of arbitration, including fees and expenses of the arbitrators, shall be shared equally by the Parties unless the award otherwise provides. The Bidder shall not be entitled to suspend the Service/s or the completion of the job, pending resolution of any dispute between the Parties and shall continue to render the Service/s in accordance with the provisions of the Contract/Agreement.

12. Governing Laws and Jurisdiction

This contract shall be governed by and construed in accordance with the Laws of India for the time being in force and all the dispute(s) or difference(s) arising out of or in connection with the contract shall be subject to the exclusive jurisdiction of the courts at Lucknow.



13. Notices

Notice or other communications given or required to be given under the contract shall be in writing and shall be faxed/e-mailed followed by either hand-delivery with acknowledgement thereof, or transmitted by pre-paid registered post or courier. Any notice or other communication shall be deemed to have been validly given on date of delivery if hand delivered & if sent by registered post than on expiry of seven days from the date of posting.

14. Publicity

Any publicity by the bidder in which the name of Bank is to be used should be done only with the explicit prior written permission of Bank. The Vendor shall not make or allow to make a public announcement or media release about any aspect of the Contract unless BANK first gives the Vendor its prior written consent.

15. Force Majeure

Force Majeure is herein defined as any cause, which is beyond the control of the selected bidder or BANK as the case may be which they could not foresee or with a reasonable amount of diligence could not have foreseen and which substantially affect the performance of the contract, such as:

1. Natural phenomenon, including but not limited to floods, droughts, earthquakes and epidemics.
2. Acts of any government, including but not limited to war, declared or undeclared priorities, quarantines and embargos.
3. Terrorist attack, public unrest in work area.

Provided either party shall within 10 days from occurrence of such a cause, notify the other in writing of such causes. The bidder or BANK shall not be liable for delay in performing his/her obligations resulting from any force majeure cause as referred to and/or defined above. Any delay beyond 30 days shall lead to termination of contract by parties and all obligations expressed quantitatively shall be calculated as on date of termination. Notwithstanding this, provisions relating to indemnity, confidentiality survive termination of the contract.



16. Confidentiality

The bidder must undertake that they shall hold in trust any Information received by them, under the Contract/Agreement, and the strictest of confidence shall be maintained in respect of such Information. The bidder has also to agree:

- To maintain and use the Information only for the purposes of this Contract/Agreement and only as permitted by BANK.
- To only make copies as specifically authorized by the prior written consent of Bank and with the same confidential or proprietary notices as may be printed or displayed on the original
- To restrict access and disclosure of Information to such of their employees, agents, strictly on a "need to know" basis, to maintain confidentiality of the Information disclosed to them in accordance with this Clause and To treat all Information as Confidential Information.
- Conflict of interest: The Vendor shall disclose to BANK in writing, all actual and potential conflicts of interest that exist, arise or may arise (either for the Vendor or the Bidder's team) in the course of performing the Service(s) as soon as practical after it becomes aware of that conflict.

17. Non Transferrable Offer

This Request for Proposal (RFP) is not transferable. Only the bidder who has purchased this document in its name or submitted the necessary RFP price (for downloaded RFP) will be eligible for participation in the evaluation process. There will not be any type of outsourcing.

The bidder should also submit an undertaking to the effect that he has not made any modification in the original copy of RFP and his bid would be liable for rejection for any violation of the above.

18. Period of validity of bid

Bids shall remain valid for Ninety days after the date of bid opening prescribed by BANK. BANK holds the rights to reject a bid valid for a period



Ninety days as non-responsive, without any correspondence. In exceptional circumstances, BANK may solicit the Bidder's consent to an extension of the validity period.

The request and the response thereto shall be made in writing. Extension of validity period by the Bidder should be unconditional and irrevocable. The Bid Security provided shall also be suitably extended. A bidder acceding to the request will neither be required nor be permitted to modify its bid. A bidder may refuse the request without forfeiting its bid security. In any case the bid security of the bidders will be returned after completion of the process.

19. Preliminary Scrutiny

BANK will scrutinize the offers/bids to determine whether they are complete, whether any errors have been made in the offer/bid, whether required technical documentation has been furnished, whether the documents have been properly signed, and whether items are quoted as per the schedule.

BANK may, at its discretion, waive any minor non-conformity or any minor irregularity in an offer/bid. This shall be final, conclusive and binding on all bidders and BANK reserves the right for such waivers.

20. No Commitment to accept lowest or any offer/bid

BANK shall be under no obligation to accept the lowest or any other offer received in response to this offer notice and shall be entitled to reject any or all offers without assigning any reason whatsoever. BANK has the right to re-issue tender/bid.

BANK reserves the right to make any changes in the terms and conditions of purchase that will be informed to all bidders. BANK will not be obliged to meet and have discussions with any bidder, and/or to listen to any representations once their offer/bid is rejected. Any decision of BANK in this regard shall be final, conclusive and binding upon the bidder.

21. Signing of the Bid

The bid shall be signed by a person or persons duly authorized by the Bidder with signature duly attested. In the case of a body corporate, the



bid shall be signed by the duly authorized officers and supported by internal corporate authorizations.

22. Subcontracting

The Bidder will not subcontract or delegate or permit anyone other than the Bidder personnel to perform any of the work, service or other performance required of the Bidder under this agreement without the prior written consent of the Bank and the bank's decision in this regard will be final and acceptable to the bidder.

23. Ownership and retention of documents

- BANK shall own the documents, prepared by or for the selected bidder arising out of or in connection with the Contract.
- Forthwith upon expiry or earlier termination of the Contract and at any other time on demand by BANK, the Vendor shall deliver to BANK all documents provided by or originating from BANK/ Purchaser and all documents produced by or from or for the Vendor in the course of performing the Service(s), unless otherwise directed in writing by BANK at no additional cost.
- The selected bidder shall not, without the prior written consent of BANK/ Purchaser store, copy, distribute or retain any such Documents.
- The selected bidder shall preserve all documents provided by or originating from BANK/ Purchaser and all documents produced by or from or for the Vendor in the course of performing the Service(s) in accordance with the legal, statutory, regulatory obligations of UCO BANK/Purchaser in this regard.

24. Bank reserves the right for following

Bank reserves its rights, without giving any reason whatsoever and without any cost or compensation therefore –

- Reject any or all proposals received in response to the RFP.
- Reject the proposals received in response to the RFP containing any deviation from the payment terms as stipulated in RFP.



- Waive or Change any formalities, irregularities, or inconsistencies in RFP. Extend the time for submission of proposal.
- Modify the RFP document, by an amendment that would be notified on the Bank's website.
- Modify the time period stipulated above for completion of assignment during the execution of assignment if it deems fit.

25. Forfeiting of EMD

The Bid security/EMD may be forfeited: -

- a) Bidder withdraws its Bid during the period of Bid validity specified in the RFP
- b) If it was found that the successful Bidder had made any statement or had enclosed any documentary evidence which turns out to be false/incorrect at any time till the bank's final settlement of the bills submitted by the bidder, for the audit assignment undertaken by the bidder.
- c) The bid security amount will be forfeited if the vendor refuses to accept work order or having accepted the work order fails to carry out his obligations mentioned therein.

26. Proposal Ownership

The proposal and all supporting documentation submitted by the bidders shall become the property of the Bank. The proposal and documentation may be retained, returned or destroyed as the Bank decides.

Zonal Head
Lucknow Zonal Office



ANNEXURE – I

To
Zonal Head
UCO Bank Zonal Office
Lucknow

Sir

1. We have carefully examined all the contents incorporated in the various parts of this Tender Document no dated and taken note of all the terms & conditions stated in the Tender Document in its various parts.
2. We hereby agree to abide by and fulfil all other Terms and Conditions of the Tender.
3. We also agree to keep the retention money clause as mentioned in the tender document.
4. The integrity and letter of undertaking and indemnity submitted by us during empanelment in Bank's list of empanelled contractors shall be binding on me during the course of this work.

For and on behalf of

(With seal)

Signature _____

Name _____

Designation _____

DULY AUTHORIZED SIGNATORY

_____ day of _____ 20



ANNEXURE-II
TECHNICAL SPECIFICATIONS
Approved Make

APPROVED MAKE OF MATERIALS		
1.	False Ceiling/Channels	India Gypsum/Armstrong/AMF/Saint Gobain
2.	Aluminium Framework/Aluminium Section	Jindal/Tata
3.	Wood Skirting/Moulding/Lipping/Beading	C P Teak
4.	Wood Preservative	STP Pentaphene Pale / Termiseal by PCI / Bison by British Paint
5.	Fire Retardant Paint	Industrial grades of Nobel/Viper
6.	Marine Ply with ISI:710 Mark	Green/Century/Sylvan
7.	BWP Block Board (IS:1659)	Green/Century/Sylvan
8.	Laminate (1 mm thick)	Merino Lam / Green lam /Century mica / Sun mica
9.	Door Closure (Heavy Duty)	Ebco / Ozone / Dorma / Godrej
10.	Door Lock	Godrej/Ebco
11.	Door Handles	Godrej / Hafele /Hettich / Ebco
12.	Drawer/Storage Handle	Godrej / Hafele /Hettich / Ebco
13.	Drawer/Storage lock (Multipurpose)	Godrej / Hafele /Hettich / Ebco
14.	Night latch	Godrej
15.	Screws	GKF/Nettle Fold
16.	Hinges	CIEF
17.	Sliding telescopic drawer channel	Ebco / Kombo / Earl Behari / Efficient Gadgets
18.	Cable Organiser	Ebco/Innofitt Systems (CM 63C)
19.	Adhesive	Fevicol SH / Araldite
20.	Soft Board	Jolly Board
21.	Vertical/Roller Blinds	Mac / Vista / Wincab
22.	Glass	Modiguard /AIS / Saint Gobain
23.	Paints (Synthetic Enamel / Acrylic Emulsion)	Asian Paints / Berger / Dulux
24.	PVC Flooring	Krishna Vinyl / Armstrong / Birla
25.	Texture Paint	Asian Paints / Berger / Dulux
26.	G I Pipe	TATA(Medium)/Jindal Steel
27.	Cement	Ultratech/Ambuja/ACC
28.	Vitrified tiles	Johnson/Kajaria/Nitco/ASL
29.	Ceramic Tiles	Johnson/Kajaria/Nitco/ASL
30.	ACP	Alucobond/Alstone/Eurobond
31.	Veneer (4mm)	Century/Ply
32.	All materials not covered above	As per sample approved by Bank/Architect



**UCO Bank
Zonal Office**

B-1/122, 1st Floor, Vineet Khand

Gomtinagar, Lucknow – 226010

Phone-0522-493-7657, 0522-493-7661

Email - zolucknow.gad@ucobank.co.in

RFP for Furnishing, Electrical and Air conditioning works at Bank's new Branch at B-1/35, Sector-L, Near Mama Chauraha, Aliganj Lucknow – 226024.

Part – II (Financial Bid)

In case of variation in technical specifications as provided by architect and that of bank the work will be done in accordance with technical specifications as given in annexure II.



BOQ of civil works

BOQ- CIVIL UCO BANK ALIGANJ

S.NO	DESCRIPTION	QTY.	UNIT	RATE (Rs.)	AMOUNT (Rs.)
A	CIVIL SCOPE OF WORKS				
	DISMANTLING & DEMOLITION				
1	Dismantling of the existing brick masonry walls and carting away the debris outside the premises to place not objected by the local civic authorities including all lead, lift, tolls, labour etc complete all as specified and directed by Officer in charge.	150	S.F.T.		
2	Dismantling marble, vitrified tile, ceramic tile flooring & dado including skirting and excavation up to 6" in plinth wherever required, etc. In a manner which facilitates laying of new flooring without undue extra expense. The rate shall include removal of debris from site.	150	S.F.T.		
3	Dismantling old plaster or skirting raking out joints and cleaning the surface for plaster including disposal of rubbish. The rate shall include removal of debris from site.	500	S.FT		
4	Dismantling and removing doors and windows wherever required in a manner which facilitates easy fixing of new doors and windows without undue expense. the rate shall include removal of debris from site.	1	NO		
5	Dismantling of the existing filled material (brickbat coba/Surkhi) of any description from sunken slab of washrooms and carting away the debris outside the premises to place not objected by the local civic authorities including all lead, lift, tolls, labour etc complete all as specified and directed by Officer in charge.	50	S.F.T.		
6	Taking out water closet (European type W.C. pan)/wash basin including take away from the site	2	L.S		
7	Dismantling and removing the Concealed water lines/sewage lines pipelines of any description, Water closet, washbasins, plumbing fittings etc from from the washrooms of following area and carting away the debris outside the premises to place not objected by the local civic authorities including all lead, lift, tolls, labour etc complete all as specified and directed by Officer in charge.				
a)	TOILET of Size (10 feet X 11 feet) - approx.	Per job	1.00		
8	Rendering in cement mortar 1:4, 20mm avg thickness as per site condition over brick/concrete surfaces and finishing the surfaces even and smooth using extra cement including necessary curing, etc., complete all as specified and directed by the Officer-in-charge. Note: The rate quoted for the item deemed to include for providing and removal of scaffolding wherever necessary.	300	S.FT		



9	Providing and Laying in position Plain Cement Concrete of mix 1:2:4 grade using 12mm/20mm downgraded granite aggregate of any description including necessary curing etc complete all as specified and directed by Officer in charge.	50	C.FT		
10	6" THK BRICK WALL WITH PLASTER for wall hung toilet Constructing 6" thk. Brick wall in 1:6 cement mortar. Brick used shall be of best quality kiln burnt, having sharp edges & giving clear ringing sound when struck against each other. The rate shall be inclusive of plastering the walls with ¾" thk. 1:4 cement plaster on both sides. A 4 ½" R.C.C. Patti Beam shall run horizontally @ 3'-0" c/c. The rate shall be inclusive of any scaffolding required, curing etc, complete.	50	S.FT		
11	PLASTERING (Additional Plastering / Repairing, patch up works) Providing and laying 12-15mm thick plaster in cement mortar 1:4:2 (1cement : 4 fine sand : 2 coarse sand) to all types of RCC work (small or big) brick/stone work surfaces including parapet, wall tops, jambs and cills etc.at all levels, in line, level and plumb as shown in detailed drawings, including smooth cement finish, as directed including providing necessary bands, drip moulds, tapak, grooves at all the junctions of walls and ceiling, walls and frames for doors or windows, around skirting/dado or at other places as directed, including raking the joints or roughening the RCC surfaces, necessary curing, scaffolding etc., complete as directed and specified. Finished rough to receive plaster of paris levelling coat. Complete.	500	S.FT		
12	WASH BASIN COUNTER (2'-0" WIDE) JET BLACK Providing and laying platform of 2'-0" width (clear) and at 2'-8" height (top) above ffl. Of approved 20mm thick granite with bull nosed edge. It shall be supported on wall as shown in the drg. Rate shall include the profile cutting and fixing of below counter wash basin and polishing the exposed edges of granite. A 2" granite fascia shall be provided below the nosed edge.	6	R.FT.		
13	DRAINAGE Providing & fixing PVC pipes of supreme/prince make or equivalent in position of required size with special fittings, traps, bends, ys, floor & nahni traps etc. Including chemical sealed joints as required at site making necessary connections with existing lines for w.c. & waste water lines, chambers to be constructed wherever necessary, unused lines for w.c. & waste water to be removed, the rate shall include all incidental work, cutting & making good walls & floors etc. Complete. Please visit the site for inspection.				
	3"	30	RFT		
	4"	50	RFT		



c	GULLY TRAP	4	Nos		
	SANITARY FIXTURES - LIGHT COLOURS (POPULAR COLOUR)				
	Providing & fixing following fixtures, the rate for the following shall be inclusive of all necessary fixtures, labour charges accessories & attachments to make then operational.				
	PARRY WARE MAKE complete with fitting				
14	Providing and fixing white vitreous china extended wall mounting water closet of size 780x370x690 mm of approved shape including seat cover, C.P. brass jet fittings, nuts, bolts and gasket Concealed wall tank etc complete. (Jaquar make : SLS-WHT-0117)	2	NOS.		
15	WASH BASIN - Indus basin - CTH - C0471 (White)	2	NOS.		
16	Providing and fixing 15 mm dia C.P. angle cock (heavy body) of approved make with C.P.wall frame with 15 mm connection pipe with material and labour complte as per direction of the Engineer-in-charge. (Jaquar make : FLR-5083N or equivalent)	6	NOS.		
17	Providing and fixing flush valves Jaquar make or equivalent with manually controled devise, 32 mm dia.(Jaquar make : FLV-1089DFP or equivalent)	3	NOS.		
18	Providing and fixing C.P. towel ring trapezoidal shape 215mm long, 200mm wide with a minimum distances of 37mm from wall face with concealed fittings arrangement of approved quality and colour. (Jaquar make : ACN-1121BN or equivalent)	2	NOS.		
19	Providing and fixing C.P. grating of approved for Nahani Trap with roun/square frame including providing and fixing Stainless Steel cockroach trap and fixing on tile/marble, including water proofing for the Nahani Trap etc. complete as per the direction of the Engineer-in-charge.	4	NOS.		
20	Providing and fixing liquid soap dispenser of staqndard size. (Jaquar make : ACN-1135N or equivalent)	2	NOS.		
21	Supplying and fixing brass chromium plated Swan neck Sink cock of first quality, approved brand, conforming to relavent IS, Manufactured by M/s parryware/Hindware/ESS ESS etc., complete all as specified and directed by Officer-In-Charge.	1	NOS.		
22	Supplying and fixing scratch proof stainless steel sink with drain board of size 1040mmX510mm and min depth of 200mm of first quality, approved brand, conforming to relevant IS, Manufactured by M/s Nirali including waste couplings to the new granite cooking platform. The sink shall be single bowl with waste couplings etc complete all as specified and directed by Officer in charge	1	NOS.		
23	Providing & Fixing mosquito Jalli for Window	300	SFT		
24	WATER PROOFING	200	S.FT		



	Providing & laying water proofing treatment, by applying cement slurry mixed with water proofing cement compound consisting of applying (a) first layer of slurry of cement @ 0.488 kg/ sq.m mixed with water proofing cement compound @ 0.253 kg/ Sq.m. This layer will be allowed to air cure for 4 hours. (b) Second layer of slurry of cement @0.242 kg/ Sq.m mixed with water proofing cement compound @ 0.126 kg/ Sq.m. This layer will be allowed to air cure for 4 hours followed with water curing for 48 hours. The rate include, preparation of surface, treatment and sealing of all joints, corners, junctions of pipes and masonry with polymer mixed slurry etc. complete.				
25	Supplying and laying flooring and skirting with 10mm or more thick, Vitrified tiles (Double charge/Multi colourprinting) of size 600 mm X 600 mm or bigger size of first quality, approved brand and shade/design, conforming to relevant IS, Manufactured by M/s Johnson/Kajaria/Nitco fixed with cement based high polymer modified quick-set tile adhesive in average 3mm thickness of first quality, approved brand conforming to relevant IS and joints neatly finished with colour matching pigment. The existing mosaic floor shall be properly hacked & cleaned before laying of tiles etc. complete all as specified & directed by Engineer-in-charge.(Basic cost of tiles shall not be less than Rs 120/Sft) Note: The rate quoted for the item deemed to include for a) slope corrections, wherever necessary b) wastages	1150	S.FT.		
26	CERAMIC TILE FLOORING (Anti skid) IN TOILET	150	S.FT.		
	Providing and fixing 12" x 12" Ceramic Tiles of approved make, quality & shade and pattern as shown in the drawing. In CM 1:4 in proper line and level. Rate shall be inclusive of providing and laying necessary PCC and Cement Mortar for a thickness of 3" and joint filling compound of the same shade of the tiles.				
27	WALL TILE DADO TOILET	400	S.FT.		
	Supplying and fixing glazed ceramic tiles dadoo tiles of size 450mmX600mm or bigger size of first quality, conforming to relevant IS, approved shade/design and colour, Manufactured by M/s.Johnson / Kajaria/Nitco fixed in cement slurry, over a backing coat of Cement mortar 1:4, 15 mm thick and curing. The joints shall be neatly finished with white/coloured cement using matching pigment and shall be neatly maintained etc., complete all as specified and directed by Officer-in-Charge. Note: The rate quoted for the item deemed to include wastages				
28	Supplying and fixing new 30 mm thick, polished Granite slab of approved shade/colour with bullnosed edges for Cooking platform/washbasin counter including cutting for provisions for fixing washbasin/ss sink etc., complete all as specified & directed by Officer in charge . Note: The rate quoted for the item deemed to include wastages	15	S.FT.		



29	Supplying and fixing 20mm thick, granite of approved colour(couple side polished) urinal partitions with edge round polished etc complete all as specified and directed by Officer in charge Note: The rate quoted for the item deemed to include wastages	6	S.FT.		
30	15mm DIA C.P.V.C. PIPE Providing & fixing 15mm dia CPVC pipes for distribution in toilets / pantry including chase cutting, chase filling. The rate shall include all accessories like tees, unions, elbows, bends etc. required to make the system operational and complete.	150	R.FT.		
31	32mm DIA C.P.V.C PIPE Providing & fixing 32 mm C.P.V.C pipes for distribution in toilets / pantry including chase cutting, chase filling. The rate shall include all accessories like tees, unions, elbows, bends etc. required to make the system operational & complete.	50	R.FT.		
32	MIRRORS IN TOILETS Providing and fixing 6mm thk. of approved make clear mirror (First Quality) on 12mm thk. Marine ply. Mirror shall have a frame of 25mm x 25mm steam beach wooden moulding finished in melamine. The rate shall be inclusive all necessary fixtures & fittings.	12.00	S.FT.		
33	PLASTIC EMULSION in white color Providing & applying plastic emulsion paint on walls, columns & ceilings. The rate shall include scrapping, levelling & preparing the surface. Primer coat + (minimum) 3 coats to get evenly spread quality finish (roller finish) of approved make, quality & finish shall be provided.	2500	S.FT.		
34	ENAMEL PAINT EXISTING DOOR WINDOW Providing & applying 1 st quality oil paint of approved make, quality & shade. The rate shall include scrapping, levelling & preparing the surface with primer quote.	350	S.FT.		
35	EXTERIOR EMULSION PAINT - UP to 10 feet Height				
a.	UP TO 10 FEET HEIGHT	300	S.FT.		
b.	ABOVE 10 FEET HEIGHT & SCAFFOLDING IS REQUIRED Providing & applying exterior grade emulsion paint of approved quality, make & shade, after scrapping the surface with wire brush & then applying (minimum) 3 coats of paint as directed by Bank / Architects.	750	S.FT.		



36	Providing and fixing scaffolding system (cup lock type) on the exterior side, made with 40 mm dia M.S. tube 1.5m centre to centre, horizontal & vertical tubes joining with cup & lock system with M.S. tubes, M.S. tube challies, M.S. clamps and M.S. staircase system in the scaffolding for working platform etc. and maintaining it in a serviceable condition for the required duration as approved and removing it thereafter .The scaffolding system shall be stiffened with bracings, runners, connection with the building etc wherever required for inspection of work at required locations with essential safety features for the workmen etc. complete as per directions and approval of Officer-in-charge. Note: a)The elevational area of the scaffolding shall be measured for payment purpose. b) The payment will be made once irrespective of duration of scaffolding.	2000	S.FT.		
37	Providing and fixing exterior side Heavy duty MS section 25X25X3MM for Window chajja 2.5' projected roofing made by TATA COLOURED GI SHEET inclding painting of MS SECTION with essential safety features for the workmen etc. complete as per directions and approval of Officer-in-charge.	90	R.FT.		
TOTAL FOR CIVIL WORK					

(Signature of bidder with seal)_____

Name _____

Designation _____

Note: The Bank reserves the right, neither to execute all items of work nor to execute the full quantity of items, as mentioned in schedule of quantities.



BOQ of furnishing work

S.NO.	DESCRIPTION	UNIT	QTY.	RATE	AMT
1	SUSPENDED FALSE CEILING				
1.1	FALSE CEILING (GYPSUM BAORD)				
	Providing and fixing Gypsum false ceiling as per drawing including of providing and fixing G.I. Frame work shall comprise of G.I. perimeter channel (MF-6A) of size 0.50mm thick having one flange of 19.6mm and another flange shall be of size 29.6mm and a web of 26.6mm along with perimeter of ceiling, screw fixed to the beam to the required curvature with nylon sleeves and screws at not exceeding 610mm centers. Then suspending G.I. intermediate channel (MF-7) of size 45mm, 0.9mm thick with two flanges of 15mm each bent to the required curvature by cutting both its flanges. Suitable bracing to be provided where ever the flanges are cut with 0.9mm G.I. Flat and nuts and bolts at specific positions and thereafter at 1220mm centers with ceiling angle of width 25mm x 10mm x 0.50mm thick fixed to soffit with G.I. cleats and steel expansion fasteners as per specification of India gypsum at a distance of 2'0" c/c both ways complete with 12.5mm board and all necessary perimeter channels etc.	Sq.Ft.	400.00		

	<p>The joints to be properly mended with paper tapes and gypsum compound all complete. The boards are to be jointed and finished which includes filling and finishing the tapered and square edges of the boards with jointing compound and fiber tape suitable for Gypsum board. A layer up to of 3.00mm thickness of Veneer Plaster is applied followed by two coats of topcoat (primer) at the face of board to give smooth seamless finish. 2 or more coats of plastic emulsion paint (roller finish) of approved shade and make shall be applied. The rate should include the full completion of the ceiling. At the time of handing over the site all necessary repairing work to be considered if required. The work to be completed as per specification, approval of the bank. No Drop or design (if any) will be considered as extra measurement it will be considered flat ceiling. (Only plan area to be measured for payment). No extra payment will be made for the cutting of light points, stain glass, cove lighting etc. The measurement will be taken in one level, rate should include the drops also, no extra amount will be paid for the drops.</p>				
1.2	<p>FALSE CEILING (ARMSTRONG CEILINGS – FINE FISSURED MICROLOOK EDGE WITH SILHOUETTE GRID (BLACK REVEAL)</p>				
	<p>Providing and fixing false ceiling system manufactured by M/s. Armstrong World Industries using hot dipped galvanized steel section, rotary stitched main tee of size 15mm x 42 mm web height, having 0.36 mm gauge at every 600 mm centre to centre maximum and rotary stitched cross tee of size 15 mm x 42 mm, having 0.33 mm gauge at every 600 mm. c/c. and wall angle of size 19 x 19 mm., having 0.35 mm gauge fixed to the periphery of the wall. The above grid is suspended at every 600mm c/c. in both directions using 2.0 mm. thick pre-straightened GI wire laying FINE FISSURED MICROLOOK WITH SILHOUETTE GRID (BLACK REVEAL) ceiling tiles manufactured by M/s. Armstrong World Industries, of size 600mmx600mmx15mm</p>	Sq.Ft.	452.00		



	having NRC 0.55, Light reflectance of >84% (WT), thermal conductivity k = 0.052-0.057 W/m0K, Humidity Resistance of 99% , having Fire Performance CLASS O / CLASS 1 (BS 476), surface having 3 coats of white paint with Fine Fissured, back of the tile duly sanded and finished with a coat of protective paint over the formed grid complete.(Branch & ATM) .				
	TOTAL OF SUSPENDED FALSE CEILING				
2	PARTITIONS WORK				
2.1	FULL / LOW HEIGHT SOLID PARTITION	Sq.Ft.	270.00		
	Full ht. Solid Partition including flush door & strong room partition up to 7' only WITH LOUVRE :- Providing and fixing solid partition , the framing shall made out of aluminium hollow section of 65mm x 37mm size 1.5mm thick of JINDAL / INDAL as internal frame structure placed horizontally & vertically at max distance of 2'-0" x 2'-0" center to center. Fixing 6 mm thick commercial ply on both sides with 1.0mm thick laminate on top of approved shade with groove pattern as per instructions of Architect. The rate shall include the cost of providing skirting of 100mm wide lined with 1mm thk laminate and providing & fixing a border at top of 100mm wide lined with 1mm thk laminate complete. Laminate Should be considered up to two or three color combination. The edge beadings with steam beach wood should be finished with melamine polish if required, frame work above false ceiling done shall not be measured but contractor may factor it while quoting there rates as measurment up to false ceiling lvl..				



	The rate inclusive of providing & fixing of required flush door of 37mm thick approx. with 1.0mm th.laminate both side with steem beech wood chowkhat of size 75mm x 65mm approx and Item includes Heavy-duty SS ball bearing butt hinges 100 x 5.5 mm (4 Nos. per shutter) with screws etc.The shade of laminate finish to be got approved from Bank. . All as per the design and instructions Bank.				
	Note :- For the purpose of payment partition shall be measured including the area of door/door frames up to false ceiling heaight.				
	Framework shall be regidly secured to floor, bottom of slab & existng walls at 2'-0" c/c with dash fasteners.				
2.2	Single skin partition	Sq.Ft.	0.00		
	As of the above but Providing and fixing single skin partition above false ceiling(where false ceiling is provided only on one side) for a height of up to 600mm or near about soffit of roof using aluminium frame as specified above along with 6mm thick Commercial ply wood lined on only one side and lining with 1mm thk laminate of approved shade and amke along with grooves.				
2.3	Full height Glazed partition manager cabin	Sq.Ft.	165.00		
	Same as of Solid ht. partition , providing 8mm thick Modi/saint Gobin float glass above 1'-0" / 3'-0" & up to 7'-0" fixed with steam beech wood beading of finished size 1 1/2" X 1" all along the edge. All edge-to-edge glass joint to be machine cut and polished and sealed with silicon sealant. joint shall be located strictly as shown in the drawing. All exposed woodwork to be mealamine polished. Item includes frosted/striped/designer glass film of 3m, Avery Dennison or equivalent (basic rate of Flim Rs. 50/ Sq.ft.) on existing glass as per manufacturer's specifications. All as per the design and instruction Bank.				
2.4	Single window Partitions cash cabin	Sq.Ft.	140.00		



	Providing and fixing in position Double skin partition 7'-0" height. The framing shall be made out of aluminium hollow section of 65mm x 37mm size 1.5mm thick of JINDAL / INDAL as internal frame structure placed horizontally & vertically at max distance of 2'-0" x 2'-0" center to center. Fixing 6 mm thick commercial ply on both sides with 1 mm thick laminate of approved colour and shade as per approval of the Architect. The partition to include 8 mm. thick Modi Float glass with etching on the sides and back including a door 3'-0" wide as per the approval with all necessary hardware, night latches etc. All exposed edges to be covered with steam beech wood Beading, 4mm grooves in places as per design duly melamine polished inclusive of all materials, hardware, night latches, labour, T&P, taxes, levies, etc. completed to the satisfaction of the bank & drawing.				
2.5	Low. Height Semi Glazed Partition	Sq.Ft.	20.00		
	Same as above but of Low height as per design including 10mm Toughened glass with edges polished to be used. All other specs are same as of above, Edges of the partition to be covered with 3" X 1.5" Steam beech wood duly melamine polished moulding. 38mm thick flush door: wicket gate also shall be included for a measurement. All as per the design and instruction bank.				
2.6	Front Glazing In head cash cabin & SWO	Sq.Ft.	20.00		
	Providing & fixing 10mm thick toughened clear float glass to shape for front side of the cash counters including cutting the holes and providing & fixing TW beading polished and tinted to approved shade. (including SWO/Chief Cashier front Glass).				
2.5	Used Existing partition from old branch with relamination work / resize as per above specification including transportation	Sq.Ft.	87.00		
	TOTAL OF PARTITIONS WORK				
3	DOOR & ACCESSORIES				
3.1	Main Entrance Door & Fixed glazing	Sq.Ft.	28.00		

	Providing and fixing toughend glass door shutters of 12mm thickness in opening of glazed partitions with stainless steel patch fittings of approved make (DORMA/ DLINE / GEZE or approved equivalent) including heavy duty double action floor-spring with steel cover plate of approved make, pull handle SS brushed finishes 24" long thick 25mm on both sides of door shutters, locking arrangement of Dorma / D Line or equivalent or better quality as approved by Engineer-in-charge. Exposed edges of glass shall be machine cut & polished. Cost includes cutting and making good the floor, walls, ceiling etc. for fixing floor spring and patch fittings. All complete as per approval of the Architect.				
3.5	Supplying and fixing of Dorma/GEZE Dline / Hardwyn/Godrej or approved equivalent Door Closer for wooden door for Branch manager, Banking hall, Chief Cashier , Dinning ,UPS,Toilet	Nos	4.00		
3.6	Supplying and fixing of mortice door lock of hardwyn make HML-480 Lock Body 304 Stainless Stell. (in BM Cabin , Store room 0. Cash cabin shall be Godrej Night latch.(atm 1 No.)	Nos	3.00		
3.7	Supplying and fixing of door stopper SS Grade 304, HESSF-2C hardwyn make.	Nos	4.00		
	TOTAL OF DOOR & ACCESSORIES				
4	WORKING COUNTER				
4.1	CASH COUNTERS	Rft.	4.50		
	Providing and fixing Chief Cash Counter in split-levels @ 2'-6" (height 750mm) & 18" (1140mm) with 2'-6" & 15" wide each respectively . Upper levels having 12mm thick frosted toughened glass (i/c taxes and transportation). Edges of 18" wide counter shall be 12mm thick frosted toughened glass. Lower tier shall be made of 19 mm thick ply wood finished in 1.5mm thick laminate. Exposed edge having steam beech wood edging of size 1 ½" x 1". Vertical face shall have 12mm thick frosted toughened glass as				



	per requirement of design. All exposed surfaces shall be finished with 1.0mm thick laminate of approved shade and colour.				
	1 no. prefabricated metal computer key board tray including drawer slides 12.5" x 22" tray with 14" telescopic slides including L – brackets for securing to the table top. Chest of drawers (size 1'-4" x 2'-0" x 2'- 5") made of 19mm thick commercial ply wood having three drawers finished with 1.0mm thick Laminate on all sides. Each drawer shall have locking system and 6" long S.S. brushed finished handle, drawer slides etc. of approved make. All exposed edges of ply wood sealed with Steam beech wood beading of size 1/4" x 3/4". All beading and exposed wood shall be melamine polished and the Internal surfaces shall be .75 mm thick laminate. Item includes readymade metal powder coated CPU trolley, grommet, footrest for each seat. All complete as per approval and instructions of the Architect / employer. The rate also include providing and fixing painting a foot rest using hard wood 100 x 25mm size 1st class seasoned country frame.				
	Payment will be made only on the centerline measurement. The rate shall include the cost of providing skirting of 100mm wide lined with 1.0mm thk laminate and providing & fixing a border at top of 100mm wide lined with 1.0mm thk laminate complete. the Internal surfaces shall be .75 mm thick laminate.				
4.1a	Used Existing Counter from with relamination work / resize as per above specification	Rft.	4.50		
4.2	RUNNING COUNTER	Rft.	15.00		

	Providing and fixing staff counter/SWO in split-levels @ 2'-6" (750 mm) & 3'1" with 2'-6" (750 mm) & 9" wide each respectively . Upper levels having 1 mm thick laminate with 19 mm thick commercial ply top. Lower tier shall be made of 19mm thick ply wood and finished in 1 mm thick laminate. Working top having steam beech wood edging of size 1 ½" x 1". Vertical face shall have 19 mm thick commercial ply over pine wood framework as per requirement of design. All exposed edges of ply wood sealed with Steam beech wood beading of size ¼" x ¾". All exposed surfaces shall be finished with 1.0mm thick laminate of approved shade.				
	The item includes Chest of drawers (size 1'-4" x 2'-0" x 2'-5") made of 19mm thick commercial ply wood having One drawers at top and a storage cabinet below having shutters of 19mm thick ply wood finished with 1.0mm thick Laminate on all sides. 1 no. prefabricated metal computer key board tray including drawer slides 12.5" x 22" tray with 14" telescopic slides including L – brackets for securing to the table top for each seat. All beading and exposed wood shall be melamine polished and the Internal surfaces shall be .75 mm thick laminate. Item includes 1'-3" high 12mm thick toughened glass above upper tier and readymade metal powder coated CPU trolley, grommet, foot rest for each seat. All complete as per approval and instructions of the Architect / employer. The rate also include providing and fixing painting a foot rest using hard wood 100 x 25mm size 1st class seasoned country frame. Payment will be made only on the centerline measurement.				
	The rate shall include the cost of providing skirting of 100mm wide lined with 1.0mm thk laminate and providing & fixing a border at top of 100mm wide lined with 1.0mm thk laminate complete.				
4.2a	Used Existing Counter from with relamination work / resize as per above specification	Rft.	15.00		
	TOTAL OF WORKING COUNTER				
5	TABLE & FURNITURE				



5.1	MANAGER TABLE (Size:- 5'-6" x 2'-6") ht. 2'-6"	Nos	1.00		
	Providing and fixing tables made out of 19 mm thick commercial ply over hard wood frame work finished with 1 mm thick laminate of approved shade. Top having steam beech wood edging of size 2" x 1 3/4". 10mm thick clear float glass with beveled edges shall be provided on the finished to 19mm thk Comm.ply wood of approved make clad with 1mm thk. laminate(color with vertical grain) as per design in all visible areas. All the exposed edges to be covered with wooden steam beech lippings and mouldings duly malamine polish. The drawers to be made out of 19mm thk ply wood with 1.0 mm laminate finish in the front , and bottom to be made out of 6mm plywood and it should play in drawer sliding telescopic channels. The inside of the drawer shall be .75 mm thick laminate. & Table back side will be 1mm laminate. A leg rest to be provided duly polished made out of 3"x2" Wooden Section.The rate inclusive of providing & fixing wooden cabinet to suit the DVR for size 2'X6"X1'9" or as per the requirements)				
	A shutter to be made by 19mm ply wood clad with 1.0mm laminate .The necessary locks handles to be provided in each drawers and shutters. 3" x 1/2" wooden skirting to be provided in all visible areas duly polished. The necessary wire managers(SS) to be provided on the tables and provision for lights to be kept if required in the front of the table. All the exposed areas to be duly malamine polished The work to be completed as per design and approval of the Bank. The table should have key board tray and CPU Trolley to be Modular. All as per the design and instructions Bank the Internal surfaces shall be .75 mm thick laminate.				
5.3	Officer TABLE (Size:- 5'-0" x 2'-6") ht. 2'-6" as per above specification	Nos	1.00		
	without glass top & drawers				
5.5	Used Existing Table with relamination work / resize as per above specification	Nos	1.00		
	TOTAL OF TABLE & FURNITURE				
6	STORAGE & SIDE UNIT				

6.1	Side and Back Unit				
	Providing and fixing Side Unit/ Back unit 400 mm depth made out of 19mm ply wood finished with 1.0mm laminate in all exposed areas and top shall be 1 mm thick . The drawers to be made out of 19mm commercial plywood and clad with 1.0mm laminate and bottom made out of 6mm comm ply duly painted in matching tone and it should play on drawer sliding channels . The shutters to be made out of 19mm commercial ply wood and should play on drawer sliding castors on powder coated channels. The necessary locks , handles, etc to be provided . 3" x1/2 wooden skirting to be provided duly polished as per matching tone all along the visible areas . Inside of the unit shall be .75 mm thick laminate. in matching tone . All the exposed edges of the boards/ply woods to be covered with woden lippings/mouldings duly polished all complete. The work to be completed as per approval and specification of the Architect.	Nos	2.00		
6.2	Low HT cabinet	Sq.Ft.	32.00		
	Providing and fixing Full /Low height Cabiner400mm deep made out of 19mm thk plywood finished with 1.0mm laminate in all exposed areas . The Shutter to be made out of 19mm ply wood in the front clad with 1.0mm laminate(color, vertical grain) . and bottom made out of 6mm plywood duly painted in matching tone and shelves 19mm thk comm ply wood to fixed inside storage. The shutters to be made out of 19mm ply wood . The necessary locks , handles, etc to be provided . 3" x1/2 wooden skirting to be provided duly polished as per matching tone all along the visible areas . Inside of the unit shall be .75 mm thick laminate finish . All the exposed edeges of the boards/plywoods to be covered with wooden lippings/mouldings duly polished all complete.All as per the design and instructions Bank.				
6.3	Main Electrical Panel Cabinet	Sq.Ft.	40.00		



	Providing and fixing of DB Shuttering formed of 12mm thk plywood wood on 12mm thick Gypsum board (fire Proof) with finish as per Item no 1 for inside and out side shutters finished with laminate on outer surface with SS (4Nos) louvre perforation and necessary hardware, hinges etc complete as per details. All as per the design and instructions Bank. Only front face used for measurement only				
	TOTAL OF STORAGE & SIDE UNIT				
7	OTHER MISCELLANEOUS ITEMS				
7.1	PIN UP / NOTICE BOARD				
	Providing and fixing soft board with necessary framework with 12mm BWR plywood on top 12 jolly board to be fixed finished with fabric @Rs80 , with necessary mouldings duly polished along the periferi. All as per the design and instructions Bank.	Sq.Ft.	24.00		
7.4	WRITING LEDGER & Cheque & sugestion box	NO	1.00		
	Providing and fixing writing ledge as per design minium 5 ft length made out 19mm comm. board with necessary grove patterns with 1.0mm laminate. 10mm thk machine polished glass to be provided on top of the writing ledge. Small boxes to be made out of 12mm comm. ply to be made on top of the writing ledge finished with 1.0 mm laminate, inside surfaces shall be .75 mm thick laminate. and rate should be included providing fixing of sugestion box & Cheque deposit box as per approval of bank .The work to be completed as per design and approval of the architect.				
7.5	Outer Shutter Boxing				
	Overhead outside shutter box: p/f sal wood frame fixing of 12mm plywood with 1mm thk. Laminate finish and openable shutter for out side area inside shall be 2 coat enamel paint with primer	Sq.Ft.	40.00		
7.6	WOODEN COLUMN PANELLING	Sq.Ft.	50.00		



	Fabricating and fixing wall/column paneling, the framing shall made out of aluminium hollow section of 65mm x 37mm size 1.5mm thick of JINDAL / INDAL at spacing not exceeding 600mm bothways (horizontal and vertical). Paneling framework to be secured to wall surface/column surface. Paneling framework to be clad on one side with 9mm thick ply finished with 1.0mm thk laminate including skirting of 100mm high & 12mm x 12mm groove at skirting level. All as per the design and instructions Bank.				
7.8	Customer Table - (4'-0" X 2'-6")	No	1		
	Providing and making a table of over all size of top as mentioned above. It shall consist of 3/4" thk. Comm. Ply top as per design (double edge on outer edge with 1 1/2" thk half moulding on the edges) supported on 3/4" thk. Comm. Ply verticals supported on wooden base (as designed by the architect). Suitable wooden moulding as architect design with mellamine shall be provided to the edge of the top. All external surfaces to be finished in 1 mm laminate. & the Internal surfaces shall be .75 mm thick laminate.				
	TOTAL OF OTHER MISCELLANEOUS ITEMS				
	GRAND TOTAL FOR FURNISHING				
	* GST EXTRA AS APPLICABLE				

(Signature of bidder with seal) _____

Name _____

Designation _____

Note: The Bank reserves the right, neither to execute all items of work nor to execute the full quantity of items, as mentioned in schedule of quantities.



BOQ of electrical work

SL No	PARTICULARS	UNIT	QTY	RATE	AMT
1	ELECTRICAL WIRING & EARTHING				
1.1	Supply,laying,connection & testing of light,fan point, wiring by 2x1.5mmsq(2x3/.029) +1x1mmsq PVC insulated, multistrand single core copper conductor FRLS wire maintating the colour code as per direction in PVC conduite of 20mm with ISI mark 1.5mm thickness to conceal in wall partition mending good the damage, complete with PVC circular box, bend to be done as per drawaing including 3 point ceiling rows wherever required GI saddle to be used for fixing,metal flexiable/PVC flexiable pipe may use if requied in partition wall. All PVC pipes should be with ISI mark. No joints will be allowed inside pipe,light, fan & plug point complete with modular type switch plate & MS box . rate Including the main circuite line 2x2.5mmsq+1x1.5mmsq earth PVC insulated Cu. Wire from DB to switch board ,maintaining the colour code. Circuite line for lighting switch board & 6Amps plug board are to be drawn from lighting DB to Lighting board & plug point board (independent), 6/16 Amps plug point line are to be draw from power DB.as per DBschedule /SLD				
a)	1 light by 1 switch	Nos.	19		
b)	2 light by 1 switch	Nos.	28		
c)	3 light by 1 switch	Nos.	0		
e)	Ceiling fan point with step type electronic regulator	No	1		
f)	Same as above, but for exhaust fan excluding regulator.	No	2		
g)	Same as above 5A Point in the switchboard itself. (for branch 4 No & ATM 1 No)	No	6		
h)	same as above Wiring for call-bell point including buzzer	No	1		
i)	Wiring (2x2.5mmsq+1x1.5mmsq from power DBs) for independant 6A multi pin socket at walls along with 6A modular type switches board housed in painted MS box (upto 3 independent plug points can be taken in one circuit). For wall Fan	No	8		



1.2	Supply and installation of modular type 2 nos 6A & multi pin sockets with 2 nos 6 Amp one way switch housed in MS box to be fixed in partitions or concealed in wall. The box shall be painted with 2 coats of enamel paint over a coat of red oxide primer including wiring for Raw power socket outlet using 2 R runs of 2.50 Sqmm and single run of 1.5 sqmm PVC insulated multi stranded single core copper conductor FRLS wire in 20mm PVC conduit to be laid in floor, partitions, etc. complete with all accessories (looping 2 sets of 2x6A socket outlet in one circuit- from DB) (Raw power). for counter (Each counter 1 Nos +BM :2 Nos, ATM 1No.,Pantry 1No.:)	No	7		
1.3	Supply and installation modular type 16A, 5-pin socket with 16A one way switch housed in MS box to be fixed in partitions or concealed in wall. The box shall be painted with 2 coats of enamel paint over a coat of red oxide primer , the rate shall include wiring fusing 2R 4.0 sqmm & single run of 2.5 sqmm PVC insulated multi stranded single core copper conductor FRLS wire in 25mm PVC conduit to be laid in floor, partitions, etc complete with all accessories (for line printer : or optional).(upto 2 independent plug points can be taken in one circuit) C.C :1No. BM.:1 No.: Alternative counter 2No + Banking Hall 1 No+ Pantry 1No ,ATM :1No)	Nos.	7		
1.5	Acs electrification :-				
(a)	Supply and fixing 25 Amps 3-pin modular socket with 25 Amp one way switch with indicator (near AC indoor unit) housed in manufacturers MS powder coated box to be concealed in wall including Wiring using 2R4.0 sqmm & single run of 2.5 sqmm PVC insulated multi stranded single core copper conductor FRLS wire in 25mm PVC conduit to be laid in floor, partitions, etc complete with all accessories. (for split AC units) -(from Stabilizer to IDU)Supply. (2 Nos for ATM), Stabilizer to be installed in the panel room.	Nos	4		
(b)	Supply and fixing 25 Amp - 3 pin metal clad socket with plug controlled by a 25 Amp SP MCB (for Ac wall mounted stabilizers) housed in manufacturers MS powder coated box to be concealed in wall including Wiring using 2R 4.0 sqmm & single run of 2.5 sqmm PVC insulated multi stranded single core copper conductor FRLS wire in 25mm PVC conduit to be laid in floor, partitions, etc complete with all accessories. (for split AC units) from AC DB to stabilizer (2 Nos for ATM)	Nos	4		



2	LAYING OF CABLE :				
2.1	Supply laying fixing main power with 50mm sq 3.5 core PVC insulated,PVC sheated Alu.Conductor, 1100 v. grade armoured cable complete with 02 nos 8 SWG bear Gl.wire as running earth .(Meter panel to Main Panel & Dgset to Main Panel)	Mts.	15		
2.2	End termination of 50mmsq 3.5 Core armoured cable,complete with brass cable gland , Alu. Lug, PVC tape.	Nos	4		
2.3	- Do - 3.5 x 16 sqmm with 02 nos 8 SWG bear Gl.wire as running earth. for Light D.B	Mts	10		
2.4	- Do - 3.5 x 25 sqmmth with 02 nos 8 SWG bear Gl.wire as running earth. for POWER & A.C D.B , UPS & ATM	Mts	10		
2.5	- Do - termination of 25 & 16 Sqmm 3.5 Core	Nos	8		
3	Out door type glow sign board wiring :-				
3.1	Supply laying of main line with 2x2.5 +1x1.5 mmsq through MS conduite from main panal to glow sign board.	Mts	25		
3.2	Supply installation of 16 amps DP MCB at main entrance Glow sign board & With Electronic timer as required.	Set	1		
4	EARTHING STATION :				
(i)	Earthing installation as per I.E. rule conforming	Set	2		
	Supply, Installation, Testing and Commissioning of Maintenance Free Earthing system made up of copperbonded rod of 10 feet length,23 mm dia. (Minimum copper bonding shall be 0.25mm) along with Rod-toConductor connectors, Earth enhancement material, Pit Cover and other accessories as required and as per specification and other applicable codes (include chamber for earthing, Earthing certificate to be submitted along with the bill).				
(ii)	Supply laying 2x8SWG copper bear wire from earth spike to main panal.(Electrolite wire)	Mts	20		
5	MAIN ELECTRICAL DISTRIBUTION				
5.1	Main Panel (wall Mounted Type)				



	Supply & erection of 6way Electric panel made of 16 gauge M.S sheet with double coated painting consisting 3No (4x40)mm copper strips of suitable length for 200 Amp current rating with supply & erection of followings I) 63Amp TPN switch 1No make HPI/Havells/standard with HRC fuses II) 63 Amp D.P change over switch 1No III) 63A Rotary switch -1No IV) 10 Amp SP MCB-6No v) Three phase indicator NOTE- Cost of connection of 3 Phase energy meter is including in the job & All internal wiring in D.B Should be 10Sq mm wire.	Set	1		
	POWER DB & AC DB. Make standard/Legrand/ABB ,Double door				
	6 way TPN MCB DB with TP MCB as incoming				
	63 TP&N MCB as main				
	16Amps SP MCB - 8 Nos (Ac :3 Nos + 2X6amp : 4Nos and 1Nos spare) +32AMPS SP X10 NOS. (Ac 3 Nos+15 Amp: 6 Nos, 1No Spare)				
5.3	including Neutral Bar. 01 Set	Set	1		
	LIGHTING DB Make standard/Legrand/ABB				
	6 way TPN MCB DB with TP MCB as incoming				
	63A TP&N MCB as main				
	32 AMPS DB MCB 1No: For Strong room)				
	16 Amps SP MCB - 03 Nos.+ (BM +Toilet) each 1No + 1No spare				
	12 Amps SP MCB - 12 Nos. (Hall - 4Nos + Store room 1 No +Exteranl Lighting 1No.:+ Ups 1No + wall Fan 3 Nos.2 No spare)				
5.4	Including Neutral Bar. 01 Set	Set	1		
6	UPS SYSTEM (Branch)				
6.1	UPS Main DB Supply, erection, testing and commissioning of three phase 4 WAY, TPN MCB DB double door type with "C" Curve MCBs, IP 42 powder coated for UPS with 63A 4P MCBs – 1No as INCOMER 32A TP MCBs – 3 Nos. as OUTGOING (UPS :2Nos and 1 set ,: Spare Including all interconnections & accessories etc Make standard/Legrand/ABB	Nos	1		
6.2	Supply & Fixing of 32A DP MCB in 2way SPN Db IP 20 metallic directly on wall Raw power Incoming & OutGoing supply for UPS (Branch :2 Nos)	Nos	2		
6.3	UPS DB-1 & 2 combined				



	12 Way SPN MCB DB with 'C' curve MCBs. Incoming : 2 No. 40A DP MCB Outgoing : 8 Nos 6/10A (BM: 1+1 Nos with lighting : Server & Data Rack (1+1) Nos:C.C 2Nos with lighting :counter :2 Nos) SPO MCBs Make standard/Legrand/ABB . Repective UPS lighting to be connected.(BM,C.C,Banking hall 2Nos) or as per SLD	Nos	1		
6.4	Supply and installation of modular type 3 nos 6A multi pin sockets with 2 nos 6A one way switch with indicator housed in MS box to be fixed in partitions or concealed in wall. The box shall be painted with 2 coats of enamel paint over a coat of red oxide primer including making connections complete the rate inclusive of Supplying and running of 3 runs of 2.5 sq.mm UPS DB's to individual powerstation through .(looping 2 sets of 3X6 A socket outlet in one circuit / or as per SLD the following size of 660 volts grade, Finolex brand PVC insulated wire (For UPS point only).(For B.M,C.C,Sever each 2Nos.) +5 Nos for Counter+Rack 1Nos)	Nos	10.00		
6.5	Supply and Installation of Moduler type 2 X 20A plug & socket housed in for UPS output control	Nos	3.00		
6.6	Supply & Laying of 2 runs of 4.0 Sqmm and 1 run of 2.5 sqmm, PVC insulated, single core, multistranded copper conductor cable in suitable rigid / flexible metal conduitfrom 3 KVA UPS to UPS DB	mtr	10.00		
	sub total I	-		-	-
		-		-	-
8	ELECTRICAL FITTINGS (\$/I/T/C				
8.1	Supply and Installation Recess mounted 2'-0"X2'-0" watt ,38 W LED FULL GLOW Philips MAKE . Light should be fixed through SS threaded bolt tighted the upper end on ceiling using anchor bolt and lower end on Light fitting with nut and bolt (RC380B G2 LED35S-6500/4000 PSU OD WH) PHILIPS/WIPRO MAKE	Nos.	12		
8.3	SQUARE SHAPE DOWNLIGHTER - INTEGRA 15W, 3000K, LHEBGTP5Z1W015, PHILIPS Razor/WIPRO MAKE	Nos.	28		
8.4	TUBELIGHT - TITANIA SLEEK NEW LED TUBELIGHT 36 W, PHILIPS/WIPRO MAKE.	Nos	3		
8.5	HANGING LIGHT - LHECDOL5PW1W040 (40WATTS), PHILIPS/WIPRO MAKE	NOS.	4		
8.6	150 mm dia Heavy Duty Exhust fan 230 voltA.C.(Havells / Crompton make). (UPS & Toilet)	Nos	2		



8.7	Wall mountaing fan 400 mm dia 230 volt A.C. PHILIPS/WIPRO MAKE	Nos.	8		
8.8	Supply of Ceiling fan with 1200mm sweep, double ball bearing motor, capacitor, three MS blades die cast Al housing in stove enameled white with, suspension rod including all accessories of approved make.(5 star rated) (ORIENT/KHAITAN).(UPS,Strong room & Store room)	Nos.	1		
	SUB TOTAL				
	SCHEDULE - (LAN & TELEPHONE WORK)				
S.NO.	DESCRIPTION	UNIT	QTY.		
1.0	TELEPHONE SYSTEM				
1.1	Wiring for telephone points with 2 pair 4/5 pair .51mm dia ATC (annealed tinned Cu wire) with PVC insulated PVC sheathed telephone cable from tag block to the point including providing ferrules at both ends and termination at both ends including providing & fixing RJ 11 outlet, faceplate and mounting box complete of modular type 9 where 2 such points are shown, 2 such wires shall be provided) This work includes providing PVC conduits in chases from the raceway to the point. (1 each for branch manager, C.C. P. officer & Clerck). separate IO box to be provided for Telephone	Nos.	2		
1.2	Supplying, laying effecting terminations, testing and commisioning of 0.51mm dia Cu. Conductor, twisted, colour coded with polythene capor barrier, telephone cables in the existing tray or in conduit including providing & fixing conduit pipe or cable tray as required from building tag block to the floor as required.				
a	0.5mm , 5 pair armoured telephone cable from telephone connection in the premises to the crone box.	rmt	1		
b	Supplying & fixing 20 pair krone tag block with enclosure.	Nos.	1		
2.0	DATA SYSTEM - CONDUITING & CABLING				



2.2	Wiring for computer networking from I/O hub to computer workstation with UTP Cat-6 computer cable including providing ferrules at both ends and termination at both ends including providing & fixing frame for with shutter, RJ 45 outlet, faceplate and mounting box complete of modular type, This work includes providing PVC conduits (1/2", 3/4" size or as required) in chases from the I/O hub to the point. The cost includes testing, commissioning etc complete. Note : Do not run more than 3 wire in single pipe & should be concealed. (Server,BM,CC & ATM each 2Nos and counter 5Nos)	Nos.	10		
2.3	Supply of Cat - 6 D-Link patch cord 7' 0" (ATM 1No)	Nos.	10		
2.4	Supply of Cat - 6 D-Link patch cord 3' 0" (ATM 2No)	Nos.	10		
2.5	Supply & fixing 24 Port Jack Panel Make:-D-Link	Nos.	1		
2.6	19" Rack 9U with Glass Door , Locking system Make: APW	Nos.	1		
2.7	24PORT 10/100Mbps Switch	Nos.	1		
GRAND TOTAL FOR LAN & TELEPHONE (C)					
TOTAL FOR ELECTRICAL WORK					
GST (@18%)					
Total with GST					

(Signature of bidder with seal) _____

Name _____

Designation _____

Note: The Bank reserves the right, neither to execute all items of work nor to execute the full quantity of items, as mentioned in schedule of quantities.



BOQ of Air conditioning works

S.NO.	DESCRIPTION	UNIT	QTY.	RATE	AMOUNT
	(AIR CONDITIONING WORK)				
1	Supplying, installation, testing and commissioning of 3-Star rated as per 2021 version Hi-wall split air conditioner of following capacity with On Off Timer along with wireless remote controller including providing and laying the standard length of 5 m copper, electrical and 25mm dia heavy duty PVC drain piping with all necessary fittings duly insulated with 9mm thick nitrile rubber pipe insulation including Initial refrigerant charge suitable for 5 Mtrs distance between IDU and ODU along with drilling the holes and packing and making good the damaged surfaces good comprising and 5 mtr Condensate drain pipe as specified spec of the following:- i) Indoor unit consisting of evaporator coil, blower fan with motor, filters, insulated drain pan control panel with cabling between control panels and units etc ii) Outdoor unit consisting of hermetically sealed Rotary Compressor to operate on 230 V, Single Phase, 50 Hz AC Supply, Anti Corrosive Coated Condensor Coil with fan and motor, interconnecting refrigeration piping, starters/controls/cutouts/relays etc., mounted inside a powder coated sheet metal cabinet duly treated for corrosion protection. the rate included interconnecting cable from indoor unit to outdoor unit (APPROVED BRAND :DAIKIN,BLUE STAR,CARRIER,HITACHI,O GENERAL)				
B	3-Star rated Hi-wall split air conditioner of 1.5 TR capacity*blue Star/Hitachi/Carrier	Each	4		
C	3-Star rated Hi-wall split air conditioner of 1.0 TR capacity	Each	0		
2	Charges for providing additional copper pipes (one circuit) for the above split units with necessary insulation and with adequate pvc insulated copper wire	Rmt	30		



	from indoor to outdoor units concealed and taken through beyond the standard 5 mtr length.				
3	Charges for providing additional 25 mm dia heavy duty PVC drain piping with all necessary fittings duly insulated with 9mm thick nitrile rubber pipe insulation drain pipe concealed / surface mounted and taken through wall / partition beyond the standard 5m length for the above split units.	Rmt	35		
4	Supply, installation, testing and commissioning of wall mounting 4KVA stabilizers for 1.5Tr & 1.0Tr Hi-Wall Split Air Conditioning units with input voltage range of 170-270 Volts and output 220 +/- 10% as required.	Each	4		
6	Providing and fixing standard powder coated support brackets & including grille gauge with locking arrangement for the above split / cassette units including fasteners and other accessories as required.				
a	For split air conditioner	Each	4		
7	Supplying and fixing 0-24 hrs electronic timer with 2nos 25A SP MCBs, 2 nos 25A TP contactors completely wired housed in a suitable powder coated enclosure with hinged door and mounted on wall with all interconnections. (for ac units in System Room)	No	0		
	TOTAL				
	GRAND TOTAL				
	NOTE :- GST TAX WILL BE EXTRA.				

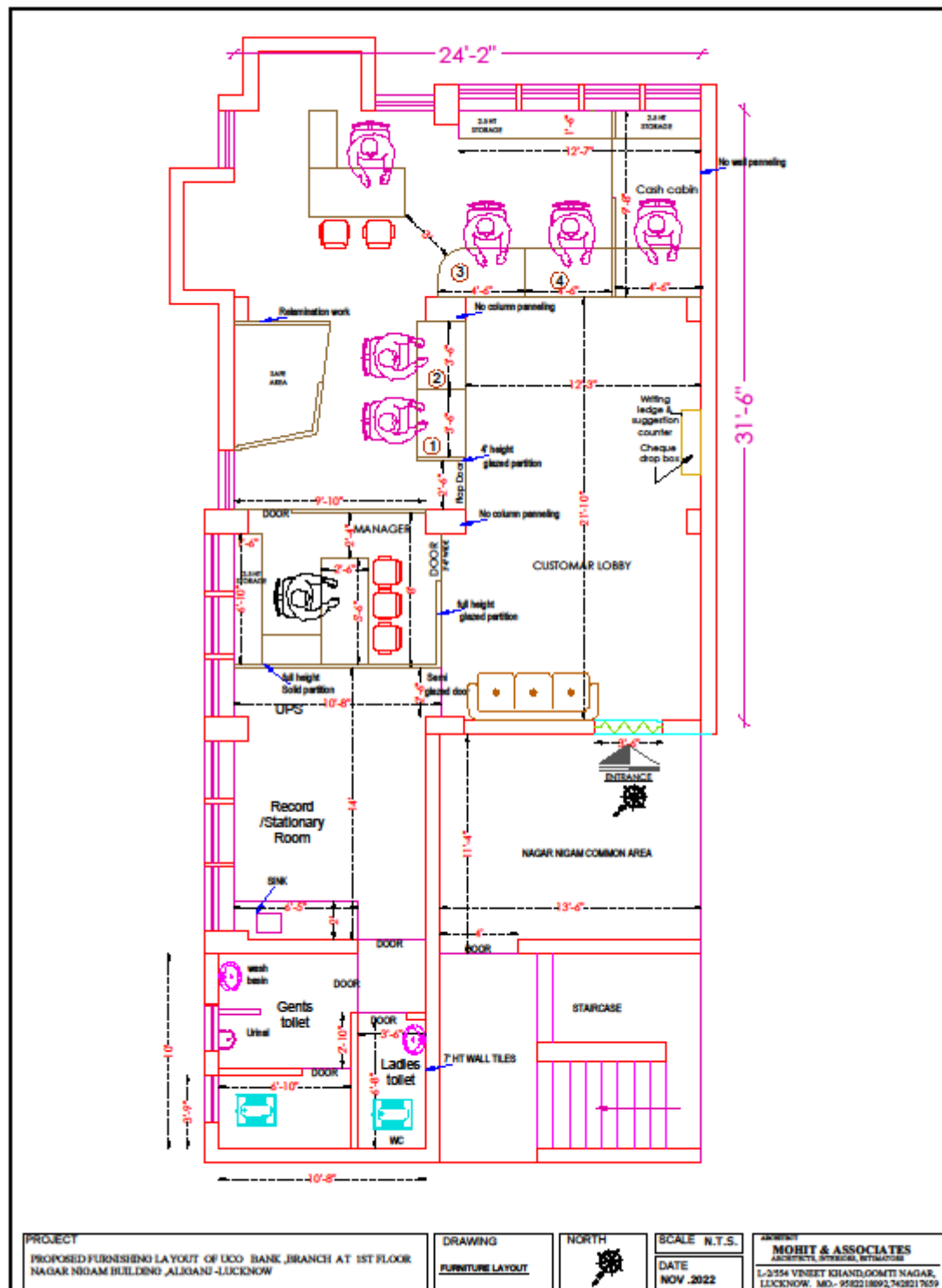

Furnishing layout

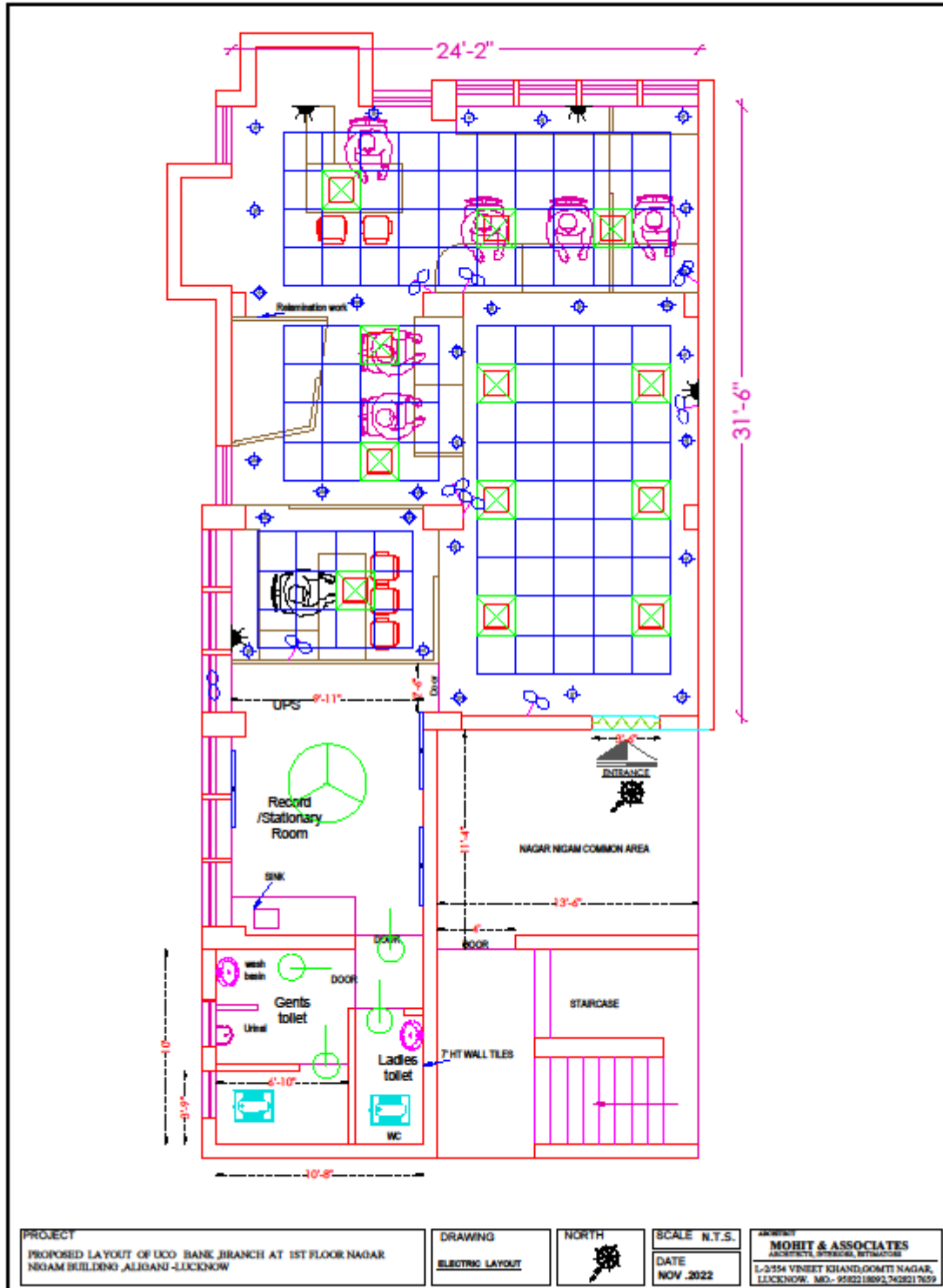

Electric Layout

