



ZOK/GAD/2022-23/424

Date: 30.12.2022



UCO Bank
Zonal Office
75/4 Siddhi Sadan
Halsey Road, Kanpur – 208001
Phone-9454385520, 9334414353
Email - zokanpur.gad@ucobank.co.in

RFP for Furnishing, Electrical & Air Conditioning works at Bank's new Branch at Sipri Bazar, Jhansi (U.P.) under Kanpur Zone.

Part – I (Technical Bid)

The information provided by the bidders in response to this RFP Document will become the property of the Bank and will not be returned. The Bank reserves the right to amend, rescind or reissue this RFP Document and all amendments will be advised to the bidders and such amendments will be binding on them. The Bank also reserves its right to accept or reject any or all the responses to this RFP Document without assigning any reason whatsoever.

This document is prepared by UCO Bank for Interior Furnishing, electrical works at Bank's new Branch at Sipri Bazar, Jhansi (U.P.) under Kanpur Zone. It should not be reused or copied or used either partially or fully in any form.





INDEX

Sl.No.	Particulars	Page No.
1	Notice Inviting Tender	1-3
2	Eligibility Criteria & Evaluation Criteria	4
3	REJECTION OF BID	4
5	ANNEXURE-I(DECLARATION)	5
6	ANNEXURE-II (TECHNICAL SPECIFICATION)	6
7	FINANCIAL BID-BOQ	7-31

Disclaimer

While the document has been prepared in good faith, no representation or warranty, express or implied, is or will be made, and no responsibility or liability will be accepted by UCO BANK or any of its employees, in relation to the accuracy or completeness of this document and any liability thereof expressly disclaimed. The RFP is not an offer by UCO BANK, but an invitation for bidder's responses. No contractual obligation on behalf of UCO BANK, whatsoever, shall arise from the offer process unless and until a formal contract is signed and executed by duly authorized officials of UCO BANK and the selected Bidder.



Notice Inviting Tender

UCO Bank invites sealed tender offers (technical and financial offer) from our empanelled contractors for Furnishing and Electrical works at Bank's new Branch at **Sipri Bazar, Jhansi (U.P.) under Kanpur Zone.**

A) The bidder (also called the vendor or bidder through this document) selected through this bidding process shall own the single point responsibility for fulfilling all obligations and providing all deliverables and services required for successful implementation of the project.

B) Salient Features

Tender Reference	ZOK/GAD/2022-23/424 dated 30.12.2022
Name of the work	Furnishing, Electrical & Air Conditioning works at Bank's new Branch at Sipri Bazar, Jhansi (U.P.) under Kanpur Zone.
EMD	<p>EMD: a) EMD of</p> <ol style="list-style-type: none"> 1) Rs.10,000/- for furnishing work 2) Rs.5,000/- each for electrical & AC works. <p>DD must be submitted with Technical Bid (Part-I) in the form of pay order /demand draft in favour of UCO Bank, payable at Kanpur. Not Applicable for MSME (Document related MSME to be furnished Under Part-I).</p> <p>b) EMD of unsuccessful bidders will be released (without any interest).</p> <p>c) EMD of L-1 bidders will be released (without any interest) after submission of Performance Bank Guarantee.</p> <p>d) However, if Successful tenderer withdraws their acceptance before completion of Work, UCO Bank will have the right to forfeit the Earnest Money Deposit without making reference.</p>



Last date and time for submission of tender	Off line original hard copy of Part-I and Part-II of tender document to be submitted by 02/01/2023 upto 16:00 hrs at UCO Bank, GAD, Kanpur Zonal Office, 75/4 Siddhi Sadan, Halsey Road, Kanpur -208001
Date of opening of tender	Technical and financial bids to be opened on 02.01.2023 at 17:00 hrs.
Time for completion	10 Days from issue of work order
Address of communication	UCO Bank, Kanpur Zonal Office General Administration Department 75/4, Siddhi Sadan, Halsey Road, Kanpur-208001
Email	zokanpur.gad@ucobank.co.in
Phone No.	9454385520, 9334414353
Architect for technical clarifications and drawings	M/s Bharat and Associates Contact - 9919877410
Mode of submission	Offline hard copy
Contents of technical bid (Part-1)	a. Original Demand Draft of EMD (Not Applicable for MSME (Document related MSME to be furnished)). b. Bidder's Covering letter (Annexure 1) c. Empanelment Letter suitable for the said category Issued by any of our Zonal office.
Validity of tender	90 (Ninety) days from date of opening

C) Submission of tender

The envelope containing Part-I of tender should be super scribed clearly " Part-I (Technical Bid)" with the name of work and will be addressed to 'The Zonal Manager, UCO Bank Kanpur Zonal Office' and must be submitted on or before the stipulated date & time of submission of tender. The financial bid should be submitted in one big non window-envelope in the same envelope containing envelope of Technical Bid. The sealed envelope should be super-scribed as "Furnishing, Electrical works at Bank's new Branch at Sipri Bazar, Jhansi (U.P.) under Kanpur Zone.



1. The documents should be submitted to UCO Bank Kanpur Zonal Office General Administration Department ,75/4, Siddhi Sadan, Halsey Road, Kanpur-208001 within stipulated time frame.

D) Miscellaneous items

1. Vendor's representatives will be allowed to be present during opening of bids at their cost.
2. In case date of pre-bid meeting, last date of receipt or opening of tender are declared as holiday, the respective date shall be treated as deferred and will be re-scheduled to next working day correspondingly.
3. It may be noted that the requirement given in this RFP is indicative only.
4. Tenders/offers through email will not be accepted.
5. Bank reserves the authority to accept or cancel any or all tenders without assigning any reason.
6. All tenders in which any of the prescribed conditions are not fulfilled or are incomplete in any respect or there is any correction in Price Bid is not duly signed and dated by the bidder are liable to be rejected.



Zonal Head
Kanpur Zonal Office

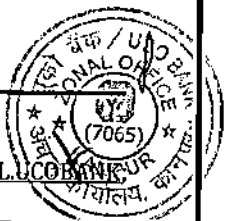



Eligibility Criteria

1. The contractor must be empanelled contractor of Bank under Kanpur Zone.
2. The contractor must apply only in that trade (furnishing, electrical or air conditioning works) in which he has been empanelled in the Bank under Kanpur Zone.

Evaluation Criteria

Lowest Bid Value will be evaluated on lowest price offered by the bidder against Financial Bid.

Rejection of Bids

The bid is liable to be rejected summarily if:

- i) Tenders are not received in two parts in separate envelopes.
- ii) It is not in conformity with the instruction mentioned in this tender document.
- iii) If it is not accompanied by requisite tender cost and EMD as stated above.
- iv) It is received after expiry of the due date and /or time.
- v) It is evasive and contains incorrect information.
- vi) If there is canvassing of any kind.
- vii) It is submitted anywhere other than the tender box or to the addressee.
- viii) If any indication of price/rate/charges is being found in Part-I of the tender.
- ix) If the bidder has applied in that trade in which he/she is not empanelled.





ANNEXURE – I

To
Zonal Head
UCO Bank Zonal Office
Kanpur

Sir

1. We have carefully examined all the contents incorporated in the various parts of this Tender Document no dated and taken note of all the terms & conditions stated in the Tender Document in its various parts.
2. We hereby agree to abide by and fulfil all other Terms and Conditions of the Tender.
3. We also agree to keep the retention money clause as mentioned in the tender document.
4. The integrity and letter of undertaking and indemnity submitted by us during empanelment in Bank's list of empanelled contractors shall be binding on me during the course of this work.

For and on behalf of

(With seal)
Signature _____
Name _____
Designation _____
DULY AUTHORIZED SIGNATORY

_____ day of _____ 20



ANNEXURE-II
TECHNICAL SPECIFICATIONS
Approved Make

APPROVED MAKE OF MATERIALS		
1.	False Ceiling/Channels	India Gypsum/Armstrong/AMF/Saint Gobain
2.	Aluminium Framework/Aluminium Section	Jindal/Tata
3.	Wood Skirting/Moulding/Lipping/Beading	C P Teak
4.	Wood Preservative	STP Pentaphene Pale / Termiseal by PCI / Bison by British Paint
5.	Fire Retardant Paint	Industrial grades of Nobel/Viper
6.	Marine Ply with ISI:710 Mark	Green/Century/Sylvan
7.	BWP Block Board (IS:1659)	Green/Century/Sylvan
8.	Laminate (1 mm thick)	Merino Lam / Green lam /Century mica / Sun mica
9.	Door Closure (Heavy Duty)	Ebco / Ozone / Dorma / Godrej
10.	Door Lock	Godrej/Ebco
11.	Door Handles	Godrej / Hafele /Hettich / Ebco
12.	Drawer/Storage Handle	Godrej / Hafele /Hettich / Ebco
13.	Drawer/Storage lock (Multipurpose)	Godrej / Hafele /Hettich / Ebco
14.	Night latch	Godrej
15.	Screws	GKF/Nettle Fold
16.	Hinges	CIEF
17.	Sliding telescopic drawer channel	Ebco / Kombo / Earl Behari / Efficient Gadgets
18.	Cable Organiser	Ebco/Innofitt Systems (CM 63C)
19.	Adhesive	Fevicol SH / Araldite
20.	Soft Board	Jolly Board
21.	Vertical/Roller Blinds	Mac / Vista / Wincab
22.	Glass	Modiguard / AIS / Saint Gobain
23.	Paints (Synthetic Enamel / Acrylic Emulsion)	Asian Paints / Berger / Dulux
24.	PVC Flooring	Krishna Vinyl / Armstrong / Birla
25.	Texture Paint	Asian Paints / Berger / Dulux
26.	G I Pipe	TATA(Medium)/Jindal Steel
27.	Cement	Ultratech/Ambuja/ACC
28.	Vitrified tiles	Johnson/Kajaria/Nitco/ASL
29.	Ceramic Tiles	Johnson/Kajaria/Nitco/ASL
30.	ACP	Alucobond/Alstone/Eurobond
31.	Veneer (4mm)	Century/Ply
32.	All materials not covered above	As per sample approved by Bank/Architect



UCO Bank
Zonal Office
75/4 Siddhi Sadan
Halsey Road, Kanpur – 208001
Phone-9454385520, 9334414353
Email - zokanpur.gad@ucobank.co.in

RFP for Furnishing, Electrical & Air Conditioning works at Bank's new Branch at Sipri Bazar, Jhansi (U.P.) under Kanpur Zone.

Part – II (Financial Bid)

The information provided by the bidders in response to this RFP Document will become the property of the Bank and will not be returned. The Bank reserves the right to amend, rescind or reissue this RFP Document and all amendments will be advised to the bidders and such amendments will be binding on them. The Bank also reserves its right to accept or reject any or all the responses to this RFP Document without assigning any reason whatsoever.

This document is prepared by UCO Bank for Interior Furnishing, electrical works at Bank's new Branch at Sipri Bazar, Jhansi (U.P.) under Kanpur Zone. It should not be reused or copied or used either partially or fully in any form.





BOQ of furnishing works

S.NO.	DESCRIPTION OF ITEM	QUANTITY	UNIT	RATE	AMOUNT (Rs.)
A.	FURNISHING WORKS				
1	Main Entrance Door For Branch + ATM	160	SQFT		
	Providing and Fitting in Position toughened glass door with 12 mm thick toughened glass with 3M security film complete in all respects with Ozone patch fittings including top patch(OPF-02),BOTTOM PATCH (OPF-03)angle lock(OPL-01)TOP PIVOT (OFS-ACC-GDP)Floor Spring (FS8400) and handle (OGH-55) 32mm x 457 mm all item included)				
2	FULL HEIGHT GLAZED & UNGLAZED PARTITION (HT -8'-6")	205.00	Sq.Ft		
	Glazed Partition(upto false ceiling height only considered and above necessary ceiling supports to be provided) with Anodized Aluminium frame work, heavy sections (2mm thickness) of 2"x1.5" section, spacing of 2'0"x2'0" on bothsides and covered with 9mm thick BWR plywood finished with 1mm thick laminate of skirting & borders on both sides.Above 1'0"/2'6"/3'0" height partition, fixed with 8.0 mm bevelled glass with 3m sticker works door and teak wood beading with duco paint. Clear glass shall be finished with frosted film sticking over the glass of approved pattern and design. Rate to include providing cutouts and provisions to run electrical conduits, switches, etc..Cost include wastages, transports, loading, unloading charges, labours, materials, tools, lead, lift and etc.Complete as per drawings and instructions of the Architect.				





	The job shall also include for provision of laying conduits, switch boxes etc. The erection of partition shall include for expansion bolts cleats, clamps bolts, nuts, screws, rivets and other accessories, all complete up to the satisfaction of the Architect.				
	All door opening shall have rebated teak wood framework (size - 75mm x 50mm, as per profile) on vertical (2 Nos.) and horizontal (1 No.) sides, with melamine finish and rebate of 40mm x 12mm, all complete up to the satisfaction of the Architect.				
	the partition and doors shall have hinges floor springs/sliding arrangement/hydraulic door closer, mortise locks (Godrej make all), etc. The rate shall include cost of all materials, labour, T&P, wastages, etc. required for proper completion of work, all complete to the satisfaction of the Architect.				
3	Low Height Wooden Partitions (partly glazed) and Flap Doors				
	Same specification as in 1 but P/F half height partition of height 4'-6" with wooden laminate till 3'-0" and 1'-6" height 12 mm thick glass secured with D brackets including all hardware necessary with the same specs.as above.	85.00	Sq.Ft		
3B	Ups parttion up to ceiling ht with bison board	90.00	Sq.Ft		
4	CASH CABIN PARTITION(HT-7'-6"ONLY)				
	Decorative Grill (12mm thk)-hexagonal opening as per instruction of Bank's Engineer/Architect.) All exposed edges of Plywood shall be fixed with 1/8" C.P.Teak Lipping.				

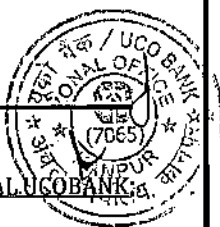



	<p>providing and fixing of Cash Enclosures at height of 7'-4" with Anodized aluminium frame work, heavy sections (2mm thickness) of 2"x1.5", spacing of 2'0"x2'0" on both sides and covered 6mm thick BWR plywood finished with 1mm thick laminate of (As per bank colours) for skirting & borders. Partition shall have provision for opening and 19mm BWR plywood tray for hallan receiving purpose. Cost include aluminium grill and fixed with teak wood beading and duco paint. Cost also include 3 nos of Solid core flush Doors with sizes of 6"x7'0", fixed in the partition. Door shall have teak wood beading and lipping with duco paint. Door finished with 1mm thick laminate of (As per bank colours) for base and (As per bank colours) for skirting of approved pattern. Door shall have 8mm glass fixed with teak wood beading and duco paint. Rate to include hardware's like brass hinges, godrej three nos of night latch, door closure, door top and handles. Cost also include cash transaction opening shall be provided with door arrangements made with BWR plywood frame work finished by laminate, duco paint and locking system. Cost include wastages, transports, loading, unloading charges, labours, materials, tools, lead, lift and etc. Complete as per drawings and instructions of the Architect.</p>				
	Solid till 4'-0" then Aluminium Decorative Grill height till 7'-0" then again solid	245.00	Sq.Ft		
5	Glass Barrier on cash cabin and front glass for counter (12 MM NECESSARY)	50.00	Sq.Ft		
	<p>Providing and fixing glass barrier (as per profile and design) in front of cash and ledger counter made out of 12mm thick polished edged float glass (Make - Modiguard or equivalent). It shall have 25mm x 20mm teakwood beading (as/shape approved by the Architect) to hold the glass from sides and top (optional). All teak wood surfaces shall be melamine polished. The rates shall include for cutting (in geometrical shape) and polishing the edges, all complete to the satisfaction of the Architect.</p>				





6	Computerised Ledger & Cash Counter				
	Providing and placing in position ledger counter with top, vertical sides/dividers, skirting and fascia made out of 19mm thick water proof board with 1mm thick laminate (as/shade approved by the Architect) on all exposed surfaces. It shall also have 75mm x 40mm teak wood runners below the top and for footrest below. Every unit shall be provided with a side unit (size - W-500mm, H-750mm, D-500mm approx.), consisting of 150 mm deep drawer at top and a cabinet with open able/hinged shutter below.				
	The fascia of drawer and shutter of cabinet below shall be made out 19mm thick water proof board with 1mm thick laminate (as/shade approved by the Architect) and sides and bottom of drawer shall be made out of 12mm thick water proof ply. The side unit shall have CAM locks, handles, guides, sliding units, hinges, magnetic catcher's etc. of approved make. Every unit shall be provided with a keyboard drawer unit (size - W-550mm, H-100mm, D-300mm approx.) below. The counter shall have 100mm deep fascia, below the top, in which keyboard drawer unit shall be adjusted.				





	It shall be made out 19mm thick water proof board with 1mm thick laminate (as/shade approved by the Architect) and sides and bottom of drawer shall be made out of 12mm thick water proof ply. The unit shall have CAM locks, handles, guides, sliding units etc. of approved make. The job shall include for 6mm x 6mm grooves in between sides and openable drawers and hinged shutters. All the exposed edges of water proof board and ply shall be provided with 6mm thick teak wood/hard wood lipping. All teak wood surfaces shall be melamine polished and other internal surfaces shall be painted with two coats of synthetic enamel over one coat of primer, all complete to the satisfaction of the Architect.				
a	High Level	10.00	Rg.Ft		
	High level (two levels) Computerised cash counter.				
	Lower level top shall be 900mm wide and at 750mm level from floor & upper level top shall be 250mm wide (and at 1150 mm level from floor				
b	Low Level	10.00	Rg.Ft		
	Low level (two levels) Computerised ledger counter.				
	Lower level top shall be 900mm wide and at 750mm level from floor & upper level top shall be 150mm wide and at 900mm level from floor				
7	Tables				
A	Manager's Table with Side credenza include the 12 mm thick glass	1.00	No.		





Providing and placing in position tables with top, vertical sides/dividers, skirting and modesty panel made out of 19mm thick water proof board with 1mm thick laminate (as/shade approved by the Architect) on all exposed surfaces. It shall also have .75mm x 40mm teak wood runners below the top and for footrest below. Every table shall be provided with a side unit (size - W-500mm, H-750mm, D-500mm approx.), consisting of 150 mm deep drawer at top and a cabinet with open able/hinged shutter below.				
The facia of drawer and shutter of cabinet below shall be made out 19mm thick water proof board with 1mm thick laminate (as/shade approved by the Architect) and sides and bottom of drawer shall be made out of 12mm thick water proof ply. The side unit shall have CAM locks, handles, guides, sliding units, hinges, magnetic catcher's etc. of approved make. Every table shall be provided with a keyboard drawer unit (size - W-550mm, H-100mm, D-300mm approx.) below. The table shall have 100mm deep facia, below the top, in which keyboard drawer unit shall be adjusted. It shall be made out 19mm thick water proof board with 1mm thick laminate (as/shade approved by the Architect) and sides and bottom of drawer shall be made out of 12mm thick water proof ply. The unit shall have CAM locks, handles, guides, sliding units etc. of approved make.				
The job shall include for 6mm x 6mm grooves in between sides and open able drawers and hinged shutters. All the exposed edges of water proof board and ply shall be provided with 6mm thick teak wood/hard wood lipping. All teak wood surfaces shall be melamine polished and other internal surfaces shall be painted with two coats of synthetic enamel over one coat of primer, all complete to the satisfaction of the Architect. Every table top shall be provided with 10 mm thick float glass (as per profile) with polished and beveled (25mm wide) edges all complete to the satisfaction of the Architect.				





B	Officer Table size 4'-6"x 2'-6"x 2'-6" With Side Table include the 12 mm thick glass	2.00	No.		
	SPECIFICATION AS PER MANAGER TABLE(PART -A)				
8	Writing Table & Brochure Holder	1.00	No.		
	Providing and fixing in position (with rear wall) slip and customer writing desk (as per design) of over all size - 1200mm x 450mm x 300mm. The fixing shall include for expansion bolts, cleats, clamps, bolts, nuts, screws, rivets and other anodized accessories, all complete up to the satisfaction of the Architect.				
	The writing top and facia/sides shall be made out of 19mm thick water proof board with 1mm thick laminate (as per shade approved by the architect), on all sides and . It shall be laid over the base of 19mm thick water proof board (already considered in various items.) and fixed with araldite. It shall include for beveling and polishing at all the exposed edges. The rate shall include cost of all materials, labour, scaffolding, wastages, polishing and T& P etc. It shall be made out of 12mm thick water proof plywood (two surfaces of 6mm thickness, fixed together, where required) on rear and both sides.				
	The front shall be made out of 12mm thick glass (as per profile). It shall be fixed in the grooves, made in side members, in an inclined manner (as per profile in drawing enclosed) with a gap of 75mm (max.) in between. The space shall be further divided in four equal parts with help of 12mm thick water proof plywood. All edges of the glass shall be polished. All the exposed edges of water proof board and plywood shall be provided with 6mm thick teak wood/hard wood lipping. All teak wood surfaces shall be melamine polished and other internal surfaces shall be painted with two coats of synthetic enamel over one coat of primer, all complete to the satisfaction of the Architect				





9	Complaint & Suggestion Box & CHEQUE DROP BOX	2.00	No.		
	Providing and fixing in position complaints/suggestion box (as per design) with hinged shutter of size - 450mm x 600mm x 150mm made out of 19mm thick water proof board with 1mm thick laminate (as per shade approved by the architect) on all exposed surfaces. It shall have 6mm thick water proof plywood on the back.				
	The hinged shutter shall be made out of teakwood (section - 25mm x 50mm) framework, with 4mm thick float glass, fixed with teakwood (size - 12mm x 12mm) beading. The unit shall have cam locks, handles, spring hinges, magnetic catchers etc. of approved make. All the exposed edges of water proof board or ply shall be provided with 6mm thick teak wood/hard wood lipping. All teak wood surfaces shall be melamine polished and other internal surfaces shall be painted with two coats of synthetic enamel over one coat of primer, all complete to the satisfaction of the Architect.				
10	Notice Board	1.00	No.		
	Providing and fixing in position notice board (as per design) of size - 900mm x 600mm x 150mm. The sides shall be made out of 19mm thick water proof board with 1mm thick laminate (as per shade approved by the architect) on all exposed surfaces. It shall have 12mm thick tack The front shall have 6mm thick float glass sliding shutter in two parts.				





	It shall also have 19mm wide two track aluminium channel for sliding arrangement, all around, along with locking arrangement board (Make - Cellotex or equivalent) wrapped with stretched blazer cloth (Make- Raymonds), of Rs. 200.00 per Mt. (approx.) in colour and pattern approved by the Architect. It shall be fixed with help of nail/partial wood (sect. 19mm x 25mm) frame work. It shall be covered with 6mm thick water proof plywood, on the back. All the exposed edges of water proof board and ply shall be provided with 6mm thick teak wood/hard wood lipping. All teak wood surfaces shall be melamine polished and other internal surfaces shall be painted with two coats of synthetic enamel over one coat of primer, all complete to the satisfaction of the Architect.				
11	False Ceiling(Armstrong)	650.00	Sq.Ft.		
	Providing and fixing in position false ceiling in armstrong 600 x 600 x 15 /16 mm dune supreme RH 99 prima tile with regular edge frame work as specified by armstrngcompany with suspenders making necessary frame work for A.C. Ducting for diffusers and light fitting.				
12	False Ceiling Works (Gypsum) with cove design & CNC CUTTING JALI & MDF JALI				
	Providing & fixing with necessary scaffolding frame in 22 gauge GI channel /angle, placed at appropriate grid, fixed to RCC slab, beam, wall etc. with fasteners /screws finished with 12.0mm Gypsum sheets joints covered with POP slurry/tape. Rates shall include painting (One Coat of putty, one coat of primer coat and two coats of acrylic paint). Rates shall include providing necessary cut-outs & additional support frames for electrical fixtures, A.C. grills, vertical drop upto 1'6" etc	475.00	Sqft		
13	Column & Wall Panelling (As per Direction BY Architect)	245.00	Sqft		





	Providing & fixing in position 2"x2" kailwood frame and finished with 6 mm thk. Commercial ply on both sides with 1.0 mm thk. Laminate on top as per instruction of the Architect				
14	Designer MDF board column cladding with CNC Cutting and backing of Acrylic /Metalim, Jaali to be painted in white duco mpaint and LED strip lighting to be included in this rate.The support system to be as above.	90	Sq.Ft.		
15	Acrylic Emulsion with POP Base.	3069.00	Sq.Ft.		
	Painting on undecorated / decorated wall and ceiling surfaces with two or more coats of acrylic emulsion(Asian/ Berger make) (as / shade approved by the Architect) of approved brand. It shall include for preparing the surfaces clean, even and smooth with thoroughly brushing with broom, scratching with patti and sand papering respectively, so that the surfaces are free from oil, grease, dirt, mortar droppings & other foreign and loose matter. It shall also include for preparing the surface and filling of holes with plaster of paris before priming coat of whitening / approved primer. this work is included Front Elevation painting (including First Floor elevation painting)Complete in all Respects .				
	The rate shall include cost of all materials such as plaster of paris, whitening /primer, glue (Fevicol), indigo / stainer, brushes, sand paper, patti, dhori, broom stick, clean water with storage and other containers, labour, scaffolding / ladder charges, cleaning of floors and other sundries etc., all complete to the satisfaction of the Architect.				
16	Low /full height Storage Racks				
	S1-Storage (Low Height)				
	Size- 6' Length X 2'-6" highX 1'-4"deep				
	Ply Wood-19.0mm thick for side top and door & back 6.0mm with shutters, shelf 19.0mm				
	Shelf-19.0mm thick Ply				



	Handle-Brush finish stainless steel				
	Lock-Vijayan/Godrej				
	All internal & rear surfaces to be painted with two coats of enamel paint over a coat of primer / putty as directed to get a smooth finish.All instructed by Bank's Engineer/Architect.	105.00	sqft		
17	ACP PANNELING (As per Bank colour)	295.00	sqft		
	Rolling Shutter Box.				
	Frame Work-2" X 2" X 1.5 mm thick Aluminium Tubular section (Horizontal/Vertical) Jindal /Alstrong Make				
	Aluminium Composite Panel-3.0mm thick of approved colour with bonding material				
18	Main Panel Boxing	sqft	45		
	Providing & fixing in position 2"x2" kailwood frame and finished with 6 mm thk. ply on Outer sides with 1.0 mm thk & Inner Side of Storage Paste 1.5 Thick Aluminium Tubular Section of Approved Colour Pattern . Front Side of Storage Aluminum Jali for Ventilation of the Panel & the Measurement of the Storage only front Facia of the Storage (Lenth x Height) . All work Complete to the Satisfaction of the Bank /Architect .				
19	Wooden Planter with Plants				
	Providing and placing in position planter made of phenol bonded 19 mm thick commercial board with top front and sides finished in 1.0 MM Thick laminate including GI trough with sand and marble chips filling and artificial plants as per the approval of the architect of not less than Rs.750. The design of the grooves shall be as per detailed drawing and complete as per Architects direction	No	0.00		
20	Synthetic Enamel	sqft	1550.00		
	• Surface preparation.				
	• Rub with sand paper to ensure that the surface is dry and free from abrasions, dust, dirt, grease etc.				



	• Fill the holes etc. in the wood, if any with putty.				
	• Let the surface dry before application of paint.				
	How to apply				
	• Generally two coats of synthetic enamel finishes are required for satisfactory results.				
	• After priming the surface with two coats of wood primer white and one coat of putty apply first coat of paint and finish as recommended.				
	• Allow a minimum time gap of 8 hrs in between two coats.				
	• First coat should be sanded with emery paper grade 320/400 and wipe clean before application of subsequent coats.				
	• For make and shade please refer to the schedule of interiors, furniture & finishes.				
21	Fire Extinguisher Rack	No	1		
22	P&F vertical Venetion blinds made out of 100mm wide strips as/ shade approved including supports,	Sft	45		
23	post construcion antitermite treatment by drilling holes and injecting chemical as per IS code from a reputed company with 10 years warranty certificate	Sqft	1250		
	Total				
	GST EXTRA				

(Signature of bidder with seal) _____

Name _____

Designation _____

Note: The Bank reserves the right, neither to execute all items of work nor to execute the full quantity of items, as mentioned in schedule of quantities.



BOQ of electrical work

S.NO.	PARTICULARS	Unit	Qty	Rate	Amount
	A -Electrical wiring (All switches to be Modular type - Anchor/ Havells or equivalent approved by architect)				
	<u>Light & Fan points</u>				
1	Supply & Installation of concealed point wiring using 600v grade 3x1.5 Sq.mm copper conductor PVC insulated wires (with proper R,Y,B color code) pulled through heavy gauge 19mm PVC conduit pipe heavy duty concealed in wall/ floor/ panelling/ partitions or above false ceiling as per requirement including 2 Nos. 2.5 sqmm circuit wires from the relevant DB and also including 1.5 sqmm green color copper earth wire and switch plate, switches, etc. as approved by the Bank's Engineer/Architect. All switch & sockets shall be modular type complete with cover plate & GI/ MS box. The work shall also include for cutting chase for conduits and moulded boxes, if required, in the wall/ floor (Without damaging the building/wall) along with clamping the conduit at every 600mm interval & finally finishing the surface & matching the same with the existing surface.The rate should include the cost of all materials, labour, T&P, taxes & levies, scaffolding, shifting of furniture, carting away the debris and cleaning the floor etc.The job shall be complete & to the entire satisfaction of the Bank.				
a	Light points + AFF points including the cost of 6A switch	Point	50		
b	Ceiling Fan Point including the cost of 6A Switch along with electronic regulator	Point	5		
c	Wall Fan Point along with 6A switch	Point	17		
d	6A switch & Socket on SDb	Point	12		
2	<u>RAW POWER POINT</u>				





	Single Power Points - Supply & Installation of point wiring for Raw power plug points on workstations / table for computers using 2 X2.5 + 1x1.5 Sq.mm copper conductor PVC sheathed flexible wire pulled through heavy gauge 19mm PVC conduit pipe heavy duty concealed in wall/ floor/ panelling/ partitions or above false ceiling as per requirement. Each point consisting of 1 nos of 16A , 2/3/5 pin sockets & 1 No.16A Switch wired together forming one point. The earth wire of green color only. All switch & sokets shall be modular type complete with cover plate & GI/ MS box. The work shall also include for cutting chase for conduits and moulded boxes, if required, in the wall/ floor (Without damaging the building/wall) along with clamping the conduit at every 600mm interval & finally finishing the surface & matching the same with the existing surface.The rate should include the cost of all materials, labour, T&P, taxes & levies, scaffolding, shifting of furniture, carting away the debris and cleaning the floor etc.The job shall be complete & to the entire satisfaction of the Bank.	Point	12		
3	AIR CONDITIONING				
1	AIR CONDITION POINTS - Circuit wiring with 2x4.0sq.mm + 1x 1.5sq.mm stranded Cu. conductor (Finolex/Anchor/Skytone) in 19mm M S conduit pipe heavy duty 16swg laid & concealed in wall/ floor/ panelling/ partitions or above false ceiling as per requirement. The job includes supply & fixing of flush mounted 4in one appliance protector pre-wired, IP 20 with factory fitted 25A, 2P MCB and 25A socket (Hagers/ Siemens/ ABB). The rate should include the cost of all materials, labour, T&P, taxes & levies, scaffolding, shifting of furniture, carting away the debris and cleaning the floor etc.The job shall be complete & to the entire satisfaction of the Bank.	Point	8		
4	UPS				
A	Sub Main Wiring/ Cabling - : SITC of sub main wiring 4nos. 10 sq.mm Stranded copper wires for UPS Input from main incoming panel to incoming Db of UPS power input system etc. in 25mm dia PVC haevy duty conduit complete to the satisfaction of the bank.	JOB	1		





B	UPS Power Input System: SITC of 4way TPN Double door Db IP 42 horizontal Complete with 1no. Incoming 32A. TP MCB and 3 x 32A 2P MCB's to regulate supply for UPS complete in all respect as required and to the satisfaction of the bank.	Set	1		
C	Wiring for UPS Input & UPS Output (For both Critical 2Kva & Non- Critical 3Kva UPS) with 2x4.0sq.mm + 1x 1.5sq.mm stranded Cu. conductor (Finolex /Anchor /Skytone) to be laid in 19mm PVC pipe heavy duty/ Flexible pipe laid & concealed in wall/ floor/ panelling/ partitions or above false ceiling as per requirement. The rate should include the cost of all materials, labour, T&P, taxes & levies, scaffolding, shifting of furniture, carting away the debris and cleaning the floor etc.The job shall be complete & to the entire satisfaction of the Bank.	JOB	1		
D	S/F of 32A 2P MCB in 2way metallic box including proper connectionbs thru lugs. Both the Db's shall be inter looped- Qty included in item 3. (2nos. For ATM and 2nos. For Branch)	Each	1		
E	UPS Output Power Distribution System: SITC of 12 way SPN Db Double door IP -43 Siemens make with 32A DP 10kA MCB and 09 nos. SP 10kA MCB complete in all respect and as required & to the satisfaction of the bank. Siemens/ L&T/ MDS/ Schnider	Set	1		
F	Input Wiring for UPS Db's with 2x4.0sq.mm + 1x 1.5sq.mm stranded Cu. conductor (Finolex /Anchor /Skytone) to be laid in 19mm PVC pipe heavy duty/ Flexible pipe laid & concealed in wall/ floor/ panelling/ partitions or above false ceiling as per requirement. The rate should include the cost of all materials, labour, T&P, taxes & levies, scaffolding, shifting of furniture, carting away the debris and cleaning the floor etc.The job shall be complete & to the entire satisfaction of the Bank.	JOB	1		
G	Supply & fixing of 4nos. 6A switches & sockets (Modular type c/w MS/GI box & cover plate) complete with computer point circuit wiring with 2x2.5sq.mm + 1x 1sq.mm stranded Cu. Single core Copper conductor (Finolex/Anchor/RPG) to be laid in PVC conduit 1" dia/ vertical drops heavy duty laid & concealed in wall/ floor/ panelling/ partitions or above false ceiling as per	Per Node	12		

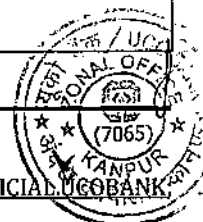



	requirement.				
5	MAIN INCOMING PANEL & DISTRIBUTION				
A	SITC of 100A Kit kats fuse unit 3nos in wooden patra complete with 100Amp. Neutral link complete in all respect as required.	Set	1		
	1 No for Metre				
	1 no for Panel to Outer Side Of Wall (For Generator Connection)				
B	Main Incoming Panel				
	Supply, Installation, Testing & Commissioning of main distribution board panel fabricated of 18swg (powder coated) comprising of Indicator lamps 3 nos.	Nos.	1		
	Voltmeter & ammeter(one each)				
	Rotary selector switches 2 nos for voltmeter & ammeter				
	Busbar (each of RYB +N) copper 100 amp each				
	125 Amp MCCB(Siemens/ L&T/ ABB/ Schnider) incoming 3P adjustable 25kA				
	Changeover TPN 100 amp for DG set (Havells/ ABB/ Sochomac)				
	Outgoing 63A 3P MCB's - 6 nos.				
	Outgoing 32Amp 2P MCB's - 6 nos.				
	Earth bus bar 25x5mm GI strip - 2nos. At the bottom.				
6	Supply Installation testing & commissioning of XLPE insulated Armoured Al.codutctor cable between main panel & DB's & generator of required thickness of approved make Skytone/ Havells based on the load assessment & confirmation of the same with architect. This rates include cost of lugs at both the ends				
	3.5 x50 sq.mm cable from Meter to Kit kat to the main panel & Pole (Approx - 20 mtr)	JOB	1		
	4c x20 sq.mm cable from Main Panel TO LHS DB (Approx - 20 mtr)	JOB	1		
	4c x 20 sq.mm cable from Main Panel to RHS DB (Approx - 20 mtr)	JOB	1		
	4c x 20 sq.mm cable from Main Panel to Kikat (Generator) (Approx - 40 mtr)	JOB	1		





7	Supply, installtion, testing & commissioning of VTPN Db double door with MCB as incomer IP 42 complete in all respects for AC, PP and L & F as under - Siemens/ Hager/ Lagrand/ ABB				
A	RHS 6way VTPN db - Loaction RHS wall opposite Cash cabins (From entrance to Rear record room & Toilet area) - Siemens 8GB0406VRC or equivalent				
	Incomer - 63A 3P MCB 10kA adjustable neutral to be directly connected to neutral bus	Each	1		
	3no. 32A 1P-MCBs 10 KA - AC's - 2nos. RHS & 1rear				
	3no. 16A 1P-MCBs 10 KA - for single power points - 2 cash & 1 May I help You & 2nos. D/W				
	4nos. 10A 1P-MCBs 10 KA for L&F				
	4os. 6A 1P-MCBs 10 KA for L&F				
	Blanking Plates - 2no.				
	All connections to be terminated thru lugs				
B	LHS 6way VTPN db - Loaction LHS wall behidn advance (From LHS LV Cash to Mgr Rm)- Siemens 8GB0406VRC or equivalent				
	Incomer - 63A 3P MCB 10kA adjustable neutral to be directly connected to neutral bus	Each	1		
	4o. 32A 1P-MCBs 10 KA - AC's - 3nos. LHS & 1 Mgr Rm				
	4no. 16A 1P-MCBs 10 KA - for single power points - (LV cash, 2 CRE, 1Advance, 2 MR & 2 Router)				
	2nos. 10A 1P-MCBs 10 KA for L&F				
	2os. 6A 1P-MCBs 10 KA for L&F				
	Blanking Plates - 2no.				
	All connections to be terminated thru lugs				
8	Glow sign Board - Circuit wiring with 2x2.5sq.mm + 1x 1.0sq.mm stranded Cu. conductor (Finolex/Anchor/Skytone) to be laid in 19 mm PVC pipe heavy duty laid & concealed in wall/ floor/ panelling/ partitions or above false ceiling as per requirement. The rates should include the cost of all materials, labour, T&P, taxes & levies, scaffolding, shifting of furniture, carting away the debris and cleaning the floor etc.The job shall be complete & to the entire satisfaction of the Bank.	JOB	1		
	<u>E -EARTHING</u>				





9	For Main Panel - S/burying of Dual pipe technology (Pipe in Pipe) earthing electrode having GI 80mm O/D pipe with 25 micron coating, 3metres long. The space between two pipes to be filled with Highly conducive & Non corrosive chemical compound. The installation shall be thru earth auger. The vacant space between pipe & hole shall also be filled with compound all around. The job also includes S/F of GI strip clamp with two holes (with SS/GI bolts & nuts) on the electrode & taking two earthing leads of 25 x 5 mm GI strip (Assumed length of 10m - beyond 10m to be paid extra) upto Main panel complete in all respects with guaranteed E/N voltage of less than 3 volts and resistance less than 1 ohms. The distance INCLUDING Earth wire 4 sq mm copper wire . Approx -80 mtr (2 FOR BRANCH & 1 ATM)	Per Icn.	2		
10	F - FIXTURES & FITTINGS				
A	a) Supplying and fixing Philips make 36W LED FLAT PANEL after disconnection of existing fitting 2'x2' size in grid type false ceiling, 600x600 suitable for recess mounting, CRCA sheet, asthetic looking, or eqv Philips/havells	Each	13		
B	b) Supplying and fixing Philips make or eqv 10 W LED round type downlighter (Philips/ wipro /Jaguar)	Each	27		
C	Supply installation testing and commissioning of 1*20watt Batten type tubular LED light fitting with LEDs, driver, diffuser, and housing complete in all respects in UPS room and record /wc/bath room /suitable place with complete in all respect with required color on need basis.	Each	9		
D	S/F of angle holder for bulbs including cost of 11w CFL lamp for Toilets	Each	4		
E	i) Supply & installation of wall bracket fan 450 MM METAL BODY (Heavy duty/ high speed) Make Bajaj/crompton greaves/havells/Orient (to be supplied after consultation with architect/Electrical Engineer as per approved drawing)	Each	17		

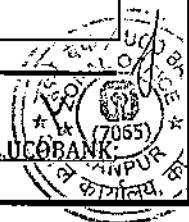



F	g) Supply & fixing of the 1200 mm 48") Sweep Ceiling fan (Orient PSPO/crompton greaves/havells) with downward rod(below false ceiling), canopy etc. including of PVC flexible copper wire.(white colour)(High speed) (Warranty Certificate is necessary)with downward rod, circular boxes, ball sockets, ceiling plates,suitable arm bracket etc. including connection with wire)White colour (WITH REGULATOR)	Each	2		
G	Supply & Fixing of fresh air fan 12" - Crompton Greaves/ Usha/ Khaitan/ Bajaj	Each	3		
H	e) Supplying and fixing LED strip 3000 K 24 watt 5 mtr length with driver (Philips or Havells or Cormpton)	SET	6		
11	<u>H - TELEPHONE</u>				
A	P/f Krone or equivalent box in the server room & out side of the Branch with a ten pair connecting strip for telephone with lock & key	Each	2		
B	10 Pair Cable with Connection from main Panel to entrance of the Branch	JOB	1		
C	Supply & fixing on wall/ furniture/ partition recessed type non modular telephone socket outlet (RJ-11) with mounting box & front plate complete with chase cutting, mending good etc. as required complete with Supply & laying of 2pair 0.61mm dia. PVC insulated telephone cables through 19mm dia rigid PVC conduit of suitable diameter as directed by the consultant from telephone junction box to telephone socket outlet including interconnection mending good etc. as required complete in all respects.	Each	4		
D	Wireless Call Bell of Approved Quality (Orient,Sunshine)	No.	1		
12	<u>I - DATA CABLING</u>				



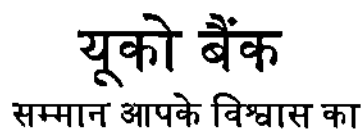

UCO BANK
Honours Your Trust



BRANCH/ OFFICE- ZONAL OFFICE, EMAIL: ZO.KANPUR@UCOBANK.CO.IN IN CONTACT:
FOLLOW UCO BANK ON TWITTER: [UCOBANKOFFICIAL](#); FACEBOOK: [OFFICIALUCOBANK](#); INSTAGRAM: [OFFICIALUCOBANK](#)
Linked In: [UCO BANK](#); You Tube: [UCO Bank Official](#)

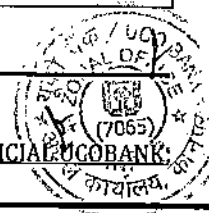



	List of approved materials	
	Materials	Approved manufacturers/suppliers
1	MCCB	MDS legrand, ABB, GE, SIEMENS
2	Changeover	Indo Asian/ HPL Socomec / GE/ Standard stangaurd
3	Distribution board	MDS / Standard / Indo Asian / HPL
4	MCB	MDS / Standard / Indo Asian / HPL
5	Cable	Gloster / Rallison / Incab / CCI
6	Copper wire	Finolex/anchor
7	Switch / Socket / Call bell and accessories	Anchor / Havells / CPL / MDS / Philips
8	Electrical Light Fittings / Fixtures Complete	Philips
9	Wall Fan / Ceiling Fan / Exhaust Fan	Khaitan/Havells

(Signature of bidder with seal) _____

Name _____

Designation _____

Note: The Bank reserves the right, neither to execute all items of work nor to execute the full quantity of items, as mentioned in schedule of quantities.





BOQ of Air Conditioning Work

S. No.	DESCRIPTION	QUANTITY.	UNIT	RATE	AMOU NT
1	Supply, Fixing, Testing & commissioning of following star rated AC units, with evaporator copper coil & imported refrigerant joints, with wireless remote controller (Make:- Bluestar / Voltas / Carrier)				
(i)	Cassette 2 TONE - INVERTER TECHNOLOGY	0.00	No.		
2	S.I.T.C. of 3 Star 1.5 Ton capacity High wall mounted Split A.C. comprising Indoor & Out-door units. Indoor unit comprising Multi Row DX cooling coil, expansion valve, drier, motor driven air-blower with metallic frame etc. Out-door unit will have rotory/scroll compressor, condenser coil, & fan, Cordless remote control unit etc. including refrigerant gas charging.	No	8		
3	S.I.T.C. of 3 Star AC as per specifications given in item no 3 above But For 1.0T Split A.C.'s	No	0		
2	SITC of interconnecting refrigerant pipe work with closed cell elastomeric nitrile rubber tublar in sulation between each set of indoor & outdoor units as per specification, all piping inside the room shall be properly supported with MS hanger & clamps including cabling from indoor to outdoor unit.				
(i)	Refrigerant Pipe for 2 TONE AC - INVETER (Cassette)	0.00	Rmt		
(ii)	Split 2.0/1.5/1.0 TONE - INVERTER	100.00	Rmt		
3	Providing & fixing, testing and commissioning of wall mounted copper wound voltage stabilizer suitable for split all accessories. Input Voltage range : 140-280 V, Output : 230 V (Make:- LIVEGAURD/ Blue-Birds & Reputed Firm .)				
(i)	CAPACITY: 5 KVA	0.00	Nos		
(ii)	CAPACITY: 4 KVA	8.00	Nos		
4	SITC of rigid CPVC piping complete with fittings supports as per specification tions & duly insulated with 6mm thick closed cell nitrile rubber insulation.				
(i)	Drain Pipe for 2.0 Tone AC (Cassette)	0.00	Rmt		
(ii)	Drain Pipe for Split 2.0/1.5 TR (Split)	85.00	Rmt		
5	M.S. stand with monkey cage - [In door & out door units	8.00	No		





6	Installation Charges .	8.00	No		
					Total
Note : GST will be extra.					

(Signature of bidder with seal) _____

Name _____

Designation _____

Note: The Bank reserves the right, neither to execute all items of work nor to execute the full quantity of items, as mentioned in schedule of quantities.



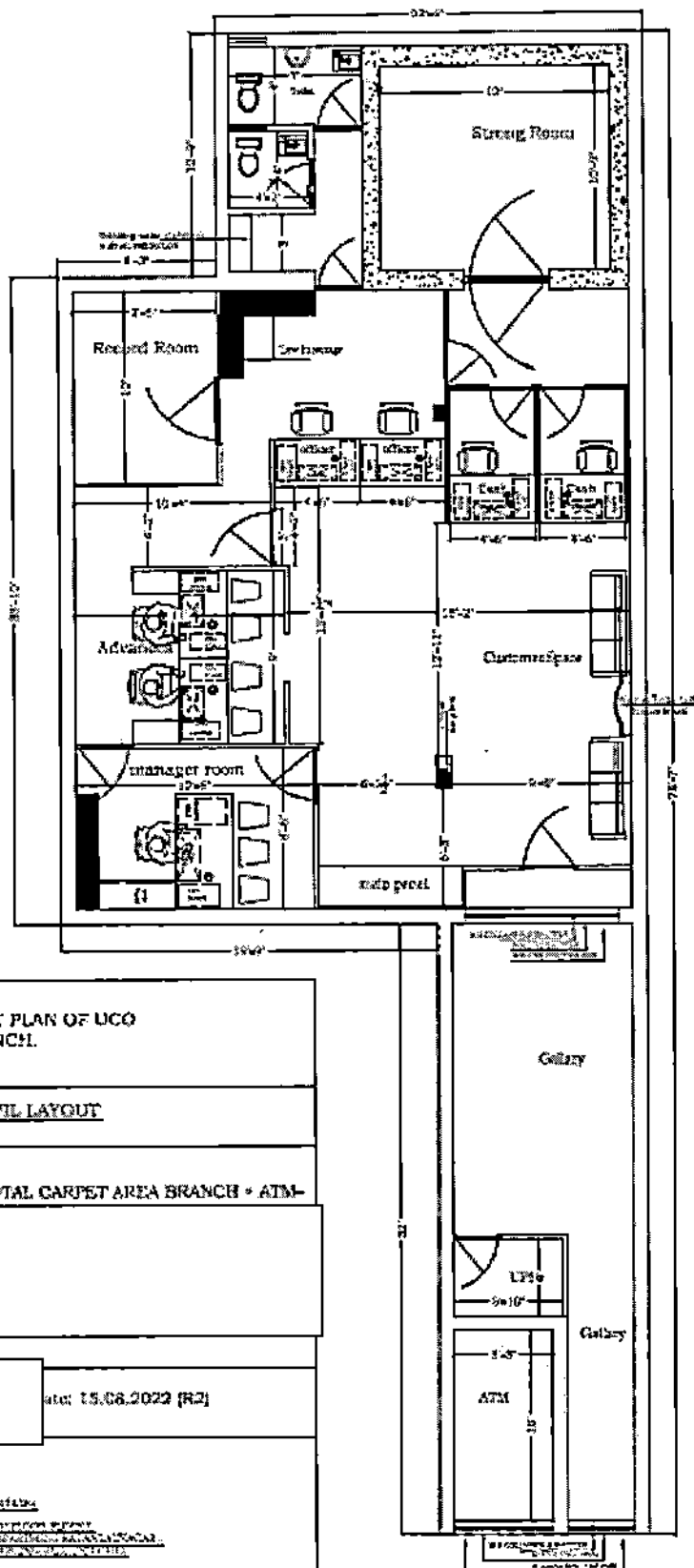

PROJECT:
PROPOSED LAYOUT PLAN OF UCO
BANK JHANSI BRANCH.

FURNISHING & CIVIL LAYOUT

TOTAL CARPET AREA BRANCH + ATM-

Date: 15.06.2022 (R2)

ARCHITECT



Signature, Name of the

Architect and his/her official stamp
and seal should be affixed to this plan.

