

**(ONLY FOR EMPANELLED CONTRACTORS OF UCO BANK)**

ISSUED TO  
M/S \_\_\_\_\_

## **TENDER DOCUMENT**

**FURNISHING OF UCO BANK BRANCH**  
**AT PIPLIWALA TOWN, MANIMAJRA.**

**OFFICE OF THE  
DEPUTY GENERAL MANAGER  
UCO BANK, Z.O. S.C.O. NO. 55-57, 1<sup>st</sup> FLOOR,  
SECTOR 17-B, CHANDIGARH - 160017**

**ARCHITECTS :**



**S.C.O-283, SECTOR-35 D,  
CHANDIGARH  
PHONE : 0172-2601465 (o)  
MOBILE : 09417495655**

## DETAILS OF TENDER

### TENDER FOR THE FURNISHING OF UCO BANK BRANCH AT PIPLIWALA TOWN,MANIMAJRA

- |     |   |   |   |
|-----|---|---|---|
| 1.  | Details of work to be done                                | : | Interior / Furnishing & Allied<br>Electrical works for UCO Bank,<br>At Pipliwala Town,Manimajra.  |
| 2.  | Form of Contract  | : | Item wise rate  |
| 3.  | Earnest Money   | : | Rs. 11,000/- (Eleven thousand only)<br>in form of Demand draft in favour of<br>Uco Bank payable at Chandigarh.  |
| 4.  | Period of contract /<br>time of Completion                | : | 4 Weeks   |
| 5.  | Last Date & time for receiving:<br>of sealed tender.      |   | <b>27-12-2015 at 3:00 p.m.</b>  |
| 6.  | Liquidated damages for non-<br>completion of work in time |   | 1.0% of the contract value per week<br>subject to a max of 10% of the<br>contract value.  |
| 7.  | Defect Liability Period                                   | : | 12 months (Twelve months) from the<br>date of virtual completion as certified<br>by Architect / employer.   |
| 8.  | Retention amount for 12 months:                           |   | 8% of the total bill.   |
| 9.  | Period of submitting of<br>Final bill.                    | : | 15 days from the date of completion.  |
| 10. | Mobilization Advance /<br>Secured Advance                 | : | No. Mobilization Advance / secured<br>Advance will be given to the<br>Contractor.   |
| 11. | Place and date of opening<br>of tender                    | : | UCO Zonal OFFICE Chandigarh 27-12-2015 at 5:00 p.m.<br>in Office of the Chief Officer, Uco Bank,<br>S.C.O. 55-57, 3 <sup>rd</sup> Floor, Zonal Office,<br>Sector 17-B, Bank Square, Chandigarh. |

**Chief Officer, Uco Bank,  
S.C.O. 55-57, 3<sup>rd</sup> Floor, Zonal Office,  
Sector 17-B, Bank Square, Chandigarh.**

## **TENDER FOR THE FURNISHING OF UCO BANK BRANCH AT PIPLIWALA TOWN, MANIMAJRA.**

### **GENERAL CONDITIONS**

1. The Contractor shall sign each page of this tender.
2. Payment to the Contractor Agency shall be made as per actual work done at site.
3. Quantity of work may increase or decrease at site as per requirement, which shall not affect the rates quoted by the contractor.
4. Furnishing works including electrical works etc. shall be done to the complete satisfaction of Bank and Architect-in-charge.
5. All teak / Cedar wood / rubber wood to be used should be knotless which is to be polished with all background surface preparation coarses maintaining the visibility of wood grains.
6. The rates to be quoted shall include the cost of material, labour charges, carriage, sales tax, or any / all other taxes any required hardware etc.
7. The contractor agency shall keep particular vigil on his workers / carpenters / painters etc. to maintain very good workmanship of all items, failing which no payment shall be made and no claim of material / labour used shall be made to him in any case, and the same work shall be executed by him again without charging any extra cost.
8. All rates shall be quoted in words & figures & any cutting over writing shall be signed.
9. All items to be executed as per drawings, if any change is required, the same shall be brought to the notice of Architect-in-Charge.
10. Any tender / quotation containing clerical or arithmetical mistakes shall be rejected.
11. Any addition, alteration or correction shall be signed and stamped properly.
12. Contractor agencies are advised (before quoting the rates) to inspect the site of the proposed work. He must go through all drawings and specifications and documents.
13. The Bank reserves the right to accept / reject any tender / quotation without assigning any reason.
14. The Contractor agency should have already executed works of furnishing interiors & exterior, civil works of very good workmanship.
15. Quality of material and workmanship rejected by the Architect / Concerned Authorities shall be removed immediately by the contractor and rectified / replaced.
16. No advance payment shall be made to the Contractor on supply of any material supplied at site for execution. Payment shall only be made on execution of any concerned / particular item.
17. The rates shall include the cost of coat of anti termite treatment on all wooden frame work and all commercial ply / board used for partitions and paneling, furniture etc. The contractor/s shall have to dismantle & dispose the existing counters, tables & partitions within the quoted cost of the total furnishing works.
18. Rates for partitions, paneling, wall cladding and false ceiling shall include cutting and making good of necessary cut-outs/chiseling to be made for electrical conduits, switch boards etc.
19. Bank shall not be responsible for any lose or damage to the contractor/labour due to any natural calamity during the course of construction. Contractor is liable to make good all the damages if any, till the work is completed and handed over to the Bank authorities.
20. Any payment to the contractor on account of execution of work, whether it is running payment or final, shall be verified by the Architect-in-Charge.
21. Unless, otherwise mentioned all materials to be used shall be I.S.I. marked. Failure to do so, the work may be rejected and in that case contractor shall have to remove the defective materials and replace / re-do the work for which no claim shall be entertained.
22. The total work shall be supervised by the Architect-in-Charge and he/she shall be kept fully informed by the contractor regarding the progress of work.
23. Bank may award the work in part or whole to a single party or any other party.
24. It may please be noted that the Bank is not bound to allot the work to the lowest party. And as such, the allotment of work shall be based on workability of rates quoted by the contractor on account of quality work.
25. The bank reserves the right to reject any or all the tenders without assigning any reason whatsoever.

26. The earnest money deposited shall not carry any interest and will be refunded to the unsuccessful tenderers.
27. Earnest money paid by the contractor shall be forfeited by the Bank if contractor fails to undertake the job if he is communicated about acceptance his rates/tender.
28. The contractor shall take all the necessary precautions while working and to safe guard adjacent property, Bank's property, Bank's Employees, and traffic persons.
29. All the rates quoted are inclusive of removal of existing counters, partitions, wiring, rubbish/ debris collected during the progress of work, rejected materials etc.
30. The contractor shall not directly or indirectly sublet the work to other party without written permission of the Bank.
31. The quantities mentioned in schedule are provisional and likely to increase/decrease to any extent or may be omitted thus altering the aggregate value of the contract. No claim for loss of profit / business shall be entertained on this account.
32. The Bank reserves the right to distribute the work for which quotations have been called, among more than one parties, if found necessary. No claim in this respect shall be considered and the contractor agrees to cooperate with other agencies appointed by the Bank.
33. All the workers of the contractor must be properly covered by an insurance policy under "Workman's Compensation act" and "Fatal Accidents Act". The contractor at his own expenses arrange to effect and maintain until the virtual completion of the contract, insurance policy in the joint name of Bank and the contractor against this risk to be retained by the Bank until the virtual completion of the work, and indemnify the Bank from all the liabilities arising out of such events. In case of delay, contractor shall arrange to extend insurance policy till work is completed.
34. All the work should be completed within the specified period in the tender. If the work is delayed due to the reasons beyond the control of the contractor, he should keep intimating the Bank explaining, therein the reasons for such delays, immediately and if in the opinion Bank's authorities the delay is justified, the contractor shall be granted extension in time limit.
35. The contractor shall furnish well in time before work commence at his own cost, colour samples, samples of materials or workmanship that may be called by Bank's Architect / Engineer for approval. Rates quoted shall cover for such preliminary work.
36. All the glass panes, door handles/ hinges, electric fittings, fans, furniture, records, floors etc. are to be thoroughly cleaned after the work is completed.
37. The rates quoted by the contractor shall be firm throughout the duration of contract (including extension of time if any granted) and will not be subject to any fluctuation due to variation in cost of material and labour.
38. Conditional tenders are liable to be rejected.
39. The successful tenderer is bound to carry out any item of work necessary for the completion of the job even those such items are not included in schedule of quantities.
40. If in any case of work required to be abandoned, the contractor shall not be entitled for any claims and he will be paid as per the actual work done till that period, if deemed fit.
41. Decision of the Bank shall be final and binding on any matter connected with the work. The matter of any dispute shall be decided after mutual discussions based on the terms and conditions of this contract. However, if the matter cannot be resolved then the same shall be referred to the respected qualified person in agreed to both the parties and his opinion shall be binding on both the parties. However, this is precourse to any legal action in this regard.
42. If at any stage during the progress of work, it is observed that the contractor is not progressing the work with due diligence, care of lagging much behind the schedule or fails to gear up the work despite instructions from Bank's Architect, the Employer (Bank) reserves the right to terminate the contract with 7 days notice. In such case the contractor shall be liable to pay the Employer any extra cost involved for the completion of the said work and will not obstruct any way in completing the work through other agency. After completion of entire work the contractor shall be paid for the actual work executed by him at the quoted rates after deducting any claims, damages. In case of such termination the security deposit held by the Bank will be forfeited.

43. Contractor shall follow all rules / regulations in force and should possess the license for employing labour and also follow all safety measures, labour bye laws and shall be responsible for any lapse.
44. At any stage i.e. during the execution of work, any kind of change reqd. whether it is in design or specification, the same has to be in-corporated by the contractor.
45. TDS/Local Taxes as applicable shall be deducted from the payments due to the contractor.

**TENDER FOR INTERIOR, FURNISHING & ELECTRICAL WORK FOR**  
**UCO BANK BRANCH AT PIPLIWALA TOWN, MANIMAJRA**

Grand Summary:-

S.No.	Sub Head	Amount (Rs.)
A.	FURNISHING WORKS	
B.	ELECTRICAL WORKS	
	LESS: DISCOUNT( IF ANY)	
<b>TOTAL AMOUNT</b>	<b>Rs.</b>	

Rupees                  Lacs                  Thousand                  Hundred                  Only

*Signature of the Contractor*

**RECOMMENDED MAKE TO BE USED FOR THE FURNISHING OF  
UCO BANK BRANCH AT PIPLIWALA TOWN ,MANIMAJRA.**

S.NO	DESCRIPTION	MAKE/BRANDS
1.	Plywood,Board (M R Gradeconforming to ISI Standards).	Green Ply, Kit ply, Duro Ply,Archid / ISI Marked.
	Laminates	Greenlam, Century,formica, Sunmica, Merinolam,Amulya. (shade No.366 of Century,1758 &1769 of Sun mica).
2.	Lipping & Moulding	Teak Wood.
3.	Adhesive	Fevicol SH.
4.	Locks (Multi purpose)	Godrej.
5.	Night Latch	Godrej.
6.	Glass	Modi / Triveni / Saint Gobain.
7.	Aluminum	Jindal.
8.	Aluminum Cladding	Eurobond / Altobond / Alukbond.
9.	Door Closer	Garnish (Heavy Duty) / Godrej.
10.	Paint	Nerolac / ICI Dulux./ Asian/Shalimar Paints.
11.	Wood Preservative	Bison by British Paints / Termiseal by ICI.
12.	Wood	Well Season partal / Gumar / Badam/kail.
13.	Drawer Channel	Telescopic
14.	Screw	Nettle fold
15.	Key Board Drawer	EBCO, EARL BIHARI, EVERITE, ELEGANT,CLASSIC.
16.	Telescopic CPU Stand /Trolley	EBCO, EARL BIHARI, EVERITE, ELEGANT,CLASSIC.
17.	Cable Organiser	EBCO
18.	Cement	ACC / Lafarz / Birla Plus.
19.	Rubber foam	Dunlop
20.	Polyurethan foam	Dunlop
21.	Texture paint	Spectrum / Heritage
22.	MCB	Havell.s / L & T / MDS / Schinder.
23.	Change over switch	L & T /G.E
24.	Modular Switch	MDS / MK / NorthWest
25.	Wires / cables(FRLS)	Finolex / Ploy cab /Havells.
26.	Ceiling fans	Bajaj / Khaitan/ Crompton Greaves
27.	Exhaust fans with louvers	Bajaj / Khaitan/ Crompton Greaves.
28.	Wall mounted fan	Bajaj / Khaitan/ Crompton Greaves/ Havells.
29.	tube light CFL( Single	Philips / Wipro/G.E.
30.	Tube light fixtures ( Double	Philips / Wipro/G.E.
31.	3X36 w recessed fixture	Philips / Wipro/G.E.
32.	12v, 50w halogens	Philips / Wipro/G.E.
33.	MCCB	Havell / L & T / MDS/ABB / Schinder.
34.	ELCB	Havell / L & T / MDS/ Schinder.
35.	Telephone wire	finolex/Delton/ Havell.
36.	Isolator	Havell's/ L & T / MDS/ABB.
37.	LAN Cable (Cat 5)	D-Link
38.	I/O Switch	D-Link
39.	Air conditioning units	Carrier / Blue Star / Hitachi / Voltas(with three star rating)

**All other Materials shall be best quality heavy section mentioned in the drawing as well as in bill of quantities and also approved by Bank / Consultant.**

**DETAILED SPECIFICATION FOR INTERIOR FURNISHING OF**  
**UCO BANK BRANCH AT PIPLIWALA TOWN ,MANIMAJRA.**

Sl. No.	Description of Item	Qty.	Rate (in Rs)	Amount (in Rs.)
<b>A</b>	<b>FURNISHING WORKS</b>			
1.	<b>WALL PANNELING :-</b> Wall paneling to be providing on all wall surfaces and columns, comprising of 1½" x 1" wooden battens ( partial wood ) shall be 2'-0" c/c covered with 6mm thick comm. ply of approved make ( phenol bonded, B.W.P., borer proof, chemically treated )with 1.0 mm thick approved shade& make of laminate shall be fixed on one sides over 6 mm ply with groove pattern and 1 ¼" X ½" teak wood beading Complete job including melamine polish on edge beading, Cornices etc. and painting of grooves in approved colour. All job to be done to architects' satisfaction/ as per bank direction . Wall paneling Ht : 4'-3" Centre pillars to be cladded upto ceiling bottom "(i.e. + 9'-0 level)"	250 sq. ft.		
2. (a)	<b>FULL HEIGHT PARTITIONS.</b> Providing and fixing full height partitions of 2"x2" kailwood/ partial wood frame at 2' c/c both ways and bottom member 4"x2" for skirting. The frame is fixed rigidly at floor level and false ceiling level. 6mm thick commercial ply ( approved made ) with 1.0 mm thick approved shade laminate shall be fixed on both sides. All wood to be painted in wood preservative. Glass (8 mm thick) with etching at the height of 1'-6" upto 7'-0" with etching and doors with lock is to be provided. Teak wood beading 1 ½ " X ½" used for fixing glass is polished to matching laminate shade. The rate include making provision for electrical conduits and switch boxes. All job to be done to architects' satisfaction/ as per bank direction . <b>Full ht. Partition (Ht : 9'x3") for Manager &amp; Strong Room</b>	320 sq. ft.		
(b)	<b>LOW HT. PARTITION FOR COUNTER SEPARATION:--</b> providing and fixed low height partitions made of 2"x2" kail/ partial wood fame at 2'-0" c/c both ways and bottom member 4'x2" for skirting. The frame is fixed rigidly at floor level. 6mm thick commercial ply ( approved make ) with 1.0 mm thick laminate ( approved shade ) shall be fixed both sides. Glass ( 8mm thick, size2'-0"x1'-0") with etching shall provided in the length of partition. New wood beading 1 ½ " X 3 ¼"( melamine polished ) around partition edges complete in all respects. ( height : 4'-6" )	50 Sq. ft.		
(c)	<b>12 MM GLASS IN FRONT OF ALL TABLES</b> Providing & fixing 12mm thick plain glass with acid wash / etching of semi circular or any other approved pattern / texture fixed to steel holders at appropriate distance sufficient in number so as to hold glass complete in all respects .All the visible edges of glass shall be grinded & polished & bevelled .The rates shall be inclusive of cost of all fitting, beadings , making suitable openings for transaction and voice communication etc.	40 Sqft.		
3.	<b>HARDARE</b>			
(a)	Providing and fixing of Godrej /Harrison night latches in cash cabin doors as per the directions of the Bank.	1 Nos.		
(b)	Providing and fixing of Mortice locks of approved make in Main door,Manager's cabin, UPS, Record Room, etc. as per the directions of the Bank.	4 Nos.		
(c)	Providing and fixing hydraulic door closures of approved make & color.	7 Nos.		

4.	<b><u>SWO COUNTER 'S (HT. 4'-0" &amp; 2'-6")</u></b> Providing and fixing cash counter 2'-9" wide having working top at + 2'-6" and 12" wide customer top at + 4'-0". One keyboard drawer ( Size 2' x 1'x3") three cupboard drawers ( size 1'-3" x 1'-6" x 6" – 2 Nos. 1'-3" x 1'-6" x 1'-0" – 1 No.) with proper sliding arrangements and auto lock, one drawer to have provision for storing cash,CPU Shelf, 12" x 18", footrest 3" x 1 ½" are provided below the main working top. Customer top has depressed portion ( 7" x 13"x4") lockable from inside for cash transfer. The counter will have all necessary hardware, laminate band and teakwood beading 1 ½ " X ½" / moulding. Recessed skirting ( ¾") finished with 1.0mm thick laminate below the counter. All inside surfaces are painted with 2 coats of synthetic enamel paint over coat of wood primer. All work is done complete in all respects to architects satisfaction.	10 R. ft.		
5.	<b><u>OFFICER'S COUNTERS:-</u></b> 2'-6" wide & 2'-6" high made of ¾" thick commercial board finished with 1.00 mm thick vertical laminate and 1.5mm thick horizontal laminate of specified and colour one keyboard drawer ( size 2'x1'x3") two cupboard drawer ( size 1'-3" x 1'-6" x 6") with proper sliding arrangement are provided along with storage unit. CPU. Shelf 12" x 18", Foot rest 3" x 1 ½" are provided below the main working top. The counter will have all necessary hardware, laminate band and 1 ½ " X ½" teakwood / partial wood beading / moulding. Recessed skirting (3/4") finished with 1.0mm thick laminate is present below the counter. All inside surfaces are painted with 2 coats of synthetic enamel paint over coat of wood primer. All work is done complete in all respects to architects satisfaction.	6 R. ft.		
6.	Providing and fixing 9" wide and ¾" thick Jet black Granite to be fixed on single window's counters and cash cabin's customer top area with edges moulded, grinded & polished as per design .The slab shall be fixed with Araldite adhesive as directed by the bank / Architect.	25 Sq. ft.		
7.	<b><u>OVER HEAD STORAGE:-</u></b> Providing storage of size 15" x 2'-9" (WXH) of ¾" comm.. board with 1.0mm thick horizontal and vertical laminate having one shelf in center. Cedar wood lipping is provided at edge. Open able shutter with clip hinges ( etching colour ), ball catchers, multi purpose locks are to be provided. All works to be done complete in all respects. The storage unit is properly fixed to wall as per drawing / design at + 5'-9" . concealed tube lights ( 3 Nos. ) to be provided along with electrical wires and connections as per drawing ( Note : Electrical fittings given separately in electrical part	70 Sq. ft.		
8.	<b><u>LOW STORAGE UNIT</u></b> Providing storage unit of size 18"x2'-6" (W x H) of ¾" thick commercial board with 1.0mm thick horizontal laminate and 1.0mm thick vertical laminate having one shelf in center. The storage unit will have all necessary hardware, decorative jalli pattern laminate band and teakwood/ partial wood beading / moulding. Recessed skirting (3/4") finished with 1.0mm thick laminate is present. Clip hinges ( dadoo kabzaa ) to be used for fixing storage unit shutters. All work to be done complete in all respects.	70 Sq. ft.		
9.	<b><u>PIN UP BOARD :-</u></b> Made of 12mm thick soft board covered by 25mm x 25mm teak wood beading painted polished to approved colour and soft board covered with blazer/ fabric cloth of approved colour. Texture and sample approved by architect. Notice	50Sq. ft.		



	Board to be fixed to wall space between storage unit ( ground placed ) and storage unit ( wall hung ) in manager's Cabin & on top of writing table & in Banking Hall. ( basic rate of fabric shall not be less than Rs.65/- per mtr.)			
10.	<b>FALSE CEILING:-</b>			
(a)	Providing and fixing Gypsum board false ceiling in levels as per the detailed drawing - made up of G.I. frames as specified by Gypsum India limited and 12mm thick Gypsum board with suitable suspenders fixed to the ceiling. Ceiling section, perimeter channel, suspenders etc. shall be standard sections supplied by Gypsum India LTD. Spacing of intermediate channels shall be at 1200c/c, and ceiling section at 457mm c/c.the work includes finishing of joints, applying primer, two or more coats of plastic emulsion paints, making cut-out for light fixtures, etc. providing of perimeter channels / beading etc. complete in all respect	650Sq. ft		
11.	<b>MANAGER'S TABLE :-</b> Providing Table for manager (Size5'-6" x 2'-6" x2'-6" )made of ¾" thick commercial board finished with 1.0mm thick horizontal and 1.0mm thick vertical laminate of specified colour and make. 5mm thick plain polished glass (approved make) of same size is placed with edges covered with partial wood beading. Drawer unit ( drawer size: 1'-1" x 1'-6"x6", 3Nos. ) is located on one side with proper sliding arrangement and auto lock are provided along with storage unit. The counter will have all necessary hardware, laminate band and teakwood/ partial wood beading 1 ½ " X ½" / moulding. Recessed skirting ( ¾") finished with 1.0mm thick laminate is present below the counter. In front, apron of ¾" board ( laminate finished ) is provided. Keyboard drawer. CPU shelf 12" x 18" & footrest 3" x 1 ½" etc. to be provided. Laminate colour combination scheme with beading to be followed. All work is done complete in all respects, to architects satisfaction.	1.Nos		
12.	<b>OFFICER'S TABLE :-</b> Providing Table for Officer's(Size5'-0" x 2'-6" x2'-6" )rest specification as per Item No-11.	1.Nos		
13.	<b>SIDE CREDENZA :-</b> Providing and placing side rack made of ¾" thick comm.. board finished with 1.5mm thick horizontal laminate. 4 Drawers ( Size 1'-1" x 1'-3" x 4" ) of ¾" board are placed below. Remaining portion has 2 shutters with 1 shelf. Laminated colour combination scheme to be followed. 5mm thick float glass(approved make) with beading is placed on top. All necessary hardware eg hinges, screws, multipurpose locks, stoppers, drawer slides, ball catchers to be provided along with teakwood / partial wood beading/ moulding . All works to be done complete in all respects.	2.Nos		
14.	<b>WRITING TABLE:-</b> Providing and fixing semi circular writing table of size 3'-6" x 1'-9" at height 3'-9" made of ¾" thick commercial board finished with 1.5mm thick horizontal laminate. In the front two bands of laminate ( 3", 2" wide ) are fixed on to 4mm thick ply. Two vertical boxes of size 5"x 9" are erected upto height: 5-6" of 3.4" thick comm.. board finished with 1.0mm thk. Laminate. On the table top at 4" gap from wall paneling, space is created for placing various forms by vertically placing ¾" thick board ( size 9"x4") flanked by glass ( 8mm thick on either side ( size 7.5" x 4" ) the table top is supported by 1.5" x 1.5" x 2 soot ISA grouted in wall. The top of vertical boxes is finished with horizontal box (6"x 3'-6") made of ¾" thick commercial board . All works to be done complete in	1.Nos		

	all respects.			
15.	<b>SIDE TABLE :-</b> Providing and placing side table of size 2'-0" x 2'-0" x 1'-6" made with 2" x 2" teakwood frame melamine polished with decorative 2 ½" x 1 ½" beading along with 12mm thick Glass on the top. All work is done complete in all respects to architects / bank managements satisfactory .	2 Nos		
16.	<b>Tandem multi seater:-</b> Supplying Stainless steel perforated 3 seater chair for customer area	1.Nos		
17.	<b>CHEQUE DROPPING BOX:-</b> Made of ¾" thick commercial board size 3'-6" x 18" round in shape, 4mm marine plywood at the top cover. Edges covered with 18m x 18mm teak wood beading, door made of 12mm marine plywood to the size of 150mmx 230mm fixed with 2 Nos. of good quality 50mm brass hinges, inner surface painted with one coat of primer and two coats of enamel paint and outside finished with 1 mm thick laminate. <b>Note:-</b> The cheque dropping box is to be fixed to the wall using screws. ____	2.Nos		
18.	<b>TEXTURE PAINT:</b> Ground Floor walls to be finished with texture paint of approved make ( Rustic) above 4'-3" upto ceiling bottom including scaffolding, cleaning & supply of all materials. Also providing & fixing 2" wide hillock wood flat member at junction between ceiling & wall along length.	500Sq. ft.		
19.	<b>ENAMEL PAINT :</b> Applying two or more coats of synthetic enamel paint of approved make over a coat of wood / metal primer on doors, windows, shutters, steel grills, ventilators, etc. as per directions of the bank/Architect.	400 Sq. ft.		
20.	<b>PLASTIC EMULSION PAINT:</b> Applying two or more coats of plastic emulsion paint of approved make over a coat of primer on walls and ceiling. The work includes sand papering, applying of wall putty of Birla make, P.O.P etc. to give even and smooth finish as per directions of the bank.	1000 sq. ft.		
	<b>TOTAL ( FURNISHING WORKS)</b>			
Sl. No.	Description of Item	Qty.	Rate (in Rs)	Amount (in Rs.)
<b>B.</b>	<b>ELECTRICAL WORKS</b>			
1.	<b>COPPER PLATE EARTHING :-</b> Supplying and installation (Testing connection & commissioning of earth stations with 600 mm x 600 mm x 3 mm th. Copper plate electrode complete with 25mm dia. "B" Class G.I pipe 4.5 mtr. deep(minimum)for watering including funnel, 30 cm x 30 cm x 30 cm masonry chamber with cover, 3" P.C.C. Bed in 1:4:8 concrete complete with 100 kgs.salt &200 kgs. charcoal filling ( as per IS : 30435 Revised ) incl. Copper strip 1" wide 4mm th. From copper base plate up to Main Panel Board. Complete job to the satisfaction of the Architect / Bank Management Electrical consultant. The electrode should not be buried less than 5meter deep and the resistant should be less than0.5Ω.	2No.		
2.	<b>ELECTRICAL WIRING AND POINTS :-</b> Providing, laying, fixing & testing of electrical points including wiring with fire retardant, PVC insulated copper wire of Finolex make flame guard quality, moulded plate switches. Sockets of Crabtree / platinum quality / North west / Anchor Roma ( Beige / ivory colour ) in concealed zinc passivated boxes complete with earthing 1.00 mm sq. multistrand wire in pvc pipe 24mmx2mm ISI marked in false ceiling, chased in walls floors, disposal of malba and repair and finished of same with cement mortar as per existing. Complete job to the satisfaction of the architect.			
a)	Wiring light points by laying 2 x1.5 and 1x1.00 copper	40. pts.		

	wire independent control with 6 amp modular type switch. ( 3 pin 5 amp. Switch& socket will be counted as a one point)			
b)	Wiring power points ( 3 pin 15 amp. power plug ) by laying copper wire 2 x 1.5 and 1 x 1.00 in 1" PVC pipe	10. pts.		
3.	<b>MAIN CABLE :-</b> Supplying/erection of copper cable size 4 core 16 sq. mm PVC insulated conductor cable 1100 volts(finolex make. Flame guard quality) grade on existing wall, false ceiling ( concealed in customer lobby ) from meter board to branch panel board.	30. Mtrs.		
4.	<b>MAIN PANEL BOARD.</b> Voltmeter, Am-meter, selector switch ,CTs, back up fuses Incoming: 100 Amp FPMCCB -1 No., 3 phase Neutral 100 Amp copper busbar -1set. 100Amp change over switch with HRC fuses. Outgoing: 100Amp FPMCCB-1No. 63Amp FPMCB-3Nos. 40Amp DPMCCB-2Nos. cable allies on all three sides. The cubicle panel shall be fabricated of 16 gauge MS sheet of superior paint over one coat of primer. The cable shall be properly terminated with the help of cable glands / thimbles etc. ( switches shall be L&T/E-E/Havells / Standard make only).	One set.		
5.	<b>DISTRIBUTION BOARD FOR LIGHT POINTS. POWER POINTS.</b> S/E of 4 WTPN D/B with Incoming -1No 63Amp TPCCB & 6 Amp. for lighting. 1Nos. 63Amp .TPMCB Incoming & outgoing. 63Amps. DPMCB -3Nos. 40Aps. DPMCB-3Nos. for power points. The main incoming in each D/B shall be controlled through ELCB of 30 mA having 30m Sec. Sensitivity. The cost includes making all connections etc. It should be either of havells or standard make For Light points : 1 No ,For Power Points : 1 No	2 Nos.		
6.	<b>Distribution Board for UPS supply :-</b> 12 Way TPN of Indo Asian / Havell / L&T / Heyger make fixed with SP MCB's of 6 AMP. 10A 20A rating complete job including Incoming -63Amps. TPMCB.-1No ,outgoing -6to20 Amps. SPMCB-12 nos for input, output and making all necessary connections for computer circuits, complete in all respects	1. No.		
7.	<b>UPS Wiring For Computer :-</b> Supply and erection of wiring set for computers in zinc passivated boxes embedded in walls/partitions to accommodate 3 Nos. 6 amp switch socket with 2X2.5 sq. mm and 1x1.5 sq. mm copper conductor, PVC insulated ISI marked cable alongwith PVC conduits. Maximum 2 computer terminals to be done to architects	7. pts.		
8.	Supply and Erection of following light fittings, recessed, ceiling mounted or surface mounted, complete job including reflector, CFL / FTL lamps, control gear, connections etc.			
(a)	Wipro make recessed mirror optic luminaire WCF 17336 3 x 36W CFL.	10 Nos.		
(b)	Recessed ceiling light fixture Wipro make compatible for 2x18W CFL lamps. Cat No.wcp36213/218	4 Nos.		
c )	single tubelight with all fittings including fluorescent rods for service area.	10 Nos.		
9.	Supplying / erection of wall mounted fans 15" dia inclusive of erection / testing and commissioning of the same ( Usha Lexus / Compton Greaves/orient).	10 Nos.		
10.	Supplying / erection /commissioning of Heavy duty exhaust fans of Polar/G.E.C/ Compton greaves make of size 12" dia with adjustable louvers complete in all respects.	2Nos.		
11.	Making electrical points for Air-conditioners with 2nos 6 mm sq. thick wires 1no. 4 mm sq. PVC wire of finolax make including under ground conduiting and metal clad enclosure of 32 Amp. switch, socket & plug.	3 Nos.		

	complete in all respects. Three phase servo type AE make or Packard			
12.	Supplying the material and wiring for music system with PVC insulated copper conductor 2x1.0 mm sq. Wires of finolex make laid in PVC conduit concealed manner in ceiling /walls along with cutting and making them good connections etc. Supply , installation ,testing and commissioning of recessed ,radiator type speakers 6 nos. 6 Watts and one DVD player of Philips/ Ahuja/ equivalent. make complete	1.Nos		
13.	Provided and laying telephone 4 pair cable in PVC conduits including all fittings, complete in all respects.	3 Pts.		
14.	Generator connection : Providing and laying copper cable 2x10 sq.mm connections from generator set of 25 KVA from the main board to the outgoing circuits, the light fittings/ fans should be energized through generator set when put to use. Work to be done complete in all respects	1 Nos.		
15.	Connectivity for the VSAT / leaselines (material & labour) – P&F of 40mm PVC conduit of ISI make including data cable of D-link & RJ-45, complete for connectivity.	1 No.		
16.	Providing and fixing refrigerant piping for 3 No. A.C.'s from outdoor units to indoor units with nitrilr rubber insulation. This item includes length of piping beyond 4.0m	20 mtrs.		
17.	Providing and fixing PVC insulated copper electrical cabling of required size for 4 No. A.C.'s from outdoor to indoor units. This item includes length of Cable beyond 4.0m	20mtrs.		
18.	Providing and fixing 25mm diameter threaded drainage piping for 5 No. A.C.'s from outdoor units to indoor units. This item includes length of piping beyond 4.0m	15mtrs.		
	<b>TOTAL ( ELECTRICAL WORKS)</b>			

	SUMMARY:-			
<b>A.</b>	<b>TOTAL OF FURNISHING WORK(BRANCH)</b>			
<b>B.</b>	<b>TOTAL OF ELECTRICAL WORK(BRANCH)</b>			
	<b>TOTAL OF ALL ABOVE ITEMS</b>			
	<b>DISCOUNT (IF ANY)</b>			
	<b>G.TOTAL</b>			

(IN FIGURES) RS \_\_\_\_\_.

(IN WORDS) RS \_\_\_\_\_.

**NAME OF CONTRACTOR:**

**ADDRESS OF CONTRACTOR:**

**ARCHITECT:**

**UCO BANK:**

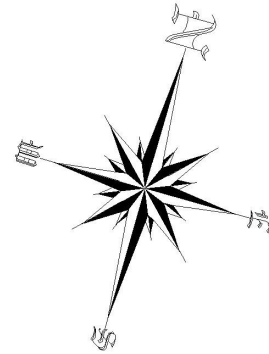
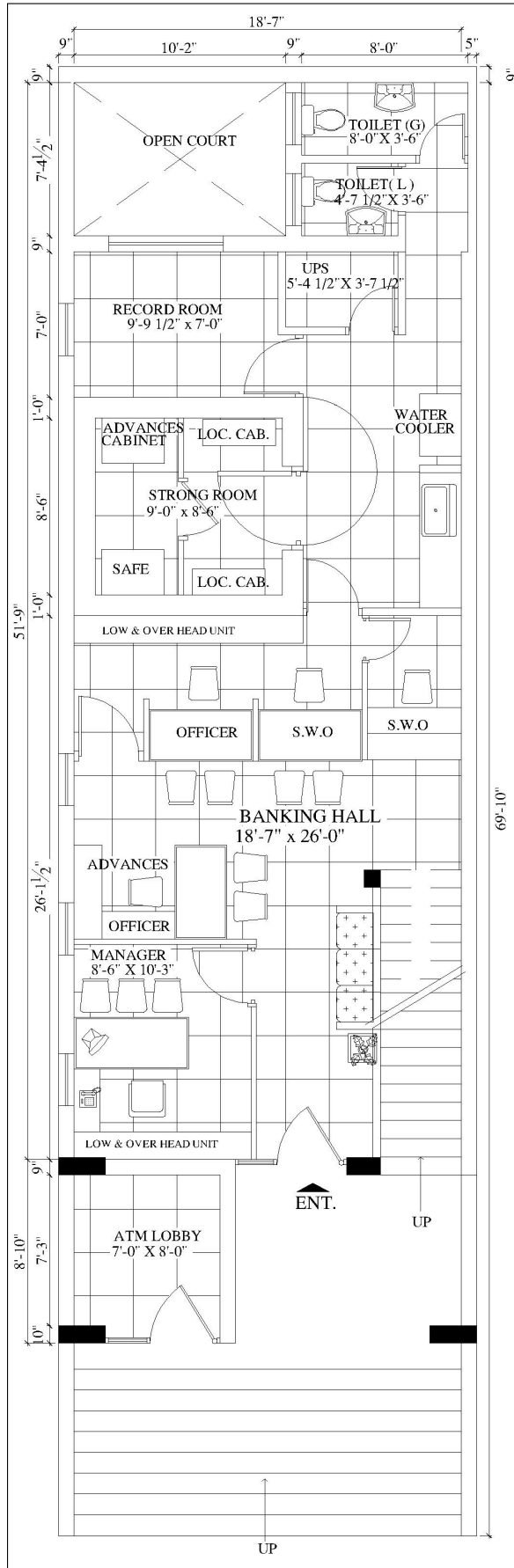

**PROPOSED INTERIOR FOR  
UCO BANK BRANCH  
AT PIPLIWALA TOWN  
MANIMAJRA. ( CHD )**

**GROUND FLOOR PLAN**



**AAKAAR ASSOCIATES**  
ARCHITECTS, ENGINEERS,  
INTERIOR DESIGNERS  
S.C.O. 283, SECOND FLOOR,  
SECTOR-35D, CHANDIGARH.  
Tel.-0172-2601465 (O)  
9417495655(M)

REV.	DESCRIPTION	DATE
JOB NO. .1175	DRG.NO.	DATE:-
SCALE: 1"=1'-0"	NAME	SIGN.
DRN.BY	PARDEEP	
CHKD.BY		
APRD.BY	NEERAJ	