

**UCO BANK
ZONAL OFFICE, INDORE**

TENDER DOCUMENTS

**FOR EMPANELLED VENDORS UNDER UCO BANK,
ZONAL OFFICE INDORE**

TENDER NO.ZOI/GAD/162/2022-23/ DATED: 14-11-2022

**PROPOSED INTERIOR FURNISHING, ELECTRICAL FURNISHING &
LAN CABLING WORKS AT PROPOSED BRANCH PREMISES AND A.T.M. OF
UCO BANK AT SUPER CORRIDOR, INDORE (M.P.)**

VOLUME-I

TENDER ISSUED TO: -

LAST DATE OF SUBMISSION: - 21.11.2022 Time 4.00 PM

DATE OF OPENING : - 21.11.2022 Time 4.30 PM

Signature of Contractor

TENDER NOTICE

To,
Contractors Empanelled in UCO Bank (Interior & Electrical) Pre qualified for the
proposed Interior Furnishing, Electrical, Civil, & LAN Cabling Work.

Dear Sir,

**PROPOSED INTERIOR FURNISHING, ELECTRICAL FURNISHING & LAN CABLING WORKS AT
PROPOSED BRANCH PREMISES AND A.T.M. OF UCO BANK AT SUPER CORRIDOR, INDORE
(M.P.)**

We refer to your application for pre qualification for the captioned work and are
pleased to inform you that you have been pre qualified for the captioned work. You
are now invited to quote for the above works as per details given below: -

NAME OF WORK	EARNEST MONEY (Rs)	TENDER COST (Rs)	TIME OF COMPLETION
PROPOSED INTERIOR FURNISHING, ELECTRICAL FURNISHING & LAN CABLING WORKS AT PROPOSED BRANCH PREMISES AND A.T.M. OF UCO BANK AT SUPER CORRIDOR, INDORE (M.P.)	Rs. 7000/-	Rs. 500/-	30 Days

1. An Earnest Money Deposit of Rs. 7,000/- (Rupees Seven Thousand only) shall be submitted along with tender document at ZONAL OFFICE Indore by Pay Orders/DD issued by a Nationalized Bank only, in the name of UCO BANK ZONAL OFFICE, Indore. A tender which is not accompanied Earnest Money Deposit will be rejected. The Earnest Money Deposit of the unsuccessful tenderers will be returned as soon as possible but without any interest.
2. **Tender Cost-** 500./-

The last date of submission of tenders is up to **4.00. P.M. on 21/11/2022.**

4. The Tenders shall be opened /evaluated at. **4.30 P.M. on 21/11/2022** in the office of The Dy. General Manager, ZONAL OFFICE Indore in the presence of authorized competent representative the tenderer along with authorization letter, who can take decision on the spot in the matter.

Signature of Contractor

.....
Branch/ Office:- General Administration department, zonal office, 2nd floor, 380-381, Saket nagar, indore-452018

सामान्य प्रशासन विभाग, आंचलिक कार्यालय, दूसरा तल, 380-381, साकेत नगर, इन्दौर पिन -452018

Email: zoindore.gad@ucobank.co.in Contact: 0731-2438300

5. UCO BANK reserves the right to accept or reject any or all the tenders without assigning any reasons for doing so.

Yours faithfully,

UCO BANK

LETTER OF OFFER/TENDER

To,
The Zonal Manager,
UCO Bank,
Zonal Office,
Indore.

NAME OF WORK: Interior Works for UCO Bank BO: SUPER CORRIDOR, INDORE (M.P.).

Sir,

1. Having visited the site and examined the drawings, conditions of contract, special conditions of contract, General specifications and detailed specifications, schedules and bill of quantities for the construction of the above named works, we offer to construct, complete and maintain the whole of the said works in conformity with the said drawings, conditions of contract, specifications, schedules and bill of quantities for the sum State in bill of quantities of this Tender Document or such other sum as may be ascertained in accordance with the said conditions of contract.
2. We undertake to complete and deliver the whole of the works comprised in the contract within the time State in the appendix hereto.
3. We have independently considered the amount of liquidated damages shown in the Appendix hereto and agree that it represents a fair estimate of the loss likely to be suffered, by you in the event of the works not being completed in time.
4. We agree to abide by this tender for the period of 90 days from opening of envelope 3 or extension there of as required by the employer from the date fixed for receiving the same and it shall remain binding upon us and may be accepted at any time before the expiry of that period.
5. We confirm that the period and rates as referred in the agreement or general conditions of contract are given or summarized in the appendix hereto, to which we give our consent and agree to abide by the same.
6. If this tender is accepted, we undertake to enter into and execute at our cost, when called upon by the employer to do so, a contract agreement in the prescribed form. Unless and until a formal agreement is prepared and executed this tender together with your written acceptance thereof, shall constitute a binding contract between us.

7. We understand that if our tender is accepted, we are to be jointly and severally responsible for the due performance of the contract.
8. We understand that you are not bound to accept the Lowest or any tender you may receive and may reject all or any tender, accept or entrust the entire work to the contractor or divide the work to more than one contractor without assigning any reason or giving any explanation whatsoever.

Signature of Contractor

Defects Liability period	12Months from the date of virtual completion.
Date of commencement	07 days from the date of acceptance letter is issued to contractor or day on which the contractor is instructed to take possession of the site whichever is later.
Time of completion	30 Days from the date of commencement.
Period of Final Measurement	One month from the date of virtual completion
Liquidated damages	1% of the tendered amount shown in the tender per week subject to the ceiling of 10% of the accepted contracted sum.
Minimum value of work for interim certificate	<u>5.00 Lacs</u> (This value shall be the difference of work done of two consecutive bills).
Initial security deposit	2% of the accepted value of the tender including the earnest money to be deposited within 15 days after awarding of the contract.
Retention percentage	(i) 10.00% on the first Rs. 1, 00,000.00 of the cost of the work. of the accepted tender amount. (ii) 7.5% on the next Rs. 1, 00,000.00 of the cost of work. (iii) 5% on the next amount upto Rs. 2 crores of the cost of work. (iv) 2% for the amount in excess of Rs. 2 crores of the cost of work subject to a ceiling on the Total Security Deposit at Rs, 25, 00,000.00.
Refund of total security comprising of EMD, ISD and Retention	Total Security deposit will be released 14 days after the end of the defect liability period & upon receipt of "no defect certificate" from the branch.
Period of honoring Certificate	15 days from date of receipt of certificate from the Architect.

To,
The Zonal Manager
ZONAL OFFICE
UCO BANK, Indore
Tel: + 0731-2438300
E mail- zo.Indore@ucobank.co.in

ZO Incharge/ supervision:
Mr -Atul kumar Yadav
Mobile no. 9691478700
E-mail- zoIndore.gad@ucobank.co.in

Signature of Contractors

यूको बैंक
सम्मान आपके विश्वास का



UCO BANK
Honours Your Trust

APPROVED MAKES & SPECIFICATIONS

LIST OF APPROVED MATERIAL AND MAKES OF ITEMS

(THE MAKE LISTED BELOW SHOULD BE FIRST APPROVED BY THE BANK BEFORE USE IN CONSTRUCTION)

- | | | |
|-----|---|--|
| 01. | BLOCK BOARDS | : 19.00 MM BWR GRADE CONFORMING TO IS 1659 CENTURY / GREEN PLY / AUSTIN / KITPLY / 'ARCHID PLY' / 'DURO' / DURIAN. |
| 02. | PLYWOOD SHEETS | : 4 MM / 6MM/ 12MM /19MM CONFORMING TO IS 710 (BWR GRADE) CENTURY / GREEN PLY / AUSTIN / KITPLY / 'ARCHID PLY' / 'DURO' / DURIAN. |
| 03. | LAMINATED ON VERTICAL SURFACE | : 1.0 MM CONFORMING TO IS 2046 ARCHIDLAM, ROYAL CROWN, AIROLAM, XYLEM OR AXILAM. |
| 04. | LAMINATED ON HORIZONTAL SURFACE | : 1.5 MM CONFORMING TO IS 2046 ARCHIDLAM ROYAL CROWN, AIROLAM, XYLEM OR AXILAM. |
| 05. | HINGES, MAGNETIC CATCHERS, SLIDING CHANNEL, HANDLES, TOWER BOLTS | : GODREJ OR 'HETTICH |
| 06. | LOCKS & CUPBOARD LOCKS | : 'GODREJ' OR 'DOORSET' OR 'HETTICH ' |
| 07. | FLOOR SPRINGS & DOOR CLOSERS | : HETTICH' OR 'EBCO' OR 'DOORWAY'/DORMA |
| 08. | GLASS & MIRRORS | : 'MODIFLOAT' OR 'SAIN GOBAIN' OR "ASAHI" (BRANDED) |
| 09. | MELAMINE POLISH & SEALER | : 'M.R.F.' OR 'NEROLAC' OR 'ASIAN' |
| 10. | SCREWS, NUTS & BOLTS ETC. | : 'NETTLE FOLD' OR 'GKW' |
| 11. | ADHESIVE & GLUE | : 'FEVICOL' OR 'PIDILITE' OR 'ARALDITE' |
| 12. | HARDWARE FITTINGS | : 'EVERTITE' OR 'ABRO' OR 'GKW' |
| 13. | P.O.P. FALSE CEILING | : 'GYPBORD' OF INDIA GYPSUM LTD |
| 14. | RUBBERIZED FOAM & EDGES | : 'MANGALAM' OR 'M.M.F |
| 15. | TAPESTRY & UPHOULSTERY CLOTH | : IN THE PRICE RANGE OF RS. 350/- PER R.MT. |
| 16. | VERTICAL BLINDS | : 'VISTA LEVOLOR' OR 'ROYAL TOUCH' |
| 18. | GALVANIZED IRON PIPES (HEAVY DUTY) | : 'TATA' OR 'SWASTIK' OR 'JINDAL' |
| 19. | GALVANIZED IRON FITTINGS (HEAVY DUTY) | : 'UNIQUE' OR 'D.G.' OR 'JET' |
| 20. | WOOD FOR JOINERY FRAMES, PARTITIONS: NATURALLY SEASONED, FIRST CLASS PINE | |

Signature of Contractor



PANELLING, DOORS, SHUTTERS, FURNITURE, WOOD, WITHOUT BLACK MARKS/PATCHES COUNTERS, CABINETS, TABLES ETC. OF FUNGUS AND SHALL BE GOT APPROVED FROM THE ARCHITECT & BANK'S ENGINEER BEFORE BRINGING THE SAME AT SITE.

SECTIONAL SIZES STATED IN DESCRIPTION OF SPECIFICATIONS OF ALL THE TENDER ITEMS ARE FINISHED SECTIONAL SIZES.

NOTE:

1. THE CONTRACTOR SHOULD OBTAIN PRIOR APPROVAL FROM EMPLOYER / CONSULTANTS BEFORE PLACING ORDER FOR ANY SPECIFIC MATERIALS. EMPLOYER MAY / DELETE ANY OF THE MAKES OR BRANDS OUT OF THE ABOVE LIST.
2. ALL MATERIALS SHOULD CONFORM TO RELEVANT STANDARDS AND CODES OF BIS.
3. MATERIALS WITH I.S.I. MARK SHALL BE USED DULY APPROVED BY THE BANKS ENGINEER /ARCHITECT.

NOTE: - IF ANY MATERIAL IS FOUND TO BE NOT UP TO THE MARK, THE CONTRACTOR WILL HAVE TO PRODUCE ORIGINAL BILLS/CERTIFICATE FROM THE MANUFACTURER OR HIS AUTHORIZED DISTRIBUTOR FOR AUTHENTICITY AND GENUINENESS OF THE MATERIAL FOR CONSIDERATION AND AS PER MAKE APPROVED BY THE BANK. THE SAME WILL NOT BE CONSIDERED FOR PAYMENT.

SEAL & SIGNATURE OF THE CONTRACTOR,

DATED:

ADDRESS:

यूको बैंक

सम्मान आपके विश्वास का



UCO BANK

Honours Your Trust

LIST OF APPROVED MATERIAL AND MAKES OF ITEMS

ELECTRICAL		
1.	MCB / DB'S	MDS LEGRAND (DOUBLE DOOR DB'S), L & T, HAVELLS , LEGRAND RX MCB, DBS – IP 54 PROTECTION
2.	CABLE / WIRE	R.R. , HAVELLS, POLYCAB MAKE CONFORMING TO IS 1554 , I) GRADE TO BE 1100 VOLTS FRLS
3.	TPN- SFU	L & T TYPE FN, LEGRAND, HAVELLS.
4.	SWITCHES EXCEPT COMPUTER	HAVELLS ,ANCHOR ROMA, LEGRAND ,SCHNEIDER WITH MODULAR BOARDS
5.	SWITCH BOARD FOR COMPUTER	HAVELLS, LEGRAND , SCHNEIDER.
6.	LIGHT FITTINGS	CROMPTON, JAQUAR, PHILLIPS.
7.	TELEPHONE CABLE	R.R. , GLOSTER, FINOLEX (CONDUCTOR DIA – 0.61 SQ.MM)
8.	PVC PIPE / CONDUIT WITH BENDS	AKG, BEC (ISI), CROWN -2 MM THIK
9.	INDUSTRIAL SOCKET WITH BOX	MDS LEGRAND, - 32 AMP/ HAGER L&T
10.	CHANGE OVER SWITCHES	BENLO , LEGRAND , HAVELLS ON LOAD (EURO LOAD)
11.	MCCB	L&T, HAVELLS, LEGRAND, SCHNEIDER.
12.	PANEL BOARD	16 SWG CRCA SHEET STEEL FABRICATD AND VERMIN PROOF AND DUST PROOF WITH NECESSARY STIFFERNERS WITH INDICATORS OF TELEMACHENIQUE /L&T AND INPUT / OUTPUT VOLT & AMPERE METER
13.	CTS AND BOARD	L&T / CSG
14.	CEILING FAN EXHAUST FAN / WALL FAN	POLYCAB , CROMPTON/USHA/BAJAJ/HAVELLS,

AT THE TIME OF STARTING OF THE WORK PRINT OF WIRING DIAGRAM IS TO BE SUBMITTED. AFTER COMPLETION OF THE WORK COMPLETION REPORT WITH WIRING DIAGRAM IS TO BE SUBMITTED.

NOTE: ELECTRICAL WIRING SHALL BE COLOUR CODED AS FOLLOWS:

FOR PHASE - RED/ YELLOW / BLUE UNIFORMLY THROUGH OUT

FOR NEUTRAL - BLACK

FOR EARTH – GREEN

NOTE : * THE ABOVE APPROVED MAKES ARE TO BE USED IN ELECTRICAL FURNISHING AND CIVIL WORKS.

** WHEREVER MAKES ARE NOT INDICATED OR EQUIVALENT MAKES ARE TO BE USED, THE PRIOR WRITTEN PERMISSION FROM THE PROJECT ARCHITECTS NEEDS TO BE TAKEN BEFORE EXECUTION OF WORK.

*** ONLY APPROVED MATERIALS SHALL BE DELIVERED TO SITE.

Signature of Contractor



LIST OF APPROVED MAKES /MATERIALS FOR AIR CONDITIONER INSTALLATION

S.NO	SPECIFICATION	MAKE
1	ELECTRICAL WIRE CABELLING 1.5MMX6 CORE	POLYCAB/PHINOX
2	ELECTRICAL WIRE CABELLING 6.0MMX4 CORE	POLYCAB/PHINOX

PREAMBLE TO SCHEDULE OF QUANTITIES

NOTE: 1) IF THE MAKE OF MATERIAL /ITEMS WITH SPECIFICATIONS RELATED TO THE ITEMS IN BILL OF QUANTITY OF PRICE BID OF TENDER FORM ARE NOT MENTIONED IN LIST OF APPROVED ITEMS THEN MAKE OF MATERIAL /ITEMS WITH SPECIFICATIONS MENTIONED IN PRICE BID ARE TO BE FOLLOWED.

2) THE CONTRACTOR SHOULD OBTAIN PRIOR APPROVAL FROM EMPLOYER / CONSULTANTS BEFORE PLACING ORDER FOR ANY SPECIFIC MATERIALS. EMPLOYER MAY / DELETE ANY OF THE MAKES OR BRANDS OUT OF THE ABOVE LIST.

3) ALL MATERIALS SHOULD CONFORM TO RELEVANT STANDARDS AND CODES OF BIS.

4) MATERIALS WITH I.S.I. MARK SHALL BE USED DULY APPROVED BY THE BANKS ENGINEER / ARCHITECT.

5) IF ANY MATERIAL IS FOUND TO BE NOT UP TO THE MARK, THE CONTRACTOR WILL HAVE TO PRODUCE ORIGINAL BILLS/CERTIFICATE FROM THE MANUFACTURER OR HIS AUTHORIZED DISTRIBUTOR FOR AUTHENTICITY AND GENUINENESS OF THE MATERIAL FOR CONSIDERATION AND AS PER MAKE APPROVED BY THE BANK. THE SAME WILL NOT BE CONSIDERED FOR PAYMENT.

6). WHILE QUOTING RATES FOR EACH ITEM OF WORK, THE CONTRACTOR SHALL INCLUDE FOR THE FOLLOWING IRRESPECTIVE WHETHER IT HAS BEEN MENTIONED OR NOT IN THE DESCRIPTION OF THE ITEM WITHOUT ANY EXTRA CLAIM / PAYMENT.

SEAL & SIGNATURE OF THE CONTRACTOR,

DATED:

ADDRESS:

ARTICLES OF AGREEMENT

This agreement made this.....day oftwo thousand twelve between **UCO Bank**, a body corporate constituted under the Banking Companies (Acquisition & Transfer of Undertaking) Act 1970, having its Head Office at 10 B T M Sarani, Kolkata-700001 (herein after called "**The Employer**") of the ONE PART and **M/s** herein after called "**The Contractor**" which includes it's heir/successors (herein after called "the Guarantor") of the OTHER PART. WHEREAS the Employer is desirous of certain works should be executed viz. Interior Works for UCO Bank BO **SUPER CORRIDOR BRANCH, INDORE(M.P.)** & has by letter of acceptance dated _____ accepted a tender by the contractor for the execution, completion, and maintenance of such works, now THIS AGREEMENT WITNESSES as follows :

4.1 In this agreement words & expressions shall have the same meaning as are respectively assigned to them in the said conditions of contract hereinafter referred to:

4.2 The following documents shall be deemed to form & to read construed as part of this agreement, viz.

i) Original tender document. ii) Relevant correspondence all letters/correspondence forming part of contract and referred to in acceptance letter. iii) Acceptance letter. iv) Bill of quantities. v) The drawings. vi) Time and progress chart. vii) Other additional documents as required,

a)

b)

c)

viii) Article of Agreement.

4.3 The aforesaid documents shall be taken as complementary and mutually explanatory of one another, but in the case of ambiguities or discrepancies the latest documents issued by the Bank shall prevail over on earlier documents.

4.4 In consideration of the payment to be made by the employer to the contractor as hereinafter mentioned, the contractor hereby covenants with the employer to perform execute, complete and maintain the work in conformity in all respects with the provision of the contract.

4.5 The employer hereby covenants to pay the contractor in consideration of the execution, completion and maintenance of the works such sums as shall become payable hereunder at the time(s) and in the manner prescribed in the said conditions and price schedule of quantities/bill of quantities prescribed in the contract.

IN WITNESS where of the parties here to have caused their respective common seals to be hereunto affixed (or have here un to set their respective hands and seals) the day, month and year first above written.

Signature of Contractor

SIGNED AND SEALED AND DELIVERED BY THE

Said _____

(Name _____)

on behalf of the contractor

In the presence of

Name: _____

Address: _____

said _____

(Name _____)

on behalf of the employer

In the presence of

Name: _____

Address: _____

* This form is included in the tender documents only for the information of the tenderers. Only the successful tenderer will be, in due course, required to complete the form.

GENERAL CONDITIONS OF CONTRACT

Except where provided for in the description of the individual items in the Schedule of Quantities or B.O.Q. and in the Specification and Conditions laid down hereinafter and in the drawings / instructions, the work shall be carried out as per the Indian Standard Specifications and under the direction of Bank.

1, INTERPRETATION:-

In construing these conditions, the specifications, the Schedule of Quantities, Tender and Agreement, the following words shall have the meaning here in assigned to them except where the subject or context otherwise requires :-

Employer/The Bank:The term Employer / Bank / The Bank shall denote UCO BANK with their ZONAL OFFICE at Indore, or any of its employees representative authorized on their behalf.

Contractor:The terms Contractor shall mean M/s. -----

_____, and his/their heirs, legal representatives, assigns and successors.

Site:The site shall mean Proposed Interior work for UCO BANK, **SUPER CORRIDOR BRANCH, INDORE(M.P.)**.

The "**Work or Works**" shall mean the works to be executed or done under this contract. "Act of Insolvency" shall mean any act as such as defined by the Presidency Town Insolvency Act or in Provincial Insolvency Act or any amending statutes.

"The Schedule of Quantities" shall mean the Schedule of Quantities OR Bill of Quantities as specified and forming part of this contract.

"Priced Schedule of Quantities" shall mean the schedule of quantities duly priced with the accepted quoted rates of the Contractor.

"Notice in Writing" or "Written notice" shall mean a notice Written, typed or in printed characters sent (unless delivered personally or otherwise proved to have been received) by registered post to the last known private or business address or registered office address and shall be deemed to have been received when in the ordinary course of post it would have been delivered.

Completion shall mean that the works are in the opinion of the Bank complete and fit for acceptance.

Signature of Contractor

2. SCOPE OF WORK:-

The work consists of the Proposed INTERIOR FURNISHING Work for B/o **UCO BANK SUPER CORRIDOR BRANCH, INDORE(M.P.)** in accordance with the "Scheme for the Interior work and "Schedule of Quantities". It includes INTERIOR FURNISHING all materials, labors, tools and equipment and management necessary for the incidental to the progress and for completion of the work. The Bank may in their absolute discretion issue further drawings and/or written instructions/details/orders/directions and explanations etc. in respect of.....

- a) The variation or modification of the design, or quantity of works or the addition or omission or substitution of any work.
- b) Any discrepancy in the drawings or between the schedule of quantities and or drawings and or specification.
- c) The removal from the site of any defective material brought there on by the Contractor and the substitution of any other material thereof.
- d) The demolition removal and / or re-execution of any work executed by the Contractor/s.
- e) The dismissal from the work of any persons employed there upon.
- f) The opening up for inspection of any work covered up.
- g) The rectification and making good of any defects under clauses hereinafter mentioned and those arising during the maintenance period (retention period).

The Contractor shall forth with comply with and duly execute any work as per the Bank's instructions, provided always the verbal instructions, directions and explanations given to the Contractors or his representative upon the works by the Banks shall if involving a variation be confirmed in writing by the Bank to the Contractors within seven days. No works for which rates are not specifically mentioned in the priced schedule of quantities shall be taken up without written permission of the Bank. Rates of items not mentioned in the priced schedule of quantities shall be fixed by the Bank as provided in Clause "Variation".

The contractor shall set up a field laboratory with necessary equipments for day

To day testing of materials like grading of coarse and fine aggregates, silt content, bulk age of sand etc.

Regarding all factory made products for which ISI marked products are available, only products bearing ISI marking shall be used in the work. Other products shall be supplied as per the brand name mentioned in the Technical Specifications.

3. DRAWINGS AND INSTRUCTIONS:-

The work shall be executed in conformity with the drawings and instructions. Immediately after receipt of the work order of the contract, the Contractor shall prepare a progress schedule and The Bar Chart and submit the same to the Bank for approval within 7 days which shall indicate the dates for the starting and completion of the various stages of works.

4.ROYALTIES / PATENTS:-

The Contractor shall pay all royalties and license fees. He shall defend all suits or claims for infringement of any patent rights and shall save the Bank harmless from loss on account thereof.

5 TECHNICAL EXAMINATIONS:-

The proposed work covered under this tender during its progress or after completion

is subject to inspection/examination by the Chief Technical Examiner / Technical Examiner, Central Vigilance Commission, Govt. of India or by an Auditor, Officer of the vigilance Cell of the Authority, on behalf of the Engineer-in-charge. The Contractor will be required to extend all co-operation, assistance and facilities for such inspection and thereafter complying their observation. All the observation of such authorities will be final and binding on the Contractor. If as a result of this examination or otherwise any sum is found to have been overpaid or over certified it shall be lawful for the Bank to recover the same The Bank shall have also right to cause a technical scrutiny of the works and the bills of the contractor including all supporting vouchers, challans, abstracts etc. If as a result of this scrutiny any sum is found to have been overpaid or over certified it shall be lawful for the Bank to recover the same.

6- SUPERITENDENCE AND SUPERVISION

The Contractor shall give all necessary personal Superintendence during the execution of the work and this obligation and liability will continue until expiration of the "Maintenance Period" (Retention Period) The Contractor shall also during the whole time of work when in progress employ one competent and experienced Engineer & one supervisor having technical background who shall be constantly in attention at the site while his men are at work. Any directions, explanations, instructions or notices given by the Bank to such representative shall be deemed to have been given and duly served on the Contractor.

Signature of Contractor

7- FAILURE BY CONTRACTOR TO COMPLY WITH BANKS/

CONSULTANTS INSTRUCTIONS:-

If the Contractor after receipt of written notice from the Bank requiring compliance within ten days fails to comply with such further drawings and / or Banks / Consultant's instructions, the Bank may employ other person to execute any such work whatsoever that may be necessary to give effect therefore and pay all cost incurred in connection therewith and same shall be recoverable from the Contractor by the Bank as a debt or shall have right to deduct same from any money due or to become due to the Contractor.

8. TENDERER SHALL VISIT THE SITE:-

Before submission of the tender, the intending tenderers is bound to visit the site and make him thoroughly acquainted with the local site condition, space restrictions, nature and requirements of the works, transport condition, labor and materials, access and storage for materials and removal of rubbish. The tenderers shall have to provide in their tender for cost of carriage, freight and other charges as also for any special difficulties and including police restriction for transport etc., for proper execution of work as indicated in the contract. The successful tenderers will not be entitled to any claim of compensation for difficulties faced by him or losses incurred on account of any site condition / restrictions which existed before the commencement of the work or which in the opinion of the Bank might be deemed to have reasonably been inferred to be so existing, before commencement of work.

9. FILLING OF TENDERS:-

The entire set of tender paper issued to the tenderer shall be submitted fully priced and also signed on the last page of each component together with initials on every page. Initial / Signature will indicate the acceptance of the tender papers by the tenderers.

The schedule of quantities shall be filled in as follows:-

- a) The Rate Column to be legibly filled in ink in both English figures and English words. No overwriting is permitted.
- b) Amount column to be filled in for each item and the amount for each sub-head as detailed in the "Schedule of Quantities".
- c) All corrections are to be signed and authenticated.
When there is difference between the rates in figures and in words the rate, in words filled up by the Contractor shall be taken as correct, if for any item, amount is not given or the amount given does not correspond to rate either in words or in figures then the amount will be calculated based on the rate quoted in words
Signature of Contractor
- e) If the contractor does not quote for any item, then their tender will be evaluated based on the highest rate of all other tenderers for that item. Even after evaluation based on this, the contractor

happens to be the lowest, they may be awarded the work, however, payment for this item will be based on the lowest rate of all the tenderers or the rate decided by the Bank.

No modification writings or corrections can be made in the tender papers by the tenderer, but may at his option offer his comments or modifications in a Separate sheet of paper attached to the original tender papers.

The Bank reserves the right to reject the lowest or any tender and also to discharge any or all the Tenders for each section or to split-up and distribute any item of work to any specialist firm or firms, without assigning any reason.

The tenderers shall note that the tender is strictly on the item rate basis and their attention is drawn to the fact that the rates for each and every item shall be correct, workable and self-supporting, If called upon by the Bank detailed analysis of any or all the rates shall be submitted. The Bank shall not be bound to recognize the Contractor's analysis.

The works will be paid for "Measured Work" on the basis of actual work done.

All items of work described in the schedule of quantities are to be deemed and paid as complete works in all respects and details including preparatory and finishing works involved, directly related to and reasonably detectable from the drawings, specifications and schedule of quantities and no further extra charges will be allowed in this connection.

The Bank has power to add to or omit from any work as shown in drawings or described in specification or included in schedule of quantities and intimate the same in writing but no addition, omission or variation shall be made by the Contractor without authorization from the Bank. No variation shall vitiate the contract.

A Schedule of Probable Quantities in respect of each work and specifications accompany these Special Conditions. The Schedule of Probable Quantities is liable to alteration by omissions, deductions or additions at the discretion of the Bank. Each Tender shall contain not only the rates but also the value of each item of work entered in a separate column and all the items shall be totaled in order to show the aggregate value of the entire Tender.

The tenderer must obtain for himself on his own responsibility and at his own expenses

all the information which may be necessary for the purpose of making a Tender and for entering into a Contract and must examine the Drawings and must inspect the Site of the work and acquaint himself with all local conditions, means of access to the work, nature of the work and all matters appertaining thereto.

The rate quoted shall be deemed to be for the finished work to be measured at Site. The rates shall also be firm and shall not be subject to exchanged variations, labour conditions, fluctuation in Railway Freights or any conditions whatsoever. Tenderers must include in their rates GST, Sales

Tax, Excise Duty, Octroi, and any other Tax and Duty or other levy levied by Central Government or any State Government or Local Authority if applicable. No claims in respect of GST, Sales Tax on Works Contract, Excise Duty, Octroi, Vat or other Tax, Duty or Levy whether existing or future shall be entertained by the Employer. However Service Tax will be paid extra as per prevailing govt. rules.

The Contractor shall note that unless otherwise stated, the Tender is strictly on item rate basis and his attention is drawn to the fact that rates for each and every item shall be correct, workable and self-supporting. The quantities in the Schedule of Quantities approximately indicate the total extent of work but may vary to any extent and may even be omitted thus altering the aggregate value of the Contract. No claim shall be entertained on this account.

The Contractor shall visit and examine the Site and satisfy himself as to the nature of the existing roads or other means of communication, the character, the extent and magnitude of the work and facilities for obtaining materials and shall obtain generally his own information on all matters affecting the execution of the work. No extra charge made in consequence of any miss-understanding or incorrect information or any of these points or on the grounds of insufficient description will be allowed. All expenses incurred by the Contractor in connection with obtaining information for submitting this tender including his visits to the Site or efforts in compiling the tender shall be borne by the Tenderers and no claim for reimbursement there of shall be entertained.

10. TIME -SCHEDULE FOR COMPLETION OF WORK:

The Contractor shall have to submit a time and progress Bar chart in a from approved by the Bank within seven days from the date of issue of **work order**.

The Contractors shall have to put all their resources and endeavor to complete the work, if possible earlier than the schedule time shown in the programmed. Keeping the general target dates as given in the Bar Chart of tender, the Contractors shall have to prepare detailed PERT Network showing in addition to the items already indicated in the programmed other items, the completion of which would affect the overall time schedule of the programmed. This Network programmed shall clearly indicate the completion of project. The Contractors shall have to prepare their own material in flow according to the final Network programmed as accepted by the Bank. Network programmed shall have to be update at regular intervals and modified programmed shall be submitted to the Architects/ Bank for programmed shall be changed without prior consent of Bank.

11. PERMITS AND LICENSES:-

Permits and License for release of any which are materials if are under Government control will be arranged by the Contractor. The Bank will render necessary assistance, sign any forms or applications that may be necessary. Charges are to be borne by the Contractor.

12 GOVERNMENT AND LOCAL RULES:-

The Contractor shall conform to the provisions of all local Bye-laws and Acts relating to the work and to the Regulations etc. of the Government and Local Authorities and of any company UNDER WHOSE JURISDICTION the work is to be carried out. The Contractor shall give all notices required by said Act, Rules, Regulations and Bye-laws etc. and pay all fees payable to such Authority/authorities execution of the work involved. The cost, if any, shall be deemed to have been included in his quoted rates, taking into account all liabilities for licenses, fees for footpath encroachment and restoration etc. and shall

Indemnify the Bank against such liabilities and shall defend all actions arising from such claims or liabilities.

13. TAXES AND DUTIES:-

Contractors Only Empanelled For UCO Bank (Interior & Electrical) to quote the rates exclusive of all Taxes & GST.

14. SETTLEMENT OF DISPUTES:-

Excepted Matters

If any dispute or difference pertaining to the under noted matters arises, the decision in writing of the supervising Architect / Bank's General Manager shall be, conclusive and binding on the Contractor/s.

- a) Written Instructions.
 - b) Permissions from Local Authorities.
 - c) Proof for quality of materials and the works.
 - d) Assigning or sub letting of the contracted works.
 - e) The causes of delays and extension of time.
 - f) Rectification of defects during the progress and Defects Liability Period.
 - g) Contractor's due diligence care and supervision at the works.
 - h) Measurements of works.
 - i) Reports on quality and progress of works.
 - j) Contractor's abandoning of the contract, partially / fully.
- 15.** Notice of termination / determination of the contract by the Employee.

QUANTITIES FOR ITEMS OF WORK:-

The quantities shown in the schedule of quantities are estimated to cover the entire work but the Bank reserves the right to execute only a part or the whole or any excess thereof without assigning any reason thereof and shall not entertain any claim for compensation except at the rates quoted in the price bid.

The Contractor on his Own shall not execute any work beyond the tender quantities for the various items, unless specifically approved by the Employer.

The contractor is bound to carry out any and all the items of work necessary for the completion of the job even though such items are

not included in the quantities and rates. Instructions in respect of such additional items, their quantities and rates will be issued in writing by the Consultant with the prior consent in writing of the Employer.

16. OTHER PERSONS ENGAGED BY THE BANK:-

The Bank reserves the right to execute any part of the work included in this contract or any work which is not included in this contract by other Agency or persons and contractor shall allow all reasonable facilities and use of his scaffolding for the execution of such work. The Contractor shall extend all co-operations in this regard.

17. EARNEST MONEY AND SECURITY DESPOSITS:-

The Tenderer will have to deposit an amount of **Rs.11,000-(Rupees Eleven Thousand Only)**, in the form of Pay Order drawn in favour of UCO BANK Indore , at the time of submission of the Tender as an Earnest Money Deposit. The Bank is not liable to pay any interest on the Earnest Money. The Earnest Money of the unsuccessful Tenderers will be refunded without any interest soon after the decision to award the work is taken or after the expiry of the validity period of the Tender.

The successful Tenderer to whom the contract is awarded will have to deposit as **"Initial Security Deposit" (ISD)** a further sum to make up 2% (Two Percent) of the value of the accepted Tender, including the Earnest Money. ISD has to be submitted in the form of Bank Draft / Pay Order drawn in favor of UCO BANK INDORE of a Nationalized Bank. The initial Security Deposit will have to be paid and also work should be started within two weeks from the date of **work order** failing which the Bank at his discretion may revoke the acceptance and forfeit the Earnest Money Deposit furnished along with the Tender. A part from the Initial Security Deposit as above, Retention Money shall also be deducted from progressive running bills at **8% of the value of each running bills** until the Retention Money equals 10 % of the accepted tender amount including the ISD amount.

Total Security Deposit will be refundable to the Contractor subject to the following:-

- a. Issue of completion certificate by the Bank after defect liability period.

Contractor removes his materials, equipment's, labour force, temporary sheds, stores etc., from the site after completion of the work.

Total Security Deposit may be refunded 14 (fourteen) days after the end of Defects Liability Period, provided the contractor has satisfactorily carried out all the work and attended to all the defects in accordance with the Conditions of Contract only after the observations / objections of Chief Technical Examiner of C.V.C are satisfied and removed. No interest is payable on Retention Money and the Initial Security Deposit.

Signature of Contractor

18. CONTRACTOR TO PROVIDE EVERYTHING NECESSARY :-

The Contractor shall provide everything necessary for the proper execution of the work according to the intent and meaning of the drawings, schedule of quantities and specification taken together whether the same may or may not be particularly shown or described therein provided that the same can reasonably be inferred there from and if the Contractor finds any discrepancies therein he shall immediately and in writing, refer the same to the Bank whose decision shall be final and binding.

The rates quoted against individual items will be inclusive of everything necessary to complete the said items of work within the contemplation of the contract, and beyond the unit price, no extra payment will be allowed for incidental or contingent work, labour and / or material's inclusive of all taxes and duties whatsoever.

The Contractor shall supply, fix and maintain at his own cost, for the execution of any work, all tools, tackles, machineries and equipment's and all the necessary centering, scaffolding, staging, planking, timbering, strutting, shoring, pumping, fencing, boarding, watching and lighting by night as well as by day required not only for the proper execution and protection of the said work but also for the protection of the public and safety of any adjacent roads, streets, walls, houses, buildings, all other erections, matters and things and the Contractor shall take down and remove any or all such centering, scaffolding, planking, timbering, strutting, shoring etc., as occasion shall be required or when ordered so to do and shall fully reinstate and make good all matters and things disturbed during the execution of works to the satisfaction of the Bank.

The Contractor shall at all times give access to workers employed by the Bank or any men employed on the buildings and to provide such parties with proper sufficient and if required, special scaffolding, hoists and ladders and provide them with water and lighting and leave or make any holes, grooves etc., in any work, where directed by the Bank as may be required to enable such workmen to lay or fix pipes, electrical wiring, special fittings etc. The quoted rates of the tenderers shall accordingly include all these above mentioned contingent works.

19. TIME FOR COMPLETION / EXTENSION OF TIME & PROGRESS OF WORKS:-

a) Time of Completion- The entire work is to be completed in all respects within the stipulated period. The work shall be deemed to be commenced within two weeks from the date of work order. Time is the essence of the contract and shall be strictly observed by the Contractor. The work shall not be considered as complete until the Bank have certified in writing that this has been completed and the Defects Liability Period shall commence from the date of such certificate.

b) Extension of Time:- If in the opinion of the Bank the works delayed (a) by reason of any exceptionally inclement weather, or (b) by reason of instructions from the Bank in consequence of proceedings taken or threatened by or disputes, with adjoining or neighboring Bank or (c) by the works, or delay of other Contractor or tradesmen engaged or nominated by the Bank and not referred to in the specifications or (e) by reason of any combination of workmen or strikes or lock-out affecting any of the building or trades or (f) from other causes which the Bank may consider are beyond the control of the Contractor, the Bank at the completion of the time allowed for the contract shall make fair and reasonable extension of time for completion in respect thereof. In the event of the Bank failing to give possession of the site upon the day specified above, the time of completion shall be extended suitably.

In case of such strikes or lockouts, as are referred to above, the Contractor shall immediately give the Bank, written notice thereof. Nevertheless, the Contractor shall use his best endeavors to prevent delay and shall do all that may be reasonably required to the satisfaction of the Bank to proceed with the works and on his doing so that it will be ground of consideration by the Bank for an extension of time as above provided. The decision of the Bank as to the period to be allowed for an extension of time for completion hereunder (which decision shall be final and binding on the Contractor) shall be promulgated at the conclusion of such strike or lock-out and the Bank shall then, in the event of an extension being granted, determine and declare the final completion date. The provision in Clause with respect to payment of liquidated damages shall, in such case be read and construed as if the extended date fixed by the owner. Were substituted for and the damage shall be deducted accordingly.

c) Progress of Work:- During the period of execution of work, the Contractor shall maintain proportionate progress on the basis of a Programmed Chart submitted by him immediately before Commencement of work and agreed to by the Bank. Contractor shall also include planning for procurement of scarce material well in advance and reflect the same in the Programmed Chart so that there is no delay in completion of the Project.

20. PROTECTIVE WORKS AND MEASURES:-

The contractor from time to time of being placed in possession of the site must suitable arrangements for watching, lighting and protecting the work, the site and surrounding property by day, by night, on Sundays and other holidays.

The Contractor shall indemnify the Bank against any possible damage to the building, roads or Members of the public in course of execution of the work.

The contractor shall provide necessary temporary enclosures, gates, entrances etc. for the protection of work and material and for altering and adopting the same as may be required and removing on completion of the works and making good all the work disturbed.

21. TOOLS:

All the tools including the odolite levels, prismatic compass, chain, steel and metallic tapes and all other surveying instruments found necessary on the works shall be provided by the contractor for the due performance of this contract as instructed by the Bank.

All measuring tapes shall be of steel and suitable scaffolding and ladders that may be required for safely taking measurement and shall be supplied by the Contractor.

The miseries and supervisors on the works shall carry with them always a one meter or two meter steel tape, a measuring tape of 30 meters, a spirit level, a plumb bob & a square & shall check the work see that the work is being done according to the drawing specifications. The site engineer will use any or all measuring instruments or tools belonging to the Contractors as he works executed or being executed on the contract.

The Contractor shall cover in his rates for making provisions for all reasonable facilities for the use of his scaffolding tools and plant etc., by nominated Sub-Contractors for their work.

22. CONTRACTOR IMMEDIATELY TO REMOVE ALL OFFENSIVE MATTERS:-

All soil filth or other matters of any offensive nature taken out of any trench, sewer, drain, cesspool or other place shall not be deposited on the surface but shall be at once carted away by the contractor to the municipal approved dumping ground

The contractor shall arrange for the disposal of the debris etc. so accumulated to the satisfaction of the Employer and local authority and no claims will be entertained afterwards if he does not include in his rates for the purpose.

23. ACCESS:-

Any authorized representative of the Bank shall at all reasonable times have free access to the works and / or to the workshops, factories or other places where materials are being prepared or constructed for the work and also to any place where the materials are lying or from where they are being obtained, and the Contractor shall give every facility to the Bank or their representatives necessary for inspection and examination and test of the materials and workmanship. Except the representative of the Bank no person shall be allowed at any time without the written permission of the Bank. The representative of Banks shall also include the officers from Head Office and Government official assign with such duties.

24. MATERIALS, WORKMANSHIP, SAMPLES, TESTING OF MATERIALS:-

All the works specified and provided for in the specifications or which may be required to be done in order to perform and complete any part thereof shall be executed in the best and most workmanlike manner with

materials of the best and approved quality of the respective kinds in accordance with the particulars contained in and implied by the specifications and as represented by the drawings or according to such other additional particulars, and instructions as may from time to time be given by the Bank during the execution of the work, and to his entire satisfaction.

If directed by the Bank the Contractor shall have to carry out tests on materials and workmanship in approved materials testing laboratories or as prescribed by the Bank at contractor's own risk and cost to prove that the materials etc. under test conform to the relevant I.S. Standard specifications or as specified in the tender specifications, the necessary charges for preparation of mould (in case of concrete cube) transporting, testing etc., shall have to be borne by the Contractor. No extra payment on this account shall in any case be entertained.

All the materials (except where otherwise described) stores and equipment required for the full performance on the work under the contract must be provided through authorized channels and must include charge for import duties, sales tax, octroi and other charges and must be the best of their kind available and the Contractor shall be entirely responsible for the proper and efficient execution of the work. The work must be done in the best workmanlike manner. Samples of all materials to be used must be submitted to the Bank when so directed the Bank and written approval from Bank must be obtained prior to placement of order. During the inclement weather the Contractor shall suspend work for such time as the Bank may direct and shall protect from injury/damage all work when course of execution, Any damage to any part of the work for any reason due to rain, storm, or neglect of Contractor shall be rectified by the Contractor in an approved manner at no extra cost.

Should the work be suspended by reason of rain, strike, lockouts or any other cause, the Contractor shall take all precautions necessary for the protection of work and at his own expenses shall make good any damage arising from any of these causes.

The Contractor shall cover up and protect from damage, from any cause, all new work and supply all temporary doors protection to windows, and any other requisite protection for the execution of the work whether by himself or special tradesmen or nominated Sub Contractor and any damage caused must be made good by the Contractor at his own expenses.

Signature of Contractor

Materials shall be of approved quality and the best of their kind available and shall generally conform to I.S. Specifications. The Contractor shall order all the materials required for the execution of the work as early as necessary and ensure that such materials are on site well ahead of requirement for use in the work. The work involved calls for high standard

of workmanship combined with speed and to the entire satisfaction of the Architects.

25. REMOVAL OF IMPROPER WORK:-

The Bank have power to order, from time to time, the removal from the site, any materials or the work which in the opinion of the Bank are not in accordance with specification or instructions, substitution or proper re-execution of any work executed with materials or workmanship not in accordance with the drawings and specifications or instructions. In case the Contractor neglects / refuses to comply with the order, the Bank have the power to employ and pay other agencies to carry out work and all expenses consequent thereon or Incidental thereto as certified by the Bank shall be borne by the Contractor or may be recovered from any money due to or that may become due to the Contractor or should be claimed from the contractor if nothing is due to him. No certificate which may be given by the Architects shall relieve the Contractor from his liability in respect of unsatisfactory or bad works / materials

26. SITE ENGINEER

The term "Site Engineer" shall mean the person/agency appointed and paid by the Bank to superintend the work. The Contractor shall afford the Site Engineer / Employer every facility and assistance for examining the work & materials & for checking and measuring work and materials. The site Engineer shall have no power to revoke, alter, enlarge or relax any extra work whatever except in so far as such authority may be specially conferred by a written order of the Bank.

The Contractors shall fulfill the requirements of the Employees State Insurance Act, 1948, applicable to all States towards their employees and keep all the required record regarding the same for inspection by the Authorities Concerned at any time. The Contractor shall indemnify **UCO BANK** Indore against any claim or legal action arising out of the said Act due to the failure of non-compliance of the provisions of the said Act and the penalty or any other amount levied by the authorities, shall be recoverable from the payments due to the Contractors.

The Contractor shall comply with the provisions of the Apprentices Act, 1961, and the Rules and Orders issued there under from time to time. Failure to do so will be in a breach of the Contract and the Bank may in their discretion cancel the contract. The Contractor shall also be liable for any pecuniary or other liabilities arising on account of any violation by him of the provisions of the Act.

The Contractor shall be responsible for the observance of all Central Rules and Regulations framed by the Central Government under the Contract Labour (Regulation and Abolition) Act, 1970. The Banks shall be entitled to deduct all damages, which it might suffer on account payable to the Contractor.

The Site Engineer shall have power to give notice to the Contractor or his foreman, of non-approval of any work or materials and such work shall be suspended or the use of such materials shall be discontinued until the decision of the Bank is obtained. The work will be examined by the Engineer from the Premises Department of the Bank and the Site Engineer from time to time. But such examination shall not in any way exonerate the Contractor from the obligation to remove defects, which may be found to exist at any stage of the work or after the same is complete. Subject to the provisions of this contract, the Contractor shall take instructions only from the Bank.

Signature of Contractor

27. CONTRACTOR'S EMPLOYEES:-

The Contractor shall employ technically qualified and competent supervisors for the work who shall be available (by turn) throughout the working hours to receive and comply with instructions of the Bank. The Contractor shall engage at least one experienced Engineer as Site-in charge and also a supervisor with technical background for execution of the work. The Contractor shall employ in connection with the work persons having the appropriate skill or ability to perform their job efficiently

The Contractor shall employ local laborers on the work as far as possible. No labourer below the age of sixteen years and who is not an Indian National shall be employed on the work. Any labourer supplied by the Contractor to be engaged on the work on day-work, basis either wholly or partly under the direct order or control of the Bank or his representative shall be deemed to be a person employed by the Contractor.

The Contractor shall have to comply with the provision of all labour legislation including the requirements of

- a) The Payment of Wages Act.
- b) Employer's Liability Act.
- c) Workmen's Compensation Act.
- d) Contract Labour (Regulation & Abolition) Act, 1970 and Central Rules 1971.
- e) Apprentices Act 1961.
- f) Minimum Wages Act
- g) Any other Act of enactment relating thereto and rules framed there under from the time to time.

The Contractor shall keep the Bank saved harmless and indemnified against all the claims if any of the workmen and shall pay all costs and expenses as may have to be incurred in connection with any claim that may be made by any workmen / third party.

The contractor shall comply AT his own cost with the order of requirement of any Health Officer of the State or any local authority or of the Employer regarding the maintenance of proper environmental sanitation of the area where the contractor's labourers are housed or accommodated, for the prevention o small pox cholera plague, typhoid, malaria and other contagious diseases. The contractor shall provide, maintain and keep in good sanitary condition adequate sanitary accommodation and provide facilities for pure drinking water at all times for the use of men engaged on the works and shall remove and clear away the same on completion of the works. Adequate precautions shall be taken by the contractor to

prevent nuisance of any kind on the works or the lands adjoining the same.

The Contractors shall arrange to provide first-aid treatment to the labourers engaged on the works. He shall within 24 hours of the occurrence of any accident at or about the site or in connection with execution of the works, report such accident to the Bank and also to the competent authority where such report is required by law.

28. DISMISSAL OF WORKMEN:-

The Contractor shall on the request of Bank immediately dismiss from works any person employed thereon by him, who may in the opinion of the Bank be unsuitable or incompetent or who may misconduct himself. Such discharges shall not be the basis of any claim for compensation or damages against the Bank or any of their officer or employee.

29. ASSIGNMENT:-

The whole of the works included in the contract shall be executed by the Contractor and the Contractor shall not directly or indirectly transfer, assign or underlet the contract or any part, share or interest therein nor, shall take a new partner, without written consent of the Bank and no subletting shall relieve the Contractor from the full and entire responsibility of the Contractor or from active superintendence of the work during their progress.

30. NOMINATED SUB-CONTRACTORS:-

All specialists, Merchants, Tradesmen and other executing any work or supply and fixing any goods for which prime cost prices or provisional sums are included in the Schedule of Quantities / Rates and / or specification who may be nominated or selected by the Bank are hereby declared to be Sub-Contractors employed by the Contractor and are herein referred to as nominated Sub-Contractors. No nominated Sub-Contractor shall be employed on or in connection with the works against whom the Bank shall make reasonable objection or save where the Bank the Contractor shall otherwise agree who will not enter into a contract presided:

a) That the nominated Sub-Contractor shall indemnify the Contractor against the same obligations in respect of the Sub-Contract as the Contractor is under in respect of this contract.

b) That the nominated Sub-Contractor shall indemnify the Contractor against claims in respect of any negligence by the Sub-Contractor, his servants or agents or any misuse by him or them of any scaffolding or other plants the property of the Contractor or under any workmen's compensation Act in force.

c) Payment shall be made to the nominated Sub-Contractor by the Contractor within fourteen days of his receipt of the Architect's Certificate provided that before any certificate is issued, the Contractor shall upon request furnish to the Architect's certificate provided that before any certificate is issued, the contractor shall upon request furnish to the Architect proof that all nominated Sub- Contractor's accounts included in pervious certification have been duly discharged, in default where of the Bank may pay the same upon a certificate of the Architect and deduct the amount thereof from any sums due to the Contractor. The exercise of this power shall not

create private of contract between the Bank and the Sub- Contractor.

31. DAMAGE TO PERSONS AND PROPERTY INSURANCE ETC.:-

The Contractor shall be responsible for all injuries to the work or workmen, to persons, animals or things and for all damages to the structural and / or decorative part of property which may arise from the operations or neglect of himself or any Sub-Contractor or of any of his or a Sub-Contractor's employees, whether such injury or damage arise from carelessness, accident or any other cause whatsoever in any way connected with the carrying out of this contract. The clause shall be held to include inter-alia, any damage to buildings whether immediately adjacent or otherwise, and any damage to roads, streets, foot paths or ways as well as damages caused to the buildings and the work forming the subject of this contract by rain, wind or other inclemency of the weather. The Bank stands indemnified by the Contractor in respect of ail and any expenses arising from aforesaid and also in respect of any claim made in respect of injury or damage under any acts of compensation or damages consequent upon such Claim.

The Contractor shall restore and reinstate all damages of every sort mentioned in this clause, so as to deliver the whole of the contract works complete and perfect in every respect and so as to make good or otherwise satisfy all claims for damages to the property or third parties.

The Contractor shall have to affect the necessary insurance cover. The Bank stands indemnified entirely from ail responsibility and the liabilities in this respect.

The insurance cover must be obtained from / placed with a company approved by the Bank and must be taken in the name of the Bank and the Contractor jointly (the name of the Bank being placed first in the policy) and the policy lodged with Bank The scope of insurance cover is also to include cost of damage or loss to the contractor till the work is in a completed stage. Insurance is compulsory and must be affected from the very initial stage. The Contractor shall also be responsible for anything, which may be excluded

from damage to any property arising out of incidents; negligence or defective carrying out of this contract i.e. the Contractor All Risk Insurance shall have extension for covering cross liability arising, if any, during execution of work.

The Bank shall be at liberty and is hereby empowered to deduct the amount of any damages, compensations, costs, charges and expenses arising or accruing from or in respect of any such claim or damages from any sums due or to become due to the Contractor or in extreme case to lodge a claim against the contractor.

32. INDEMNIFICATIONS AND INSURANCE:-

The Bank at all times stands indemnified by the contractor for any loss what so ever to the Bank (The Employer) / to its property by theft, fire and / or earthquake, injury / death of the workers, Bank's Employees and third party and the contractor shall obtain C.A.R. policy in joint name first being that of the Bank.

Unless otherwise instructed the Contractor shall insure the works 2nd keep them insured until the virtual completion of the contract against loss or damage by theft, fire and / or earthquake, flood etc. The insurance must be taken from a company approved by the Bank, in the joint names of the Bank and the Contractor for such amount and for any further sum if called to do so by the Bank,

The Contractor shall deposit the policy and receipt for premiums paid with the Bank within 15 (fifteen) days from the date of issue of work order unless otherwise instructed. In default of the Contractor insuring as provided above, the Bank ON his behalf may so insure and may deduct the premiums plus administrative expenses paid, from any money due, or which may become due to the Contractor. The Contractor shall as soon as the claim under the policy is settled or the work reinstated by the Insurance Company shall they elect to do so proceed with due diligence with the completion of the works in the same manner as though the loss has not occurred and in all respects under the conditions of the contract. The contractor in case of rebinding or reinstatement after loss shall be entitled to extension of time for completion as the Bank may deem fit.

33. ACCOUNTS, RECEIPTS AND VOUCHERS:-

The Contractor shall, upon the request of the Bank furnish them with all the invoices, accounts, receipts and other vouchers that they may require in connection with the works under this contract If the Contractor shall use materials less than that what he is required under the contract, the value of

the difference in the quantity of the materials he was required to use and that he actually used shall be deducted from his dues. The decision of the Bank shall be final and binding on the Contractor for any work under this contract.

34. MEASUREMENT OF WORK:-

- a) The measurement shall be generally done by the Site Engineer or by an employee or an agency of the Bank, specially authorized for the purpose.
- b) The Consultant/Site Engineer engaged by the Bank shall take joint measurements (i.e. accompanied by the Contractor's authorized representative) of the work as it progress and record them directly in the Measurement Books.
- c) It shall be ensured that the method of measurement is in accordance with the contract. The precision in measurements shall be as laid down in IS-1200. Any points of disagreement with the Contractor pertaining to measurements shall be promptly referred to the decision of the Bank.
- d) Extra / deviated items, as claimed by the Contractor, shall not be recorded in Measurement Book until they are approved by the Bank,
- e) In case some allegedly extra / deviated item is carried out by the Contractor while complying with approved drawings and specifications and the same is to be covered up. The Site Engineer shall check the item and its specification and record its measurements but simultaneously enter up the provision that their admittance is subject to the approval by the Bank. Both the measurements and the provision shall be got signed by the Contractor.
- f) The Measurement Book shall not be handed over to the Contractor at any time. The Contractor or his representative may be permitted by the Site Engineer to see it in his presence and / or make a (concurrent) copy of his own. The Contractor shall, however, be warned that his copy shall be regarded as an unofficial copy of the Bank's Measurement Book. This is the only authorized official document in the matter.
- g) The measurement shall be signed at the end of each session of measurement of the day's work, as the case may be, by both the parties (i.e. the Employer / Site Engineer and the Contractor)

35. CONCEALED WORK:-

The Contractor shall give due notice to the Employer whenever any work is to be buried in the earth, concrete, partitions or in the walls or otherwise, becoming inaccessible later on, in order that the work may be inspected and correct dimensions taken before such burial, in default whereof the same shall, at the opinion of the Employer be either opened up for

measurement at the Contractor's expenses or no payment may be made for such materials, shall any dispute or difference arise after the execution or any work as to measurements etc. OR other matters which cannot be conveniently tested or checked the notes of the employer shall be accepted as correct and binding on the Contractor.

36. PAYMENTS:-

All bills shall be prepared by the Contractor in the form prescribed by the Bank / Architects after the measurements are endorsed as mentioned in a Clause above (named as 'Measurement of Works'). Normally one interim bill shall be prepared each month, subject to minimum value for interim certificate as state in this document. The bills in proper forms along with detailed measurements in support of the quantities of work done and other supporting documents and must show deductions for all previous payments, retention money, etc.

The Bank will deduct retention money as described in relevant Clause above of these conditions. The refund of retention money will be made as specified in the said clause.

If the Bank has supplied any materials or goods to the Contractor, the cost of any such materials or goods will be deducted from the amount due to the Contractor in accordance with the quantities consumed in the work or in one lot, depending up on the situation.

All the interim payments shall regarded payments subject to and against the final payment only and not as payments for work done and completed and shall not preclude the requiring of bad, unsound & imperfect or unskilled work to be removed and taken away and reconstructed, or re-erected or be considered as an admission of the due performance of the contract, or any part thereof in any respect of the accruing of any of them as to the final settlement and adjustment of the accounts or otherwise or in any other way vary or affect the contract. The final bill shall be submitted by the Contractor within **TWO MONTH** of the date fixed for completion of the work or of the dates of certificate of completion furnished by the Bank and payment shall be made within four months from the date of receipt of the certificate from the consultant.

FINAL BILL PAYMENT:-

The final bill shall be accompanied by a certificate of completion from the Bank. Payments of final bill shall be made after deduction of Retention money etc as specified in the relevant clause above, which sum shall be refunded after the completion of the defects liability period after receiving the Bank's certificate that the contractor has rectified all defects to the satisfaction of the Bank. The acceptance of payment of the final bill by Contractor would indicate that he will have no further

claim in respect of the work executed .Electrical audit will done before final payment.

37. MONTHLY STATEMENT OF VARIATIONS/DEVIATIONS /EXTRAITEMS:-

The Contractor may when authorized by the Bank and shall, when directed in writing by the Employer bank to add or omit or vary the works shown in the drawings or described in the specifications or included in the priced schedule of quantities. The Contractor on his own accord shall make no. addition omission or variation without such authorization or direction. A verbal authorization or direction by the Employer shall when confirmed correctly by the Contractor in writing within 8 days shall be deemed to have been given in writing.

The Contractor shall send to the Employer once in every month a statement giving particulars, as full and detailed as possible, of all claims for any additional payment to which the Contractor may consider himself entitled and of all deviated or extra or additional work ordered by the Employer which he has executed during the preceding month. The rates for additional, altered, **substituted** work shall be arrived in accordance with following rules:

- a) The net rates of prices in the contract schedule shall determine the valuation of (the rates for) the extra work (items) where such extra work is of similar character and is executed under similar conditions as the work priced therein.
- b) If the rates for the extra, altered or substituted (deviated) work are not provided for (available) in the contract schedule, they shall to the extent possible be derived out of rate given in that schedule for similar or near similar items. For the purpose of such deviation, where necessary and when so directed, the Contractor shall furnish detailed analysis for the said similar or near similar items in the contract schedule. For such portions of the analysis, for the extra, altered or substituted (deviated) work for which prices cannot be abstracted from the corresponding analysis of rates for the said similar or near similar items in the contract schedule, market rates substantiated by purchase bills vouchers dependable printed price schedules of building materials of different types and prevailing labour rate shall be adopted adding 15% over towards profits and overheads. When called upon to do so the Contractor shall submit the required purchase bill / vouchers.

38. PREPARATION FOR OCCUPATION AND USE AFTER COMPLETION:

The whole work will be thoroughly inspected by the Contractor and deficiencies and defects shall be put to right. On completion of such inspection the Contractor shall inform the Employer that he has completed the work and it is ready for inspection.

On completion the Contractor shall clean all windows and doors including the cleaning, removing hand / finger stains and oiling if necessary, of all hardware, inside and outside, all floors, staircase, and every part of the building. He will leave the entire building neat and clean to the satisfaction of the Bank.

39. CLEARING SITE ON COMPLETION: -

On completion of the works the Contractor shall clear away and remove from the site all constructional plant, surplus materials, rubbish and temporary works of every kind and leave the whole of the site and the works clean and in a workmanlike condition to the satisfaction of the Bank.

40. P.V.A. IN THE QUOTED RATES:-

The rate quoted shall be firm throughout the tenure of the contract (including extension of time, if any, granted) and will not be subject to any fluctuation due to increase in cost of materials, labour, sale tax, octroi, etc.

41. SUSPENSION OF WORK: -

If the Contractor except on account of any legal restraint upon the Bank preventing the continuance of the work or in the opinion of the Bank shall neglect or fail or proceed with due diligence in the performance of his part of the contract or if he shall more than once make default, the Bank shall have the power to give notice in writing to the Contractor requiring the work be proceeded within a reasonable manner and with reasonable dispatch, such notice purport to be a notice under this Clause.

42. TERMINATION OF CONTRACT BY THE BANK: -

If the Contractor being a company go into liquidations whether voluntary or compulsory or being a firm shall be dissolved or being an individual shall be adjudicated insolvent or shall make an assignment or a composition for the benefit of the greater part, in number of amount of his creditors or shall enter into a Deed or arrangement with his creditors, or if the Official Assignee in insolvency or the Receiver of the Contractor in insolvency shall repudiate the contract, or if a Receiver of the Contractor's firm appointed by the Court requiring him to do so, to show to the reasonable satisfaction of the Bank that he is able to carry out and fulfill the Contract, and if so required by the Bank to give reasonable security therefore, or if the Contractor shall suffer execution to be issued, or shall suffer any payment

under this contract to be attached by or on behalf of and of the creditors of the Contractor, or shall assign, charge or encumber this contract or any payments due or shall neglect or fail to observe and perform all or any of the acts matters of things by this contract, to be observed and performed by the Contractor within three clear days after the notice shall have been given to the Contractor in manner hereinafter mentioned requiring the Contractor to observe or perform the same or shall use improper materials or workmanship in carrying on the works, or shall in the opinion of the Bank not exercise such diligence and make such due progress as would enable the work to be completed within due time agreed upon and shall fail to proceed to the satisfaction of the Bank after three clear days notice requiring the Contractor so to do shall have been given to the Contractor as hereinafter mentioned, or shall abandon the contract, then and in any of the said cases, the Bank may notwithstanding previous waiver determine / terminate the contract by a notice in writing to the effect a hereinafter mentioned, but without thereby affecting the powers of the Bank of the obligations and liabilities of the Contractor the whole of which shall continue in force as fully as if the contract, had not been so determined and as if the work subsequently executed had been executed by or on behalf of the Contractor (without thereby creating any trust in favour of the Contractor) further the Bank or his agent, or servants, may enter upon and take possession of the work and all plants, tools, scaffoldings, sheds, machinery . steam and other power, utensils and materials lying upon premises or the adjoining lands or roads and sell the same as his own property or may employ the same by means of his own servants and workmen in carrying on and completing the works or by employing any others contractors or other persons or person to complete the works, and the Contractor shall not in any way interrupt or do any act matter or things to prevent or hinder such other Contractors or other persons or person employed from completing and finishing or using the materials and plants for the works when the works shall be completed, or as soon thereafter as conveniently may be, the Bank Shall give notice in writing to the Contractor to remove his surplus materials and plants and shall the Contractor fail to do so within a period of 14 days after receipt by him the Bank may sell the same by Public Action and shall give credit to the losses incurred by the Bank in getting the works carried out through other agency and the amount payable to the agency shall be adjusted against the amount payable to the Contractor by way of selling his tools and plants or dues on account of work carried out by the Contractor or against the Security Deposit and by raising claims for the balance recoverable amount.

Without prejudice to any of the right or remedies under this contract, if the Contractor, being an individual expires, the Employer shall have the option of termination of the contract without incurring any liability for such termination.

43. MODE OF - MEASUREMENT:

Unless otherwise mentioned elsewhere in the tender measurement will be for the net quantities or work produced in accordance with up to date rules laid down by the Indian Standard Institution. In the event of any dispute with regard to the measurement of the work executed, the decision of the Bank shall be final and binding on the Contractor.

44. ACTION WHERE NO SPECIFICATION: -

In the case of any class of work for which there is no such specification in Technical Specification, such work shall be carried out in accordance with the I.S. Specification and in the event of there being no I.S. Specification, then in such case the work shall be carried out in all respects in accordance with the instructions and requirements of the Bank.

45. CONTRACTOR NOT TO STORE MATERIALS IN A MANNER THAT MAY INCONVENIENCE TO THE EMPLOYER / PUBLIC OR STAFF MEMBERS:

The Contractors shall not deposit / store materials on any site which will inconvenience the Employer. The Bank may instruct the Contractor to remove any materials, which are considered by him to be a danger or inconvenience to the Employer and cause them to be removed at the Contractors cost.

46. LIQUIDATED DAMAGES: -

Shall the work be not completed to the satisfaction of the Bank with in the stipulated period the Contractor shall be bound to pay to the Bank a sum calculated at the rate of 1.00% of the cost of the work (As shown in the tender) per week of delay subject to a maximum of 7.5% of the actual project cost or contract sum whichever is more, by way of liquidated damages, for the period during which the work remains incomplete or unfinished after the expiry of the due / extended completion date.

47. WRITTEN GUARANTEE FOR THE SPECIALISED WORKS: -

Wherever provision for submission of a written guarantee has been advised, the same shall be submitted from the specialized agency along with a counter guarantee by the main Contractor engaged for the work before receiving any payment from the employed, against such item of work be furnished on a non judicial stamp paper of appropriate value. The guarantee shall however come into the force from the date of the completion of the entire contracted work.

48. INCOME TAX/GST/SALES TAX ON WORKS CONTRACT: -

Statutory deduction of Income Tax/ GST/Sales Tax on work contract shall be made from all the ad-hoc, interim and final payments as per laws applicable.

49. AGREEMENT: -

The successful Contractor will be required to enter into an agreement in accordance with the Draft Agreement from enclosed and the schedule of

conditions within 15 days from the date of work order is advised by the Bank that his tender has been accepted and he shall pay for all stamps and legal expenses incidental thereto. However, the written acceptance by the Bank of a tender will constitute a binding contract between the Bank and the person so tendering whether such formal agreement is or is not subsequently executed.

50. NO COMPENSATION FOR ALTERATION IN, OR RESTRICTION OF WORK BE CARRIED OUT

If at any time after the commencement of the work, the Bank shall for any reason whatsoever not require the whole work thereof as specified in the tender to be carried out the Bank shall give notice in writing of the fact to the Contractor who shall have no claim to any payment or compensation whatsoever on account of any profit or advantage with which he might have derived from the execution of the work in full but which he did not derive in consequence of the full amount of the work not having been carried out' neither shall he have any claim for compensation by reason of any alterations having been made in the original specification, drawing, design and instructions which shall involve any curtailment of the work as originally contemplated.

The Contractor shall not be entitled to any compensation for any loss suffered by him on account of delays in commencing or executing the work, whatever the case of delays may be, including delays arising out of modifications to the work entrusted to him or in any sub-contract connected therewith or delays in awarding Contracts for other trades if the project or in commencement or completion of such works or in procuring Government controlled or other building materials or in obtaining water and power connection for the work or for the other reason whatsoever and the Employer shall not be liable for any claim in respect thereof. The Employer does not accept ('ability for any sum besides the Tender amount, subject to such variation as are provided for herein.

51. RIGHTS OF TECHNICAL SCRUTINY OF BILLS: -

The Employer shall have right to cause a technical examination of the works and the final bill of the Contractor including all supporting vouchers, abstracts, etc., to be made at the time of payment of the final bill. If as a result of this examination or otherwise any sum is found to have been overpaid or over certified, it shall be lawful for the Employer to recover the sum.

52. WEEKLY REPORTING TO THE BANK -

WEEKLY REPORTS on Labour, Materials, Progress and Hindrances shall have to be submitted by the Contractor. A set of **PHOTOGRAPHS (8" X 6")-mini. 2no.** for each building shall also be submitted once in a week.

53. ARBITRATION: -

All disputes or difference of any kind whatsoever (except for excepted matters vide Clause No. 14 earlier) which shall at any time arise between the parties hereto touching or concerning the works or the execution or maintenance thereof of this contract or the rights touching or concerning the works or the execution of maintenance thereof of this contract or the construction remaining operation or effect thereof OR to the right or liabilities of the parties or arising out of or in relation thereto whether during or after determination foreclosure or breach of the contract (other than those in respect of which the decision of any person is by the contract expressed to be final and binding) shall after written notice of 60 days by either party to the contract to the other of them and to the Employer hereinafter mentioned be referred for adjudication to a **Sole Arbitrator** to be appointed as per the provisions of law.

If the Arbitrator so appointed is unable or unwilling to act or resigns his appointment or vacates his office due to any reason whatsoever another Sole Arbitrator shall be appointed as per the Law.

The work under the Contract shall, however, has to continue during the Arbitration proceeding and no payment otherwise due to the Contractor shall be withheld on account of such proceedings.

The Arbitrator shall be deemed to have entered on the reference on the date he issued to both the parties fixing the date of the first hearing.

The Arbitrator may from time to time, with the consent of the parties, enlarge the time for making and publishing the award.

The Arbitrator shall give a separate award in respect of each dispute or difference referred to him. The Arbitrator shall decide each dispute in accordance with the terms of the contract and give a reasoned award. The venue of arbitration shall be such place as may be fixed by the Arbitrator in his Sole discretion.

The fees, if any, of the Arbitrator shall, if required to be paid before the award is made and published, be paid half and half by each of the parties. The cost of the reference and of the award including the fees, if any, of the Arbitrator who may direct to and by whom and in what manner, such costs or any part thereof shall be paid and may fix or settle and amount of costs to be so paid.

The award of the Arbitrator shall be a reasoned Award.

Subject to aforesaid, the provisions of the Arbitration and Conciliation Act, 1996 or any statutory modification or re-enactment thereof and the rules made there under and for the time being in force, shall apply to the Arbitration proceeding under this clause.

The Employer and the Contractor hereby also agree that arbitration under clause shall be a condition precedent to any right to action under the contract with regard to the matters hereby expressly agreed to be so referred to arbitration. ' '

54. DECLARATION:-

I /We have inspected the site of works and have made me/us fully acquainted with the local conditions in and around the sites works. I/ We hereby declare that I/We have gone through the conditions laid down in the notice inviting tender, general conditions of contract, technical specifications and understood the same on the basis of the same. I/We quoted our rates in the schedule of quantities with the tender document.

I / We shall also uniformly maintain such progress with the work, as may be directed by the Bank to ensure complete of the same within the target date as mentioned in the tender document.

Date

Witness: Signature of Tender

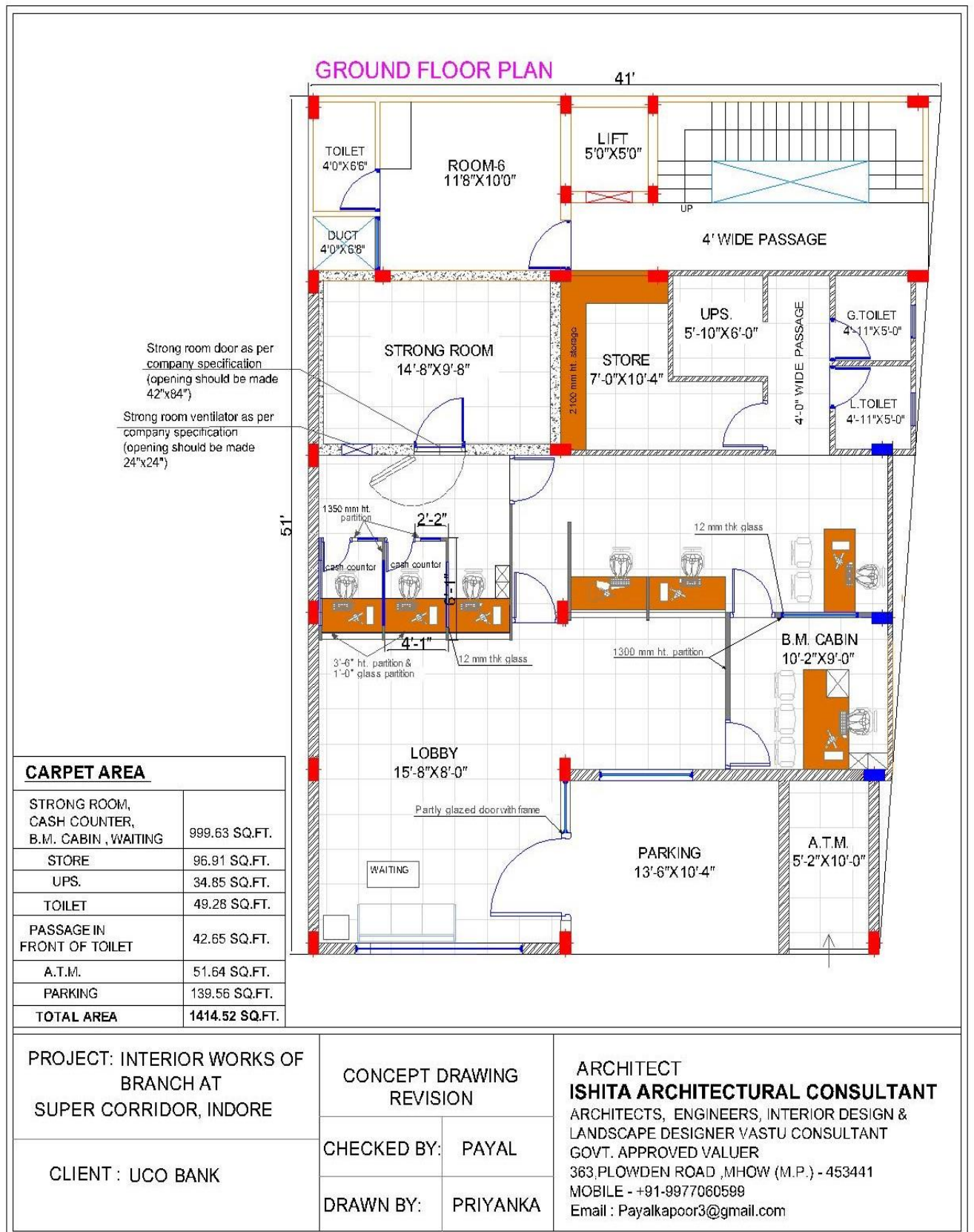

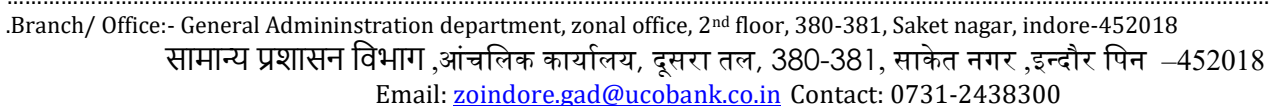

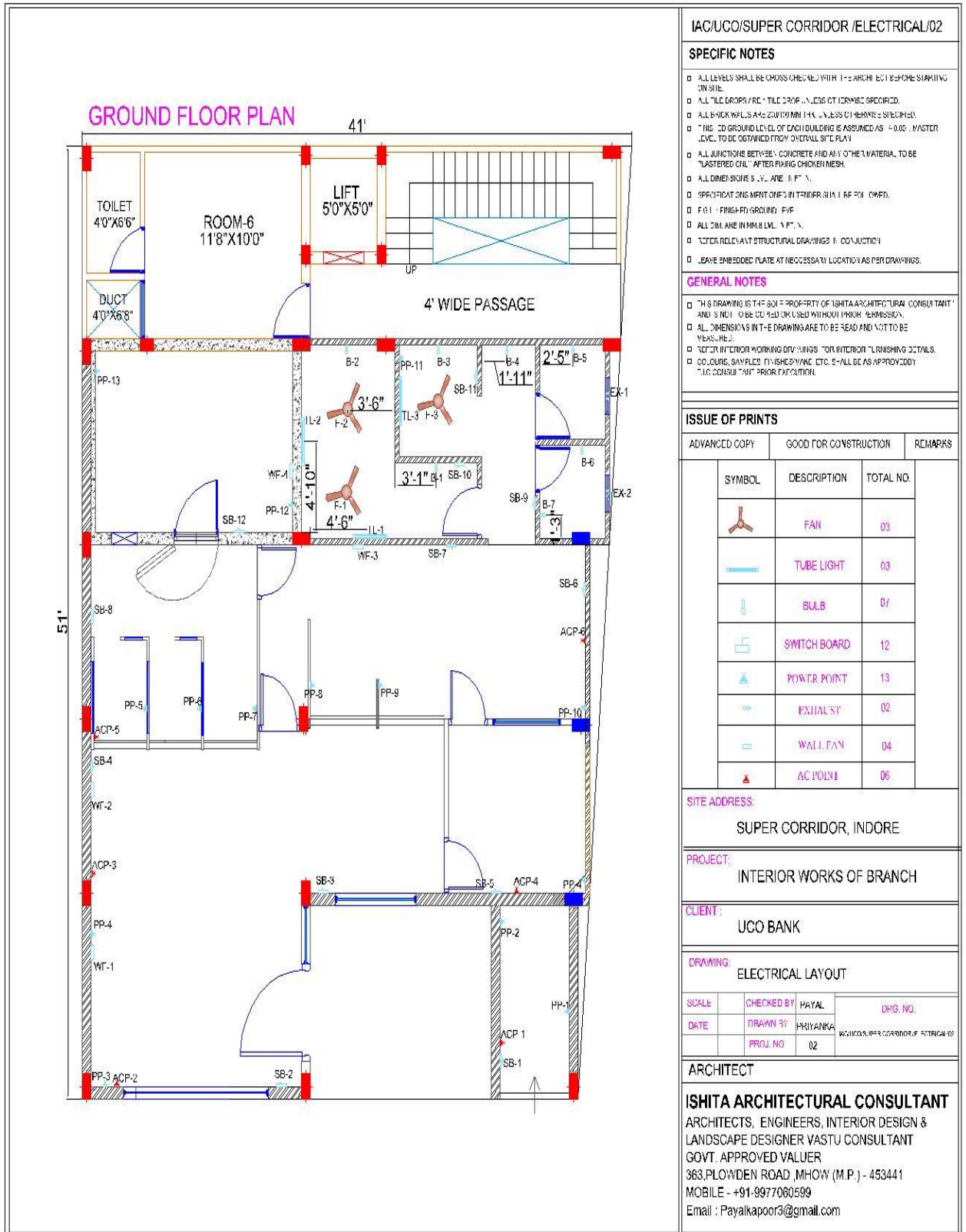

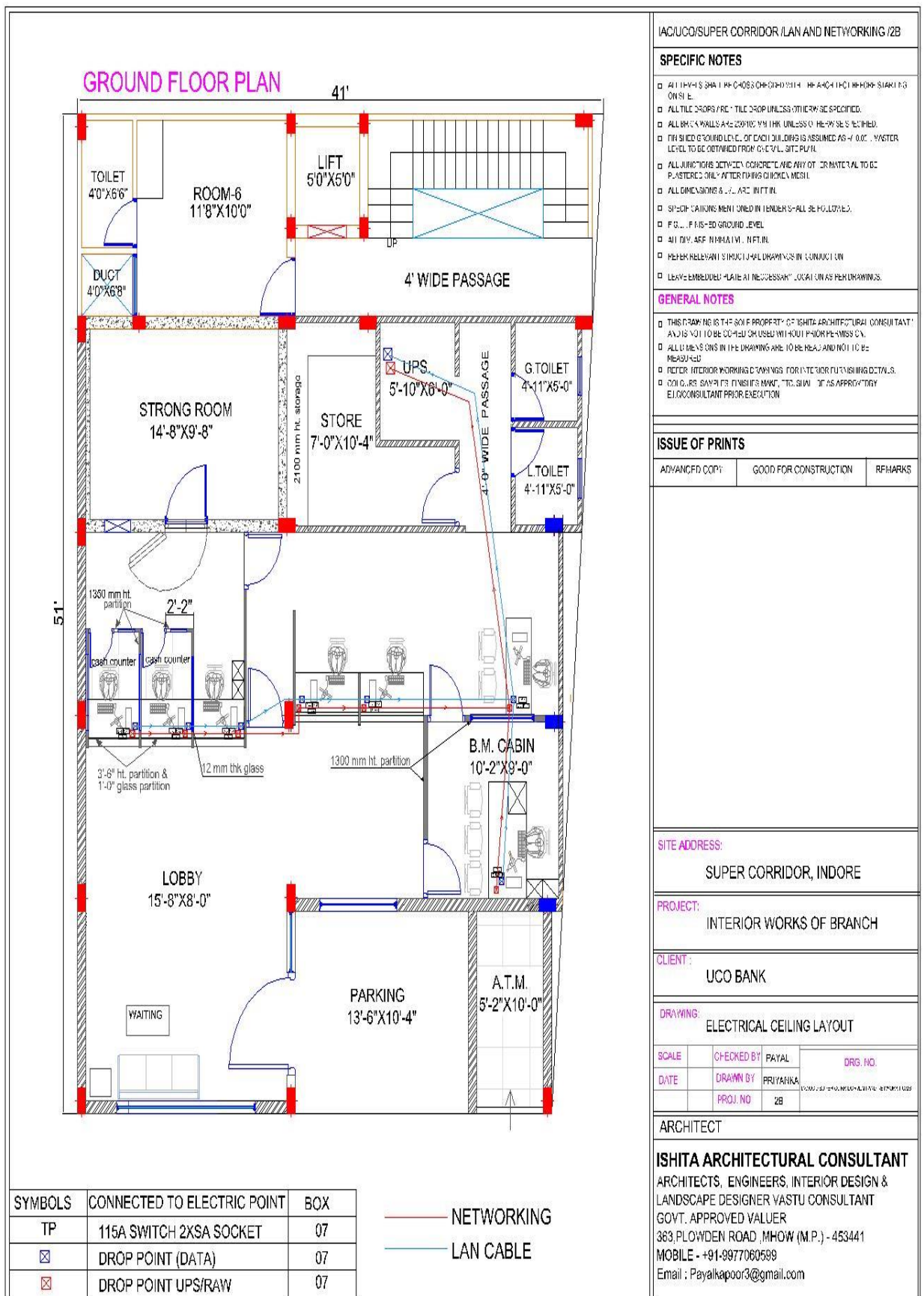

<p style="text-align: right;">ISHITA ARCHITECTURAL CONSULTANT Architects, Interior Designer</p>		
<p style="text-align: center;">BOQ FOR INTERIOR FURNISHING, ELECTRICAL FURNISHING & LAN CABLING WORKS AT PROPOSED BRANCH PREMISES AND A.T.M. OF UCO BANK AT SUPER CORRIDOR, INDORE (M.P.)</p>		
Sr.No.	ITEM OF WORK	ESTIMATED AMOUNT
A	TOTAL ESTIMATED COST OF INTERIOR FURNISHING WORKS	
B	TOTAL ESTIMATED COST OF ELECTRICAL WORKS.	
C	TOTAL ESTIMATED COST OF COMPUTER CABLING WORKS	
D	TOTAL ESTIMATED COST FOR ELECTRICAL FIXTURES	
E	TOTAL	
F	ADD CONTINGENCIES @ 5%	
G	ADD ARCHITECTURAL CONSULTANCY SERVICES @3%	
H	GRAND TOTAL (E+F+G)	
	Say Rs.	

ISHITA ARCHITECTURAL CONSULTANT
Architects, Interior Designer

**BOQ OF INTERIOR WORKS FOR NEW BRANCH PREMISES AND A.T.M. OF UCO BANK AT
SUPER CORRIDOR, INDORE (M.P.)**

Sr.No.	DESCRIPTION OF ITEM	UNIT	QTY	RATE	AMOUNT
A	WAITING/RECEPTION				
1	WRITING DESK (3'-0" x 1'-4" x 1'-0" high)				
	Providing & fixing writing desk made out of 19 mm block board finished with 1.0 mm thick laminate on top, sides, etc. & will be fixed on wall. The desk will have 1'0" wide closed box with lockable shutter on one side with a slit & remaining 2'0" to be divided equally in 3 parts by 8mm glass partition for keeping stationary for customers use. All exposed edges of block board will have 6mm T.W. beading. All internal exposed surface of block board will be finished with 1.0 mm thick laminate. All exposed T.W. beading to be polished All hardware to be of superior quality.	Nos.	1		
2	CHEQUE BOX AND SUGGESTION BOX				
	P & F in position laminated cheque drop box made of 19mm thick block board and will have locking arrangement. All internal exposed surface of block board will be finished with 1.0 mm thick laminate. All exposed T.W. beading to be polished All hardware to be of superior quality.	Nos.	3		
3	VERTICAL BLINDS				
	Providing and fixing at site vertical blinds 4" wide vertical blinds Vista make only with extruded powder coated head rail housing control units, spacers, runners, tilt rod with reduction gear mechanism, tilt control for rotation for rotation of 180 degree louvers made of approved fabric/ color scotch guard coating & bottom mechanism of powder coated galvanized steel with required components. Shades & colors shall be decided as per architect.	Sq.Ft.	100		
4	FRAMELESS FULLY GLAZED MAIN ENTRANCE DOOR (Toughened Glass with Patch Fittings)				

	Providing and fixing at site Main entrance Full glazed Door. The door shall be 4' wide single leaf Glass shutter. Door shutter shall be made up of 12 mm. thick SGG SECURITY / AIS STRONGLAS impact resistance glass (toughened glass) with pencil polish edges all around. Etching details for glass door as per design or direction of Architect. Door shall be fixed with patch fitting assembly inclusive of Top & Bottom Patches, Floor spring, Bottom Lock, SS Brushed Handle of 2' Long & 1" dia. on both sides. (Door Size - 4'x7'). The cost shall include all necessary fittings, all labor, materials, etc. complete.	Sq.Ft.	85		
5	Providing & fixing in position 12 mm Modi float clear toughened glass with aluminum top, bottom & vertical side members 100 x 50 mm (16 G 0 black (or as per approve shade) powder coated. Rates to include glazing clip, gasket. Etc. complete.	Sq.Ft.	32		
6	FULL HEIGHT PARTITION (10'-0" / 11'-0" height)				
	P&F partly glazed partition with 6mm ply fixed on both sides of 2" x 2" kailwood frame work @ 2'0" c/c both ways finished with 1mm thick laminate. The partition shall have 10 mm thick float glass with Etching/ Frosting work fixed with T.W. beading. Doors shall be flush type fitted with 6mm thk. float glass finished with 1mm thick laminate on both sides inclusive of mortice lock, hinges, S.S. Handles, door stopper, door closer etc complete. Door frame shall be made out of 4" x 2" teak wood with 1/2" rebate all over for door. Doors shall be measured in partition area, all wood work to be polished.	Sq.Ft.	330		
7	LOW HEIGHT PARTITION (4'-6" ht.)				
	S & F partition with 6mm ply on both sides of kailwood frame 2" x 2" @ 16" c/c both ways finished with 1mm thick laminate up to 3'0" height. Rest 1'6" will have 12 mm thick float glass with Etching/ work set in wooden frame with T.W. beading / "D" section (as required), all exposed woodwork to be polished/ Painted . Flap Doors shall be flush type finished with 1mm thick laminate on both sides inclusive of Door Latch, Heavy duty S.S. Hinges and S.S. Handle. (Flap door shall be measured in partition area)	Sq.Ft.	45		
8	INTERNAL GLASS SS PARTITION (Half)				
	Providing and fixing at site internal partition of size 1050 x 1350 mm made up of 2 Nos 75mm dia SS pipes which are to be grouted in the over 6.0mm thick SS plate of size 175 x 175mm with SS Anchor fastener bolts, the partition shall have 12.0mm toughened glass of size 900 x 900mm to be fixed to SS pipes with SS side Brackets, the glass shall have approved etching pattern, the cost shall include all materials, labor etc complete.	Sq.Ft.	15		

9	VISUAL MERCHANDISING:				
	Supply & placing in position designer level customized branded stand alone writing cum information panel of size 75" x15" x2.5" and writing area 15"x 14" .,16G M. S. powder coated, fitted with imported acrylic & vinyl of Bank approved shade.	Each	1		
10	MANAGER'S TABLE (Size-6'-0"X3'-0"X2'-6")				
	Supplying & fixing in position Manager table made out of 19mm block board finished with 1.0mm thick laminate on top and vertical surfaces . Top will also have 12mm thick float glass with edge polish. Table will have storage unit on one side with 1 nos. drawer on sliding drawer channel with locking arrangement & one cabinet below drawer with shutter . Facia of drawer & shutter shall be finished with 1.0mm thick laminate.On opposite Side of storage unit below the Table Top a space for keeping CPU on pedestal 1' wide & 4" Ht. from floor is provided. Table will be provided with Keyboard tray (Ebco), unit will also have cable manager for wires & cables.Foot rest made out of 19mm block board (box type with top inclined) to be provided. All exposed edges of block board will have 6mm T.W. beading. All internal exposed surface of block board will be finished with 1.0 mm thick laminate. All exposed T.W. beading to be polished . All hardware fitting of superior quality.	Nos.	1		
11	SIDE TABLE (3'-6" x 1'-6" x 2'-6" height)				
	Supplying & fixing in position side units made out of 19mm block board & 8mm ply back. Top & side finished with 1.0mm thick laminate. Table will have storage unit on one side with 4 nos. drawer on sliding drawer channel & 2 nos cabinet with flap door with locking arrangement . All exposed edges of Block board will have 6mm T.W. beading. All internal exposed surface of block board will be finished with 1.0 mm thick laminate. All exposed T.W. beading to be polished. All hardware fitting will be of superior quality.	Nos.	1		
12	OFFICER'S TABLE (4'-6" X 2'-6" X 2'-6" height)				
	Supplying & fixing in position table made out of 19 mm block board finished with 1.0mm thick laminate on top and vertical surfaces . Top will a have 10mm thick float glass with edge polish. Table will have space for keeping CPU on pedestal 4" Ht. from floor is provided. Table will be provided with Keyboard tray (Ebco), unit will also have cable manager for wires & cables.Foot rest made out of 19mm block board (box type with top inclined) to be provided . Facia of drawer & shutter shall be finished with 1.0mm thick laminate . All exposed edges of block board will have 6mm T.W. beading. All internal exposed surface of block board will be finished with 1.0 mm thick laminate. All exposed T.W. beading to be polished .	Each	2		

	All hardware fitting of superior quality.				
13	SIDE TABLE (OFFICER'S) (3'-0" x 1'-6" x 2'-6" height)				
	OFFICER'S SIDE TABLE: Supplying & fixing in position side units made out of 19mm block board & 8mm ply back. Top & side finished with 1.0mm thick laminate. Table will have storage unit on one side with 4 nos. drawer on sliding drawer channel & 2 nos cabinet with flap door with locking arrangement . All exposed edges of Block board will have 6mm T.W. beading. All internal exposed surface of block board will be finished with 1.0 mm thick laminate. All exposed T.W. beading to be polished. All hardware fitting will be of superior quality.	Nos.	1		
14	P & F Full Height (storage cabinets) 22" deep & 7'-0" height made out of 19mm block board with 6mm ply back. All exposed vertical & horizontal surfaces to be laminate with 1mm thick laminate. Shelves of 19mm block board to be provided at 16" c/c and vertical partition at 3'0" c/c. Shutters will have locking arrangement and S.S. handels. All hard ware fittings of superior quality. All internal exposed surface of block board will be finished with 0.8 mm thick laminate. All exposed T.W. beading to be polished / Painted as per approved colour. All hardware fitting will be of superior quality.	Sq.Ft.	165		
15	P & F Over head storage cabinets 1'4" deep made out of 19mm block board with 6mm ply back. All exposed vertical & horizontal surfaces to be laminate with 1mm thick laminate. Shelves of 19mm block board to be provided at 1'3" c/c and vertical partition at 3'0" c/c. Shutters will have locking arrangement and S.S. handels. All hard ware fittings of superior quality. All internal exposed surface of block board will be finished with 0.8mm thick laminate. All exposed T.W. beading to be polished/Painted as per approved colour. All hardware fitting will be of superior quality.	Sq.Ft.	85.45		

16	P&F Filing Cabinet - 1'-4" deep & 2'-6" Height made out of 19mm block board with 6mm ply back. All exposed vertical & horizontal surfaces to be laminate with 1mm thick laminate. Shelves of 19mm block board to be provided at 1'3" c/c and vertical partition at 3'0" c/c. Shutters will have locking arrangement and S.S. handels. All hard ware fittings of superior quality. All internal exposed surface of block board will be finished with 1.0 mm thick laminate. All exposed T.W. beading to be polished/Painted as per approved colour. All hardware fitting will be of superior quality.	Sq.Ft.	90		
17	CLERICAL COUNTER				
	Supplying, fixing & keeping in position clerical counter made out of 19mm block board. The cost shall be inclusive of following: Working top 2'6" wide (at 2'6"ht) with 1.0mm thick laminate on top & provision for key board tray fixed below working top. Cable managers to be provided for wires & cables. Each counter will have 1 nos. Openable cabinet with 2 Nos. drawer unit 1'4" wide made out of 19mm block board sides & 6mm ply bottom fixed on sliding telescopic drawer channels with locking arrangement. A pedestal below 1'0" wide to be provided for keeping CPU. Facia of drawer & top of pedestal to be finished with 1.0 mm thick laminate. Front panel shall be finished with 1.0mm thick laminate. All exposed edges of block board will have 6mm thick T.W. beading. Counter shall have foot rest made out of 3" x 2" T.W. section duly polished. All fittings like handles, knobs, lock, hinges, etc., will be of superior quality. All internal exposed surface of block board will be finished with 1.0 mm thick laminate. All exposed T.W. beading to be polished/Painted as per direction, finished complete.	R.FT	23		
18	Counters provided with front glass panel -12 mm thick (toughened with polished Edges) above the Table top at Front upto1'6" vertical parallel to counter,above Table Top (i.e. 4'0" height from floor top) fixed between table side partitions by means of s/s clamps/D.Brackets or with Teak Wood Beadings.Openings in Glass panel is to be provided as per the direction of Architect /drg. Provided.	R. Ft.	27		
19	CASH COUNTER :				

	Supplying, fixing & keeping in position counter made out of 19mm block board. The cost shall be inclusive of following: Working top 2'-6" wide (at 2'-6"ht) with 1.0mm thick laminate on top & provision for key board tray fixed below working top. Cable managers to be provided for wires & cables. Transaction top 1'4" wide (at 3'10"ht.) finished with 1.0 mm thick laminate. Cash transaction slot to be provided as directed. Each counter will have 3 nos. drawer unit 1'4" wide made out of 19mm block board sides & 6mm ply bottom on sliding drawer channels with locking arrangement. Drawer will also have internal (removable) partitions in drawers as desired by the cashier for keeping notes of different denominations. A pedestal below 1'0" wide to be provided for keeping CPU. Facia of drawer & top of pedestal to be finished with 1.0mm thick laminate. Front panel shall be finished with 1.0mm thick laminate. All exposed edges of block board will have 6mm thick T.W. beading. All fittings like handles, knobs, lock, hinges etc. will be of superior quality.	R.Ft.	45		
20	CASH CAGES PARTITION				
	P&F in position cash cabin partition above cash counter on front side and above 3' ht upto 6'4" ht on sides, made out of kail wood frame work with 12mm clear toughened glass with exposed edges duly polished . P&F cash cabin partition on (7'0") side & back of cash counter. Partition will be made out of 2" x 1½" kail wood sections 2'0" c/c both ways covered with 6mm ply duly laminated with 1mm thick laminate on both sides up to 3'9" height from ground level & from 3'9" up to 6'10" 12mm thick clear toughened glass to be provided fixed with teak wood beading duly polished. Cost shall be inclusive of 30mm thick door with 12mm thick clear toughened glass (as directed) from 3.9" upto 6'10" & below 3'9" finished with 1mm thick laminate on both sides. Top roof of cash cabin have 6mm tick m.s. jail 3"c/c for security reason welded to sides angles 1/2" x 1/2" painted white .The cost will also include mortice lock, hinges, S.S. Handles,door stopper, godrej door closer and tray made out of 19mm block board laminate finish on side partition etc complete. . All necessary hardware like handles, hinges, Door Closers,night latch, aldrop etc to be provided will be of superior quality. All wood work to be polished/Painted . All exposed edges of 12mm glass to be duly edge polished complete.	Sq.Ft.	367.9		
21	FALSE CEILING				
A	GYP SUM BOARD				

	Providing and fixing gypsum false ceiling in 12.5mm thick Gypboard (POP) plain false ceiling with GI suspended from RCC slab/ Beam as approved by Bank/ Architect including G.I. Parameter Channels of size 0.55 mm thick having one flange of 20mm and another flange of 30mm and web of 27mm along with parameter of ceiling, screw fixed, to the	Sq.Ft.	420.19		
	The suspended G.I. Intermediate channels of size 45 x 0.9 mm thick with two flanges of 15mm each from the soffit at 1200mm C/C with GI cleats and steel expansion fasteners. Ceiling sections of 0.55mm thick having web of 51.5mm and two flanges of 26mm each with lips of 10.5mm are then fixed to intermediate channel with help of connecting clips and in direction perpendicular to intermediate channel at 457 mm C/C. 12.5mm Tapered edge Gypboard channel at 457mm C/C in both the directions screwed fixed to the ceiling				
B	ARMSTRONG				
	Providing and fixing of false ceiling at all heights of 600mmx600mmx12mm armstrong mineral fiber ceiling tiles of type IBIZA RH-90 laid on armstrong prelude XL exposed grid systems with 9mm wide T Section flanges colour white. The frame work comprise of main runner spaced at 1200mm centers securely fixed to the structural soffit approved				
	be fixed by approved roof plug and screws etc. The last hanger at the end of each main runner should not be greater than 450mm from the adjacent wall. flush fitting 1200mm along cross tees (with double stitching) to be interlocked between main runners at 600mm c/ c to form 1200x600mm modules. Cut cross tees longer than 600mm to be supported independently. 600mmx600mm modules to be formed by fittings 600mm long flush fitting cross tees centrally between the 1200mm cross tees. Perimeter trim to be armstrong wall	Sq.Ft.	623.22		
22	SHUTTER BOXING				
	Providing & fixing wooden paneling for shutter boxing i/c of trap door for rolling shutter made out of 19mm ply wood (BWP: IS 710 grade) finished with synthetic enamel /1 mm. th Mica Laminate on all external exposed surfaces	Sq.Ft.	154.8		
	mechanically with drilling machine and suitable attachment. Finally the boards are to be jointed and finished with jointing compound, paper tape and two coats of top Coat, suitable for Gypboard (As recommended practice of India Gyp.) For light fittings incutouts etc are to be made with a frame of parameter channels of size 20 x 27 x 30 x 0.5mm thick supported suitably. Angle beads, edge bends, control joints as required to be provided. The quoted rates to include all the above items, ceiling to be				

	Painted with minimum two coats of				
23	NOTICE BOARD				
	Providing & fixing notice board made out of 19mm block board finished with 1.0mm thick laminate externally. Back will be 8mm thick ply with blazer cloth finish fixed on 12mm thick celotax board. Front shall be 6mm thick float glass fitted in Aluminum double channel for smooth sliding. All exposed edges of Block board will have 6mm T.W. beading duly polished. All hardware to be of superior quality.	Nos.	1		
24	ETCHING FILM				
	Providing and fixing at site approved design & pattern of etching film to be 3m 7725- - 325 Pressure sensitive film for permanent graphic fixed at site over the glazed area as per the given design & drawing including all materials, wastage etc complete.	Sq.Ft.	55		
25	DOOR CLOSERS				
	Providing & Fixing Hydraulic Door Closers of Godrej/ hyper make only, to Door Shutter with Frames using necessary Screws, Nuts & Bolts etc. complete.	Nos.	6		
26	DUST BIN:				
	Supply of SS perforated type dustbin to be placed inside ATM lobby.	Each	2		
	TOTAL ESTIMATED COST OF INTERIOR FURNISHING WORKS .				0

ISHITA ARCHITECTURAL CONSULTANT
Architects, Interior Designer

**BOQ OF ELECTRICAL WORKS FOR NEW BRANCH PREMISES AND A.T.M. OF UCO BANK AT
SUPER CORRIDOR, INDORE (M.P.)**

Sr. No	DESCRIPTION OF ITEM	QTY.	UNIT	RATE	AMOUNT
	<u>ELECTRICAL WORKS</u>				
1	SUBHEAD I (POINT WIRING)				
	The rates for the point wiring shall include providing and fixing of following:				
a.	Wiring of the point of any length from distribution board to point outlet excluding circuit wiring				
b.	Earthing of all switch box and all outlet boxes fitting, fans, 3rd pin of plug with 1.50mm copper wire.				
c.	Modular Switch/ Sockets of Standard make with necessary modular series cover plate and MS Boxes				
d.	Embedding all conduits in walls laying in slabs, above false ceiling or in floors including all accessories as required, cutting and refilling the chases with cement mortar .				
e	Providing, fixing Modular switches, sockets, M.S. boxes (1.6mm thick) draw boxes, G.I. Pull wires (where required), brass screws, ceiling rose/connector etc.				
f	Adopting separate and independent system of wiring for lighting, power (normal and essential supply). Wiring for following points using PVC insulated copper conductor wires of 650V/1100V grade in 16 SWG M.S. conduit stove enameled concealed/ exposed including switches & sockets as above.				

g	Circuit wiring for Lighting circuit with 2 x 2.5 + 1 x 1.5 sq mm PVC insulated copper conductor single core multi stranded wire in 16 swg stove enameled rigid steel conduit with conduit accessories like bend, junction box etc on surface / recessed manner etc (Wiring from D.B. / Source to Board/destination) and making good all the damages, painting, cleaning the site etc complete as required as per				
	INTERNAL WIRING				
1	POINT WIRING :				
	Providing wiring (supply, fixing, testing and comm. etc) for light point / Exhaust fan point / Call bell point etc with 1.5 sq mm PVC insulated copper conductor single core multi stranded wire in 16 swg stove enameled rigid steel conduit with conduit accessories like bend , junction box etc in concealed/surface manner as per site requirement with suitable Modular Switches with plate and metal / PVC box, ceiling rose , bulb holder etc including 1.5 sqmm PVC insulated copper earth wire etc complete as required. Wire				
a.	Providing and fixing one light point controlled by one switch.	72	NOS		
b.	Providing and fixing two light point controlled by one switch.	36	NOS		
c.	Providing and fixing one fan point controlled by one switch with stepped regulator (Two Module) as required.	7	NOS		
2	6 AMP. POINTS ON SAME BOARD :				
	Supply, fixing, testing and commissioning of 1 No 6 A Multi Socket with 1No. 6 A switch (Modular type) with cover plate , sheet steel box / PVC modular box etc on surface / concealed manner I/c electrical connections and making good all the damages, painting, cleaning the site etc	15	NOS		
3	16 AMP. POWER POINTS:				

	Supply, fixing, testing and commissioning of 1 No 16 A switch & 1 No. six pin 6/16 Amp. Multi Socket (Modular Type) with cover plate , sheet steel box etc on surface / concealed manner l/c electrical wiring with 2 X 2.5 sqmm + 1 X 1.5 sqmm PVC insulated copper conductor single core multi stranded wire in 16 swg stove enameled rigid steel conduit with conduit accessories like bend, junction box etc on surface / recessed manner etc (Wiring from D.B. / Source to Board/destination) and making good all the damages, painting, cleaning the site etc complete as	13	NOS		
	PANELS AND D.B.'s				
4	MAIN PANEL :				
	Supplying, fixing in position, testing and commissioning of following type Loadline DB comprising of				
	INCOMER				
	1 Nos – 80 Amp MCCB				
	OUTGOINGS				
	2 Nos- 40 Amp MCB				
	1Nos- 63. Amp MCB				
	1 Nos 20 Amp DPMCB (Glow sign)				
	SET AS ABOVE	1	Nos		
5	LIGHT DISTRIBUTION BOARD				
	Supply, Installation, Testing and commissioning of the surface / recess mounting following way MCB three phase distribution board for single phase outgoing with IP 42 protection , direct on wall incl. the followings accessories				
	INCOMER				
	1 No. TPMCB 40 Amp				
	OUTGOINGS				
	8-10 Nos SPMCB 6-10 Amp				
	SET AS ABOVE	1	Nos		

	incl. Electrical connection ,earthing, making good all the damages, painting, cleaning the site, etc complete as per site requirement and as directed.				
	SUBHEAD IV : UPS WIRING				
6	U.P.S. DISTRIBUTION BOARD (INCOMER)				
	Supply, Installation, Testing and commissioning of the surface / recess mounting following way Double door MCB D.B.- Single phase distribution board (Consumer unit) for single phase out going with IP 42 protection incl. the followings accessories – incl. Electrical connection ,earthing, making good all the damages, painting, cleaning the site, etc complete as per site requirement and as directed.				
a.	INCOMER				
	1 NOS 40 A TPNMCB				
	OUTGOINGS				
	2 Nos- 40 Amp SPN				
	SET AS ABOVE	1	Nos		
b	UPS DIST. BOARD OUTGOINGS.				
	1 NOS 12 WAY SPN DIST BOARD				
	1 Nos- 40 Amp SPN				
	6-8 NOS 6 AMP SPMCB				
	SET AS ABOVE	1	Nos		
7	SPECIAL POINTS: (UPS) any length				

	Supply, fixing, testing and commissioning of following Modular type switch socket with cover plate , sheet steel box etc on surface / concealed manner l/c electrical wiring with 2 X 2.5 sq mm + 1 X 1.5 sq mm PVC insulated copper conductor single core multi stranded wire in rigid 16 swg stove enameled rigid steel conduit with conduit accessories like bend, junction box etc on surface / recessed manner etc (Wiring from D.B. / Source to Board/destination) and making good all the damages, painting, cleaning the site etc				
	2 Nos. 6 A Switch + 3 Nos. 6 A, 5 pin Socket.	15	Nos.		
	CABLING :				
8	L.T.CABLES :				
	Supply,laying ,testing and commissioning of the following 1100 volt grade pvc insulated Al / Cu. Conductor armored cable inner and outer sheathed , along with the two run of G.I.earth wire i/c termination with brass gland and Al. lugs etc. complete as required.				
A	On surface :				
	S/Fixing the cable on wall / column / beam / ceiling / above false ceiling / existing trench etc incl. s/f of of saddles / spacers (wherever required as per site conditions) and two run of G.I. earth wire along with the cable. Making good all the damages				
a	4 C x 10.0 sqmm armored copper cable with 10 SWG 2 Nos G.I. wire for ups room	265	M		
b	3.5 C x 50.0 sqmm armored Aluminium cable with 10 SWG 2 Nos G.I. wire for pole to main board	132	M		
	TELEPHONE WIRING / CABLING SYSTEM.				
	TELEPHONE POINT :				

9	Supplying, Installation, testing and commissioning of the telephone point with the followings -				
a.	Two pair, 0.61 mm dia. telephone cable tinned copper conductor, P.V.C. insulated and sheathed , fire retarding, anti termite, color coded twisted pairs and rip cord.				
b	HMS Pvc pipe on beam /column / wall / / floor etc with all necessary materials i/c connections, identification by numbering etc complete as required as per I.T.D. specification.				
c.	Single outlet with shutter modular type Telephone Outlets (RJ – 11) with suitable size M.S./ PVC modular boxes complete as required .	12	Nos.		
TOTAL ESTIMATE COST FOR ELECTRICAL WORKS					

	COMPUTER CABLING SYSTEM.				
	COMPUTER POINT : I / O's :				
1	Supplying, Installation, testing and commissioning of the Computer point with the followings -				
a.	Four pair STP CAT 6 LAN cable tinned copper conductor, P.V.C. insulated and sheathed , fire retarding, anti termite, color coded twisted pairs and rip cord.				
b	HMS Pvc Pipe on beam /column / wall / floor etc with all necessary materials i/c connections, identification by numbering etc complete as required as per At & T specification.				
c.	Single outlet with shutter modular type I / O's Outlets (RJ – 45) with suitable size M.S./ PVC modular boxes complete as required	22	Nos.		
2	Supply and Installation of following factory fabricated patch cords (STP-CAT 6) complete with connectors and boots on both sides.				
a.	One Meter length	14	Nos.		

b	Two Meter length	14	Nos.		
3	Supply and laying of Four Pair STP CAT 6 LAN cables including cost of 25mm dia 1.5mm thick PVC Conduit / Floor trunking.	375	Mtrs.		
4	Testing of STP cabling with scanner for all the Nodes.	1	Nos		
	TOTAL ESTIMATED COST FOR COMPUTER NETWORKING				
	ELECTRICAL FITTINGS				
	SUBHEAD III : ELECTRICAL FITTINGS				
1	DECORATIVE CFL / FTL LUMINAIRES :				
	Supply, fixing, testing and commissioning of Recess mounted decorative luminaire with square paralite metalised louvre in metallic frame, held securely to the main body by four toggles, epoxy white powder coated CRCA sheet steel housing, electro-chemically brightened, polished and anodized aluminium mirror reflector, Prewired with Low watt loss ballast type BLLB, push fit pin holders and mains connector, true light lamp, etc with class-I electrical safety, complete as required. Fitting Dimensions : 600X600X80 mm				
	a) 600 x 600 mm LED Panel 36 w	23	Nos.		
	(Approx.) Location : make philips, crompton, SYSKA, Wipro				
2	DOWN LIGHTER :				
	11 W LED CIRCULAR DOWN LIGHTER make philips, crompton, SYSKA, Wipro or EQ	39	Nos.		
3	1X20w T-5 led fitting with electronic choke make philips, crompton, SYSKA, Wipro or EQ or equivalent make.	3	Nos.		
4	BRACKET FAN				
	Supply and fixing of the following fans Wall bracket fan white (400mm blade size) crompton, Bajaj or equivalent make.	4	Nos.		

5	Supply and fixing of the following ceiling fans double Ball bearing without regulator. (Brilliant white)				
	1200mm sweep	3	Nos.		
	(Make: Crompton Greaves/Usha/Almonard/Khaitan.				
6	Supply and fixing of the 300 mm (900 RPM) sweep exhaust fan , Including making hole in the wall for fixing , and making good the civil damages etc as required. Crompton , Almonard	2	Nos		
TOTAL ESTIMATED COST FOR ELECTRICAL FIXTURES					