



NOTICE

Ref No: ZOBH/GAD-PREM/TN/100/2018-19

DATE: 23.11.2018

UCO Bank, Zonal Office, Bhagalpur desires to invite sealed offers from reputed Contractor for **execution interior furnishing and electrical work in Sultanganj Branch and Electrical Work in Katoria Branch as per Bank's specification under supervision of our empanelled architect in TWO PART SYSTEM, PART- I (Pre-Qualification Documents) & PART- II (Bid Documents)** to be submitted to **Zonal Manager, UCO Bank, Zonal Office, Bhagalpur** in two separate envelopes. The eligible and interested contractor may collect the "**Document for Tender**" from the following **Zonal Office, Bhagalpur** by paying non-refundable fee of **Rs. 1000.00** by way of **Cash/Demand Draft payable to ZONAL OFFICE, BHAGALPUR**. The document can also be downloaded from our website. The document submitted without the prescribed fee will be summarily rejected. The duly completed document in the prescribed format with all supporting documents shall be sealed in a cover and super scribed as 'Application for TENDER of (Category name)', (Branch name) and the same be submitted to **ZONAL OFFICE, BHAGALPUR**.

Tender document may be obtained/downloaded from 26.11.2018 to 10.12.2018 from Zonal Office & Bank website (www.ucobank.com)

Date & Place of Submission of Tender: Upto **3.00 PM on 11.12.2018** at the office of the Zonal Manager, UCO Bank Zonal Office, S K TARAFDAR ROAD, ADAMPUR, BHAGALPUR.

Tender will be addressed to: Zonal Manager, UCO Bank Zonal Office, S K TARAFDAR ROAD, ADAMPUR, BHAGALPUR.

Date, Time & Place of opening of Tender : 11.12.2018 at 3.30 PM in Zonal Office, Bhagalpur

UCO BANK reserves its right to reject any / or all the applications without assigning any reasons whatsoever.

-sd-
Zonal Manager
Zonal Office, Bhagalpur



NOTICE OF INVITATION TO TENDER

Sealed tenders on item/rate over estimated cost basis are invited from competent Interior Furnishing, Electrical & Data Cabling contractors having sound technical and financial capacity for Furnishing, Electrical & Data Cabling works of UCO BANK, SULTANGANJ BRANCH , BHAGALPUR, BIHAR.

Parties who have not executed one or two work of similar nature, each costing not less than 75% of the estimated cost satisfactorily during last two or three year & does not have any office/site or presence in the Bihar state need not respond. Contractor must have valid license for Electric work and copy must be attached herewith for reference.

Tender will be submitted in two parts in two separate envelopes

First Part: Application format duly filled by Contractor, Signed Tender Form with EMD amount and Tender Fees.

Second Part: Financial Bid.

Tender collection: - Tender document may be obtained from 23.11.2018 to 10.12.2018 at 10:30 AM to 05:00 PM from following address-

**UCO BANK
ZONAL OFFICE
S K Tarafdar Road, Koyalaghat, Adampur Chowk
Bhagalpur, Bihar**

Tender fee: - 1000.00

Estimated cost of project: - **Rs. 7,86,956.00**

Time of completion: - 25 Days

Earnest Money: - **Rs.8000.00** By crossed demand draft/ Banker'scheque drawn in favour of
ZONAL MANAGER UCO BANK payable at Bhagalpur.

Time and date of

Submission of tender: - Up to 3:00 P.M. on 11.12.2018

at **UCO BANK ZONAL OFFICE
S K Tarafdar Road, Koyalaghat,
Adampur Chowk, Bhagalpur.**

Time and date of Opening of tender:

at

First part: 11.12.2018 at 03.30 PM

Second Part: 11.12.2018 at 04.00 PM

**UCO BANK,ZONAL OFFICE
S K Tarafdar Road, Koyalaghat,
Adampur Chowk, Bhagalpur**

Note: Tender may be downloaded from UCO Bank website: www.ucobank.com

The bank will not be bound to accept the lowest tender and reserves the right to accept or reject any or all the tenders without any reason what so ever.



ZONAL MANAGER

ZONAL OFFICE S K Tarafdar Road, Koylaghat, Adampur Chowk, Bhagalpur

**GENERAL RULES AND INSTRUCTION FOR GUIDANCE OF
TENDERERS**

- (1) Tenders are hereby invited on behalf of **UCO BANK, Bhaglpur ZONE** for Interior Furnishing, Electrical & Data Cabling works of UCO BANK, SULTANGANJ BRANCH, BHAGALPUR, BIHAR and estimated cost of Rs. **7,86,956.00**
- (2) Contract documents consisting of the plan, complete specification, the schedule of quantities of the various classes of work to be done, and the set of conditions of contract to be complied with by the persons whose tenders may be accepted, and which will also be found in the form of tenders can be purchased from **UCO BANK ZONAL OFFICE BHAGALPUR** Between the 10:30 AM to 05:00 PM every day, except on Sunday and Bank Holiday.

The site for the work is available/The site for the work shall be made available in parts as specified below.

- (3) Tenders, which should always be placed in sealed cover, with the Name of project written on the envelopes will be received by **UCO BANK ZONAL OFFICE Bhagalpur** up to 3:00 PM on 11.12.2018 and First part will be opened in Zonal Office at 03:30 PM on 11.12.2018 and Financial Bid will be opened on 11.12.2018 at 04:00 PM
- (4) Tenders are to be on the prescribed form which can be obtained from **UCO BANK ZONAL OFFICE BHAGALPUR**. The time allotted for the carrying out of the work will be 20 Days from the next day after the date of written orders to commence work
- (5) The contractors should quote rate and amount in figures as well as in words tendered by them. The amount of each item should be worked out and requisite totals given.
- (6) Contractors should signs & stamp on each page on tender papers and submit it.
- (7) The last date of Issue of tender form will be on 10.12.2018 up to 05:00 PM.
- (8) Earnest money RS. **8000.00** in the form of Bank draft/Banker's cheque in favour of **ZONAL MANAGER UCO BANK** must accompany with each tender and each tender is to be in a sealed Envelopes super scribed on it " **TENDER FOR (Name of the Project)** " and addressed to :-

**ZONAL MANAGER
UCO BANK ZONAL OFFICE,
S K Tarafdar Road, Adampur Chowk, Bhagalpur**

- (9) The contractor whose tender is accepted will be required to furnish by way of security deposit 2.0% for the amount of awarded tender for the due fulfillment of his contract in the form of Bank draft/Banker's cheque in favour of **ZONAL MANAGER UCO BANK ZONAL OFFICE BHAGALPUR**.

The **EMD** of the contractor, whose tender is accepted, shall be forfeited in full in case he does not remit the Initial security deposit within the stipulated period or start the work by the stipulated date mentioned in the award letter.

- (10) The acceptance of a tender will rest with the **UCO BANK BHAGALPUR ZONE** which does not bind itself to accept the lowest tender, and reserves to itself the authority to reject any or all of the tenders received without the assignment of a reason .All tenders in which any of the prescribed condition are not fulfilled or are incomplete in any respect are liable to be rejected.

The Bank reserves the right to accept the tender in full or in part and the tenders shall have no claim for revision of rates or other conditions if his tender is accepted in part.

- (11) Canvassing in connection with tenders is strictly prohibited and the tenders submitted by the contractors who resort to canvassing will be liable to rejection.
- (12) All rates shall be quoted on the proper form of the tender alone.
- (13) An item rate tender containing percentage below/above will be summarily rejected, However where the tenderer voluntarily offer a rebate for payment within a stipulated period, this may be considered.
- (14) On acceptance of the tender, the name of the accredited representative of the contractor who would be responsible for taking instruction for the Employer/Architect shall be communicated to the employer.
- (15) Special care should be taken to write the rate & amount in figure as well as in words in such a way that interpolation is not possible .The total amount should be written both figures and in words. In case of figures the words Rs. should be written before the figures of rupees and words after the decimal figures. Example Rs. 2.15P ,and in case of words ,the word “Rupees” should precede and the word “paisa” should be written at the end, unless the rate is in whole rupees and followed by the words “only”. It should invariably be up to two decimal places. While quoting the rate in schedule of quantities , the word “only” should be written closely following the amount and it should be not be written in the next line.
- (16) The bank does not bind itself to accept the lowest or any tender and reserves to itself the right of accepting the whole or any part of the tender and the tenderer shall be bound to perform the same at the quoted rate.
- (17) The rate quoted by contractor includes all tax & royalty like sales tax, V.A.T, contract tax, turn over tax etc. The bank will not entertain any claim whatsoever in this respect.
- (18) The contractor shall give a list of his relatives working with the Bank along with their designation and addresses.



- (19) No employee of the Bank is allowed to work as a contractor for a period of two years of his retirement from the Bank service without the previous permission of the Bank. The contract is liable to be cancelled if either the contractor or any of his employees is found at any time to be such a person who has not obtained the permission of the Bank as aforesaid before submission such a person who has not obtained the permission of the Bank as aforesaid before submission of the tender or engagement in the contractor's service.
- (20) The tender of works shall remain open for acceptance for a period of two days from the date of opening of tenders if any tenderer withdraw his tender before the said period, then the Bank shall be at liberty to forfeit his earnest money paid along with the tender.
- (21) The tender for the work shall not be witnessed by a contractor or contractors who himself/themselves has/have tendered or who may and had/have tendered for the same work failure to observe this condition would render tenders of the contractors tendering as well as witnessing the tender liable to summary rejection.
- (22) It will be obligatory on the part of the tenderer to tender and sign and tender document for all the component part and that after the work is awarded, he will have to enter into an agreement for each component with the competent Authority in the Bank.
- (23) It may also be noted that entire allotted work should be completed within **25 (Twenty Five) Days** from receipt of this letter, failing which a sum of Rs. **500.00 (Five hundred)** per day, being the amount of default charge, will be recovered from you after the expiry of stipulated period.
- (23) The tenderer, apart from being a competent contractor must associate himself with agencies of the appropriate class who are eligible to tender for (a) Interior (b) sanitary & water supply installation and (c) AC.

Signature of competent Authority

-sd/-

ZONAL MANAGER
UCO BANK

LIST OF APPROVED MATERIALS/MANUFACTURERES

DESCRIPTION

MAKE

Board / Ply (BWP)	:	Green/ Duro/Century
Laminate (1.0mm th)	:	Green/ Sunmica/Formica/ Century
Door Closer / Floor spring	:	Everite,Godrej, Hemaco
Drawer & Keyboard, Slide	:	Ebco (Telescopic)
Glue for fixing	:	Fevicol (Pidilite), Jivanjor
Glass	:	Modi Float, Saint Gobain
Mortice Latch & Lock	:	Godrej, Golden Industries Ltd.
Aluminium Sections	:	Jindal / Indal / Hindalco
False Ceiling	:	Gypsum marked “Gypsteel” , Lafarge
Synthetic Enamel	:	Asian, Nerolac, ICI, Berger
Emulsion Paint/Plastic Paint	:	Asian, Nerolac, ICI , Berger
Screws	:	Nettlefold / G.K.W.
Vitrified Tiles	:	Naveen/Somany/Euro
Ceramic Tiles	:	Naveen/Asian/Euro
Wood	:	IInd Grade teak wood

Note: Material used other than above mentioned items must be approved from the Architects/ Bank.



TENDER FORM

TO

Tender notice no: _____

Date: _____

Name of work: proposed electrical and furnishing of Bhagalpur Main branch.

Sir,

I/we the undersigned have examined the tender document and the site of works as hereby submit this tender amounting the sum of RS.....and should the same be accepted hereby undertake to execute complete and maintain all works as set forth in the schedule of quantities and specifications in accordance with the conditions of tendering, general conditions of contract, and the rates quoted by us in the aforesaid schedule of quantities all here to annexed or in default thereof to forfeit and pay to UCO BANK the sum of money mentioned in the aforesaid documents.

I/We agree to abide by this tender for the period of one year from the date fixed for opening of the same.

I/We undertake to complete and deliver the whole of the works covered under this tender within a period of 25 (Twenty Five) calendar days from the date of issue of work order.

I/we undertake to deposit Initial Security Deposit @ 2% of project cost if I/we were awarded the tender.

I/we submit a copy of the Electric License No.....valid uptofor your ready reference.

I/We shall be bound by the terms and conditions of the tender documents and our accepted tender.

Signature of tenderer

Name

Address

Date:-

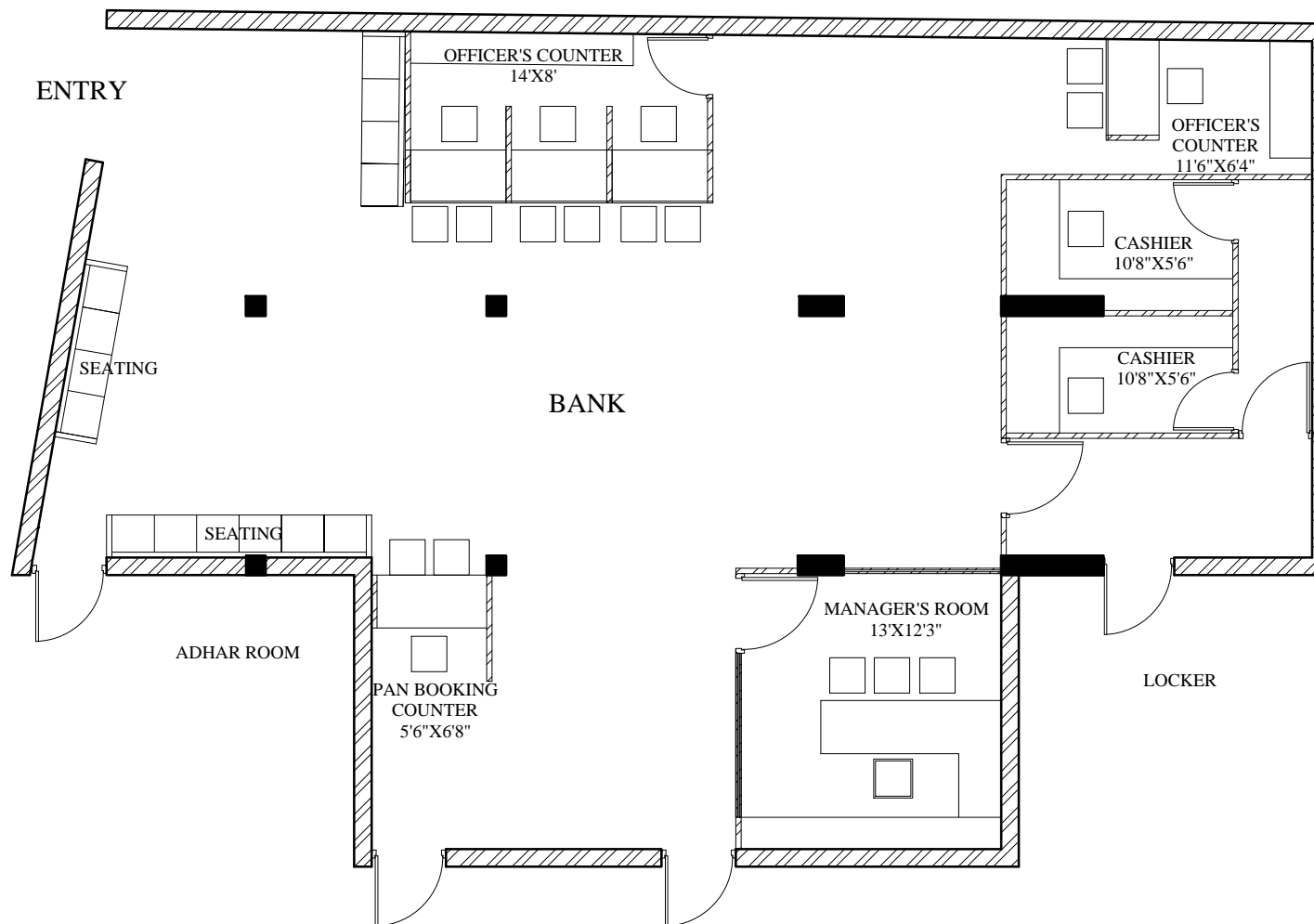

novus
ARC DESIGN PVT. LTD

C-6,NETAJI SUBHASH ENCLAVE,
GADAKANA , BHUBANESHWAR ,
ODISHA
PH: +91 8763522530
E-MAIL : respond2nad@gmail.com

GENERAL NOTES

1. THIS DRAWING AND DESIGN IS THE PROPERTY OF THE DESIGNERS. NO PORTION MAY BE USED OR REPRODUCED WITHOUT THEIR WRITTEN PERMISSION.
2. ALL DIMENSIONS ARE TO BE VERIFIED ONSITE BY THE CONTRACTOR. ANY DISCREPANCIES ARE TO BE REPORTED TO THE DESIGNERS IMMEDIATELY.
3. THIS DRAWING IS TO BE READ IN CONJUNCTION WITH THE DESIGNERS SPECIFICATIONS AND CONDITIONS OF CONTRACT.
4. DRAWINGS NOT SHOWING THE LATEST REVISIONS ARE TO BE CANCELED.
5. ALL DIMENSIONS ARE TO BE READ NOT SCALED.
6. ALL INDICATED LEVELS ARE FINISHED LEVELS UNLESS NOTED OTHERWISE.

NO.	DATE	REVISIONS

CLIENT:
UCO BANK

PROJECT:
INT-SULTANGANJ-UCO BANK-
BRANCH OFFICE

SHEET TITLE :
PLAN-FURNITURE LAYOUT

DRAWN BY :
MAYNAK

HANDLED BY :
AR.A.KAUSHAL

DATE : 31 OCT 2018
SCALE : NTS

SHEET NO :
01



DETAILED WORKS DONE FOR INTERIORS OF UCO BANK, SULTANGANJ				
1915 SQ FT - CARPET AREA				
		AREA	RATE (SQ FT)	AMT
PVC VINYL FLOORING				
	Providing and fixing of pvc vinyl flooring with proper adhesive and equipments with approved design.It thickness should be of atleast 2mm and should be fire resistant,anti slip performance,bacterial resistance.	1912		
CARPENTRY WORK				
	MANAGER'S TABLE: Providing and Placing Manager Table of size (6'-0" X 2'-6" X 2'-6") edged with teakwood beading of 2"x2" (approx) cut to required shape, top of table to have 1.0mm thick laminates and teakwood beading to be polished to required colour. Table to have a vertical modesty panel of 19 mm thick blockboard covered with laminates (1.0mm thick) from the outer side and (0.8mm thick) laminates on the inner side including supply and fixing of sliding keyboard of approved make and provision of 1 no.s drawer & 1 no file cabinet with lock & all fitting. In all these tables/counters provision shall be made so that the CPU of the computer can be kept under the table and only the monitor shall be visible. Also there shall be neat hole in the table top for the wire.	1		
	MANAGER'S CABIN BACK-STORAGE UNIT: Providing and fixing 1'-6" deep, 3'-0" high, 9'-5" long Low Height Storage unit in Manager Cabin of size as mentioned in the drawing made with 19mm thick water proof ISI board of approved make all complete with necessary hardware, locking arrangement, handle. All exposed surface should be finshed with 1.0mm thick laminate of approved make and shade and internal surface should be finished with 0.8mm thick laminate as per drawing and direction.	1		
	DOORS: Providing and fixing of 4Nos.(sizes: 3'x7') & 2 Nos.(sizes: 3'4"x7') of 25 mm ply doors with 1 mm lamitate of approved mark on both sides and adequate hardware fittings.	131		
	MAIN DOOR WITH 12mm TH GLASS: Providing and fixing Main entrance aluminium glazing work at main entrance door comprising approx 85-100 mm size top and bottom aluminium powder coated/anodized with brown color shade frame of 2.5 mm thick including SS designer handle, heavy duty floor spring, lock including with logo of UCO BANK made with etching on glass neatly written and as per the instructions of the Bank/Architect. (GLASS DOOR SIZE-8'X8')	64		

<p>FULL HEIGHT SEMI GLAZED PARTITION:(MANAGER CABIN) Providing and fixing full height wooden partition with frame of 2"x2" (finished size) seasoned hard wood member at max. intervals of 1'-6" x1'-6" c/c with provision of bigger at skirting, fixing to the ceiling, slab, beams etc including the door. All woodwork to be treated with 1st quality anti termite paint and should be covered with 12 mm thick ply Board of approved make finished by 1.0 mm thick laminate of approved make on both side including the glazing part made with 8 mm clear glass (wooden-2'-0"+glass-5'-0"+wooden2'-0"-upto ceiling) including supply and fixing of Door Handle,Door Closer,Door Lock, Door stopper, Mortise Lock, Night Latch,hardware, etc.</p>	204		
<p>OFFICER'S COUNTER PARTITION & BACK STORAGE: Providing and Placing a back storage unit of size (10' long, 2' wide & 3' high) is to be made with top made of 19 mm thick blockboard, edged with teakwood beading of 2"x2" (approx) cut to required shape with partition walls upto 4' high adjacent to tables and adjoining the door. Table to have a verticle modesty panel of 19 mm thick blockboard. Top and vertical board shall becovered with laminates (1.0mm thick) from the outer side and (0.8mm thick) laminate on the inner side including supply and fixing of sliding keyboard of EBCO/Efficient</p>	200		
<p>OFFICERS TABLE: Providing and Placing Officer'sTable of size (4'-6"x2'-0") with top made of 19 mm thick blockboard, edged with teakwood beading of 2"x2" (approx) cut to required shape with an insert of different coloured wood in the center, top of table to have 1.0mm thick laminates and teakwood beading to be polished to required colour. Table to have a verticle modesty panel of 19 mm thick blockboard covered with laminates (1.0mm thick) from the outer side and (0.8mm thick) laminate on the inner side including supply and fixing of sliding keyboard ofEBCO/Efficient Gadgets and provision of 2 nos drawer 1 no file cabinet with lock & hardware. In all these tables/counters provision shall be made so that the CPU of the computer can be kept under the table and only the monitor shall be visible. Also there shall be neat hole in the table top for the wire all complete with removing of existing table and hand over to the bank as per instructions.</p>	4		

<p>CASH COUNTER TABLE WITH DRAWER: Providing and Placing two tier Cash Counter Table of size (4'-6"x2'-0") table top at 2'-6" high and (4'-6"x2'-0") service top at 2'-6" high with top to be made of 19 mm thick board, edged with teakwood beading of 2"x2" (approx) cut to required shape, top of table to have 1.0mm thick laminates and teakwood beading to be polished to required colour. Table to have a verticle modesty panel of 19 mm thick board covered with laminates (1.0mm thick) from the outer side and (0.8mm thick) laminate on the inner side including supply and fixing of sliding keyboard of EBCO/Efficient Gadgets and provision of 1 nos drawer & 1 nos file cabinet with provision of lock in all. In all these tables/counters provision shall be made so that the CPU of the computer can be kept under the table and only the monitor shall be visible. Also there shall be neat hole in the table top for the wire. (Service top shall be finished with 19mm thick jet black granite)</p>	2		
<p>CASH COUNTER PARTITIONS: Providing and fixing double skin Partition of full height with frame of 2"x2" (finished size) seasoned hard wood member at max intervals of 2'-0" x2'-0" c/c with provision of bigger at skirting, fixing to the false ceiling, slab, beams, door frame etc including door. All woodwork to be treated with 1st quality anti termite paint and should be covered with 19 mm thick Ply of approved make and 1.0 mm thick laminate of approved make and 12 mm thick clear glass (all the glass of the counter shall be of 12 mm) Supply and fixing of Door Lock, Door Closer, Door stopper, Mortice Lock, Night Latch etc.</p>	470		
<p>PASS BOOK (TABLE+FRONT GLASS): Providing and Placing one tier Counter Table of 4' length, 2'-0" wide and 2'-6" high with top to be made of 19 mm thick blockboard, edged with teakwood beading of 2"x2" (approx) cut to required shape with. Table to have a verticle modesty panel of 19 mm thick blockboard. Top and verticle board shall be covered with laminates (1.0mm thick) from the outer side and (0.8mm thick) laminate on the inner side including supply and fixing of sliding keyboard of EBCO/Efficient Gadgets and provision of drawer/cabinet as per specification mentioned for the table. An integral part of all table to be used as counter, facing the public shall be 12 mm thick glass on the front counter table at a gap of 3" from the table, upto a total height of 12" from the table top, in teakwood frame as per design.. In all these tables/counters provision shall be made so that the CPU of the computer can be kept under the table and only the monitor shall be visible. Also there shall be neat hole in the table top for the wire all complete with removing of existing counter and hand over to the bank as per instructions.</p>	1		

PASS BOOK PARTITIONS: Providing and fixing double skin Partition of full height with frame of 2"x2" (finished size) seasoned hard wood member at max intervals of 2'-0" x2'-0" c/c with provision of bigger at skirting, fixing to the false ceiling, slab, beams, door frame etc including door. All woodwork to be treated with 1st quality anti termite paint and should be covered with 19 mm thick Ply of approved make and 1.0 mm thick laminate of approved make and 12 mm thick clear glass (all the glass of the counter shall be of 12 mm) Supply and fixing of Door Lock, Door Closer, Door stopper, Mortice Lock, Night Latch etc.	20		
COLUMN PANELLING: Providing and fixing Column paneling up to ceiling height with frame of 2"x2" (finished size) seasoned hard wood member at max intervals of 2'-0" x2'-0" c/c with provision of bigger at skirting, fixing to the false ceiling, slab, beams, door frame etc. All woodwork to be treated with 1st quality anti termite paint and should be covered with 6 mm thick Ply of approved make and as per design including 1.0 mm thick laminate of approved make. (Laminate shall be of number of horizontal/verticle/diagonal grooves and ply under such grooves shall be painted with approved colours and shades.	265		
PIN UP BOARD Supplying and fixing of pin up Board of size 3'0" x 3'0" made of 9mm plywood frame filled with soft board covered with fur. The outer teak wood frame of the pinup board to be finished with melamine of approved colour.	1		
BLINDS: Providing and fixing LUXAFLEX/VISTA LEVELOR brand Venetian Providing and fixing LUXAFLEX/VISTA LEVELOR brand Venetian blinds with 4" wide woven fabric coated blinds mechanism housed in head rail 1" wide high extruded from aluminium and louvers to be hung extruded from aluminium and louvers to be hung on superior quality runners with attached stainless steel spacer to obtain over lapping of 15 mm between the louvers	92		
COMPLAIN BOX: Providing and fixing of complain box with plyand laminate finish	1		
WRITING DESK: Providing and fixing Writting Desk as per drawing made of 12 mm thick Ply finished with 1.0 mm th laminate all Complete with hardware fittings and as per instruction of the Bank/Architect	1		
CHECK DROP BOX: Providing and fixing CHECK DROP BOX all complete with fixing as per guideline.	1		
WINDOWS: Packing of alternative windows with 6mm ply and laminate finish	80		
Aluminium sliding windows: Providing and fixing of windows with aluminium frame and glass	100		

WALL PAINT & PUTTY				
	Applying of 2 coats of putty, 1 coat of primer & 2 coats of paint. Paint should be of Asian, dulux. colour shade as per design	3200		
	TOTAL			
ELECTRICAL & LIGHTING WORKS:				
	LED TUBE LIGHT (18/26 W) of PHILIPS, JAQUAR, HAVELLS, OREVA, CROMPTON or equivalent. SUPPLYING, FIXING, INSTALLATION, CHECKING & WIRING WITH POLYCAB, FINOLEX or HAVELLS to be passed through telephonic and PVC tube (include main circuit wiring, panel and other)	28		
	EXHAUST FANS. of HAVELLS, USHA, OREVA, CROMPTON or equivalent. SUPPLYING, FIXING, INSTALLATION, CHECKING & WIRING WITH POLYCAB, FINOLEX or HAVELLS to be passed through telephonic and PVC pipes of 12 mm dia.	2		
	WALL MOUNTED FANS. of HAVELLS, USHA, OREVA, CROMPTON or equivalent. SUPPLYING, FIXING, INSTALLATION, CHECKING & WIRING WITH POLYCAB, FINOLEX or HAVELLS to be passed through telephonic and PVC pipes of 12 mm dia.	8		
	PANEL BOARD 250 AMP INCOMING & 8 NOS 63-100 AMP OUTGOING ALL THREE PHASE CIRCUIT WITH INDICATOR SUPPLYING, FIXING, INSTALLATION & CHECKING	1		
	UPS DISTRIBUTION BOARD Supply, Installation, Testing and commissioning double door D.B board for UPS POWER point circuit distribution complete with tinned copper bus bars, neutral link, earth bar, din bar, detachable gland plate inter connections including painting, earthing etc. as required. all complete as per instructions of Elec.Er. / Architect. 10A MCB-10 nos	1		
	LIGHT DISTRIBUTION BOARD: Supply, Installation, Testing and commissioning double door D.B board for Lighting point circuit distribution complete with tinned board for Lighting point circuit distribution complete with tinned copper bus bars, neutral link, earth bar, din bar, detachable gland plate inter connections including painting, earthing etc. as required. all complete as per instructions of Elec.Er. / Architect. 10A MCB-10 nos	1		
	CHANGE OVER SWITCH (BETWEEN TWO UPS): Supply and fixing of 32A 415 volt 4 pole change over switch on MS clamp and complete with all interconnection (For change over between two UPS) of Havells/L&T make in sheet steel over between two UPS) of Havells/L&T make in sheet steel enclosure on wall all complete with hardware.	1		
	MODULAR SWITCH BOARD ON WALL (LIGHT & FAN): Supply, Installation, Testing and commissioning of modular switch board with all accessories of approved make on wall/partition for light/fan points on wall/partitions. Each set contain 1 No 6 Amp switch socket including required switch in light control board with suitable size including GI box, board, & face plate. board with suitable size including GI box, board, & face plate. There must be individual switches for light and fan.	6		

	MODULAR SWITCH BOARD FOR IT RACK UPS POWER: Supply, Installation, Testing and commissioning of modular switch board for UPS Power with all accessories of approved make on wall. Each set contain(6 Amp Socket- 3 nos + 16 Amp Socket- 3 nos)	1		
	MODULAR SWITCH BOARD ON TABLE(UPS POWER): Supply, Installation, Testing and commissioning of modular switch board with all accessories of approved make on table including each set contain(2 No 5pin 6 Amp socket with separate switch each set contain(2 No 5pin 6 Amp socket with separate switch + 1 no 5 pin 6/16Amp socket with separate socket) with suitable size.	8		
	15A SWITCH SOCKET ON TABLE(RAW POWER): Supply, Installation, Testing and commissioning of switch board with all accessories of approved make on table/wall including each set contain (1No fuse 10Amp & 1 No indicator 10Amp + 1 each set contain (1No fuse 10Amp & 1 No indicator 10Amp + 1 no 5pin 16A socket with switch) with suitable size and wiring from the Main Panel to each point. Max two number point may be looped.	8		
	UPS INSTALLATION (METAL CLAD SOCKET & UPS WIRING) : Supply & Installation of Industrial type Metal Clad socket 32A TPN, Flush Type with MCB & socket of approved make for UPS.	4		
	AC INSTALLATION (MODULAR METAL CLAD SOCKET & AC WIRING CIRCUIT) : Supply & Installation of Industrial type modular Metal Clad socket 25A Flush Type with MCB & socket of approved make for AC concealed in the wall as per drawing and instructions.	4		
	DATA POINT: Supply, Installation, Testing and commissioning of RJ 45 modem Jack in modular IO box including patch cord of required length for Computer including making connection , soldering etc as required and as per drawing and instructions of the bank/Architect	7		

	DATA WIRING (FROM IT RACK TO DATA POINT AT TABLE): Supply, Installation, Testing and commissioning of Concealed Data wiring from Server to each computer with CAT-6 wire including supply of 25mm dia heavy duty PVC conduit of reputed make in floor/wall/ceiling as required. (from IT Rack to each computer)	400		
	EARTH STATION EACH: Supply, Installation, Testing & Commissioning of ground Earth Pit with 2'X2'x1/4" copper plate buried at a depth of 10' feet below with 2'X2'x1/4" copper plate buried at a depth of 10' feet below from the ground surface and 1"x8' long GI pipe with arrow socket, funnel 8 SWG copper wire in 1/2" GI pipe, nut & bolt etc and covering with 2" x12" heavy duty C.I earth cover including chambering and filling the boring area with charcoal and salt (40 Kgs each) as per IS 3043 specification including wiring from earthpit to the UPS & Panel and Earth Bus bar.(Earth resistance should not exceed 2 ohm at the earth terminal at UPS.	2		
	TOTAL			
	GRAND TOTAL			

