

**U C O   B A N K**

**ZONAL OFFICE -BHOPAL**

**TENDER DOCUMENT FOR  
INTERIOR WORK FOR  
BO: MALVIYA NAGAR  
BHOPAL**

**Tender issued to: .....**

.....

.....

**SEAL & SIGNATURE OF FIRM**

**UCO BANK- ZOANL OFFICE-BHOPAL**

**NOTICE OF INVITATION TO TENDER**

**SHORT TERM (TENDER NOTICE)**

REF. NO.

DATE: 01.06.2018

To

.....  
.....  
.....

Sub: Interior Works of Uco Bank, BO: MALVIYA NAGAR-BHOPAL.

Dear Sir,

Sealed tenders on item rate basis are invited for Interior Works of BO: MALVIYA NAGAR-BHOPAL. Tender Document may be purchased from UCO Bank, Zonal Office at Bhopal, against payment of Rs.Nil ;by way of DD favoring UCO Bank, Zonal office- Bhopal (non refundable).

Earnest Money: Rs. 20000.00 (by crossed demand draft payable at Bhopal  
& drawn in favor of **UCO Bank - Bhopal**.)

Time of Completion: 45 Days.

Time & Date of submission  
Of Tender : on or before 3.00 pm on **dated 11.06.2018**

Time & date of opening  
Of Tender : at 3.30 pm on **dated 11.06.2018**

The Bank reserves the right to accept or reject any or all the tenders without assigning any reason whatsoever.

Uco Bank  
Zonal Office,  
Bhopal.

**SEAL & SIGNATURE OF FIRM**

## FORM OF TENDER

To,  
The Chief Officer,  
UCO Bank,  
Zonal Office,  
Bhopal.

NAME OF WORK: Interior Works for UCO Bank BO: MALVIYA NAGAR-BHOPAL.

Sir,

1. Having visited the site and examined the drawings, conditions of contract, special conditions of contract, General specifications and detailed specifications, schedules and bill of quantities for the construction of the above named works, we offer to construct, complete and maintain the whole of the said works in conformity with the said drawings, conditions of contract, specifications, schedules and bill of quantities for the sum State in bill of quantities of this Tender Document or such other sum as may be ascertained in accordance with the said conditions of contract.
2. We undertake to complete and deliver the whole of the works comprised in the contract within the time State in the appendix hereto.
3. We have independently considered the amount of liquidated damages shown in the Appendix hereto and agree that it represents a fair estimate of the loss likely to be suffered, by you in the event of the works not being completed in time.
4. We agree to abide by this tender for the period of 90 days from opening of envelope 3 or extension thereof as required by the employer from the date fixed for receiving the same and it shall remain binding upon us and may be accepted at any time before the expiry of that period.
5. We confirm that the period and rates as referred in the agreement or general conditions of contract are given or summarized in the appendix hereto, to which we give our consent and agree to abide by the same.
6. If this tender is accepted, we undertake to enter into and execute at our cost, when called upon by the employer to do so, a contract agreement in the prescribed form. Unless and until a formal agreement is prepared and executed this tender together with your written acceptance thereof, shall constitute a binding contract between us.
7. We understand that if our tender is accepted, we are to be jointly and severally responsible for the due performance of the contract.
8. We understand that you are not bound to accept the Lowest or any tender you may receive and may reject all or any tender, accept or entrust the entire work to the contractor or divide the work to more than one contractor without assigning any reason or giving any explanation whatsoever.

**SEAL & SIGNATURE OF FIRM**

## **APPENDIX TO FORM OF TENDER**

Defects Liability period	12 Months from the date of virtual completion.
Date of commencement	07 days from the date of acceptance letter is issued to contractor or day on which the contractor is instructed to take possession of the site whichever is later.
Time of completion	45 Days from the date of commencement.
Period of Final Measurement	One month from the date of virtual completion
Liquidated damages	1% of the tendered amount shown in the tender per week subject to the ceiling of 10% of the accepted contracted sum.
Minimum value of work for interim certificate	5.00 Lacs (This value shall be the difference of work done of two consecutive bills).
Initial security deposit	2% of the accepted value of the tender including the earnest money to be deposited within 15 days after awarding of the contract.
Retention percentage	<p>(i) 10.00% on the first Rs. 1, 00,000.00 of the cost of the work. of the accepted tender amount.</p> <p>(ii) 7.5% on the next Rs. 1, 00,000.00 of the cost of work.</p> <p>(iii) 5% on the next amount upto Rs. 2 crores of the cost of work.</p> <p>(iv) 2% for the amount in excess of Rs. 2 crores of the cost of work subject to a ceiling on the Total Security Deposit at Rs, 25, 00,000.00.</p>
Refund of total security comprising of EMD, ISD and Retention	Total Security deposit will be released 14 days after the end of the defect liability period & upon receipt of “no defect certificate” from the branch.
Period of honoring Certificate	15 days from date of receipt of certificate from the Architect.

**SEAL & SIGNATURE OF FIRM**

## ARTICLES OF AGREEMENT

This agreement made this.....day of .....two thousand twelve between **UCO Bank**, a body corporate constituted under the Banking Companies (Acquisition & Transfer of Undertaking) Act 1970, having its Head Office at 10 B T M Sarani, Kolkata-700001 (herein after called "**The Employer**") of the ONE PART and **M/s** ..... herein after called "**The Contractor**" which includes it's heir/successors (herein after called "the Guarantor") of the OTHER PART.

WHEREAS the Employer is desirous of certain works should be executed viz. Interior Works for UCO Bank BO MALVIYA NAGAR-BHOPAL & has by letter of acceptance dated \_\_\_\_\_ accepted a tender by the contractor for the execution, completion, and maintenance of such works, now THIS AGREEMENT WITNESSES as follows :

4.1 In this agreement words & expressions shall have the same meaning as are respectively assigned to them in the said conditions of contract hereinafter referred to:

4.2 The following documents shall be deemed to form & to read construed as part of this agreement, viz.

i) Original tender document. ii) Relevant correspondence all letters/correspondence forming part of contract and referred to in acceptance letter. iii) Acceptance letter. iv) Bill of quantities. v) The drawings. vi) Time and progress chart. vii) Other additional documents as required,

a)

b)

c)

viii) Article of Agreement.

4.3 The aforesaid documents shall be taken as complementary and mutually explanatory of one another, but in the case of ambiguities of discrepancies the latest documents issued by the Bank shall prevail over on earlier documents.

4.4 In consideration of the payment to be made by the employer to the contractor as hereinafter mentioned, the contractor hereby covenants with the employer to perform execute, complete and maintain the work in conformity in all respects with the provision of the contract.

4.5 The employer hereby covenants to pay the contractor in consideration of the execution, completion and maintenance of the works such sums as shall become payable hereunder at the time(s) and in the manner prescribed in the said conditions and price schedule of quantities/bill of quantities prescribed in the contract.

IN WITNESS where of the parties here to have caused their respective common seals to be hereunto affixed (or have here un to set their respective hands and seals) the day, month and year first above written.

SIGNED AND SEALED AND DELIVERED BY THE

Said \_\_\_\_\_  
(Name \_\_\_\_\_)

on behalf of the contractor

In the presence of

Name: \_\_\_\_\_

Address: \_\_\_\_\_

\_\_\_\_\_

said \_\_\_\_\_  
(Name \_\_\_\_\_)

on behalf of the employer

In the presence of

Name: \_\_\_\_\_

Address: \_\_\_\_\_

\_\_\_\_\_

\* This form is included in the tender documents only for the information of the tenderers. Only the successful tenderer will be, in due course, required to complete the form.

**SEAL & SIGNATURE OF FIRM**

## S E C T I O N   I

### GENERAL RULES & INSTRUCTIONS FOR THE GUIDANCE OF TENDERERS

- 1.0 Tenders are hereby invited on behalf of **UCO BANK- Zonal Office- Bhopal** for the **Interior furnishing & electrification works of BO: MALVIYA NAGAR-BHOPAL**.
- 2.0 Contract documents consisting of the plans, complete specifications, the schedule of quantities of the various classes of work to be done and the set of conditions of contract to be complied with by the person/firm whose tenders may be accepted and which will also be found in the form of tenders, can be seen/purchased at the Chief Officer, UCO Bank, Zonal Office Bhopal between normal working hours of one day prior to the last day of submission of the tenders & except on Sundays & Bank holidays.
- The site for the work is available
- 3.0 Tenders, which should always be placed in sealed cover, with the name of the project written on the envelope will be received by **The Chief Manager**, up to **11<sup>TH</sup> June 2018** at 3.00P.M. & will be opened by him in his office on dated **11<sup>th</sup> June 2018** at 3.30 hrs.
- 4.0 In case of two part tenders, dates of submission opening of the tenders & the part thereof along with the superscription on the packages should be as per specific instruction on the tender notice/ form.
- 5.0 Tenders are to be on the prescribed form which can be obtained from the office of **The Chief Manager, UCO Bank, Zonal Office, Bhopal** on payment of a sum of Rs.Nil, in cash.
- 5.i The time allowed for the carrying out of the work will be 45 days from the date of commencement of the work.
- 6.0 The Contractors should quote in figures as well as in words the rate, & amount tendered by them. The amount for each item should be worked out & the requisite totals given.
- 7.0 While a contractor signs a tender in an Indian language the percentage above or below & tendered amount & the total amount tendered should also be written in the same language. In the case of illiterate contractors the rates or the amounts tendered should be attested by a witness.
- 8.0 Issue of tender form will be stopped one day before the date fixed for the opening of tenders.
- 9.0 Earnest money, amounting to **Rupees 20000.00( Rs. Twenty Thousand Only)**, in the form of Bank Draft drawn in favor of **"UCO Bank"Bhopal**, must accompany each tender and each tender is to be in a sealed cover super scribed "Tender for Interior Works for BO: MALVIYA NAGAR-BHOPAL at UCO Bank Building, and addressed to The Chief Manager, UCO Bank, Zonal Office, Bhopal, (M.P.)
- 10.0 The contractor, whose tender is accepted will be required to furnish by way of security deposit for the due fulfillment of his contract, such sum will amount:
- a) 10.00% on the first Rs. 1, 00,000.00 of the cost of the work. of the accepted tender amount.
  - b) 7.5% on the next Rs. 1, 00,000.00 of the cost of work.
  - c) 5% on the next amount upto Rs. 2 crores of the cost of work.
  - d) 2% for the amount in excess of Rs. 2 crores of the cost of work subject to a ceiling on the Total Security Deposit at Rs. 25, 00,000.00.

The Security Deposit shall be collected as detailed in clause no.10 of the General conditions of the contract.

The EMD of the contractor, whose tender is accepted, shall be fortified in full in case he does not remit the Initial Security Deposit within the stipulated period or start the work by the stipulated date mentioned in the award letter.

- 11.0 The acceptance of a tender will rest with the UCO Bank, The Bank reserves the right to accept or reject any or all the tenders received without the assignment of any reasons. All

**SEAL & SIGNATURE OF FIRM**

tenders in whom any of the prescribed conditions are not fulfilled or are incomplete in any respect are liable to be rejected.

The bank reserves the right to accept the tender in full or in parts and that the tenderer shall have no claim for revision of rates or other conditions if the tender is accepted in parts.

- 12.0 Canvassing in connection with tender is strictly prohibited and the tenders submitted by the contractor who resorts to canvassing will be liable to rejection.
- 13.0 All item rates shall be quoted on the proper form of the tender alone.
- 14.0 An item rate tender containing percentage below/above will be summarily rejected. However, where a tenderer voluntarily offers a rebate for payment within a stipulated period, this may be considered.
- 15.0 On acceptance of tender, the name of the accredited representative(s) of the contractor who would be responsible for taking instructions from the Employer/Architect shall be communicated to the Employer.
- 16.0 Special Care should be taken to write the rates in figures as well as in words & the amounts in figures only, in such a way that interpretation is not possible. The total amount should be written both in figures & in words. In case of figures, the words "Rs" should be written before the figure of rupees & words "P" after the decimal figures, e.g. Rs.2.15p. & in case of words, the word "Rupees" should precede & the word "Paisa" should be written at the end, unless the rate is in whole rupees & followed by the words "Only", it should invariably be up to two decimal places. While quoting the rates in schedule of quantities, the word "Only" should be written closely following the amount & it should not be written in the next line.
- 17.0 The bank does not bind itself to accept the lowest or any tender and reserves to itself the right of accepting the whole or any part of the tender and the tenderer shall be bound to perform the same at the rate quoted.
- 18.0 GST or any other tax like work contract tax etc. may be mentioned clearly either inclusive or exclusive in respect of this contract & the Bank will not entertain any claim apart from this whatsoever.
- 19.0 The contractor shall give a list of his relatives working with the bank along with their designations and addresses.
- 20.0 No employee of the Bank is allowed to work under or as a contractor for a period of two years after his retirement from Bank services, without the previous permission of the Bank. The contract is liable to be cancelled if either the contractor or any of his employees is found at any time to be such a person who had not obtained the permission of the Bank as aforesaid before submission of the tender or engagement in the contractor's service.
- 21.0 The tender for works shall remain open for acceptance for a period of 90 days from the date of opening of the tenders. If any tenderer withdraws his tender before the said period, then the bank shall be at liberty to forfeit Earnest Money paid along with the tender.
- 22.0 The tender for the work shall not be witnessed by a contractor or contractors who himself/themselves has/have tendered or who may and has/have tendered for the said work. Failure to observe this condition would render tenders of the contractors tendering as well as witnessing the tender liable to summary rejection.
- 23.0 It will be obligatory on the part of the tenderer to tender and sign the tender documents for all the component parts and that, after the work is awarded, he will have to enter in to an agreement, for each component with the competent authority in the bank.

The tenderer, apart from being a competent contractor must associate himself with the agencies of the appropriate class who are eligible for (i) Electrical (ii) Sanitary & water supply installations and (iii) Horticulture.

Signature of the Competent Authority,

UCO BANK, ZONAL OFFICE- BHOPAL.

**SEAL & SIGNATURE OF FIRM**

## SECTION II

### GENERAL CONDITIONS OF CONTRACT

Except where provided for in the description of the individual items in the Schedule of Quantities & in the specifications & conditions laid down hereinafter & in the drawings, the work shall be carried as per standard specifications & under the directions of the Employer/Architects.

#### 1. INTERPRETATION

In construing these conditions, the specifications, the schedule of quantities, tender & Agreement, the following words shall have the meaning herein assigned to them except where the subject of context otherwise requires :

- i) **Employer:** The term employer shall denote UCO Bank with their head office, at Kolkata, & any of its employees or representative authorized to act on their behalf.
- ii) **Architects/Consultants:** The term Architects shall mean M/s Rteriors-Bhopal or in the event of his/their ceasing to be the Architects for the purpose of this contract such other person/s as the Employer shall nominate for the purpose. The architect with the approval of the Bank may engage a local Architect/ Consulting Engineer for supervision & co-ordination of the work at the site. He will be considered a representative of the Architect. The Bank may also engage a Project Management Consultant for the supervision of the work. He will be designated by the term PMC & work as Employer's agent at the site.
- iii) **Contractor:** The term Contractor shall mean .....(name & address of the contractor) & his/their heirs, legal representatives assigns & successors.
- iv) **Site :** The site shall mean the site where the works are to be executed as shown within boundary on the Site Plan including any building & erections there on allotted by the Employer for the Contractor's use.
- v) **Site Engineer:** The Site Engineer shall be appointed by the Bank. The Bank may also determine the number of Site Engineers & the supporting staff at site office to assist them & also whether the Site Engineer shall be temporary or permanent. As far as possible, the Site Engineer should assume charge of his post before the Contractor reports on site of work. Where more than one Site Engineer is appointed, one of them shall be designated as senior Site Engineer by the Premises Department & the other Site Engineers shall be reporting to the Senior Site Engineer. Wherever PMC is engaged, Site Engineer, if any, will work in close co-ordination with PMC.
- vi) **Drawings :** The work is to be carried out in accordance with drawings, specifications, the schedule of quantities & any further drawings which may be supplied or any other instruction, which may be given by the employer during the execution of the work.

All the drawings relating to work given to the contractor together with a copy of schedule of quantities are to be kept at site & the Employer/Architects/PMC shall be given access to such drawings or schedule of quantities whenever necessary.

In case any detailed Drawings are necessary, contractor shall prepare such detailed drawings &/or dimensional sketches therefore & have it confirmed by the Employer/Architects/PMC as case may be prior to taking up such work.

The contractor shall ask in writing for all clarifications on matters occurring anywhere in drawings, specifications & schedule of quantities or to additional instructions at least 10 days ahead from the time when it is required for implementations so that the Employer may be able to give decision thereon.

- vii) "The works" shall mean the work or works to be executed or done under this contract.
- viii) "Act of Insolvency" shall mean any act as such as defined by the Presidency Towns Insolvency Act or in Provincial Insolvency Act or any Amending Statutes.
- ix) "The Schedule of Quantities" shall mean the schedule of quantities as specified & forming part of this contract.
- x) "Priced Schedule of Quantities" shall mean the schedule of quantities duly priced with the accepted quoted rates of the contractor.

**SEAL & SIGNATURE OF FIRM**



## **2. SCOPE**

The work consists of Interior Works UCO Bank BO: MALVIYA NAGAR-BHOPAL, under UCO Bank, Zonal Office, BHOPAL, in accordance with the "Drawings" & "Schedule of Quantities". The Interior works, related civil and electrical works etc. complete are within the scope of this tender. It includes furnishing all materials, labor, tools and equipment and management necessary for, and incidental to, the construction & completion of the work. All work, during its progress and upon completion shall confirm to the lines, elevations and grades as shown on the drawings furnished by the Employer/Architects. Should any detail essential for efficient completion of the work be omitted from the drawings & specifications it shall be the responsibility of the contractor to inform the Employer/Architects & to furnish & install such detail with Employer's / Architect's concurrence, so that upon completion of the proposed work the same will be acceptable and ready for use.

Employer or his agent (PMC) may in their absolute discretion issue further drawings and/or written instructions, details, directions and explanations, which are, hereafter collectively, referred to as "The Employer's / Architect's instructions" in regard to :

- a) The variation or modification of the design quality or quantity of works or the addition or omission or substitution of any work.
- b) Any discrepancy in the drawing or between the schedule of quantities and/or drawings and/or specifications.
- c) The removal from the site of any defective materials brought thereon by the contractor and the substitution of any other material thereof.
- d) The demolition/removal and/or re-execution of any work executed by the contractors.
- e) The dismissal from the work of any persons employed thereupon.
- f) The opening up for inspection of any work covered up.
- g) The rectification and making good of any defects under clauses hereinafter mentioned and those arising during the maintenance period (retention period).

The contractor shall forthwith comply with and duly execute any work comprised in such Employer's or his Agent/ Architect's instructions, provided always that verbal instructions, directions and explanations given to the contractor's or his representative upon the works by the Employer's or his Agent/ Architect's shall, if involving a variation, be confirmed in writing to the contractor/s within seven days. No works, for which rates are not specifically mentioned in the priced schedule of quantities, shall be taken up without written permission of the Employer's or his Agent/ Architect's. Rates of items not mentioned in the priced schedule of quantities shall be fixed by the employer in consultation with the Architects as provided in clause "variations".

Regarding all factory made products for which ISI marked products are available, only products bearing ISI marking shall be used in the work.

## **3. TENDERER SHALL VISIT THE SITE**

Intending Tenderer shall visit the site & make himself thoroughly acquainted with the local site conditions, nature and requirements of the works, facilities of transport conditions, effective labour and materials, accesses and storage for materials. The Tenderer shall provide in their tender for cost of carriage, freight and other charges as also for any special difficulties and including police restriction for transport etc. for proper execution of work as indicated in drawings. The successful Tenderer will not be entitled to any claim of compensation for difficulties faced or losses incurred on account of any site conditions which existed before the commencement of the work or which in the opinion of the Employer might be deemed to have reasonably been inferred to be so existing before commencement of work.

## **4. TENDERS**

The entire set of tender paper issued to the tenderer should be submitted fully priced and also signed on the last page together with initials on every page. Initials/Signature will indicate the acceptance of the tender papers by the tenderers.

(Also see para 16 of General Rules & Instructions for the Guidance of Tenderers).

**SEAL & SIGNATURE OF FIRM**

**The schedule of quantities shall be filled in as follows:**

- i) The "Rate" column to be legibly filled in ink in both English figures and English words.
- ii) Amount column to be filled in for each item and the amount for each subhead as detailed in the "Schedule of Quantities".
- iii) All corrections are to be initialed.
- iv) The "Rate Column" for alternative items shall be filled up.
- v) The "Amount" column for alternate items of which the quantities are not mentioned shall not be filled up.
- vi) In case of any errors/omissions in the quoted rates, the rates given in the tender marked "Original" shall be taken as correct rates.

No modifications, overwriting or corrections can be made in the tender papers by the tenderer, but he may at his option offer his comments or modifications in a separate sheet of paper attached to the original tender papers.

The employer reserves the right to reject the lowest or any tender and also to discharge any or all of the tenders for each section or to split up and distribute any item of work to any specialist firm or firms, without assigning any reason. The Bank reserves the right to accept the tender in full or in part and the tenderer shall have no claim for revision of rate or other conditions if his tender is accepted in parts.

The tenderers should note that the tender is strictly on the item rate basis and their attention is drawn to the fact that the rates for each and every item should be correct workable and self-supporting. If called upon by the Employer / Architects detailed analysis of any or all the rates shall be submitted by the contractor. The Employer / Architects shall not be bound to recognize the contractor's analysis.

The works will be paid for as "measured work" on the basis of actual work done and not as "lump sum" contract.

All items of work described in the schedule of quantities are to be deemed and paid as complete works in all respects and details including preparatory and finishing works involved directly related to and reasonably detectable from the drawings, specifications and schedule of quantities and no further extra charges will be allowed in this connection. In the case of lump sum charges in the tender in respect of any item of works, the payment of such items of work will be made for the actual work done on the basis of lump sum charges as will be assessed to be payable by the employer.

The employer has power to add to, omit from any works as shown in drawings or described in specifications or included in schedule of quantities and intimate the same in writing but no addition, omission or variation shall be made by the contractor without authorization from the Employer. No variation shall vitiate the contract.

The tenderer shall note that his tender shall remain open for consideration for a period of 90 days from the date of opening of the tender.

## **5. AGREEMENT**

The successful contractor may be required to sign agreement as may be drawn up to suit local conditions and shall pay for all stamps and legal expenses, incidental thereto.

## **6. GOVERNMENT AND LOCAL RULES**

The contractor shall conform to the provisions of all local By-laws and acts relating to the work and to the regulations etc. of the Government and local authorities and of any company with whose system the structure is proposed to be connected. The contractor shall give all notices required by said act, rules, regulations and Byelaws etc. and pay all fees payable to such authorities for execution of the work involved. The cost, if any, shall be deemed to have been included in his quoted rates, taking into account all liabilities for licenses, fees for footpath encroachment and restorations etc. He shall indemnify the employer against such liabilities and shall defend all actions arising from such claims or liabilities.

**SEAL & SIGNATURE OF FIRM**

## **7. TAXES AND DUTIES**

The tenderers must clearly mentioned in their tender prices quoted for all duties, royalties, cesses and GST, or any other taxes or local charges, if applicable **Extra or included**. However, work contract tax shall be deducted at source at the specific rate in Union legislative, if applicable. The certificate in respect of T.D.S. shall be issued by the Bank as per rate. No claim whatsoever on this account shall be entertained.

## **8. QUANTITY OF WORK TO BE EXECUTED**

The quantities shown in the schedule of quantities are intended to cover the entire new structure indicated in the drawings but the Employer reserves the right to execute only a part or the whole or any excess thereof without assigning any reason therefore. Variations in the value is however not expected to be more than  $\pm 25\%$ .

## **9. OTHER PERSONS ENGAGED BY THE EMPLOYER**

The employer reserves the right to execute any part of the work included in this contract or any work which is not included in this contract by other agency or persons and contractor shall allow all reasonable facilities and use of his scaffolding for the execution of such work. The main contractor shall extend all co-operations in this regard.

## **10. EARNEST MONEY AND SECURITY DEPOSIT**

The tenderer will have to deposit an amount of **Rs.20000.00 (Twenty Thousand Only)** in the form of Bank draft drawn in favor of “**UCO Bank, Bhopal.**” at the time of submission of tender as an Earnest Money. The employer is not liable to pay any interest on the Earnest Money. The Earnest Money of the unsuccessful tenderers will be refunded without any interest soon after the decision to award the work is taken or after the expiry of the validity period of the tender.

The successful tenderer to whom the contract is awarded will have to deposit an initial security deposit, a further sum to make up 2% of the value of the accepted tender including the Earnest Money. The initial Security Deposit will have to be made by the contractor to the bank within 14 days of acceptance of award letter, failing which the employer at his discretion may revoke the letter of acceptance and forfeit the earnest money deposit furnished along with the tender. The initial security deposit shall be accepted in the form of Demand draft and not by Bank Guarantee. Apart from the initial security deposit made as above, retention money shall be deducted from the progressive running bills @ 8% of the gross value of each running bill until the Total Security Deposit plus the retention money equals.

- a) 10.00% on the first Rs. 1, 00,000.00 of the cost of the work. of the accepted tender amount.
- b) 7.5% on the next Rs. 1, 00,000.00 of the cost of work.
- c) 5% on the next amount up to Rs. 2 crores of the cost of work.
- d) 2% for the amount in excess of Rs. 2 crores of the cost of work subject to a ceiling on the Total Security Deposit at Rs. 25, 00,000.00.

**The Retention Amount 50% of it shall be refunded to the contractor on completion subject to the following:**

- i) **Issue of Virtual Completion Certificate by the Architect/ Premises Dept.**
- ii) **Contractor's removal of his materials, equipment, labour force etc. from the site ( excepting for a small presence required if any for the defect liability period & approved by the Bank.**

The remaining 50% of the amount may be refunded to the contractor fourteen days after the defect liability period, provided the contractor has satisfactorily carried out all the works and attended to all the defects in accordance with the conditions of contract including site clearance. No interest is allowed on Retention Money.

## **11. CONTRACTORS TO PROVIDE EVERYTHING NECESSARY**

The contractor shall provide everything necessary for the proper execution of the work according to the intent and meaning of the drawings, schedule of quantities and specifications taken together whether the same may or may not be particularly shown or described therein provided

**SEAL & SIGNATURE OF FIRM**

that the same can reasonably be inferred there from & if the contractor finds any discrepancies therein, he shall immediately & in writing refer the same to the Employer / Architect/ PMC whose decision shall be final and binding. The contractor shall provide him self for ground & fresh water for carrying out of the works at hi own cost. The Employer shall on no account be responsible for the expenses incurred by the contractor for hired ground or fresh water obtained from else where.

The rates quoted against individual items will be inclusive of everything necessary to complete the said items of work within the contemplation of the contract and beyond the unit price. No extra payments will be allowed for incidental or contingent work, labor and/or materials inclusive of all taxes and duties whatsoever except for specific taxes, if any, stipulated in the tender documents.

The contractor shall supply, fix and maintain at his own cost for the execution of any work, all tools tackles, machinery and equipment's and all the necessary scaffolding, , watching and lighting by night as well as by day required not only for the proper execution and protection of the said work but also for the protection of the public and safety of any adjacent roads, streets, walls, houses, buildings, all other erections, matters and things and the contractor shall take down and remove any or all such scaffolding, etc. as occasion shall be required or when ordered to do so and shall fully reinstate and make good all matters and things distributed during the execution of works to the satisfaction of the Employer/Architect.

The Contractor shall at all times give access to workers employer by the Architect / Employer or any men employed on the buildings and to provide such parties with proper sufficient and if required special scaffolding, hoists and ladders and provide them with water and lighting and leave or make any holes, grooves etc. in any work where directed by the employer as may be required to enable such workmen to lay or fix pipes, electrical wiring, special fittings etc. The quoted rates of the tenders shall accordingly include all these above mentioned contingent works.

## **12. TIME OF COMPLETION, EXTENSION OF TIME & PROGRESS CHART**

1. **Time of completion:** The entire work is to be completed in all respects within the stipulated period. The work shall deem to be commenced within seven days from the date of acceptance letter issued to the contractor or the day on which contractor is instructed to take possession of site, whichever is latter. Time is the essence of the contract and shall be strictly observed by the contractor.

The work shall not be considered as completed until the Employer have certified in writing that work has been completed and the defects liability period shall commence from the date of such certificate.

2. **Extension of Time :** If, in the opinion of the Employer/Architect/ PMC the works be delayed,(a) By reason of any exceptionally inclement weather, or (b) by reason of instruction from the employer in consequence of proceedings taken of threatened by or disputes, with adjoining or neighboring owners or (c) by the works, or delay, of other contractors or tradesmen engaged or nominated by the Employer and not referred to in the specification or (d) By reason of authorized extra and additions or (e) By reason of any combination of workmen or strikes or lockout effecting any of the building trades or (f) From other causes which the employer may consider are beyond the control of the contractor, the Employer at the completion of the time allowed for the contract shall make fair and reasonable extension of the time for completion in respect therefore. In the event of the Employer failing to give possession of the site upon the day specified above the time of completion shall be extended suitably.

In case of such strikes or lockouts, as are referred to above, the contractor shall immediately give the employer, written notice thereof. Nevertheless, the contractor shall use his best endeavors all that to prevent delay, and shall do all that may be reasonably required, to the satisfaction of the employer to proceed with the works and on his doing so that it will be ground of consideration by the employer for an extension of time as above provided. The decision of the Employer as to the period to the allowed for an extension of time for completion hereunder (which decision shall be final and binding on the contractor) shall be promulgated at the conclusion of such strike or lockout and the employer shall then, in the event of an extension being granted, determine and declare the final completion date. The provision in clause 13, with respect to payment of liquidated damages shall, in such case, be read and construed as if the extended date fixed by the employer were substituted for and the damage shall be deducted accordingly.

**SEAL & SIGNATURE OF FIRM**

**3. Progress of work :** During the period of construction the contractor shall maintain proportionate progress on the basis of a programmed chart submitted by the contractor immediately before commencement of work and agreed to by the employer/Architect. Contractor should also include planning for procurement for scarce material well in advance and reflect the same in the programmed chart so that there is no delay in completion of the project.

### **13. LIQUIDATED DAMAGES**

Should the work be not completed to the satisfaction of the Employer/Architect within the stipulated period, the contractor shall be bound to pay to the employer a sum calculated as given below by way of liquidated damages and not as penalty during which the work remains un commenced or unfinished after the expiry of the completion date.

a)	For contracts having time for completion 6 months & Less.	1.00% of the estimated amount shown in the tender per week subject to a ceiling of 10% of the accepted contracted sum.
b)	For contracts having time for completion exceeding 6 months but not exceeding 24 months.	0.5% of the estimated amount shown in the tender per week subject to a ceiling of 7.5% of the accepted contracted sum but not exceeding the total S.D. of the contract.
c)	For contracts having time for completion in excess of 2 years (24 months).	0.25% of the estimated amount shown in the tender per week subject to a ceiling of 5% of the accepted contracted sum but not exceeding the total S.D. of the contract.

### **14. TOOLS, STORAGE OF MATERIALS, PROTECTIVE WORKS & SITE OFFICE REQUIREMENTS**

The contractor shall provide, fix up and maintain in an approved position proper office accommodation for the contractor's representative and staff, which offices shall be open at all reasonable hours to receive instruction, notices or communication and clear away on completion of the work and make good all work disturbed.

All drawings maintained on the site are to be carefully mounted on boards of appropriate size and covered with a coat of approved varnish. They are to be protected from ravages of termites, ants and other insects.

The contractor shall provide at site at his own cost all artificial light required for the work and to enable other contractors and subcontractors to complete the work within the specified time.

The Contractor shall provide a suitable temporary hut for the watchmen and clear away the same when no longer required and to provide all necessary attendants, lights etc. required.

The contractor shall arrange for temporary latrines for the use of workers and field staff and keep the same in a clean sanitary condition to the satisfaction of the Public Health Authorities and shall cause such latrines and soil to be cleared away whenever necessary and shall make good all the works disturbed by these conveniences.

Every precaution shall be taken by the contractor to prevent the breeding of mosquitoes on the works during the construction and all receptacles, cisterns, water tanks etc. used for the storage of water must be suitably protected against breeding of mosquitoes. The contractor shall indemnify the employer against any breach of rules in respect of anti-malarial measures.

The contractor shall not fix or place any placards or advertisement of any description or permit the same to be fixed or placed in or upon any boarding, gantry, building structure other than those approved by the Employer.

#### **Protective Measures**

The contractor from the time of being placed in possession of the site must make suitable arrangements for watching, lighting and, protecting the work, the site and surrounding property by day, by night, on all days including Sundays and other holidays.

**SEAL & SIGNATURE OF FIRM**

Contractor shall indemnify the employer against any possible damage to the building, roads, or member of the public in course of execution of the work.

The contractor shall provide necessary temporary enclosures, gates, entrance etc. for the protection of the work and materials and for altering and adopting the same as may be required and removing on completion of the works and making good all works disturbed.

#### **Storage of materials**

The contractor shall provide and maintain proper sheds for the proper storage and adequate protection of the materials etc., and other work that may be executed on the site including the tools and materials of subcontractors and remove same on completion.

#### **Tools**

All instruments like steel tape etc. which is found necessary for the works shall be provided by the contractor for due performance of the contract.

All measuring tapes shall be of steel and suitable scaffolding and ladders that may be require for safety taking measurements and shall be supplied by the contractor.

The Mistree's and the supervisors on the works shall carry with them always a one meter or two meter steel tapes, a measuring tape of 30 meters, a spirit level, a plumb bob and a square and shall check the work to see that work is being done according to the drawings and specifications. The site engineer will use any or all measuring instruments or tools belonging to the contractor as he chooses for checking the works executed or being executed on the contract.

The contractor should cover in his rates for making provisions for all reasonable facilities for the use of his scaffolding, tools and plants etc. by subcontractors for their work.

#### **15. NOTICE AND PATENTS OF APPROPRIATE AUTHORITY AND OWNERS**

The Contractor shall confirm to the provisions or any acts of the legislature relating to the work, and to the regulations and By-Laws of any authorities, and / or any water, lighting and other companies, and / or authorities with whose system the structures were proposed to have constructed and shall before making any variation from the drawings or specifications that may be associated to so confirm, give the Employer/Architects written notice, specify the variations proposed to be made and the reasons for making them and apply for instructions thereon. the Employer on receipt of such intimation shall give a decision with a reasonable time.

The Contractors shall arrange to give all notices required for by the said acts, regulations or By-laws to be given to any authority, and to pay to such authority or to any public officer all fees that may be properly chargeable in respect of the work and lodge the receipts with the Employer

The contractor shall indemnify the employer against all claims in respect of patent rights, royalties, damages to buildings, roads or member of public in course of execution of work and shall defend all actions arising from such claims and shall keep the employer saved harmless and indemnified in all respects from such actions, costs and expenses.

#### **16. CLEARING SITE AND SETTING OUT WORKS**

The contractor shall set out the works and shall be responsible for the true and perfect setting out of the work and for the correctness of the positions, levels, dimensions and alignment of all parts thereof. If at any time, any error shall appear during the progress of any parts of the works the contractor shall at his own expenses rectify such error, if called upon to the satisfaction of the employer. The contractor shall further set out the work to the alternative positions at the site until one is finally approved and the rates quoted in his tender should include for this and no extra on this account will be entertained.

#### **17. ACCESS**

Any authorized representative of the Employer/Architect shall at all reasonable times have free access to the works and/or to the workshops, factories or other places where materials are being prepared or constructed for the work and also to any place where the materials are lying or from where they are being obtained, and the contractor shall give every facility to the bank or their representatives necessary for inspection and examination and test of the materials and workmanship. Except the representatives of the Employer, no person shall be allowed at any time without the written permission of the Employer.

**SEAL & SIGNATURE OF FIRM**

## **18. MATERIALS, WORKMANSHIP, SAMPLES, TESTING OF MATERIALS**

All the works specified and provided for in the specifications or which may be required to be done in order to perform and complete any part thereof shall be executed in the best and most workman like manner with materials of the best and approved quality of the respective kinds in accordance with the particulars contained in and implied by the specifications and as represented by the drawings or according to such other additional particulars and instructions as may from time to time be given by the Employer/Architect during the execution of the work, and to his entire satisfaction.

If required by the Employer/Architect the contractor shall have to carry out tests on materials and workmanship in approved materials testing laboratories or as prescribed by the employer at his own cost to prove that the materials etc. under test confirming to the relevant IS standards or as specified in the specifications. The necessary charges for preparation of mould, (in case of concrete cube), transporting, testing etc. shall have to be borne by the contractor. No extra payment on this account would in any case be entertained.

All the materials (except where otherwise described) stores and equipment required for the full performance of the work under the contract must be provided through normal channels and must include charge for import duties, sales taxes, octroi and other charges and must be the best of their kind available and contractor/s must be entirely responsible for the proper and efficient carrying out of the work. The work must be done in the best workman like manner. Samples of all materials to be used must be submitted to the Employer/Architect when so directed by the Engineer/Architects and written approval from Employer/Architect must be obtained prior to placement of order. The approved samples shall be kept with the Employer till the completion of work.

Should the work be suspended by reason of rain, strike, lockouts or any other cause, the contractor shall take all precautions necessary for the protection of work and at his own expenses shall make good any damage arising from any of these causes.

The contractor shall cover up and protect from damage, from any cause, all new work and supply all temporary doors, protection to windows, and any other requisite protection for the execution of the work whether by himself or special tradesmen or subcontractor and any damage caused must be made good by the contractor at his own expenses.

## **19. REMOVAL OF IMPROPER WORK**

The Employer shall during the progress of the work have power to order in writing from time to time the removal from the work within such reasonable time or times as may be specified in the order of any materials which in the opinion of the Employer/Architect are not in accordance with specification or instructions, the substitution or proper re-execution of any work executed with materials or workmanship not in accordance with the drawings and specifications or instructions. In case the contractor refuses to comply with the order the employer shall have the power to employ and pay other agencies to carry out the work and all expenses consequent thereon or incidental there to as certified by the employer shall be borne by the contractor or may be deducted from any money due to or that may become due to the contractor. No certificate which may be given by the Architects shall relieve the contractor from his liability in respect of unsound work or bad materials.

## **20. SITE ENGINEER / PROJECT MANAGEMENT CONSULTANT**

The term, "Site Engineer / PMC" shall mean the person / agencies appointed & paid by the Employer to superintend the work. The contractor shall afford the Site Engineer /PMC every facility and assistance for examining the works and materials for checking and measuring work and materials. The Site Engineer/PMC shall have no power to revoke, alter, enlarge or relax any requirements of the contractor or to sanction any day work, additions, alterations, deviations, or omissions or any extra work whatever, except in so far as such authority may be specially conferred by a written order of the Employer.

The Site Engineer/PMC shall have power to give notice to the contractor or to his foreman of non approval of any work or materials and such work shall be suspended or the use of such materials shall be discontinued until the decision of the employer is obtained. The work will from time to time be examined by the Architects, Engineer from the premises department of the Employer and the Site Engineer if any. But such examination shall not in any way exonerate the contractor from

**SEAL & SIGNATURE OF FIRM**

the obligation to remedy defects which maybe found to exist at any stage of the work or after the same is complete ,Subject to the limitations of this clause the contractor shall take instructions only from the Architects/Employer or his representative.

## **21. CONTRACTOR'S EMPLOYEES**

The Contractor shall employ technically qualified and competent supervisors for the work who shall be available (by turn) through out the working hours to receive and comply with instructions of the Employer/Architects. The contractor shall engage at least one experienced Engineer as site-in-charge for execution of the work. The contractor shall employ in connections with the work persons having the appropriate skill or ability to perform their job efficiently.

The contractor shall employ local laborers on the work as far as possible.

No laborers below the age of sixteen years and who is not an Indian National shall be employed on the work.

Any laborer supplied by the contractor to be engaged on the work on day work basis either wholly or partly under the direct order or control of the Employer or his representative shall be deemed to be a person employed by the contractor.

The contractor shall comply with the provisions of all labour legislation's including the requirements of:

- a) The payment of Wages Act.
- b) Employer's Liability Act.
- c) Workmen's Compensation Act.
- d) Contractor Labor (Regulation & Abolition) Act, 1970 and Central Rules 1974.
- e) Apprentices Act 1961.
- f) Any other Act or enactment relating thereto and rules framed there under from time to time.

The contractor shall keep the Employer saved, harmless and indemnified against claims if any of the workmen or any other person and all costs and expenses as any be incurred by the Employer in connection with any claim that may be made by any workman or any other person.

The contractor shall comply at his own cost with the order of requirement of any Health Officer of the state or any local authority or of the Employer regarding the maintenance of proper environmental sanitation of the area where the contractor's laborers are housed or accommodated, for the prevention of small pox, cholera, plague, typhoid, malaria and other contagious diseases. The contractor shall provide maintain and keep in good sanitary condition adequate sanitary accommodation and provide facilities for pure drinking water at all times for the use of men engaged on the works and shall remove and clear away the same on completion of the works. Adequate precautions shall be taken by the contractor to prevent nuisance of any kind on the works or the lands adjoining the same.

The contractor shall arrange to provide first aid treatment to the laborers engaged on the works. He shall within 24 hours of the occurrence of any accident at or about the site or in connection with execution of the works, report such accident to the employer and also to the competent authority where such report is required by law.

## **22. DISMISSAL OF WORKMEN**

The contractor shall on the request of the employer immediately dismiss from works any person employed thereon by him who may in the opinion of the employer be unsuitable or incompetent or who may misconduct himself. Such discharges shall not be the basis of claim for compensation or damages against the Employer or any of their officers or employee.

## **23. ASSIGNMENT**

The whole of the works included in the contract shall be executed by the contractor and the contractor shall not directly or indirectly transfer, assign or underlet the contract or any part, share or interest therein nor, shall take a new partner without written consent of the employer and no subletting shall relieve the contractor from the full and entire responsibility of the contract or from active superintendence of the work during their progress.

**SEAL & SIGNATURE OF FIRM**



#### **24. DAMAGE TO PERSONS AND PROPERTY INSURANCE ETC.**

The contractor shall be responsible for all injury to the worker or workmen or persons, or things and for all damages to the project works, materials, equipments, structural and/or decorative part of property which may arise from the operations or neglect of himself or of any subcontractor or any of his or a subcontractor's employees whether such injury or damage arise from carelessness, accident or any other cause whatsoever in any way connected with the carrying out of this contract. The clause shall be held to include inter alia any damage to buildings whether immediately adjacent or otherwise and any damage to roads, streets, foot paths or ways as well as damages caused to the buildings and the works forming the subject of this contract by rain, wind or other inclemency of the weather. The contractor shall indemnify the employer and hold harmless in respect of all and any expenses arising from any such injury or damages to persons or property as aforesaid and also in respect of any claim made in respect of injury or damage under any acts of compensation or damage consequent upon such claim.

The contractor shall re-instate, rectify and remedy all damages of every sort mentioned in this clause so as to deliver the whole of the contract works complete and perfect in every respect and so as to make good or otherwise satisfy all claims for damages to the property or third parties.

The contractor shall affect the insurance necessary and indemnify the employer entirely from all responsibility in this respect. The insurance must be placed with company approved by the employer and must be effected jointly in the name of the contractor and the employer and the policy lodged with the latter. The scope of insurance is to include damage or loss to the contract itself till this is made over in a complete state. Insurance is compulsory and must be affected for the very initial stage. The contractor shall also be responsible for anything which may be excluded from the damage to any property arising out of incidents, negligence or defective carrying out of this contract.

The employer shall be at liberty and hereby empowered to deduct the amount of any damages, compensations, costs, charges and expenses arising or accruing from or in respect of any such claim or damages from any sums including the total security deposit due or to become due to the contractor.

#### **25. INSURANCE**

Unless otherwise instructed the contractor shall insure the works for all risk (include fire, flood, earthquake & third party) of the contractor for total tender value and keep them insured until the virtual completion of the contract against any loss or damage of the material and of the project. The insurance must be placed with a company approved by the Employer in the joint names of the Employer and the contractor for such amount and for any further sum if called to do so by the Employer. Further the premium of such sum being allowed, to the contractor, as an "authorized extra".

The contractor shall deposit the policy and receipt premium paid with the Employer within 21 (twenty one) days from the date of issue of work order unless otherwise instructed. In default of the contractor insuring as provided above the Employer on his behalf may so insure and may deduct the premiums paid from any money due, or which may become due to the contractor. The contractor shall as soon as the claim under the policy is settled or the work reinstate by Insurance Company should they elect to do so, proceed with due diligence with the completion of the works in the same manner as though the fire has not occurred and in all respects under the conditions of the contract. The Contractor in case of rebuilding or rein-statement after fire shall be entitled to extension of time for completion as the Employer may deem fit.

#### **26. ACCOUNTS RECEIPT & VOUCHERS**

The contractor shall, upon the request of the employer furnish them with all the invoices, accounts, receipts and other vouchers that they may require in connection with the works under this contract. If the contractor shall use materials less than what he is required under the contract, the value of the difference in the quantity of the materials he was required to use and that he actually used shall be deducted from his dues. The decision of the employer shall be final and binding on the contractor as to the amount of materials. The contractor is required to use for any work under this contract.

#### **27.**

**SEAL & SIGNATURE OF FIRM**

Before taking any measurement of any work the site Engineer or a subordinate deputed by him shall give reasonable notice to the contractor. If the contractor fails to attend at the measurements after such notice or fails to countersign or to record the difference within a week from the date of measurement in the manner required by the Site Engineer then in any such event the measurements taken by the Site Engineer or by the subordinate deputed by him as the case may be is final and binding on the contractor and the contractor shall have no right to dispute the same.

## **28. PAYMENTS**

All Bills shall be prepared by the contractor in the form prescribed by the Employer/ Architects. Normally one interim bill shall be prepared each month subject to minimum value for interim certificate as dated in these documents. The bills in proper forms must be duly accompanied by detailed measurements in support of the quantities of work done & must show deductions from all previous payments, retention money, etc.

The Employer / Architect shall issue a certificate after the due scrutiny of the contractor's bill stating the amount due to the contractor from the Employer & the contractor shall be entitled to payment thereof, within the period of honoring the certificates named in these documents. In case of delay due to some reasons in the processing of such bills for payment, an adhoc advance of 75% of the billed amount may be paid on the request of the contractor for the smooth progress of work.

The amount state in the interim certificate shall be the total value of work properly executed & 7% of the invoice value of material brought to site for permanent incorporation into the work up to the date of the bills less the amount to be retained by the employer as retention money vide clause 10 of these conditions & less installments previously paid under these conditions, provided that such certificates shall only include the value of said material & goods as & from such time as they are reasonably, properly & not prematurely brought to or placed adjacent to the work & then only if adequately protected against the weather or other casualties.

The Employer will deduct retention money as described in clause 10 of these conditions. The refund of retention money will be made as specified in the said clause.

If the Employer has supplied any materials or goods to the contractor, the cost of any such materials or goods will be progressively deducted from the amount due to the contractor in accordance with the quantities consumed in the work.

All interim payments shall be regarded as payments by way of advance against the final payment only & not as payments for the work actually done & completed, & shall not preclude the requiring of bad, unsound & imperfect or unskilled work to be removed & taken away & reconstructed, or re-erected or be considered as an admission of the due performance of the contract, or any part thereof in any respect or the accruing of any claim, nor shall, it conclude, determine or affect in any way the power of the Employer under these conditions or any of them as to the final settlement & adjustment of the accounts or otherwise or in any other way vary or affect the contract. The final Bill shall be submitted by the contractor within one month of the date fixed for completion of the work or of the date of certificate of completion furnished by the site Engineer & payment shall be made within three months.

## **29. FINAL PAYMENTS**

The final bill shall be accompanied by a certificate of completion from the Employer/ Architect. Payments of final bill shall be made after deduction of Retention Money as specified in clause 10 of these conditions, which sum shall be refunded after the completion of the Defects Liability Period after receiving the Employer's / Architect's certificate that the contractor has rectified all defects to the satisfaction of the Employer / Architects. The acceptance of payments of the final bill by the contractor would indicate that he will have no further claim in respect of the work executed.

## **30. VARIATION/DEVIATIONS**

The price of all such additional items/ non tendered items will be worked out on the basis of rates quoted for similar items in the contract wherever existing or an engineering rate analysis based on prevalent fair price of labor, material & other components as required. The tender rates shall hold good for any increase or decrease in the tendered quantities up to variations of 25%. For variations beyond 25%, the rates for the respective items may be reviewed on mutually agreed terms.

## **31. SUBSTITUTION**

**SEAL & SIGNATURE OF FIRM**

Should the contractor desire to substitute any materials and workmanship, he/they must obtain the approval of the Architect/Employer in writing for any such substitution well in advance. Materials designated in this specification indefinitely by such terms as "Equal" or "other approved" etc., specific approval of the Employer/Architect has to be obtained in writing.

### **32. PREPARATION OF BUILDING WORKS FOR OCCUPATION AND USE ON COMPLETION**

The whole of the work will be thoroughly inspected by the contractor and deficiencies and defects put right. On completion of such inspection the contractor shall inform the employer that he has completed the work and it is ready for inspection.

On completion, the contractor shall clean all windows and doors including the cleaning and oiling, if necessary, of all hardware, inside and outside, all floors, staircases, and every part of the building. He will leave the entire building neat and clean and ready for immediate occupation and to the satisfaction of the Bank.

### **33. CLEARING SITE ON COMPLETION**

On completion of the works, the contractor shall clear away and remove from the site all constructional plant, surplus materials, rubbish and temporary works of every kind and leave the whole of the site and the works clean and in a workmanlike condition to the satisfaction of the Employer / Architects.

The contractor shall make good at his own cost and to the satisfaction of the Employer all defects, shrinkages or other faults which may appear within 6 months after completion of the work. In default, the employer may employ and pay other persons to amend and make good such damages, losses and expenses consequent thereon or incidental thereto shall be made good and borne by the contractor and such damages, losses and expenses shall be recoverable from him by the employer or may be deducted by the employer, in lieu of such amending and making good by the contractor, deduct from any money due to the contractor a sum equivalent to the cost of amending such work and in the event of the amount retained being insufficient, recover that balance from the contractor from the amount retained under clause No. 10 together with any expenses the Employer may have incurred in connection therewith.

### **34. CONCEALED WORK**

The contractor shall give due notice to the Employer / Architects whenever any work is to be buried in the earth, concrete or in the bodies of walls or otherwise becoming inaccessible later on, in order that the work may be inspected and correct dimensions taken before such burial, in default whereof the same shall, at the option of the Employer/Architect be either opened up for measurement at the contractor's expense or no payment may be made for such materials. Should any dispute or differences arise after the execution of any work as to measurements etc., or other matters which cannot be conveniently tested or checked, the notes of the Employer / Architect shall be accepted as correct and binding on the contractor.

### **35. ESCALATION**

The rates quoted shall be firm throughout the tenure of the contract (including extension of time, if any, granted)& will not be subject to any fluctuation due to increase in cost of materials, labor, sales tax, octroi, etc. unless specifically provided in these documents.

The price variation clause being adopted by the RBI may be followed, if such a situation arises on a case to case basis.

Further in case of variation in the wages of labor due to statutory enactments like the revision of the Minimum Wages Act by more than 10%, the increase in actual cost due to implementation of the statutory provision based on the number & category of labor actually borne on the Muster during the period under consideration may also be considered, if provided in the tender.

### **36. IDLE LABOUR**

Whatever the reasons may be no claim for idle labor, additional establishment cost of hire and labor charges of tools and plants would be entertained under any circumstances.

### **37. SUSPENSIONS**

If the contractor, except on account of any legal restraint upon the Employer preventing the continuance of the work, abandons, suspends work or in the opinion of the Employer, the

**SEAL & SIGNATURE OF FIRM**

contractor neglects or fails to proceed with due diligence in the performance of his part of the contract, the Employer shall have the power to give notice in writing to the contractor requiring the work be proceeded within a reasonable manner and with reasonable dispatch, such notices purport to be a notice under this clause.

After such notice shall have been given the contractor shall not be at liberty to remove from the site of the works or from any ground contiguous thereto any plant or materials to subsist from the date of such notice being given until the notice shall have been complied with. If the contractor shall fail for 7 (seven) days after such notice has been given to proceed with the works as therein prescribed, the Employer may proceed as provided in clauses 38 (Termination of contract by Employer).

### **38. TERMINATION OF CONTRACT BY EMPLOYER**

If the contractor being a company go into liquidation whether voluntary or compulsory or being a firm shall be dissolved or being an individual shall be adjudicated insolvent or shall make an assignment or a composition for the benefit of the greater part, in numbers or amount of his creditors or shall enters into a Deed or arrangement with his creditors or if the official assignee in insolvency of the receiver of the contractor in insolvency, shall repudiate the contract, or if a receiver of the contractor's appointed by court shall be unable, within fourteen days after notice to him requiring him to do so, to show to the reasonable satisfaction of the Employer that he is able to carry out and fulfill the contract, and if so required by the employer to give reasonable security therefore, or if the contractor shall suffer execution to be issued, or shall suffer any payment under this contract to be attached by or on behalf of and the creditors of the contractor, or shall assign charge or encumber this contract or any payments due or which may become due to the contractor there under, or shall neglect or fail to observe and perform all or any of the acts matters of things by this contract to be observed and performed by the contractor within three clear days after the notice shall have been given to the contractor in manner hereinafter mentioned requiring the contractor to observe or perform the same or shall use improper materials or workmanship in carrying on the works, or shall in the opinion of the employer not exercised such due diligence and make such due progress as would enable the work to be completed within due time agreed upon, and shall fail to proceed to the satisfaction of the employer after three clear days notice requiring the contractor so to do shall have been given to the contractor as hereinafter mentioned, or shall abandon the contract, then and in any of the said cases, the bank may notwithstanding previous waiver determine the contract by a notice in writing to the effect as hereinafter mentioned, but without thereby effecting the powers of the employer of the obligations and liabilities of the contractor the whole of which shall continue in force as fully as if the contract, had not been so determined and as if the works subsequently executed had been executed by or on behalf of the contractor (without thereby creating any trust in favor of the contractor). Further the employer or his agent, or servants, may enter upon and take possession of the work and all plants, tools, scaffolding, sheds, machinery, steam and other power utensils and materials lying upon premises or the adjoining lands or roads and sell the same as his own property or may employ the same by means of his own servants and workmen in carrying on and completing the works or by employing any other contractors or other persons or person to complete the works and the contractor shall not in any way interrupt or do any act, matter of thing to prevent or hinder such other contractors or other persons or person employed from completing and finishing or using the materials and plants for the works when the works shall be completed, or as soon thereafter as conveniently may be, the employer shall give notice in writing to the contractor to remove his surplus materials and plants and should the contractor fail to do so within a period of fourteen days after receipt by him. The employer may sell the same by Public Auction and shall give credit to the contractor for the amount so released. Any expenses or losses incurred by the employer in getting the works carried out by other contractors shall be adjusted against the amount payable to the contractor by way of selling his tools and plants or due on account of work carried out by the contractor prior to engaging other contractors or against the Security Deposit.

### **39. ARBITRATION**

All disputes or differences of any kind whatsoever which shall at any time arise between the parties hereto touching or concerning the works or the execution or maintenance thereof of this contract or the rights touching or concerning the works or the execution of maintenance thereof of this contract or the construction remaining operation or effect thereof or to the rights or

**SEAL & SIGNATURE OF FIRM**

liabilities of the parties or arising out of or in relation thereto whether during or after determination for closure or Breach of the contract (other than those in respect of which the decision of any person is by the contract expressed to the final and binding) shall after written notice by either party to the contract to the other of them and to the Employer hereinafter mentioned be referred for adjudication to a sole arbitrator to be appointed as hereinafter provided.

For the purpose of appointing the sole Arbitrator referred to above, the employer will send within thirty days of receipt of the notice, to the contractor a panel of three names of persons who shall be presently unconnected with the Organization for which the work is executed.

The Contractor shall on receipt of the names as aforesaid, select any one of the persons named to be appointed as a sole Arbitrator and communicate his name to the employer within thirty days of receipt of the names. The employer shall thereupon without any delay appoint the said person as the Sole Arbitrator. If the contractor fails to communicate such selection as provided above within the period specified, the component authority shall make the selection and appoint the selected person as the Sole Arbitrator.

If the Employer fails to send to the contractor the panel of three names as aforesaid within the period specified, the contractor shall send to the employer a panel of three names of persons who shall all be unconnected with either party. The Employer shall on receipt of the names as aforesaid select any one of the persons named and get appointed him as a Sole Arbitrator. If the Employer fails to select the person and appoint him as the Sole Arbitrator within 30 days of receipt of the panel and inform the contractor accordingly, the contractor shall be entitled to appoint one of the person from the panel as the Sole Arbitrator and communicate his name to the Employer.

If the Arbitrator so appointed is unable or unwilling to act or resign his appointment or vacates his office due to any reason whatsoever another Sole Arbitrator shall be appointed as aforesaid.

The work under the contract shall however continue during the Arbitration proceedings and no payments due or payable to the contractor shall be withheld on account of such proceedings.

The Arbitrator shall be deemed to have entered on the reference on the date he issues notice to both the parties fixing the date of the first hearing.

The Arbitrator may from time to time with the consent of the parties enlarge the time for making and publishing the award.

The Arbitrator shall give a separate award in respect of each dispute or difference referred to him. The Arbitrator shall decide each dispute in accordance with the terms of the contract and give a reasoned award. The venue of Arbitration shall be such place as may be fixed by the Arbitrator on his sole discretion.

The fees, if any, of the Arbitrator shall, if required to be paid before the award is made and published, be paid half and half by each of the parties. The costs of the reference and of the award including the fees, if any, of the Arbitrator who may direct to and by whom in what manner such costs or any part thereof shall be paid and may fix or settle the amount of costs to be so paid.

The award to the Arbitrator shall be final and binding on both the parties.

Subject to aforesaid the provisions of the Arbitration Act 1940 or any statutory modification or reenactment thereof and the rules made there under and for the time being enforce, shall apply to the Arbitration proceeding under this clause.

The Employer and contractor hereby also agree that arbitration under clause shall be a condition precedent to any right to action under the contract with regard to the matters hereby expressly agreed to be so referred to arbitration.

### **SECTION III**

#### **SPECIAL CONDITION OF CONTRACT**

##### **1. MATERIALS PROVIDED BY EMPLOYER**

i)The Employer may reserve to themselves the right to provide certain materials as mentioned for the work at the time of awarding contract or during the progress of the work and these shall

**SEAL & SIGNATURE OF FIRM**

be jointly inspected by the Engineer and the contractor before issue of materials. Suitability and sufficiency of the material shall be checked by the contractor.

ii) After the materials are received, the contractor shall not decline to accept responsibility for the proper quality, safety and sufficiency of the resulting work or structure by alleging defects of materials received from the Employer.

iii) The value of materials provided by the Employer shall be calculated at the prevalent market rates/invoice rates including all taxes, duties transportation, labor and other incidentals by the Engineer and the amounts shall be deducted in full from the interim Bill of the contractor as and where applicable.

iv) For all materials, issued free of cost to the contractor, the rates for such complete items shall be suitably modified/varied by the Engineer, unless otherwise provided for in the contract.

v) Wastage of extra quantity of materials used by the contractor over and above the allowed quantity as determined by the Engineer shall be taken as unnecessary and unauthorized and such use/wastage shall be at the cost of the contractor.

The Employer will not be bound to take back such materials found surplus with the contractor either before or after the completion of work or on an earlier termination of the contract, unless otherwise provided for in the contract.

vi) On loss or damage of any such materials, it shall be replaced by the contractor with the same quality/brand with the approval of Engineer or the value of such material would be recovered from interim bill of the contractor at the prevalent market rate, as would be appropriate in the opinion of the Engineer.

1.2(i) The contractor will be required to pay all taxes levied by the Central and/or State Governments on such part of his profit in respect of the contract as in chargeable therewith under the laws for the time being in force.

1.2(ii) The contractor's staff will be liable to pay all taxes levied by the Central and/or Union Governments on such of their salaries as are chargeable there with under the laws for the time being in force and the contractor shall conform such duties in regard to the deduction thereof as may be lawfully imposed on him.

1.2(iii) Contractor shall have to produce the certificate from the manufacturer or their authorized dealers for all procured products confirming use of specific materials at site.

## **2. ELECTRICITY AND WATER**

2.1 The Contractor shall be provided Electricity and water at one point only by the Bank and the Contractor shall pay to the Bank for the consumption of this facility on mutually agreed upon by the Bank and the Contractor.

2.2 Regarding all factory made products for which I.S.I. marked products are available, only products bearing I.S.I. marks shall be used in the work unless otherwise mentioned in the list of approved make of material in the tender.

2.3 CARE FOR EXISTING PROPERTY: The Contractor shall make all necessary arrangements as required by the Employer to ensure that all existing property of the Owner are not damaged or disrupted by the Contractor in any way. If in spite of his best efforts there is some disruption, or loss occurs, the Contractor shall reinstate and make it good as early as possible without any additional cost to the Owner.

3. **DRAWINGS:** Some of the detailed drawings may not be ready at the time of placing the order. The Contractor will have to proceed with the work till such time such drawings are released. The Contractor shall have absolutely no claim on the Owner on this account. Efforts will be made however, to release drawings progressively to have un-interrupted progress. Contractor will prepare/Shop drawings wherever required by Bank/Architects.

## **SECTION IV** **MEASUREMENT**

### **1. MEASUREMENT**

**SEAL & SIGNATURE OF FIRM**

- 1.1 The number of pages for measurements alone shall be 100 per book. If convenient, the measurement book may be provided with perforated sheets, in triplicate, for dispatch to concerned authorities. The pages shall be serially machine numbered. The book shall be in the custody of the Site Engineer.
- 1.2 In addition to pages for measurements, pages shall be provided for index. Instructions, Certificate of Condition (wholeness) of the Book and Record of handling and taking over.
- 1.3 Each book shall bear an identifying number.
- 2. RECORDING OF MEASUREMENTS**
- 2.1 The measurements shall be generally recorded by the Site Engineer or by the Consultant of the bank, specifically authorized for the purpose.
- 2.2 The Site Engineer (or his representative) shall take joint measurements (i.e. accompanied by the contractor's authorized representative) of the work as it progresses and record them directly in the Measurement Books.
- 2.3 It shall be ensured that the method of measurement is in accordance with the contract. The precision in measurements shall be as laid down in IS 1200. Any points of disagreement with the contractor pertaining to measurements shall be promptly referred to the decision of the competent authority.
- 2.4 Extra/deviated items, as claimed by the contractor, shall not be recorded in Measurement Book until they are approved by the competent authority.
- 2.5 In case some allegedly extra/deviated item is carried out by the contractor while complying with approved drawings and specifications, and the same is to be covered up, the Site Engineer shall check the item and its specification and record its measurements but simultaneously enter up the provision that their admittance is subject to the approval by the competent authority. Both the measurements and the proviso shall be got signed by the contractor.
- 2.6 The measurement Book shall not be handed over to the contractor at any time. The contractor or his representative may be permitted by the Site Engineer to see it in his presence and/or make a (concurrent) copy of his own. The contractor shall, however, be warned that his copy shall be regarded as an unofficial copy of the bank's Measurement Book. This is the only authorized document in the matter.
- 2.7 The measurement shall be signed at the end of each session on measurement of the day's work, as the case may be, by both the parties (i.e. Measurer/Site Engineer and the contractor).
- 3. CONCEALED WORK**
- 3.1 The contractor shall give due notice to the Employer whenever any work is to be covered up in the bodies of walls or otherwise, becoming inaccessible later on, in order that the work may be inspected and correct dimensions taken before such burial. In default where of the same shall, at the opinion of the Employer be either opened up for measurement at the contractor's expenses or no payment may be made for such materials. Should any dispute or difference arise after the execution of any work as to measurements etc. or other matters which cannot be conveniently tested or checked, the notes of the employer shall be accepted as correct and binding on the contractor.
- 4. The following instructions shall be borne in mind while taking measurements.**
- 4.1 The work shall be measured in the same sequence as constructed.
- 5. Checking of Measurements: Checking of the measurements shall be as under.**
- 5.1 It shall not be perfunctory and should result in revealing errors, accidental or deliberate, by the staff. It should also serve as a process of instruction to junior staff:
- 5.2 Measurements recorded shall be checked not less than 25% by Bank's representative from the Zonal Office and 100% measurement by the architect.

**SEAL & SIGNATURE OF FIRM**

**SECTION V**  
**SAFETY CODE**

**SCAFFOLDS**

1. Suitable scaffolds shall be provided for workmen for all works that cannot safely be done from the ground, or from solid construction except in the case of short duration work which can be done "safely from ladders" when a ladder is used, it shall be of rigid construction made either of good quality wood or steel. The steps shall have a minimum width of 450 mm and a maximum rise of 300 mm. Suitable hand hold of good quality wood or steel shall be provided and the ladder shall be given an inclination not steeper than 1/4 to 1 (1/4 horizontal and 1 vertical).
2. Scaffolding or staging more than 4m, above the ground floor, swung or suspended from an overhead support or erected with stationary support shall have a guard rail properly bolted, braced or otherwise secured, at least 1 m, above the floor or platform of such scaffolding or staging and extending along the entire length of the outside and ends thereof with only such openings as may be necessary for the delivery of materials. Such scaffolding or staging shall be so fastened as to prevent it from swaying from the building or structure.
3. Working platforms, gangways and stairway shall be so constructed that they do not sag unduly or unequally and if the height of the platform, gangway or stairway is more than 4 m, above ground level or floor level, they shall be closely boarded and shall have adequate width and be suitably fenced as described in (ii) above.
4. Every opening in the floor of a building or in a working platform shall be provided with suitable means to prevent the fall of persons or materials by providing suitable fencing or railing whose minimum height shall be 1m.  
  
Where ever there are open excavations in ground, they shall be fenced off by suitable railing and danger signals installed at night so as to prevent persons slipping into the excavations.
5. Safe means of access shall be provided to all working places. Every ladder shall be securely fixed. No portable single ladder shall be over 9M, in length while the width between side rails in rung ladder shall in no case, be less then 290 mm, for ladder up to and including 3M, in length for longer ladders this width shall be increased at least 20 mm for each additional meter of length.
6. A sketch of the ladders and scaffolds proposed to be used shall be prepared and approval of the Engineer obtained prior to construction.

**OTHER SAFETY MEASURES**

7. All personnel of the Contractor working with in the plant site shall be provided with safety helmets. All welders shall wear welding goggles while doing welding work and all metal workers shall be provided with safety gloves. Persons employed on metal cutting and grinding shall wear safety glasses.
8. Adequate precautions shall be taken to prevent danger from electrical equipment. No materials on any of the sites of work shall be so stacked or placed as to cause danger or inconvenience to any person or the public.
9. The contractor shall take all the measures on the site of the work to protect the public from accidents & shall be bound to bear the expenses of defense of every suit, action or other proceedings at law that may be brought by any person for injury sustained owing o neglect of the above precaution & to pay any such persons or which may with the consent of the contractor, be paid to compromise any claim by any such person.

**SEAL & SIGNATURE OF FIRM**



## **PERSONAL SAFETY EQUIPMENTS**

10. All necessary personal safety equipment as considered adequate by the Engineer should be kept available for use of the person employed on the site and maintained in a condition suitable for immediate use, and the Contractor should take adequate steps to ensure proper use of equipment by those concerned.
  - a) Workers employed on mixing asphalt materials, cement and lime mortars shall be provided with protective footwear and protective goggles.
  - b) Those engaged in white washing and mixing or stacking of cement bags or any materials which are injurious to the eyes shall be provided with protective goggles.
  - c) Those engaged in welding works shall be provided with welder's protective eye shields.
  - d) When workers are employed in sewers and manholes, which are in use, the Contractor shall ensure that the manhole covers are opened and are ventilated at least for an hour before the workers are allowed to get into manholes so opened shall be cordoned off with suitable railing and provided with warning signals or boards to prevent accident to the public.
  - e) The Contractor shall not employ men below the age of 18 years and women on the work of painting with products containing lead in any form. Wherever men above the age of 18 years are employed on the work of lead painting, the following precaution should be taken:
    - i) No paint containing lead or lead products shall be used except in the form of paste or ready made paint.
    - ii) Suitable face masks should be supplied for use by the workers when paint is applied in the form of spray or a surface having lead paint dry rubbed and scrapped.
    - iii) Overalls shall be supplied by the Contractor to the workman and adequate facilities shall be provided, to enable the working painters during the execution of work.
11. The safety provisions should be brought to the notice of all concerned by display on a notice board at a prominent place at work spot. The person responsible for compliance of the safety code shall be named therein by the contractor.

## **SECTION VI**

### **MODEL RULES FOR THE PROTECTION OF HEALTH AND SANITARY ARRANGEMENTS FOR WORKERS**

#### **DEFINITION**

- 1.a) 'Work Place' means a place at which, at an average 50 workers are employed in connection with construction work.

#### **FIRST AID**

- 2.(a) At every work place, there shall be maintained in readily accessible place first aid appliance including an adequate supply of sterilized dressings and sterilized cotton wool. The appliance shall be kept in good order and in large work place they shall be placed under the charge of a responsible person who shall be readily available during working hours.

#### **DRINKING WATER**

- 3.a) In every work place, there shall be provided and maintained at suitable places easily accessible to labor sufficient supply of cold water fit for drinking.
- b) Where drinking water is obtained from an intermittent public water supply, each work place shall be provided with storage where such drinking water shall be stored.
- c) Every water supply of storage shall be at a distance of not less than 15 m, from any latrine, drain or other source of pollution. Where water has to be drawn from an existing well which is within the proximity of latrine, drain or any other source of pollution, the well shall be properly chlorinated before water is drawn from it for drinking. All such wells shall be entirely closed in and be provided with a trap door which shall be dust and water proof.

**SEAL & SIGNATURE OF FIRM**

## SECTION - VII

### PREAMBLE TO BILL OF QUANTITIES

#### RATES TO INCLUDE:

Rates quoted shall be for the items completed in all respect at all floors/heights/levels including all taxes, octroi and the cost of all materials, fittings, fixtures, all labor and for all the operations as detailed in the specifications and contract conditions. Apart from other factors mentioned in the specifications and contract conditions, rates quoted for the items in this schedule shall also include the following:

#### **1. GENERAL:**

- a. Whether mentioned or not in the Bill of Quantities, all works are to be carried out as per the drawings, designs, catalogues and or instructions of the Architects/Bank. extra shall be paid over the quoted rates for not understanding the designs etc. before hand.
- b. Sample of all works/items shall be got approved from the Architects/Bank before taking the mass production in hand and nothing shall be paid for the cost of samples.
- c. Any incidental work required to complete the item and not specifically covered in the item as mentioned in Bill of Quantities shall be completed at no extra cost.
- d. Unless otherwise specified all exposed surfaces of wood/wooden moldings and plywood of loose furniture/items tops shall be finished in at least two coats of melamine polish, including staining to match the shades of laminates etc.
- e. All laminates for furniture items shall be 1.0 mm thick for vertical & 1.5 mm for hoz. Spaces, in Satin finish, color texture and shade as per the schemes given by the Bank/Architect.
- f. Unless otherwise specified, all inner surfaces, sides and under sides of furniture items, drawers/cabinets shall be polished/Painted flat oil painted as directed by Architects.
- g. All exposed edges of plywood/block boards shall be finished with teak wood lip pings 5 mm thick of profile as per detail and Melamine polished unless otherwise specified and no extra cost shall be paid.
- h. All furniture items shall be delivered at site packed in polythene sheets.

#### **2. WOOD WORKS:**

- a. Wherever ply is mentioned it will mean ply wood.
- b. All Board/Ply will be of BWP Commercial Type.
- c. All teak wood will mean CP. teak.

#### **3. HARDWARE:**

- 3.1 Necessary handles, tower bolts, ball catchers, stoppers, hinges, brass/GI screws, nails, locks, sliding rails, nut and bolts etc. shall be provided by the Contractor which shall be out of the approved make of these materials annexed in the technical specifications/approved by Architects/Bank.

#### **4. PAINTING AND POLISHING:**

- 4.1 All finishes, shade of colors, texture of fabrics including all surfaces of finishes like POP, painting, lamination, paneling, stitching joints in upholstery, all polishing shall be as per the satisfaction of the Architects/Bank.
- 4.2 Thoroughly brushing the surface to be finished, free from mortar dropping and other foreign matter including preparing the surface and sand papering to give an even surface.
- 4.3 For painting and polishing items - on all kinds of wood and wood based surfaces.
- 4.4 All painting work to be completed with at least one coat of the primer along with two coats of the paint as per the Technical Specification, Manufacturer's specification and to the satisfaction of the Architects/Bank.

**SEAL & SIGNATURE OF FIRM**

- 4.5 All the polishing works to be completed with at least two coats of the polish of the approved make as per the list of approved manufacturers and to the full satisfaction of the Architects/Bank.
5. **GLASS WORKS:**
- 5.1 The edges of glass tops for tables wherever shown shall be beveled as per approval of the Architects.
6. **PARTITIONS AND PANELLING**
- a. Quoted rate shall include labor/materials required to fix the sub-frame to the wall with MS flats ('L' / 'U') shape clamp with adequate screws and repairing the portion damaged while putting the gut ties. etc. and making good the same.
- b. Quoted rate shall be inclusive of making provisions for electrical conduits and switch boxes and time required while coordinating with other Contractors for the final finishing of the work.
- c. The partition frame work shall be provided up to the RCC slabs at top but measurement for payment shall be of partition up to false ceiling and frame /support of partition above false ceiling shall be carried out within the quoted rate for which no extra shall be paid.
- d. All electrical works shall be got carried out through licensed "A" class Electrical Contractor having experience of similar work and duly approved by Architects/Bank. The work shall be executed as per specifications and strictly in keeping with relevant IS code and rules and regulations of authorities.
- e. All work/materials will be as per good engineering practice.
- f. Wherever glass is mentioned it will be clear float glass.

## **SECTION - VIII**

### **SPECIFICATIONS**

1. **GENERAL:**
- 1.1 This section of the specifications covers all general civil work is any, for which no separate detailed specifications have been included.
- 1.2 All these works shall be done in accordance with the drawings and instructions for the Engineer-in-charge. Unless otherwise so specifically mentioned, the latest CPWD Specifications (New Delhi) for the particular item of work shall be followed. In case of any dispute regarding the intent of the specifications, the Engineer's decision shall be final.

All work shall be done as per approved drawings, specifications, site instructions and with specified materials/makes as approved. In case the Contractor desires to substitute an approved/specified material/make with an alternative one he must get specific approval of the same before its use in the work. Failure to do so will make the work liable to rejection irrespective of the fact that it might not have been detected and rejected earlier.

- 1.3 All finished work must be truly vertical and horizontal or in any other plane as shown and required and true to lines and levels. The Tenderers must inspect the various existing surfaces and areas on which he has work on and take whatever measures necessary to achieve the above objective and include the cost of the same in his rates as no extra will be payable for this purpose.
- 1.4 Samples of all items of work shall be prepared & got approved before proceeding with the work. For partitions complete layout shall be marked on the floor at the site for inspection & checking; only after approval installation shall commence.
- 1.5 Teak wood used anywhere in the work shall be 1st quality Teak wood. If anything to the contrary is mentioned elsewhere in these documents or drawings the above shall prevail & Tenderer shall be deemed to have quoted their rates accordingly.

**SEAL & SIGNATURE OF FIRM**

2. **WOOD WORK AND JOINERY:**
  - 2.1 **PLY WOOD:** Ply wood shall be BWR as per IS-303-1975 Specifications
  - 2.2 **BLOCK BOARDS:** Block board shall be as per IS: 1659-1979 BWR grade.
  - 2.3 **FLUSH DOORS:** 2202 Pt I (1991) Specification for wooden flush door shutter (cellular and hollow core type) ply wood face panels BWR grade.
  - 2.3 **LAMINATE:** Laminates where specified shall be of approved brand type, texture and thickness and manufacturer as per IS: 2046-1969. Fixing of laminates shall be done as per best trade practices and strictly as per printed instructions of the manufacturers using phenol Formaldehyde Synthetic Resin adhesive of approved make. Unless otherwise indicated laminated shall be 1.0 & 1.5 mm thick of approved make.
  - 2.4 **JOINERY:** All details shall conform to the drawings, but all measurements shall be checked at site. The scantlings shall be accurately planned and finished smooth to hold full dimensions shown in the drawings after finishing and rebates, rounding and moldings made before they are framed. No patching or plugging of any kind shall be prepared and got approved by the Engineer before proceeding with bulk manufacture.
3. **IRONMONGERY:**
  - 3.1 This section shall cover all finish hardware, latches, locks and other fittings and fixtures etc., used in wood doors. All finish hardware shall be well made, reasonably smooth, and free sharp edges and corners flaws and other defects and shall be as per relevant Indian Standard Code. Unless otherwise required all finish hardware shall be polished brass.
  - 3.2 All hardware shall be of approved make and shall be specifically got approved by the Engineer before ordering. No fittings and fixtures shall be fixed before all major work is over. While fixing correct handling of fixtures shall be ensured.
  - 3.3 All finish hardware shall be fixed by skilled carpenters experienced in this work. Work shall be done as per manufacturer's printed instructions and to the satisfaction of the Engineer.
  - 3.4 All hardware fixed to respective locations shall be adequately protected from damage and slashes of mortars and paints by covering suitably with Jute clothes/Black PVC sheet till handing over of the work to the Engineer/Owner to his satisfaction. The finished hardware shall be absolutely clean without any foreign materials and fully showing original finish in its best condition.

## **ELECTRICAL INSTALLATION WORKS**

**GENERAL:** All provisions of the "General Conditions" and "Supplementary General Conditions" shall form a part of this section.

### **WORKS INCLUDED IN THIS SECTION**

- a) 230V single phase, 2 wire lighting & power distribution system complete.
- b) An adequate equipment grounding system.
- c) Conduit, pull wire and outlet boxes for Telephone system.

**CODE REQUIREMENTS:** All work shall be done in accordance with the Institute of Electrical Engineers/I.S.S. code amended up to date/ Indian Electricity Rules.

**MATERIALS:** All materials to be used in this work be new and bear the Architects/ Bank approval.

**RECEPTACLES:** All 250V receptacles shall be 2 wire three pin 5 amp flush mounted modular series of flush type of approved make. For power loads, the flush type 6 pin socket shall of 15 amps. Rating and be also of approved make.

**SWITCHES:** All flush type switches shall be totally enclosed type of 5 amp modular series rating for up to four light outlets and 15amps rating for more than four light outlets being controlled by one switch. These shall be of approved make for light loads. For power loads, the flush type modular switches shall be of 15 amps rating and be of approved make.

**COVER PLATE:** These shall be as per the standard modular series and shall be an integral part of the switch or socket and of color approved by the Architects as required.

**LOCATION:** The drawings indicate diagrammatically various outlets and equipments. In the event of things in the indicated locations of equipment or fixture being necessary due to developed

**SEAL & SIGNATURE OF FIRM**

conditions in the building construction or rearrangement of furnishing, such changes shall be made without any extra cost by the contractor.

The route of various conduits shall take into consideration the provisions of other services and shall be decided accordingly at site by the Architects/ Bank.

**POSITION OF LIGHTINGS & DISTRIBUTION BOARDS & SWITCH GEARS:** The recommended position of the lighting points, control switches, distribution boards and switch gears, as shown on the layout drawings, will be adhered to as far as practicable. Should there be any discrepancy or incomplete description, ambiguity or omission in the drawings and other documents, whether original or supplementary, forming the contract, the contractor shall immediately on discovering the same, draw attention of the Architects. Prior to the installation of lighting, and plug points, switches etc. final position shall be ascertained by the contractors with the Architects representative.

**PAINTING AND MARKING:** All exposed steel work not actually embedded in building construction (viz. Conduits, junction boxes, switch boards etc.) will be painted to match the existing shades of walls as instructed. This work will be done by the contractor without any extra charge.

The contractor shall satisfy the Architects/ Bank that he has trained labor for making joints of Copper cable/wire etc. Wherever recessed fittings/ fixtures are required to be installed the Contractor shall be responsible for making the recesses in the false ceiling. Only such electrical material of makes and type as approved by Architects/ Project Manager shall be used.

**CONDUITS :**These shall be of 16 SWG up to 32mm dia and 14 SWG thick for 38mm and above dia steel, stove enameled having perfectly circular tubing and capable of being cleaned and tight fitting joints. For flexible conduits 14 SWG thick galvanized MS Flexible conduits will be used.

**USE OF BENDS:** These shall be of 14 SWG. As far as possible, the conduit system shall be so laid out that it will obviate the use of tees, elbows and sharp bends. No length of conduit shall have more than the equivalent of two quarter bends from inlet to outlet.

**CROSS SECTION:** The conduits shall be of ample sectional area to facilitate the drawings of cables. In no case shall the total cross section of cables measured overall be more than half the area of the conduit.

**DRAW BOXES:** M.S. draw boxes of ample dimensions shall be provided at convenient points on walls to facilitate pulling of long runs of cables. They will be completely concealed with hylam covers flushed with finish surface. These boxes will be as few as possible and located where found suitably by the Architects/ Bank. All the G.I boxes used for housing switches, plugs, drawing of wires etc. shall be five sided and of minimum 20 SWG.

**SWITCH BOXES:** G.I boxes of required sizes shall be provided to house switches and plug sockets. These shall be attached to conduits by means of check nuts on either side of their walls. These shall be completely concealed leaving edges flush with wall surfaces.

**THE CLEANING OF CONDUIT SYSTEM:** The entire Conduit System, including outlets and boxes shall be thoroughly cleaned after completion of erection and before drawing in cables.

**PROTECTION:** To safeguard against filling up with the plaster etc. all the outlet boxes and switch boxes will have to be provided with temporary covers and plug within the tendered cost which shall be replaced by sheet covers as required.

**PAINTING BEFORE ERECTION:** The conduit shall be painted at such places where the pipe had been damaged due to vice or wrench grip.

**WALL SOCKETS & PLUGS:** Wall sockets will be of the following type:

- a) For light plug point 5 amps. Capacity 3 pin type.
- b) For power plug point 15 amps. Capacity 6 pin type.

The quoted rate shall also include earthing the third pin with 16 S.W.G. G.I wire.

**WIRES AND CABLES:** All wire/cables shall have been manufactured in accordance with the latest I.S. specifications amended up to date. The wiring shall be carried out in the mentioned manner each of which will conform to the given specifications. In concealed/surface conduit system

**SEAL & SIGNATURE OF FIRM**

including providing supply and fixing of conduit, bends junction boxes, Brass bushes, check nuts etc.

Looping system will be followed throughout including supply and drawing of required sizes of wire without damaging the same. All flush type accessories will be used. The installation will generally be carried out in conformity with the I.S.I. Code, Indian Electricity rules.

The Light plug points shall be complete with 3 pin 5 amps Plug & socket enclosed in G.I. box with the controlling switch as required and the third pin shall be earthed with 16 SWG Bare copper wires.

Wiring for power plugs shall be as mentioned in the schedule of quantities. Each circuit shall have not more than one power plugs and the plugs shall be earthed with 14 SWG Bare wire. The point shall be complete with a 3 pin 15 amps. Plug socket 15amps switch combined mounted on G.I. Box.

**POINT RATE:** The rate per point shall include all materials, & labor required for completing the point as mentioned in BOQ.

## SECTION IX

### LIST OF INDIAN STANDARDS REFERRED TO:

S.No.	I.S.Codes	SPECIFICATIONS
1.	I.S.No.1200	Latest measurements of building & civil engineering works, methods of.
2.	I.S. No. 2202(Part I)-1973	Specification for Wooden Flush Door Shutters ( Solid Core type Part I- plywood panels)
3.	I.S. No.710 & 303-1975	Specifications for Plywood for general purposes
4.	I.S. No. 1659-1979	Block Boards
5.	IS: 2046-1969.	Laminates
6.	I.S. No. 848-1974	Specification for Synthetic resin adhesive for plywood ( phenol & Amino plastic)
7.	I.S. No. 133-1975	Specification for Enamel, Interior (a) under coating (b) Finishing.
8.	I.S. No. 8756-1978	Ball Catchers
9.	I.S. No. 3564-1975	Door Closer (hydraulically regulated)
10.	I.S. No. 799-1979	Drawer Locks
11.	I.S. No. 694	Wiring with SPVC Cu. Wire through ISI PVC Conduits
12.	I.S. No. 3854	Computer outlet switch boards
13.	I.S. No. 9537 Part III	ISI PVC Conduits with accessories for Telephone/ LAN cable
14.	I.S. No. 8828	SP MCBs / DP MCBs
15.	I.S. No. 4064	Change Over Switch,63 Amps,4 Pole
16.	I.S. No. 13947 ( Part I-III)	100 Amps MCCB , Incomer

### LIST OF APPROVED MAKE OF ACCEPTABLE MATERIALS

S.No.	Particulars	Specifications
1.	Block Boards/Ply/Flush Doors	Green Ply , “Century “or equivalent make only
2.	Synthetic Enamel paint	Asian, Berger, Nerolac or ICI
3.	Locks	Godrej, Acme, Yale India Ltd, Golden Industries Ltd.
4.	Brass/ powder coated Hardware fittings.	Palladium, Earl behari or equivalent.
5.	Glass (Plain / Float)	Modi Guard, Triveni, Saint Govin.
6.	Hardware/Hinges, Magnetic catchers, sliding Channels, Handles & fittings	EARLBEHARI, FLORA, HATTICH or equivalent.
7.	Glue / Adhesives	Fevicol.
8.	M.S. Screws	Nettle Fold, GWK
9.	Laminates	1.Seamed Anergre ( 366 of Century ) 2. Sugar Maple ( F1/ 1758 of Formica) 3. Goncalo Alves (1769 of Sunmica ) * Same approved shade may be acceptable with Euro, Green lam,

**SEAL & SIGNATURE OF FIRM**

		Signature, Delta, Royal Touch, Timex or equivalent.
10.	Gyp Board for False Ceiling	M/s India Gypsum Ltd. or equivalent.
11.	Floor Springs & Door Closers	M/s Everite agencies Pvt Ltd, M/s Hemoes, M/s Nita Floor Springs, M/s Doorma, M/s Kelwyn.
12.	Surface Paint	ICI,Asian,Berger or equivalent
13.	Readymade Chairs	Featherlite/ Comfort / Decora
14.	Gyp Board for False Ceiling	M/s India Gypsum Ltd. or equivalent as per consultant's prior approval.
15.	Rubber Foam	Dunlop, prestige or equivalent.
16.	U Foam (6mm, 25mm, 50mm, 75mm) 1 <sup>st</sup> quality	U-foam, MM foam or equivalent minimum of 40 densities.
17.	Vertical Blinds	Vista, Trac, Mac or equivalent as per consultant's approval.
18.	Vitrified Tiles (24"x24")	Nitco, RAK , Granolite, Asian or Jhonsons.
19.	Ceramic Tiles	Nitco, RAK , Granolite, Asian or Jhonsons.
20.	Door Closers	M/s Everite, M/s Kelwyn or equivalent as per consultant's prior approval.
21.	Floor Springs for Glass Doors & Patch Fittings.	M/s Doorma, Ozone or Ebco or equivalent as per consultant's prior approval
22.	Surface Paint	ICI, Asian, Berger or equivalent - "Shalimar"
<b><u>LIST OF APPROVED MAKE OF MATERIAL FOR ELECTRICAL WORKS</u></b>		
1.	MCB and MCB DB's	Havells or equivalent with hinged door recess type.
2.	Copper PVC insulated Wires(multistrand)	Finolex, Havells, RR Cables or equivalent make.
3.	CABLES	Finolex, Havells, RR Cables or equivalent Cables make.
3.	M.S. conduit (ISI marked)	B.E.C, Steel Kraft, AKG make
4.	Telephone wires (0.5mm)	Delton, National make
5.	5/15 amps. Switch, Socket	Anchor Roma Series, Crabtree or equivalent
6.	Telephone Socket (3 pin)	North West
7.	PVC Conduit	BCE, Plaza, AKG
8.	Light Fixtures	Philips, Crompton, Havels, Bajaj or equivalent.
<b>Note: The Contractor shall get the samples of all the items covered in this list for the clients for approval before commencing the supply.</b>		

- 1.
2. No Deviation permissible. Wherever Contractor proposes to use "equivalent" makes (i.e. Other than specified) the same shall be done only after prior approval from the Employer/Architect.
3. All material to be used shall be of first quality unless otherwise specified.

**SEAL & SIGNATURE OF FIRM**

**Schedule of B.O.Q. for Furbishing of UCo Bank; BO: MALVIYA NAGAR-BHOPAL; with Details of Specification.**

S.No.	Item	Qty.	Unit	Rate	Amount
<b>SCHEDULE OF FURNISHING (A)</b>					
<b>1.</b>	<b>NEW PARTITION:</b> Supplying & fixing at site with the following specifications.				
i)	Providing & Fixing <b>Solid Partitions</b> : as per approved design, Vertical wooden post sections of 2"x 1½" @ 2'-0" c/c (post to be fixed with roof ceiling); Horizontal wooden runners of sections 2"x 1½" @ 1'-6" c/c; 6 mm BWR grade ply (IS-710) to be pasted on both sides; 1 mm thick laminate to be pasted over the ply on both sides with 17 no. nail groove as per the approved color & pattern; 12.5 mm wooden skirting of height 75-100 mm finished with laminate on both sides; wire manager to be provided as per requirement.	25.00	Sq.Mtrs		
ii)	Providing & Fixing <b>Partly Glazed &amp; Partly Solid Partitions:</b> as per approved design, Vertical wooden post sections of 2"x 1½" @ 2'-0" c/c for solid portion (some of the post to be fixed with roof ceiling); Horizontal wooden runners of sections 2"x 1½" @ 1'-6" c/c for solid portion; 6 mm BWR grade ply (IS-710) to be pasted on both sides for solid portion; 1 mm thick laminate to be pasted over the ply on both sides with 17 no. nail groove as per the approved color & pattern for solid portion; 6 mm glass to be fitted with TW beading of 25 mm J section at glazed portion c/c of vertical post at glazed portion will be decided on the basis of site condition; Solid partition shall be 1050-1200 mm from ground level, then glazed partition up to 2100 mm & thereafter solid partition; 12.5 mm wooden skirting of height 75-100 mm finished with laminate on both sides; wire manager to be provided as per requirement.	55.00	Sq.Mtrs		
iii)	<b>Partitions 1650 mm Height partly glazed &amp; partly covered for cash cabins:</b> as per drawing, Vertical wooden post sections of 2"x 1½" @ 2'-0" c/c for solid portion; Horizontal wooden runners of sections 2"x 1½" @ 1'-6" c/c for solid portion; 6 mm BWR grade ply (IS-710) to be pasted on both sides for solid portion; 1 mm thick laminate to be pasted over the ply on both sides with 17 no. nail groove as per the approved color & pattern for solid portion; 6 mm glass to be fitted with TW beading of 25 mm J section at glazed portion c/c of vertical post at glazed portion will be decided on the basis of site condition; Solid partition shall be 1050-1200 mm from ground level, then glazed partition up to 2100 mm & thereafter solid partition; 12.5 mm wooden skirting of height 75-100 mm finished with laminate on both sides; wire manager to be provided as per requirement.	15.00	Sq.Mtrs		
iv)	<b>Door Shutters</b> 35 mm thick flush door finished with 1 mm thick laminate as per the approved color & pattern with 17 no. nail groove & with peep hole / looking glass of 6" to be provided.	10.00	Sq.Mtrs		
<b>2.</b>	<b>C.T.O. COUNTERS :</b>				
a.	Providing & fixing of <b>NEW C.T.O. COUNTERS</b> make it	7.50	R.Mtrs.		

**SEAL & SIGNATURE OF FIRM**



S.No.	Item	Qty.	Unit	Rate	Amount
	individual module with working top at 750 mm as per drawing, made of 19mm Boiling water resistant board (BWR grade IS 1659) for the structures, writing top, front fascia and cupboard units with drawer having necessary compartments. Key board shall be with sliding channels of (Ebco or equivalent).The writing top 1½ " thick shall have 19mm thick BWP grade B.B. with 1.50 mm thick Laminate as per the approve quality and color. Counters shall be in modular type. It shall have 1.0mm thick laminate of approved colors for all sides except top. The top shall have 1.5 mm thick laminate. Teak wood beading shall be all around (Hand made).Counter shall have leg rest of teakwood section <b>3"x2"</b> .Mat finish oil paint & Melamine finish polish to be applied where there is non laminated area. Counters to have locking arrangements of Godrej & other accessories with wire managers. The Counter shall be strictly as per the instructions of the consultant and approved drawing by the Bank.				
<b>b.</b>	<b>CASH COUNTERS :</b>				
	Providing & fixing of <b><u>NEW SINGLE WINDOW &amp; CASH COUNTERS</u></b> make it individual module with working top at 750 mm & customer's top at 1050-1150 mm as required, made of 19mm Boiling water resistant board (BWR grade IS 1659) for the structures, writing top, customer's top front fascia, computers hoods and cupboard units with drawer having necessary compartments for keeping cash. Key board shall be with sliding channels of (Ebco or equivalent).The writing top 1½ " thick shall have 19mm thick BWP grade B.B. with 1.50 mm thick Laminate as per the approve quality and color. Counters shall be in modular type. It shall have 1.0mm thick laminate of approved colors for all sides except top. Teak wood beading shall be all around (Hand made).Counter shall have leg rest of teakwood section <b>3"x2"</b> .Mat finish oil paint & Melamine finish polish to be applied where there is non laminated area. Counters to have locking arrangements of Godrej & other accessories with wire managers. The Counter shall be strictly as per the instructions of the consultant and approved drawing by the Bank.	3.00	R.Mtrs.		
<b>3.</b>	<b>GLASS SCREEN:</b>				
	Providing & fixing <b><u>Front Glass Screen for S/W &amp; Cash Cabins</u></b> in 12mm thick Float Glass (Modi/ Triveni or equivalent) with cash hole in 1 <sup>st</sup> class teak wood frame section 63x75mm with teak wood beading of approved shapes with polish & other accessories.	7.50	Sq.Mtrs		
<b>4.</b>	<b>FALSE CEILING:</b>				
	Providing and fixing at all height false ceiling including providing and fixing of frame work made of special sections power pressed from M.S. sheet and galvanized in accordance with zinc coating of grade 350 as per IS : 277 and consisting of angle cleats of size 25mm wide x 1.6mm thick with flanges of				

**SEAL & SIGNATURE OF FIRM**

S.No.	Item	Qty.	Unit	Rate	Amount
	22mm and 37mm at 1200mm centre to centre one flange fixed to the ceiling with dash fastener 12.5mm diax40mm long with 6mm dia bolts to the angle hangers of 25x25x0.55mm of required length, and other end of angle hanger being fixed with nut and bolts to G.I. channels 45x15x0.9mm running at the rate of 1200mm centre to centre to which the ceiling section 0.5mm thick button wedge of 80mm with tapered flanges of 26mm each having clips of 10.5mm at 450mm centre to centre shall be fixed in a direction perpendicular to G.I. channel with connecting clips made out of 2.64mm diax230mm long G.I. wire at every junction including fixing the gypsum board with ceiling section and perimeter channels 0.5mm thick 27mm high having flanges of 20mm and 30mm long, the perimeter of ceiling fixed to wall/partition with the help of rawl plugs at 450mm centre to centre with 25mm long drive-all screws @ 230mm interval including jointing and fixing to a flush finish of tapered and square edges of the board with recommended filler, jointing tapes, finisher and two coats of primer suitable for board as per manufactures specification and also including the cost of making openings for light fittings, grills, diffusers, cutouts made with frame of perimeter channels suitably fixed all complete as per the direction of Consultant.				
a.	12.5 mm thick gypsum board conforming to IS: 2095- Part I.	200.00	Sqm		
b.	Providing & fixing of <b>POP Moldings</b> , architrave's, heavy type Cornices at all the junctions of the walls & False Ceiling, complete.	90.00	R.mtrs.		
5.	<b>MAIN ENTRANCE BOX TYPE GLAZED DOOR</b>				
	Providing, fabricating & fixing of <b>Main Entrance Glazed Door</b> . The Door Frame shall be made of teak wood sections 5"x 3" to be fixed at site with the help of hold fast. The Door shall be flap door of Wooden C shape frame of standard size as per the consultant's approval with approved color laminate on both sides. The top and bottom section shall be properly jointed with Pivot and Floor Spring (Heavy Duty ISI mark) and 12.00 mm thick Glass (Modi /Triveni or equivalent) with provision of toughening & beveled edge. Rubberized / appropriate padding with adhesive shall be used to proper functioning of the Door. Provision of 6.00mm thick half round teak wood beading be fixed with adhesive on both side of the glass duly melamine finish polish as per the design. The Door shall include cost of approved handles; floor springs heavy duty I.S.I. mark & godrej locking arrangements. It shall be strictly as per Consultant's instructions.	5.00	Sq.Mtrs		
6.	<b>STORAGE CABINET</b>				
a.	Providing, fabricating fixing in position <b>Storage Cabinets Flush type</b> 1'-6" deep made out of made of 19mm Boiling water resistant board (BWR grade IS 1659) for bottom, top, sides, & back with teak wood beading for all exposed surfaces.				

SEAL & SIGNATURE OF FIRM

S.No.	Item	Qty.	Unit	Rate	Amount
	The shutters shall be made of 19 mm thick BWP boards as per the design & pattern & shall be fixed over 1"x1" teak wood frame section all around & shall be flush with the top edge. Storage unit shall have provisions for 1'-6" wide & 1'-3" deep drawers across the length of cabinet. Shutter & drawer fascia shall have 1.0mm & top shall have 1.5 mm thick approved laminate finish. All inside surfaces are to be painted 3 coats of paint. The length of cabinets may vary as per site conditions. Shutters/drawers shall have earl Bihari fittings, Godrej make locks & magnetic catcher, complete as per design & Consultant's instruction.	20.00	Sq.mtrs		
b.	Providing, fabricating fixing in position <b>Cupboard Units</b> 1'-6" deep made out of made of 19mm Boiling water resistant board (BWR grade IS 1659) for bottom, top, sides, & back with teak wood beading for all exposed surfaces. The shutters shall be made of 19 mm thick BWP boards as per the design & pattern & shall be fixed over 1"x1" teak wood frame section all around & shall be flush with the top edge. Shutter fascia shall have 1.0mm & top & Bottom shall have 1.5 mm thick approved laminate finish. All inside surfaces are to be painted 3 coats of paint. The length of cabinets may vary as per site conditions. Shutters shall have earl Bihari fittings, Godrej make locks & magnetic catcher, complete as per design & Consultant's instruction.	15.00	Sq.mtrs		
c.	Providing, fabricating fixing in position <b>Over head Storage Cabinets</b> 1'-6" deep made out of made of 19mm Boiling water resistant board (BWR grade IS 1659) for bottom, top, sides, & back with teak wood beading for all exposed surfaces. The shutters shall be made of 19 mm thick BWP boards as per the design & pattern & shall be fixed over 1"x1" teak wood frame section all around & shall be flush with the top edge. Shutter fascia shall have 1.0mm & top & Bottom shall have 1.5 mm thick approved laminate finish. All inside surfaces are to be painted 3 coats of paint. The length of cabinets may vary as per site conditions. Shutters shall have earl Bihari fittings, Godrej make locks & magnetic catcher, complete as per design & Consultant's instruction.	15.00	Sq.mtrs		
7.	<b>BRANCH MANAGER TABLE: size 6'-0"x 2'-6"</b>				
	Providing & supplying <b>Branch Manager Table</b> , made out of 19mm BWR block board(IS-1659) and all external side will have 1.0mm laminate finish all inside surfaces will be painted with 3 coat of approved color paint, the top of the table shall be 1½" thick BWR grade board with 1.5 mm thick laminate as per the approved color. The table will have drawer for computer keyboard below the top out of 19mm. BWR and a full length shelf top and storage drawer with cupboard unit and tea tray, moving on slider. The front fascia of the table is made of 19mm thick BWR grade board with teak wood beading all around. The table shall have side Credenza of size 3'-0"x2'-6"x1'-6"	1.00	No.		

SEAL & SIGNATURE OF FIRM

S.No.	Item	Qty.	Unit	Rate	Amount
	made of 19 mm BWR grade board with drawers on top, below it shelves and openable doors with laminate on top, front and sides. All the exposed surfaces be laminated & beading. All the exposed surfaces be laminated & beading. All the edges shall have teak wood beading as per the design. The cost shall include all the accessories, necessary materials i.e. lock, channels, handles, catchers etc. complete as per the design and instructions.				
<b>8.</b>	<b>OFFICER'S TABLES: size 4'-6"x 2'-0"</b>				
	Providing & supplying <b>Officer's Table</b> , made out of 19mm BWR block board(IS-1659) and all external side will have 1.0mm laminate finish all inside surfaces will be painted with 3 coat of luster paint, the top of the table shall be over 1½" thick BWR grade board with 1.5 mm thick laminate as per the approved color. The table will have drawer for computer keyboard below the top out of 19mm. BWR and a full length shelf top and storage drawer with cupboard unit and tea tray, moving on slider. The front fascia of the table is made of 19mm thick BWR grade board with teak wood beading all around. The table shall have side Credenza of size 3'-0"x2'-6"x1'-6" made of 19 mm BWR grade board with drawers on top, below it shelves and openable doors with laminate on top, front and sides. All the exposed surfaces be laminated & beading. All the exposed surfaces be laminated & beading. All the edges shall have teak wood beading as per the design. The cost shall include all the accessories, necessary materials i.e. lock, channels, handles, catchers etc. complete as per the design and instructions.	6.00	No.		
<b>9.</b>	<b>CLERICAL TABLES: size 4'-0"x 2'-0"</b>				
	Providing & supplying <b>Clerical Staff Tables</b> , made out of 19mm BWR block board(IS-1659) and all external side will have 1.0mm laminate finish all inside surfaces will be painted with 3 coat of luster paint, the top of the table shall be over 1½" thick BWR grade board with 1.5 mm thick laminate as per the approved color. The table will have sliding computer keyboard below the top out of 19mm. BWR moving on slider. The front fascia of the table is made of 19mm thick BWR grade board with teak wood beading all around. The table shall have side Credenza of size 3'-0"x2'-6"x1'-6" made of 19 mm BWR grade board with drawers on top, below it shelves and openable doors with laminate on top, front and sides. All the exposed surfaces be laminated & beading. All the edges shall have teak wood beading as per the design. The cost shall include all the accessories, necessary materials i.e. lock, channels, handles, catchers etc. complete as per the design and instructions.	2.00	Nos.		
<b>10.</b>	Providing & Fixing <b>Cheque Deposit Box</b> with <b>Complaint Box &amp; Writing Desk Glass Top</b> made of 19 mm thick Block Board with openable door with locking arrangements as per design	1.00	No.		

SEAL & SIGNATURE OF FIRM

S.No.	Item	Qty.	Unit	Rate	Amount
	with open slit. The structure shall have approve colour laminate with skirting & on the top shall have 12 mm thick glass fixed on studs of 4"-6" as per consultant's instructions duly painted.				
11.	Providing & Fixing <b>Display Unit / Console Pillar</b> : size 480 mm dia made of 19 mm thick B.B. upto roof level with proper fixing & flexible ply covering all around as per plan with approved color laminate.	1.00	No.		
12	Providing and fixing <b>Shutter boxing</b> with Wooden paneling for Shutter Covering including trap door for Rolling Shutter made out of 19mm BWR grade Board finished with approved color ACP Sheet on external exposed surface fixed on angle iron frame work.	30.00	Sq.Mtr.		
13.	Providing & Fixing <b>Wall Paneling</b> as per bank's approved design & specifications with 2 <sup>nd</sup> class T.W. frame section 2" X 1" battens fixed 2'-0" c/c, over it 6 mm plywood fixed neatly with tapered edges & over it bank's approved color laminate as per the pattern with top made of teak wood beading as per the design.	130.00	Sq.Mtr.		
14.	Providing & Fixing <b>Notice Board</b> made out of 19mm thick B.B. with 8 mm thick back ply with blazer cloth over 12 mm thick celotax board. All exposed edges shall be covered with T.W. lipping duly Paint/polish.	02.00	Sq.Mtr.		
15.	Providing and fixing at site <b>Fixed Glazing</b> 12.0mm thick glass with approved safety film to be fixed with Patch Fitting including all materials, labour etc complete.	05.00	Sq.Mtr.		
16.	Providing & Fixing <b>G.I. Duct</b> for UPS Room to open area complete in all respect.	1.00	Job		
17.	Providing & Supplying Executive Chair for B.M. revolving & tilting with cushion seat and back with arms. Make Featherlite, Methodex, Comfort or as per consultant's approval.	1.00	No.		
18.	Providing & Supplying Officer's Chair revolving & tilting with cushion seat and back with arms. Make Featherlite, Methodex, Comfort or as per consultant's approval.	14.00	Nos.		
19.	Providing & Supplying Visitor's Chairs with cushion seat and back with arms. Make Featherlite, Methodex, Comfort or as per consultant's approval.	17.00	Nos		
20.	Providing and at site, <b>Visitor's Sitting</b> , of three seated powder coated perforated chairs module with MS frame, (MAKE FEATHERLITE or equivalent) as per Consultant's choice.	5.00	Nos.		
21.	Providing & Fixing <b>Venetian Blinds (Vertical)</b> as per the approved color & make vistalelor, Livin or equivalent.	15.00	Sq.Mtr.		
<b>TOTAL FOR (A)</b>					
<b>B.</b>	<b>CIVIL WORK:</b>				
1.	Providing and applying Birla/J.K. or equivalent wall care Exterior/interior mix putty for outer surface i/c sand papering for making the surface smooth for applying any or vinyl paint with all cost of materials, labours, and scaffolding etc. in all position complete.	200.00	Sq.Mtr.		

**SEAL & SIGNATURE OF FIRM**

S.No.	Item	Qty.	Unit	Rate	Amount
2.	Providing and applying two or more coats of <b><u>Luster /velvet touch Acrylic Emulsion Paint</u></b> to internal wall surface to give an even shade, including thoroughly brushing the surface free from foreign matters, sand papering smooth, filling in all holes and cracks, applying two coats of ready made putty of standard company and finished with white cement filling and rubbing down the surface with one coat of cement primer. Rate to include for all tool, labor & scaffolding as required & directed.	200.00	Sq.mtrs		
3.	Providing and applying two coats of <b><u>Synthetic enamel</u></b> over one coat of steel/wooden primer with all materials labor etc. complete.	25.00	Sq.mtrs		
4.	Erection of Brick wall of 300 mm thick with 6mm bars @ 3 nos. at every 4 layer with PCC	16.00	Sq.mtrs		
5.	Erection of Brick wall of 200 mm thick with 6mm bars @ 2 nos. at every 4 layer with PCC	3.00	Sq.mtrs		
6.	Pilastering of surfaces @ 12.5mm with 1:4 ratio of sand & cement in line & level.	50.00	Sq.mtrs		
7.	Dismantalling of Brick wall with removal of debris & make good the surfaces.	12.00	Sq.mtrs		
8.	Providing 7 Fixing <b>Vitrified Tiles</b> as per the quality mentioned and fixing with adhesive and PCC as required.	210.00	Sq.mtrs		
9.	Pest Control Treatment of branch with 1 year warranty	150.00	Sq.mtrs		
<b>TOTAL FOR (B)</b>					
<b>TOTAL FOR (A+B)</b>					

**SEAL & SIGNATURE OF FIRM**

**Schedule of B.O.Q. for Electrification of U Co Bank; BO: MALVIYA NAGAR-BHOPAL; with Details of Specification.**

S.No.	Item	Qty.	Unit	Rate	Amount
<b>SCHEDULE OF ELECTRIFICATION</b>					
<b>A.</b>	<b>ELECTRICAL INSTALLATION WORK</b>				
1.	<p>Supplying and fixing, Testing &amp; Commissioning <u>Electrical Main Panel Board</u> with providing and fixing Vermin Proof in 20 gauge MS sheet, of following 8 way, three pole and neutral, sheet steel Load line MCB distribution board, 3 phase 440V/ single phase 250V 50c/s supply., on surface /recess, complete with tinned copper bus bar, neutral bar, earth bar, din bar, detachable gland plate, interconnections, including painting, ear thing etc as required. with the followings -</p> <p><b>INCOMER</b>  1 Nos - 100 Amp MCCB  1 Nos.- 100 Amp SFU with 63 A HRC fuses.  1 Nos -160 A TPN insulated Aluminum Bus Bar  1 Nos.- 100 A change over switch (manual)  1 Nos -63 Amp TPMCB  1 Nos -100 A TPN insulated Aluminum Bus Bar (Generator side)</p> <p><b>OUTGOINGS</b>  2 Nos- 63 A TPMCB  2 Nos- 40 Amp TP MCB  2 Nos- 32 Amp TP MCB</p> <p><b>SET AS ABOVE</b></p>	1.00	Set		
2.	<p><b><u>LIGHT DISTRIBUTION BOARD:</u></b>  Supply, Installation, Testing and commissioning of the surface / recess mounting following way MCB three phase distribution board for single phase outgoing with IP 42 protection , direct on wall incl. the followings accessories</p> <p><b>INCOMER</b>  1 No. TPMCB 40 Amp</p> <p><b>OUTGOINGS</b>  6-8 Nos SPMCB 6-10 Amp</p> <p><b>SET AS ABOVE</b> incl. Electrical connection ,earthing, making good all the damages, painting, cleaning the site, etc complete as per site Requirement and as directed. Supply, installation, commissioning &amp; testing at site 4 Pole Change Over Switch as approved for drawing power supply from the source.</p>	1.00	Nos.		
3.	<p><b><u>UPS DSITRIBUTION BOARD</u></b>  Providing and fixing at site AC distribution board comprising of the following items in three way TPNCB</p> <p><b>INCOMER</b>  1 Nos- 63 Amp TP MCB</p> <p><b>OUTGOINGS</b>  7 Nos 20 Amp SPNCB  2 Nos 32 Amp TPMCB</p> <p><b>SET AS ABOVE</b></p>	2.00	Job		
4.	<p>Providing &amp; fixing at site <u>3 x 1.5 sq.mm computer points</u> in PVC insulated single core copper flexible wire in PVC Conduits, with individual circuits through UPS. Ear thing of third pin. (Av.Run-8Mtrs.)</p>	16.00	Nos.		
5.	<p>Point Wiring with 2x 4.00 sq.mm. PVC insulated single core copper wire in PVC conduit/casing for power/ A.C. (Av.Run-10 Mtrs.)</p>	90.00	Rmtr.		
6.	<p>Point Wiring with 2x2.5 sq.mm. &amp; 1x1.5 sq.mm. PVC insulated single core copper wire in PVC conduit/casing for power/ A.C. (Av.Run-10 Mtrs.)</p>	90.00	Rmtr.		
7.	<p>Point Wiring with 3x1.5 sq.mm. PVC insulated single core copper</p>				

**SEAL & SIGNATURE OF FIRM**

S.No.	Item	Qty.	Unit	Rate	Amount
	flexible wire including circuit wiring with 2x2.5 sq.mm. & 1x1.5 sq.mm PVC insulated copper flexible wire in PVC conduit/casing for Light/Fan/ Exhaust fan/ 6A raw power plug/ call bell/ Sign Board points. (Av.Run-6 Mtrs.)	180.00	Rmtr..		
8.	Supply & fixing 1x 6A, 5-pin modular socket & switch for Raw power.	15.00	Nos.		
9.	Supply & Fixing Computer Switch Board with modular type 4x 6A, 5-pin socket outlet & 1x 16 A, switch.	16.00	Nos.		
10.	Supply & Fixing Power Switch board with modular type 1x 16A, 6-Pin socket outlet & 1x16A, switch.	15.00	Nos.		
11.	Supply & Fixing Call Bell with push button modular type.	2.00	No.		
12.	Supply & Fixing 10 A NO/NC contactor in M.S. enclosure for auto OFF/ ON control of power inside the strong room.	1.00	No.		
13.	Supply & Fixing & A to 12 A DOL starter for room A.C.	1.00	No.		
14.	Wiring with 2 x 10 sq.mm. & 1x 4 sq.mm. single core PVC insulated copper flexible wire in PVC conduit/casing (from 63 A, DP,MCBs, near the source of supply to Lighting cum power DB & computer DB.	45.00	Mtrs.		
15.	Loop Wiring with 3x 10 + 1x 4 sq.mm single core PVC insulated copper flexible wire in PVC flexible conduit at the source point.	30.00	Mtrs.		
16.	Loop Wiring with 2x10+1x 4 sq.mm single core PVC insulated copper flexible wire in PVC flexible conduit for UPS incoming & out going.	30.00	Mtrs.		
17.	<b>Concealed Point Wiring</b>				
	Supply, installation, testing and commissioning of concealed point wiring in 25mm dia of approved make and ISI brand rigid PVC conduit, ISI marked confirming to relevant IS with 2x1.5 x1.0 sqmm PVC insulated standard copper conductor wire (RR/Finolex) with all drops accessories and hardware etc. The point shall include A-6 control switch, concealed MS box having size/space adequate to mount control switches for lights, fans, regulators, sockets for half points and ceiling fan electronic type regulators. The work shall include, using existing wiring and PVC conduits and other materials.				
a.	<b>One light point</b> controlled by one 6 Amp. S.P. switch	45.00	Nos.		
b.	<b>Two light point</b> controlled by one 6 Amp. S.P. switch, each group called as a set.	25.00	Nos.		
18.	Wiring of <b>A.C. Point</b> with 2x4 sqmm and 1x2.5 sqmm PVC copper multi strand wire in PVC conduit with circuit wiring upto the main panel with necessary MCB & Industrial plug socket 20 Amp S.P. MCB in sheet steel enclosure with complete installation.	10.00	Nos.		
19.	Dedicated <b>Earth station</b> with 600mm x600 mm <b>Copper earth Plate</b> as per IS: 3043.	1.00	Nos.		
a.	Earth Bus near UPS.	1.00	No.		
b.	Copper Earth Strips	20.00	Mtrs.		
20.a	Dedicated <b>Earth station</b> with 600mm x600 mm <b>G.I. earth Plate</b> as per IS: 3043.	1.00	Nos.		
b.	Earth Wire with 2x 8 SWG, G.I. wire in Alkathene pipe.	20.00	Mtrs.		
<b>TOTAL (A)</b>					
<b>B.</b>	<b>TELEPHONE WIRING</b>				
1.	Supplying, laying, fixing, testing & commissioning of following rigid PVC non metallic conduit (1.6mm wall thickness) of approved make on surface (wall / column / beam / ceiling etc) / in concealed manner i /c with all m. s. accessories like bends , tees , junction boxes etc.				

**SEAL & SIGNATURE OF FIRM**



S.No.	Item	Qty.	Unit	Rate	Amount
	including necessary breaking and cementing the floor if required, complete as required.				
a).	<b>20 mm dia.</b>	90.00	RMtr.		
2.	Supplying , drawing, testing and commissioning of 0.61 mm dia. Telephone cable tinned copper conductor, PVC insulated and sheathed , fire retarding, anti termite, colour coded twisted pairs and rip cord in existing pipe / trench / tray/ beam /column / floor etc with all necessary materials i/c connect connections, telephone sockets with identification by numbering etc complete as required as per I.T.D. specification.				
a).	<b>Two pair cable</b>	90.00	RMtrs		
<b>TOTAL (B)</b>					
<b>C.</b>	<b>SUB HEAD: STRUCTURE CABLING WORKS (COMPUTERS NETWORKING).</b>				
1.	Providing Cat- 6 mounting Chord (1 Mtr.) Factory crimped.	16.00	Nos.		
2.	Supply & Laying of CAT- 6 UTP cable.	180.00	Mtrs.		
3.	Supply & Fixing of CAT -6, I.O. + SMB ( single Port)	16.00	Nos.		
4.	Providing & fixing Jack Panel.	1.00	Nos.		
5.	Charges for Termination at both ends per node	16.00	Nos.		
6.	Supplying laying /fixing of <b>25 mm dia</b> rigid PVC non metallic conduit 1.6 mm wall thickness of approved make on surface ( wall / column / beam / ceiling etc) / in concealed manner i/c with all accessories like bends , tees , junction boxes etc. including necessary breaking and cementing the floor if required, complete as required.	180.00	Mtrs.		
7.	<b>Testing of STP cabling with scanner for all the Nodes.</b>	L.S.	L.S.		
<b>TOTAL (C)</b>					
<b>D.</b>	<b>POWER CABLE: (CONTINGENCY WORK)</b>				
	Supply, laying, testing & commissioning of the following 1100 volt grade L.T. XLPE Al. conductor armored cable inner and outer sheathed, along with the two run of G.I. earth wire etc. i/c termination at both ends.				
1.	<u><b>On surface:</b></u> S/Fixing the cable incl. s/f of saddles / spacers wherever required as per site conditions) and two run of G.I. earth wire along with the cable, making good all the damages. i/c termination at both ends.				
a).	4 C X 10 sqmm. <b>COPPER CABLE</b> ( with 08 SWG G.I.wire)	30.00	RMtr.		
b)	4 C X 35 sqmm <b>Aluminum Armored Cable</b> (with 08 SWG G.I.wire) from pole to meter.	30.00	Rmtr.		
<b>TOTAL (D)</b>					
<b>E.</b>	<b>DECORATIVE CFL LUMINAIRES/ ELECTRICAL FITTINGS :</b>				
	Supply, fixing, testing and commissioning of Recess mounted decorative luminaires with square paralite metal louver in metallic frame, held securely to the main body by four toggles, epoxy white powder coated CRCA sheet steel housing, electro-chemically brightened, polished and anodized aluminum mirror reflector, true light lamp, etc. with class-I electrical safety, complete as required. Dimensions: 600X600X80 mm (Approx.) Location: as per drgs. Make: as per approved List.				
i)	Supplying, Testing & Fixing & commissioning <b>2 X 36 watts CFL(2'x2')</b> as per approved list of material or equivalent	45.00	Nos.		
ii)	Supply and fixing of the <b>Wall bracket Fans.</b> (Make: Crompton Greaves/ Havels/Orient /Bajaj or equivalent.	24.00	Nos.		

**SEAL & SIGNATURE OF FIRM**

S.No.	Item	Qty.	Unit	Rate	Amount
iii)	Supply and fixing of the 300 mm (900 RPM) sweep <b>Exhaust Fan</b> , Including making hole in the wall for fixing , and making good the civil damages etc as required. Crompton, Havels or equivalent.	03.00	Nos.		
iv)	Supply & Fixing of CFL lamps with suitable brackets	20.00	Nos.		
<b>TOTAL (A+B+C+D+E)</b>					

**SEAL & SIGNATURE OF FIRM**

**Abstract Sheet for Interior Furnishing of UCO Bank; BO: MALVIYA  
NAGAR-BHOPAL**

- |  |                     |
|--|---------------------|
| <b>1. Cost of Interior Furnishing</b>          | <b>:: Rs.</b>       |
| <b>2. Cost of Civil Work</b>                   | <b>:: Rs.</b>       |
| <b>3. Cost of Electrification</b>              | <b>:: Rs. _____</b> |
| <b>TOTAL FURBISHING</b>                        | <b>:: Rs. _____</b> |
| <b>4. GST.(weather inclusive or exclusive)</b> | <b>:: Rs. _____</b> |
| <b>5. Grand Total</b>                          | <b>::Rs. _____</b>  |

In words & Figures::

**SEAL & SIGNATURE OF FIRM**

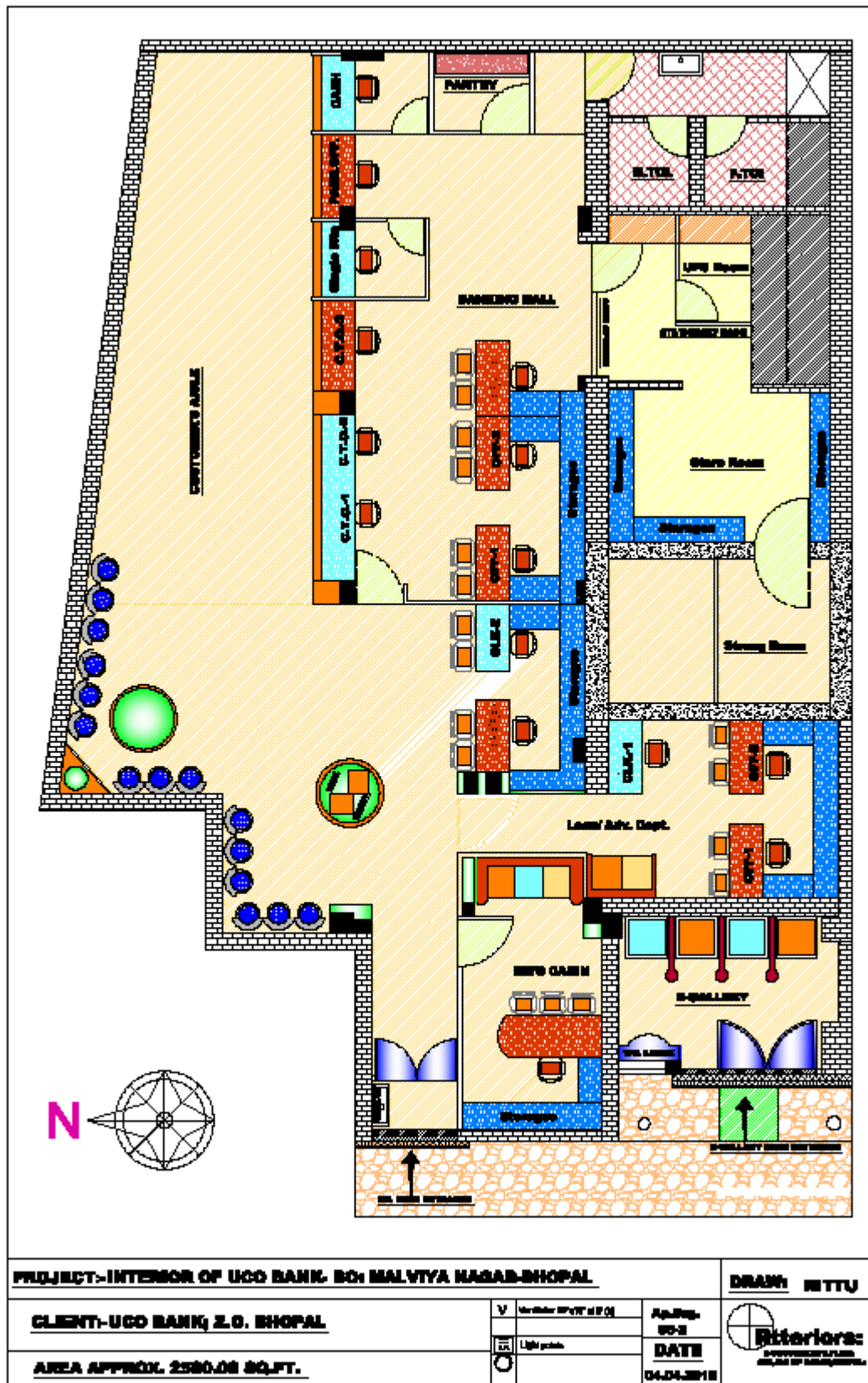

SEAL & SIGNATURE OF FIRM

**SEAL & SIGNATURE OF FIRM**