



ZONAL OFFICE SALT LAKE  
1<sup>ST</sup> FLOOR, 3 & 4 DD BLOCK, SECTOR-I, SALT LAKE,  
KOLKATA -700064

TENDER DOCUMENT

FOR

CONSTRUCTION OF  
(Civil & Furnishing works)

AT

DUM DUM CANTONMENT BRANCH,  
U C O B A N K  
MUNICIPAL MARKET, 1<sup>ST</sup> FLOOR  
MANUJENDRA DUTTA ROAD  
KOLKATA-700028

CONSULTING DEVELOPMENT SERVICES

Architects ● Engineers ● Valuers

17, Kalibari Lane, Jadavpur, Kolkata-700032

Off : 033 24239590

(M) 9330870022 / 9831664630

Email: [cds.ganguly@yahoo.com](mailto:cds.ganguly@yahoo.com)

**CONTENTS**

SN	DESCRIPTION	Page No
01.	Notice inviting tender	03
02.	Condition of tender	04
03.	General conditions of contract	05
04.	Form of tender	07
05.	List of material of approved brand	08
06.	Schedule & specifications	
	A) CIVIL Works	
	&	12
	B) Furnishing Works	
07.	Design layout (drawing)	23

UCO BANK  
ZONAL OFFICE SALT LAKE  
1<sup>ST</sup> FLOOR, 3 & 4 DD BLOCK, SECTOR-I,  
SALT LAKE, KOLKATA -700064

CONSTRUCTION OF DUM DUM CANTONMENT BRANCH, UCO BANK  
MUNICIPAL MARKET, 1<sup>ST</sup> FLOOR, MANUJENDRA DUTTA ROAD,  
KOLKATA- 700028.

(Civil & Furnishing works)

TENDER NOTICE NO:

Dated:

**NOTICE INVITING TENDERS**

1. Sealed tenders in the prescribed form are invited by the UCO Bank Zonal Office Salt Lake from the enlisted internal furnishing & civil contractors of UCO Bank on item rate basis for construction of proposed Civil & Furnishing works at Dum Dum Cantonment Branch.
2. The tender documents for the work can be Downloaded with up to date income tax, sales tax, professional tax clearance certificate, from WEBSITE on payment of Rs 500.00 (Rupees Five Hundred) on or from 02/07/2018-18/07/2018. Downloaded tender had to submit a DD Of Rs 500.00 (Rupees Five Hundred) favoring Uco Bank, salt lake zonal payable at Kolkata.
3. A Demand Draft or Pay Order for 2% cost of the quoted Value favoring UCO BANK Salt lake Zonal Payable in Kolkata as Earnest Money to be submitted along with the tender documents. Any tender which is not accompanied by the EMD shall be summarily rejected. EMD of unsuccessful bidder will be returned within a week of award of work to successful bidder without any interest.
4. Tenders should be submitted in sealed covers with the name of work written on the envelope & shall be received up to 3.00 p.m. 18/07/2018 at the office of the Zonal Head, Zonal Office Salt Lake, 1<sup>st</sup> Floor, 3 & 4 DD Block, Sector-I, Salt Lake, Kolkata -700064 and will be opened on 19/07/2018 at 3.30pm at the above office in presence of attending tenderers or their authorized representative (not more than one at a time). Tender documents will not be issued or received by post.
5. The Bank does not bind itself to accept the lowest bid and reserve the right to split up the order as and when necessary and accept or reject any or all tenders without assigning any reason whatsoever.
6. The Bank will not be bound to accept the lowest tender and reserves the right to reject any or all tenders without assigning any reason thereof.
7. Clarifications, if any, required for details, can be obtained from our Consultant, **M/S CONSULTING DEVELOPMENT SERVICES . 17, KALI BARILANE JADAVPUR KOLKATA 700032. CONTACT: - 09330870022 /9830350444**
8. The Bank will not be bound to accept the lowest tender and reserves the right to accept or reject any or all tenders/ application without assigning any reason whatsoever.

### Condition of Tender

1. Attested copies of up to date civil contractor's license, Income tax, value added tax and professional tax clearance certificates will have to be submitted along with the tender, without which the tender will be considered as incomplete and liable for rejection.
2. The tender shall remain valid for three months from the date of opening of the tender.
3. The tenderer is to quote his rate in ink in both English figures and in English word.
4. All corrections in the tender should be initialed by the tenderer before submission of the tender.
5. Each page of the tender documents must be signed by the tenderer.
6. Canvassing in any form is strictly prohibited and any tenderer found to have resorted to canvassing should be liable to have his tender rejected summarily.
7. In the event of the tender being submitted by a firm, it must be signed by a person holding a power of attorney authorizing him to do so, such power of attorney should be produced along with the tender.
8. Time is the essence of this contract and preference is likely to be given to a tender who will be in a position to complete the works in all details within the shortest possible time. The tenderer is requiring to specially mentioning in his tender the time he will require for completion of all work within the scope of this tender. Maximum time permitted is 20 calendar days from the date of issuing work order. If the contractor does not complete the work within the stipulated time, the contractor shall be liable to pay UCO Bank liquidation damage for delay as a penalty @ 2% (two percent) of the value of the work in respect of every day of delay or part thereof, subject to a maximum of 20% (Twenty percent) of the value of the work executed by the contractor.
9. When the work is awarded and the letter of intent issued, these documents shall become an integral part of contract.

**GENERAL CONDITIONS OF CONTRACT**

Unless otherwise provided for in the contract documents, these general conditions shall apply to the work of all the specification attached herewith.

1. The contractor shall provide all the necessary supervision during the execution of the works as long as the Architect may consider necessary (which approval may at any time be withdrawn). The Supervisor/ representative of the contractor are to be constantly on the work site & shall give his/ her whole time to the supervision of the same. Such authorized agent or representative shall receive on behalf of the contractor, directions and instructions from the Architect or Architect's representatives.
2. The contractor shall employ only such persons as are skilled and experienced in their trade. The Architect's shall be at liberty to object and call the contractor to remove from the site any person employed by him/ her for the execution of the work who in the opinion of the Architect misconduct's himself or is incompetent or negligent in the proper performance of his duties and such persons shall not be again employed upon the works without permission of the Architect.
3. The contractor shall inspect and examine the site and its surrounding and shall satisfy himself before the submission of his/her tender as to the nature of the site, the qualities, quantities and materials necessary for the completion of the works and in general shall obtain all necessary information's like risk contingencies which may influence or effect his tender & the execution of work in case it is assigned to him/ her.
4. Rate quoted shall cover all the items like transport, octroi, value added tax, incidental charges, duties service tax, any other statutory taxes, etc, for completing the works. No claim will be entertained by the bank due to any fluctuation in the rate of labor, material, freights, taxes, duties etc. at any stage. The rate quoted will be firm during the entire period of work.
5. The contractor has to arrange photos passes in prescribed proforma for the men working in the site. The contractor has to pay all legal dues to the workman engaged by him during the work as per law in force. Contract labor (Regulation & Allowance 1970). P.P.Act 1952, Bonus Act 1965, Est. Act 1972, West Bengal House Rent Allowance Act 1974, Gratuity Act 1972, and latest amended Acts are to be complied for execution of the work.
6. If the contractor fails to pay legal dues to labour or any workmen, UCO Bank will reserve the right to deduct such due, from the final bill of the contractor and arrange for disbursement to the concerned labour or workmen.
7. Work has to be carried out at the site without affecting the normal activities of the staff. The contractor will be responsible for any damage caused during the period of work and has to pay the damage.

8. The successful tenderer to whom the contract is awarded will have to deposit as “initial security deposit” (ISD) a further sum to make up of the value of the accepted tender including the Earnest Money. ISD may be submitted in the form of Demand Draft/ Pay Order. The initial Security Deposit will have to be made within 7 days from the date of acceptance of tender, failing which the Bank at its discretion may revoke the letter of acceptance and forfeit the Earnest Money deposit furnished along with the tender. ISD will be refunded along with the final bills.
9. If the contractor does not complete the work within the stipulated time, the contractor shall be liable to pay UCO Bank liquidation damage for delay as a penalty @ 2% (two percent) of the value of the work in respect of every day of delay or part thereof, subject to a maximum of 20% (Twenty percent) of the value of the work executed by the contractor.
10. Material and workmanship shall confirm to relevant ISI specification. Contractor has to follow the instruction of the Architect or his authorized representatives during the period of work.
11. The quantities given in schedule approximate and may vary as per requirement of the site. Payment shall be made on the basis of actual measurement of the work to be certified by Architect. Measurement shall be made as per relevant IS code except wherever otherwise mentioned.
12. The contract is time-bound and the works are to be completed within the time limit. Maximum time to complete the work is 20 calendar days from the date of issue of work order. This is a working Branch and the contractor has to work with no or minimum obstruction to its regular services.
13. 90% payment will be released after successful completion of work against bill duly verified & certified by the Consultant Architect & Branch Manager as well. Remaining 10% billed amount will be released after completion of 01 year, provided there is no deficiency/ defects observed in terms of quality & quantity of works. There would neither be any advance payment nor any payment against progressive bills.
14. The contractor has to clear all the materials, debris, tools, tackles, scaffolding etc. after completion of work for which no payment to be made.
15. The Bank shall not be liable for or in respect of any damage compensation payable at law in respect or in consequence of any accident or injury to any workmen or other person in the employment of the contractor and the contractor shall indemnify and keep indemnified the bank against all such damages and compensation (save and except as aforesaid) and against all claims, demands, proceeding costs, charges and expenses in respect thereof or in relation thereto.

**FORM OF TENDER**

To  
The Zonal Head  
UCO Bank,  
Zonal Office Salt Lake  
1<sup>st</sup> Floor, 3 & 4 DD Block, Sector- I,  
Salt Lake, Kolkata -700064

TENDER NOTICE NO:

dated

**Construction of Civil & Furnishing Works at Dum Dum Cantonment Branch**

Sir,

I/We the undersigned have examined the tender documents and the site of works as hereby submit this tender amounting the sum of Rs..... and should the same be accepted hereby undertake to execute, complete and maintain all works as set forth in the schedule of quantities and specifications in accordance with the conditions of tendering, general conditions of contract, and the rates quoted by us in the aforesaid schedule of quantities all here to annexed or in default thereof to forfeit and pay to UCO Bank the sum of money mentioned in the aforesaid documents.

I/We agree to abide by this tender for the period of three months from the date fixed for opening of the same.

I/We undertake to complete and deliver the whole of the works covered under this tender within a period of 30 calendar days from the date of issue of work order.

I/we shall be bound by the terms and conditions of the tender documents and our accepted tender.

Witness.....

Signature of Tenderer.....

Name.....

Name.....

Address.....

Address.....

Date.....

Date.....

INTERIOR WORKS		
SL.	DESCRIPTION OF MATERIAL	MAKE OF MATERIAL
1.A.	Hardwood All wood must be well seasoned, free from knots, other defects, due to handling and transportation wherever necessary, provide with Anti-terminate treatment, door & door frames lipping.	KAPOOR / SAL / BADAM / C.P.TEAK/ SAL
1.B.	PLY WOOD	MAYUR/AVENGER/SYLVAN/DURO/GREEN/
02	LAMINATE	FORMICA/SUNMICA/GREENLAM/EURO/CENTURY (1.0/1.5
03	ADHESIVE	FEVICOL
04	GLASS	MODI GUARD / SAINT GOBAIN
05	MORTICE LOCK, FITTING	GODREJ
06	WOOD PRESERVATIVE	TERMINATION TOR (PIDILITE)STP-
07	PAINT :- ENAMEL / EMULSION	BERGER , ASIAN PAINT / ICI / OIKOS /
08	FLOOR SPRING & DOOR	GODREJ / OZONE
09	PRE LAMINATED PARTICLE	NOVOPAN, DECOLAM
10	HANDLES, TOWER BOLT HINGES,	GODREJ /EARL BIHARI
11	RUBBER SOLUTION	DUNLOP S-758/FEVICOL
12	veneer	DURO/GREEN/CENTURY/VIR/MAYUR
13	OIL BOUND PAINT	BERGER, NEROLAC, ASIAN, ICI
14	POLISH	M.R.F. POLYURETHENE,FRENCH
15	SUN CONTROL FILM	GARWARE
16	VENETIAN BLINDS	VISTA LEVOLOR / AEROLOUX OR
17	GYPSUM BOARD	GYP BOARD
18	PIN UP BOARD	SITATEX STRAW BOARD
19	VINYL FLOORING	ARMSTRONG / L.G. / SOLARBRITE
20	CERAMIC TILES	KAJARIA/NITCO/BELL OR EQUIVALENT
21	VITRIFIED TILES	NAVEEN/JOHNSON/RAK OR EQUIVALENT
22	ALUMINUM SECTIONS	JINDAL/HINDALCO
23	SCREW	GKW
24	HANDLES, TOWER BOLT HINGES, LOCKS NIGHT	GODREJ /EARL BIHARI
25	DOOR CLOSER/FLOOR SPRING	DORMA, OZONE
26	SLIDING	MECHANISMS KAFF, HETTICH
27	RUBBER SOLUTION	DUNLOP S-758/FEVICOL
28	MODULAR FURNITURE	BLOW-PLAST / GODREJ / FEATHERLITE/METHDOX & EQUIVALENT
29	veneer	DURO/GREEN/CENTURY/VIR/MAYUR
30	TEXTURED PAINT	SPECTRUM / OIKOS / NEROLAC
31	METAL LAMINATE	DURO



ELECTRICAL WORKS		
SL.	DESCRIPTION OF MATERIAL	MAKE OF MATERIAL
01	SWITCH / FUSE	HPL / HAVELLS / M.K., SCHINEIDER,LEGRAND
02	CHANGE OVER SWITCH	HPL / HAVELLS / M.K., SCHINEIDER / LEGRAND
03	MCCB / MCB / MCI	LEGRAND (LEXIC) / HPL (MOELLER)
04	RCCB / RCBO	LEGRAND (LEXIC) / HPL (MOELLER)
05	MCB DB BOX	LEGRAND (LEXIC) / HPL (MOELLER) /
06	CABLE	POLYCAB / FINOLEX / SCHINEIDER, INDO-ASIAN / LEGRAND
07	CABLE SOCKET	DOWELL'S / 3D
08	PVC PIPE & ACESSORIES	POLYCAB / HARSH
09	WIRE (FRLS)	RR / POLYCAB / PHENOLUX / HAVELLS /
10	MODULAR ACESSORIES	CRABTREE (AHTENA) / LEGRAND (MOSAIC)
11	MINI STARTER	GETRON / ELECTRON
12	LIGHT FITTING	GETRON / ELECTRON / PHILIPS / CROMTON
13	NETWORKING SWITCH	IBALL / DELINK
14	JACK PANEL	IBALL / DELINK
15	CABLE MANAGER	IBALL / DELINK
16	LAN CABLE	IBALL / DELINK
17	INFO. OUTLET	IBALL / DELINK
18	PATCH CORD	IBALL / DELINK
19	CONDUIT	CAP/SIEKO (15 MM THICK CONDUIT)
20	FITTING	PHILIPS / CROMTON GREEVES
21	TELEPHONE WIRE	PHENOLUX /HAVELLS/ POLYCAB
22	FAN CROMPTON / HAVELLS	FAN CROMPTON / HAVELLS
CIVIL WORKS		
SL.	DESCRIPTION OF MATERIAL	MAKE OF MATERIAL
01	SAND	BOICHI,HOOGLY
02	STONE CHIP	PAKUR
03	CEMENT	L.& T
04	MS ROD	TATA
05	VITRIFIED TILES	JOHNSON,ORIENT
06	PAINT	BERGER / ICI
07	PVC PIPE/DOOR	DUROPLAST

**WORKS SPECIFICATIONS :**

Sl. No.	Location	Type of Material	Colour Code
1.	Floor	Vetrified tiles of 600 mm x 600 mm	Armenia of H&R JOHNSON (India) Or 10205 of BELL Ceramics Ltd. Or Equivalent
2.	Wall	Plastic Emulsion Paint	White Aura (3P0051) of Berger Paints India Ltd. Or Popcorn White (46YY86/166) of Azo Nobel India Ltd. Or Solemn Yellow (7882) of Asian Paints Ltd. Or Equivalent
3.	Ceiling	Plastic Emulsion Paint	White of the above manufacturers

**1) Broad specification of partitions / cabins / counters.****A) Indicative broad specifications of furnishing items:-**

Sl. No.	Items	Broad Specification
1.	Counter	1. 750 mm height 2. 1050 mm height for Cash Counter with working top and customers top. 3. Length of Cash Counter – 1200 mm
2.	Table with side unit	1. Officer's Table – 1500 mm x 750 mm size 2. Manager's Table – 1800 mm x 900 mm size 3. Clerical Table – 1200 mm x 600 mm
3.	Cash Cabin	1. Height 1350 mm out of which 1050 mm will be said and remaining 300 mm will be glazed 2. 1050 mm high 12 mm thick toughened glass at front side. 3. Length of cash cabin – 1800 mm.
4.	Manager's Chamber	Partly glazed
5.	Low height partition	1350 mm height (Partly glazed)
6.	Main entrance	Glazed door with frame.

**B) Indicative basic material specification:-**

Sl. No.	Material	Specifications
1.	Lamination on Horizontal surface	1.5 mm thick conforming to IS 2066
2.	Lamination on vertical surface	1.0 mm conforming to IS 2046
3.	Block board	19.00 mm BWR Grade conforming to IS 1659 Century / Green / Austin or equivalent.
4.	Ply	4 mm/ 6mm/ 12mm/ 19mm conforming to IS 710 (BWR Grade) of Century / Green / Austin of equivalent.

**2) Colour Code of partitions / cabins / counters.**

Sl. No.	Colour Code	Location
1.	Steamed Anegre (equivalent to 366 of M/s. Century)	This colour will be provided at vertical faces of all counter / partitions along with facade of the counter as per design.
2.	Sugar maple (equivalent to 1758 of M/s. Formica)	This colour will be provided at vertical faces of all counter / partitions along with facade of the counter / tables as per design.
3.	Goncalo Alvez (equivalent to 1769 of M/s. Sunmica)	The colour will be provided at skirting as per design.

Furnishing Works

BOQ OF CIVIL WORK FOR UCO BANK, , DUM DUM CANTONMENT BRANCH					
Sl. No.	PARTICULARS	UNIT	QTY.	RATE	AMOUNT
1.	<b>FALSE CEILING GRID CEILING:-</b> Providing and fixing of Armstrong Acoustical Suspended false ceiling system with "Dune Microlook" tiles. The tiles should have humidity resistance of 99% RH, Average NRC 0.50 and STC of 34dB, Light reflectance > 85%, thermal conductivity k = 0,052 - 0.057 W/M K, colour white with the exposed side finished with Crisp finely granulated with microperforations, Fire Performance class 0/ class 1 ( BS - 476) in module size of 600mm x 600mm x 16mm, laid with black silhouette 15mm hot dipped galvanised steel suspension system having rotary stitching. To comprise main runners of length 3000 mm width 15mm and web height 35 mm made out of 0.4 mm hot dipped galvanised steel spaced at 1200 mm centres securely fixed to the structural soffit by approved hangers at 1200 mm maximum centres and not more than 150mm from spliced joints. The last hanger at the end of each main runner should not be .greater than 600 mm from the adjacent wall. 1200 mm long cross tees of web height 35mm and made out of 0.4 mm thick galvanised steel to be interlocked between main runners at 600 mm require independent support. 600x600 mm modules to be formed by fitting 600 mm long cross tees centrally between the 1200mm cross tees. The 1200 mm cross tees to have central "birds mouth" notches to facilitate fitting of 600 mm cross tees. Perimeter trim to be Armstrong wall angles secured to walls at 450mm maximum centre's. False ceiling will be measured on horizontal plane only Horizontal plane measurements are to be inclusive of all vertical drops, edge moldings', facials, etc. rate quoted to include cost of providing support framework formed of perimeter channels or fixing light fixtures, AC grills/diffusers etc. Also to provide concealed perimeter channel support as required to support modular grid ceiling sections at junction between gypboard else ceiling and modular grid tile ceiling.	SQM	115.00		
2.	<b>PARTITION</b> Providing and fixing partition consisting of 2" x 2" finished sap wood section without sap and pints at maximum 2<-0"C/C both horizontally and vertically treated with Pentapehene pale com STP as anti termite & fire retardant from Viper. To be fixed screwed to the floor and ceiling with M.S. cleats.				

Furnishing Works

BOQ OF CIVIL WORK FOR UCO BANK, , DUM DUM CANTONMENT BRANCH					
Sl. No.	PARTICULARS	UNIT	QTY.	RATE	AMOUNT
	The frame work will be claded with 6mm thk. BWR plywood both sides and finished with 1.0mm thk. approved shade laminate as per design with approved adhesive. In case of Partly glazed and low ht.(4'-0" & 6'-0") partition 8mm thk. Etched/frosted ass to be provide fixed with 3"x3/4" white beach/ teak wood moulding with natural polished all complete. In case of Low ht. partition ( 4'-0") approved colour soft board should be embeded in partition with white beach/white ceader wooden beading with natural polish. The Work to be completed as per specification .design and approval of the Architects.				
	<b>Note: During joint measurement Partition ht. will be considered upto False ceiling level. In event of difference in false ceiling ht. the partition ht. shall be calculated on average ht.</b>				
	Partly Glazed Partition Including Internal Glass ht. will be from 3'-8"				
	Low Ht. Partly Glazed Side Partition Full ht. Partly Glazed; Partition Full Blocked Partition	SQM	22		
	Full ht. Partly Glazed Partition Low Ht. Door Partition				
3.	<b>Aluminum composite panel / Cladding on column specifications:-</b>  Providing & fixing Aluminium composite paneling in standard aluminum frame as per manufacturers specifications, Aluminium sections of Jindal of standard sections to be used.  Panel-Thickness-4mm, width 1220mm, length-3660mm foil thickness-0.5mm, Application- Exterior.Brand – Alucobond/ Alstone.[ note:- Texture of interior grade ACP sheet shall be decided by bank/Architect.	NO.	4		

Furnishing Works

BOQ OF CIVIL WORK FOR UCO BANK, , DUM DUM CANTONMENT BRANCH					
Sl. No.	PARTICULARS	UNIT	QTY.	RATE	AMOUNT
4.	Providing and fixing made out of 19mm thk. BWR block board for top, slidis and front of approved make cladded with 1.0mm laminate as per design in all visible areas. All the exposed edges to be covered with white beach/teak wooden lippings and table front facia will have 1 ½" x 1" mouldings with natural polish. The drawers to be made out of 19mm thk block board for front, sides to be made out of 12mm BWR plywood and bottom and back to be made out of 6mm BWR plywood and it should play in telescopic drawer sliding channels. The inside of the drawer and the table to be synthetic enamel painted (approved colour). A largest to be provided duly painted made out of 19mm thk BWR blockboard. A shutter to be made by 19mm BWR block cladded with 1.0mm laminate. The necessary godrej multipurpose locks (brass), brass hinges, 4" matt finished handles (brass) of approved make to be provided in each drawers and shutters. On top of the Branch manager table 10mm thk. Glass to be placed edges duly machine. polished. The table should have black powder coated readymade key board tray and tea ay with laminate finish. The necessary wire managers to be provided on the tabs and the provision for lights to be kept if required in the front of table. Readymade metal CPU trolly to e provided every where with a provision of castors to be provided. 3" raised portion made : 19mm BWR b/b finished with 1.0mm laminate and 1 1/2" raised portion made of 19mm WR b/b finished with 1.0mm approved colour laminate as per design to be provided on table front. All the exposed areas to be duly enamel painted. The work to be completed as per design and approval of the Architect.				
	Branch Manager	NO	1		
	Officers	NO	3		
	Spl. Asst. / Officers	NO	1		
5.	CASH COUNTER / TELLER COUNTER				

Furnishing Works

BOQ OF CIVIL WORK FOR UCO BANK, , DUM DUM CANTONMENT BRANCH					
Sl. No.	PARTICULARS	UNIT	QTY.	RATE	AMOUNT
	<b>12 mm GLASS PARTTION</b>				
	Providing .and fixing in position 12mm thk. machine polished glass at top of Cash counter front. Necessary 1 1/2" x1/2" white beech/white ceader moulding with natural polish to be provided. The work to be completed in all respect as per design , direction and approval of Architect.	LS	---		
	Providing and fixing, top, front & sides of cash / SW counter made out of 19mm BWR block board as per design cladded with 1.0mm thk laminate & the expose edges to be finished with necessary white beach or teak wood lippings, mouldings (as per design), etc. Special 6" drawer to be made; for the cash /teller with dividers of 12mm BWR plywood .The front of the drawer made out of 19mm BWR block board finished with 1.0mm laminate, sides 12mm BWR plywood and bottom, back to be made of 6mm BWR plywood. The inside and sides of the drawer to be synthetic enamel painted. The drawers and shutters to be provided with necessary drawer sliding channels,4" matt finished handles, brass hinges, godrej multipurpose locks etc. A leg rest to be provided made out of 19mm thk BWR block board duly enamel painted. Inside of the unit to be enamel painted in the matching tone. All visible areas to be covertd with white beach or teak wood lippings, mouldings with natural polish. Wire manager approved colour, legrest, Readymade CPU trolly, black powder coated readymade keyboard tray, tea tray finished with 1.0mm laminate to be provided.18mm thk approved colour Granite with bullnosed moulding (double) to be provided at customer top at 3' 8" M..6" raised portion made of 19mm BWR b/b finished with 1.0mm laminate and 3" raised portion made of 19mm BWR b/b finished with 1.0mm approved colour laminate as per design to be provided as shown in drawing. The work should be completed as per specification, design and approval of the Architects	SQM	4.5		
6.	<b>SIDE AND BACK UNIT</b>				
	Providing and fixing Side Unit/ Back unit made out of 19mm BWR block board for top, sides and 6mm thk. BWR ply for back finished with 1.0mm laminate. The drawers to be made out of 19mm BWR block board in the front cladded with 1.0mm laminate, sides to be made out of 12mm plywood and bottom, back made out of 6mm plywood and it should play on rawer sliding channels. Drawer and sliding shutters inside to be synthetic enamel	SQM	4.0		

Furnishing Works

BOQ OF CIVIL WORK FOR UCO BANK, , DUM DUM CANTONMENT BRANCH					
Sl. No.	PARTICULARS	UNIT	QTY.	RATE	AMOUNT
	<p>painted. The Sliding shutters to be made out of 19mm block board with 1.0mm laminate finished and should play on alluminium channels all four sides. The necessary godrej multipurpose locks, brass hinges, 4" brass matt finished handle, 4" brass matt finished sliding handle etc to be provided . Inside of the unit to be synthetic enamel painted in matching one. All the exposed edges of the boards/plywoods to be covered with White beach/teak wood lippings/ mouldings with natural polished all complete side and back unit top will have 1 1/2"x1" white beech/teak wood moulding with natural polish at front facia. The work to be completed as per specification, design and approval of the Architects.</p>				
7.	<b>STOREAGE</b>				
	<p>Providing and fixing! storage made out of 19mm BWR block board for top, sides &amp; 6mm BWR ply for back finished, with 1.0mm laminate. The shutters to be made out of 19mm block board with 1.0mm laminate. The necessary godrej multipurpose locks, 6" SS matt finished handles, auto closing hinges etc to be provided . 3" x 1/2" white beach/White cedar wooden skirting to be provided duly natural polished as per matching tone. Inside of the unit to be synthetic enamel painted in matching tone . All the exposed edges of the boards/plywoods to be covered with white beach/white cedar wooden lippings/1 1/2" x 1" mouldings duly natural polished all complete. For full ht. storage file divider made out of 6mm thk ply to be provided. The work to be completed as per approval and specification of the Architect.</p>	SQM	2.0		
	<p>Full ht storage 8'-0" (deep 1'-6")*3</p>				
8.	<p><b>CHEQUE DEPOSIT BOX</b> Providing and fixing cheque deposit box made out of 19mm thk block board &amp; finished with 1.0mm thk. Laminate &amp; inside to be synthetic enamel painted. a 1" high slit &amp; small door with key and locking arrangement to be done for dropping &amp; taking out the slips. The work to be completed as per the design, direction &amp; approval of the architect.</p>	NO	1		
9.	<p><b>FIRST AID BOX</b> Providing &amp; fixing in position first aid box made out of 19mm thk. BWR block board finished with 1.0mm thk. Laminate. Inside to be enamel painted all exposed edges to be covered with white beach/white cedar lipping with natural polish. Necessary hardware like multipurpose lock, brass hinges and</p>	NO	1		



Furnishing Works

BOQ OF CIVIL WORK FOR UCO BANK, , DUM DUM CANTONMENT BRANCH					
Sl. No.	PARTICULARS	UNIT	QTY.	RATE	AMOUNT
	handle to be provided. The work to be completed as per the direction approval of the architect.				
10.	<b>MAIN GATE</b> :- Providing & fixing fully glazed door at the main entrance consists of 6"x2"seasoned white beach/ Teak wood section for bottom rail and 4"x2" seasoned white beach/teak wood section for top rail finished with natural polish / by aluminum channel with . 12mm thk. Modi Guard /Saint Gobain clear float glass with sand blasting/etching (as per design) and finish handle (1'-0" long) of Neki/Hasseley make to be fixed on both sides & proper locking arrangement in bottom rail to be done. The gate should include lapping, molding, and beading & heavy duty floor spring of approved make. Having both side openable with two doors and rest as fixed. 2 Nos & ATM gate with back side Gate for the premises.	SQM	5.0		
11.	<b>PVC Doors</b> – Doors & door frame with a low thermal conductive material can reduce the loss of interior energy. <b>Weather Resistance / Anti-Ultraviolet</b> Highly weather resistant quality is achieved by anti-ultraviolet and high impact resistant formulation. It can withstand long exposure in extreme weather change under scorching sun, storms, dryness, high humidity. No brattling and quality deterioration occurs in the door. It's closed, smooth surface means that it is extremely easy to clean using gentle household detergent dissolved in water. This also means that the product is virtually dirt resistant because there are no pores, which can be filled with dirt. modern technology, doors will practically last forever. Which are an excellent do not involve any future maintenance costs including proper locking arrangements.	SQM	9.0		
12.	<b>Soft Board / Notice Board:-</b> Providing and fixing suggestion box made out of 19mm block board and finished with 1.0mm thk laminate & inside to be synthetic enamel painted. A 1" high slit & small door with key and locking	No.	1		

Furnishing Works

BOQ OF CIVIL WORK FOR UCO BANK, , DUM DUM CANTONMENT BRANCH					
Sl. No.	PARTICULARS	UNIT	QTY.	RATE	AMOUNT
	<p>arrangement to be done for dropping &amp; taking out the slips. The work to be completed as per design, direction &amp; approval of the architect.</p> <p><b>Note: Where pin up board is in a paneled area, the top of the pin up board should be flushed with the panel, keeping the same level. The work should be completed as per specification, design &amp; approval of the Architects</b></p>				
13.	<b>M.S Grill Cover For AC:-</b> supply and fixing of ms grill bar as box for covered the ac outdoor unit .with angles and bars as per specification including civil work in complete.	NO.	5		
14.	<b>Adopting Ceiling :-</b> Adopting of ceiling for the three numbers of colum where circular encasement had been done .in total 3 Nos	R.ft.	50		
15.	<p><b>Side Partition:-</b>Providing and fixing full hight ply partition with alluminium channel consisting of 8" x 3" finished sap wood section without sap and pints at maximum 2'-0"C/C both horizontally and vertically treated with Pentapehene pale com STP as antitermite &amp; fire retardant from Viper. To be fixed screwed to the floor and ceiling with M.S. cleats. The frame work will be claded with 6mm thk. BWR plywood both sides and finished with 1.0mm thk. approved shade laminate as per design with approved adhesive. partition 8mm thk. Etched/frosted ass to be provide fixed with 3"x3/4" white beach/ teak wood moulding with natural polished all complete. In case of Low ht. partition ( 4'-0") approved colour soft board should be embeded in partition with white beach/white ceader wooden beading with natural polish.The Work to be completed as per specification .design and approval of the Architects.</p> <p><b>Aluminium composite panel specifications:-</b></p> <p>Providing &amp; fixing Aluminium composite paneling in standard aluminum frame as per manufacturers specifications, Aluminium sections of Jindal of</p>	SQM	53		

Furnishing Works

BOQ OF CIVIL WORK FOR UCO BANK, , DUM DUM CANTONMENT BRANCH					
Sl. No.	PARTICULARS	UNIT	QTY.	RATE	AMOUNT
	standard sections to be used  Panel-Thickness-4mm, width 1220mm, length-3660mm foil thickness-0.5mm, Application- Exterior.Brand – Alucobond/ Alstone. [note:- Texture of interior grade ACP sheet shall be decided by bank/Architect.				
16.	<b>In ground floor</b> Supplying and laying true to line and level vitrified tiles of approved brand (size not less than 300 mm X 600 mm X 10 mm thick) in floor, skirting etc. set in 20 mm sand cement mortar (1:4) and 2 mm thick cement slurry back side of tiles using cement @ 2.91Kg./M2 or using polymerised adhesive (6 mm thick layer applied directly over finished artificial stone floor/Mosaic etc without any backing course) laid after application slurry using 1.75 Kg of cement per M1 below mortar only, joints grouted with admixture of white cement and colouring pigment to match with colour of tiles / epoxy grout materials of approved make as directed and removal of wax coating of top surface of tiles with warm water and polishing the tiles using soft and dry cloth upto mirror finish complete including the cost of materials, labour and all other incidental charges complete true to the manufacturer's specification and direction of Engineer-in-Charge.(White cement, synthetic adhesive and grout material to be supplied by the contractor)	SQM	112		
17.	Removal of Existing Plastering and damaged surfaces where ever necessary inside or out sides ( Including scaffolding complete)	SQM	50		
18.	Dismantle of Old IPS flooring of Toilets	SQM	9		
19.	Removal of Existing door frames of the Toilet with shutter	LS	--		
20.	Removing loose scales, blisters etc. from surface and thoroughly smoothening the surface to make the same suitable for receiving fresh coat of paris. Rendering the surface of walls and ceiling with plaster of paris (thickness not less than 1.5 mm.)	SQM	415		

Furnishing Works

BOQ OF CIVIL WORK FOR UCO BANK, , DUM DUM CANTONMENT BRANCH					
Sl. No.	PARTICULARS	UNIT	QTY.	RATE	AMOUNT
21.	<b>ROLLING SHUTTER HOOD COVER</b>  Providing & fixing in position hood cover of rolling shutters fabricated out of 2"x2" hard wood section cover; with 12mm thk. plywood. Hood cover will have necessary openable pallah at bottom, hardware incldg. locks, hinges handles. The job to be completed as per approval of the Architect in all respect.	SQFT	15		
22.	<b>ROLLING SHUTTER ENCASEMENT</b>  Providing & fixing rolling shutters encasement fabricated out of 19mm thk. BWR B3 finished with 1.0mm thk. laminate for top, sides, front and bottom with necessary openable pallah at bottom, hardware incldg. locks, hinges & handles. The job to be completed as per approval of the Architect.	SQFT	25		
23.	Applying of two cots of prima on the paris surface of approve quality including smoothening surface by sand papering etc. of approved make Brand.	SQM	420		
24.	Applying Acrylic Emulsion Paint of approved make and brand on walls and ceiling including sand papering in intermediate coats (Two Coats) Luxury Qty.	SQM	830		
25.	Painting with best quality synthetic enamel paint of approved make brand including smoothening surface by sand papering etc.	SQM	210		
26.	Collapsible gate with 40mm x 40mm x 6mm Tee as top and bottom guide rail, 20mm x 10mm x 2mm vertical channels 100mm apart in fully stretched position 20mm x 5mm M.S. flats as collapsible bracings properly rivetted and washered including 38mm steel rollers including locking arrangements, fitted and fixed in position with lugs set in cement concrete and including cutting necessary holes, chasing etc. in walls, floors etc. and making good damages Complete.	SQM.	5		
27.	Plaster (to wall, floor, ceiling etc.) with sand and cement mortar including rounding off or chamfering corners as directed and raking out joints	SQM	50		

Furnishing Works

BOQ OF CIVIL WORK FOR UCO BANK, , DUM DUM CANTONMENT BRANCH					
Sl. No.	PARTICULARS	UNIT	QTY.	RATE	AMOUNT
	including throating, nosing and drip course, scaffolding/staging where necessary (Ground floor).[Excluding cost of chipping over concrete surface]  <b>With 1:4 cement mortar</b> (a) 20 mm thick plaster				
28.	S.F. & F. 1 <sup>st</sup> Quality Ceramic Tiles in Toilets (floor to match) as approved by Architect by Synthetic Adhesive area of each Decorative tiles 0.09 sq.m	SQM	6		
29.	<b>SANITARY AND PLUMBING WORKS</b>				
	Taking out Old Plumbing Lines with all fittings complete	LS	--		
	Total Internal concealed water Pipe line with UPVC & CPVC pipe lines with necessary Tees,bends,elbows,etc along with necessary waste line and drainage line to the necessary pit				
	Toilet Fittings & Fixtures				
	EWC	NO.	2		
	10ltr. PVC Cistern	NO.	2		
	PVC solid Seat Cover	NO.	2		
	Gents flat back Urinal	NO.	1		
	Urinal Partition	NO.	1		
	Wash Basin (20"x16") fittings complete	NO.	2		
	Soap Tray/ Soap dispenser	NO.	2		
	Mirror	NO.	2		
	Gate Valve	NO.	2		
30.	<b>Venitian Blind</b> : -. 16mm Micro/25mm Slimline/25mm 25mm In Between Glass Slat Material The slats shall be manufactured from 0.175mm thick high tensile aluminium alloy which are crowned. The crowned slat shall be flexible enough to end 180 around a 12.5 mm radius without incurring any permanent deformation. [Note: Special finishes available in 0.200	SQM.	5		

Furnishing Works

BOQ OF CIVIL WORK FOR UCO BANK, , DUM DUM CANTONMENT BRANCH					
Sl. No.	PARTICULARS	UNIT	QTY.	RATE	AMOUNT
	<p>mmaluminium alloy 6011]Slat Dimensions 16mm Micro: the slat width is 16mm with a 4mm slat overlap.25mm: the slat width is 25 mm with a 5mm slat overlap25mm Slimline: the slat width is 25 mm with a 5mm slat overlap25mm Limited Edition: the slat width is 25 mm with a 3mm slat overlapPolyester Cord The core of the polyester cord shall be 1.5 mm thick with a braided jacket and finished with the unique Break-Thru Safety Tassel.Head &amp; Bottom Rails Fabricated from 0.5 mm hot-dipped aluminium zinc coated steel. The finish is 12 ±2 microns thick and comprises a thermoset polymercoating over primer.Colour &amp; finish The colour shall be white in slat style plain/gloss/metallic/brushed/jewel/MULTIVISION™ Concept/THERMOSTOPTMSlats with co-ordinated trims.</p> <p>Control The blind shall be operated by wand/motorised/control knob (in-between glass model)Motorisation Type It shall incorporate automatic down stop/automatic up stop/low speed tilting/remote control/switch control.Clutch Wand operated 25 mm and 16mm Aluminium Venetian Blinds shall contain the clutch mechanism</p> <p>.</p>				
	<b>Total</b>				





ZONAL OFFICE SALT LAKE  
1<sup>ST</sup> FLOOR, 3 & 4 DD BLOCK, SECTOR-I, SALT LAKE,  
KOLKATA -700064

TENDER DOCUMENT

FOR

CONSTRUCTION OF  
(Electrical Works)

AT

DUM DUM CANTONMENT BRANCH,  
UCO BANK  
MUNICIPAL MARKET  
1<sup>ST</sup> FLOOR, MANUJENDRA DUTTA ROAD,  
KOLKATA -700028

CONSULTING DEVELOPMENT SERVICES

Architects ● Engineers ● Valuers

17, Kalibari Lane, Jadavpur, Kolkata-700032

Off : 033 24239590

(M) 9330870022 / 9831664630

Email: [cds.ganguly@yahoo.com](mailto:cds.ganguly@yahoo.com)



CONTENTS

SN	DESCRIPTION	Page No
01.	Notice inviting tender	03
02.	Condition of tender	04
03.	General conditions of contract	05
04.	Form of tender	07
05.	List of material of approved brand	08
06.	Schedule & specifications	09
	A) Electrical Works	
07.	Design layout (drawing)	14

UCO BANK  
ZONAL OFFICE SALT LAKE  
1<sup>ST</sup> FLOOR, 3 & 4 DD BLOCK, SECTOR-I,  
SALT LAKE, KOLKATA -700064  
CONSTRUCTION OF DUM DUM CANTONMENT BRANCH, UCO BANK  
MUNICIPAL MARKET, 1<sup>ST</sup> FLOOR, MANUJENDRA DUTTA ROAD,  
KOLKATA-700028  
(Electrical Works)

TENDER NOTICE NO:

Dated:

**NOTICE INVITING TENDERS**

1. Sealed tenders in the prescribed form are invited by the UCO Bank Zonal Office Salt Lake from the enlisted internal electrical contractors of UCO Bank on item rate basis for construction of proposed Electrical works at Dum Dum Cantonment Branch.
2. The tender documents for the work can be Downloaded with up to date income tax, sales tax, professional tax clearance certificate, from WEBSITE on payment of Rs 500.00 (Rupees Five Hundred) on or from 02/07/2018-18/07/2018. Downloaded tender had to submit a DD Of Rs 500.00 (Rupees Five Hundred) favoring Uco Bank, salt lake zonal payable at Kolkata.
3. A Demand Draft or Pay Order for 2% cost of the quoted Value favoring UCO BANK Salt lake Zonal Payable in Kolkata as Earnest Money to be submitted along with the tender documents. Any tender which is not accompanied by the EMD shall be summarily rejected. EMD of unsuccessful bidder will be returned within a week of award of work to successful bidder without any interest.
4. Tenders should be submitted in sealed covers with the name of work written on the envelope & shall be received up to 3.00 p.m. 18/07/2018 at the office of the Zonal Head, Zonal Office Salt Lake, 1<sup>st</sup> Floor, 3 & 4 DD Block, Sector-I, Salt Lake, Kolkata -700064 and will be opened on 19/07/2018 at 3.30pm at the above office in presence of attending tenderers or their authorized representative (not more than one at a time). Tender documents will not be issued or received by post.
5. The Bank does not bind itself to accept the lowest bid and reserve the right to split up the order as and when necessary and accept or reject any or all tenders without assigning any reason whatsoever.
6. The Bank will not be bound to accept the lowest tender and reserves the right to reject any or all tenders without assigning any reason thereof.
7. Clarifications, if any, required for details, can be obtained from our Consultant, **M/S CONSULTING DEVELOPMENT SERVICES . 17, KALI BARILANE JADAVPUR KOLKATA 700032. CONTACT: - 09330870022/09830350444**
8. The Bank will not be bound to accept the lowest tender and reserves the right to accept or reject any or all tenders/ application without assigning any reason whatsoever.

### Condition of Tender

1. Attested copies of up to date civil contractor's license, Income tax, value added tax and professional tax clearance certificates will have to be submitted along with the tender, without which the tender will be considered as incomplete and liable for rejection.
2. The tender shall remain valid for three months from the date of opening of the tender.
3. The tenderer is to quote his rate in ink in both English figures and in English word.
4. All corrections in the tender should be initialed by the tenderer before submission of the tender.
5. Each page of the tender documents must be signed by the tenderer.
6. Canvassing in any form is strictly prohibited and any tenderer found to have resorted to canvassing should be liable to have his tender rejected summarily.
7. In the event of the tender being submitted by a firm, it must be signed by a person holding a power of attorney authorizing him to do so, such power of attorney should be produced along with the tender.
8. Time is the essence of this contract and preference is likely to be given to a tender who will be in a position to complete the works in all details within the shortest possible time. The tenderer is requiring to specially mentioning in his tender the time he will require for completion of all work within the scope of this tender. Maximum time permitted is 20 calendar days from the date of issuing work order. If the contractor does not complete the work within the stipulated time, the contractor shall be liable to pay UCO Bank liquidation damage for delay as a penalty @ 2% (two percent) of the value of the work in respect of every day of delay or part thereof, subject to a maximum of 20% (Twenty percent) of the value of the work executed by the contractor.
9. When the work is awarded and the letter of intent issued, these documents shall become an integral part of contract.

**GENERALCONDITIONSOFCONTRACT**

Unless otherwise provided for in the contract documents, these general conditions shall apply to the work of all the specification attached herewith.

1. The contractor shall provide all the necessary supervision during the execution of the works as long as the Architect may consider necessary (which approval may at any time be withdrawn). The Supervisor/ representative of the contractor are to be constantly on the work site & shall give his/ her whole time to the supervision of the same. Such authorized agent or representative shall receive on behalf of the contractor, directions and instructions from the Architect or Architect's representatives.
2. The contractor shall employ only such persons as are skilled and experienced in their trade. The Architect's shall be at liberty to object and call the contractor to remove from the site any person employed by him/ her for the execution of the work who in the opinion of the Architect misconduct's himself or is incompetent or negligent in the proper performance of his duties and such persons shall not be again employed upon the works without permission of the Architect.
3. The contractor shall inspect and examine the site and its surrounding and shall satisfy himself before the submission of his/her tender as to the nature of the site, the qualities, quantities and materials necessary for the completion of the works and in general shall obtain all necessary information's like risk contingencies which may influence or effect his tender & the execution of work in case it is assigned to him/ her.
4. Rate quoted shall cover all the items like transport, octroi, value added tax, incidental charges, duties service tax, any other statutory taxes, etc, for completing the works. No claim will be entertained by the bank due to any fluctuation in the rate of labour, material, freights, taxes, duties etc. at any stage. The rate quoted will be firm during the entire period of work.
5. The contractor has to arrange photos passes in prescribed proforma for the men working in the site. The contractor has to pay all legal dues to the workman engaged by him during the work as per law in force. Contract labor (Regulation & Allowance 1970). P.P.Act 1952, Bonus Act 1965, Est. Act 1972, West Bengal House Rent Allowance Act 1974, Gratuity Act 1972, and latest amended Acts are to be complied for execution of the work.
6. If the contractor fails to pay legal dues to labour or any workmen, UCO Bank will reserve the right to deduct such due, from the final bill of the contractor and arrange for disbursement to the concerned labour or workmen.
7. Work has to be carried out at the site without affecting the normal activities of the staff. The contractor will be responsible for any damage caused during the period of work and has to pay the damage.

8. The successful tenderer to whom the contract is awarded will have to deposit as “initial security deposit” (ISD) a further sum to make up of the value of the accepted tender including the Earnest Money. ISD may be submitted in the form of Demand Draft/ Pay Order. The initial Security Deposit will have to be made within 7 days from the date of acceptance of tender, failing which the Bank at its discretion may revoke the letter of acceptance and forfeit the Earnest Money deposit furnished along with the tender. ISD will be refunded along with the final bills.
9. If the contractor does not complete the work within the stipulated time, the contractor shall be liable to pay UCO Bank liquidation damage for delay as a penalty @ 2% (two percent) of the value of the work in respect of every day of delay or part thereof, subject to a maximum of 20% (Twenty percent) of the value of the work executed by the contractor.
10. Material and workmanship shall confirm to relevant ISI specification. Contractor has to follow the instruction of the Architect or his authorized representatives during the period of work.
11. The quantities given in schedule approximate and may vary as per requirement of the site. Payment shall be made on the basis of actual measurement of the work to be certified by Architect. Measurement shall be made as per relevant IS code except wherever otherwise mentioned.
12. The contract is time-bound and the works are to be completed within the time limit. Maximum time to complete the work is 20 calendar days from the date of issue of work order. This is a working Branch and the contractor has to work with no or minimum obstruction to its regular services.
13. 90% payment will be released after successful completion of work against bill duly verified & certified by the Consultant Architect & Branch Manager as well. Remaining 10% billed amount will be released after completion of 01 year, provided there is no deficiency/ defects observed in terms of quality & quantity of works. There would neither be any advance payment nor any payment against progressive bills.
14. The contractor has to clear all the materials, debris, tools, tackles, scaffolding etc. after completion of work for which no payment to be made.
15. The Bank shall not be liable for or in respect of any damage compensation payable at law in respect or in consequence of any accident or injury to any workmen or other person in the employment of the contractor and the contractor shall indemnify and keep indemnified the bank against all such damages and compensation (save and except as aforesaid) and against all claims, demands, proceeding costs, charges and expenses in respect thereof or in relation thereto.

**FORM OF TENDER**

To  
The Zonal Head  
UCO Bank,  
Zonal Office Salt Lake  
1<sup>st</sup> Floor, 3 & 4 DD Block, Sector- I,  
Salt Lake, Kolkata -700064

TENDER NOTICE NO:

dated

**Construction of Civil & Furnishing Works at Dum Dum Branch**

Sir,

I/We the undersigned have examined the tender documents and the site of works as hereby submit this tender amounting the sum of Rs..... and should the same be accepted hereby undertake to execute, complete and maintain all works as set forth in the schedule of quantities and specifications in accordance with the conditions of tendering, general conditions of contract, and the rates quoted by us in the aforesaid schedule of quantities all here to annexed or in default thereof to forfeit and pay to UCO Bank the sum of money mentioned in the aforesaid documents.

I/We agree to abide by this tender for the period of three months from the date fixed for opening of the same.

I/We undertake to complete and deliver the whole of the works covered under this tender within a period of 20 calendar days from the date of issue of work order.

I/we shall be bound by the terms and conditions of the tender documents and our accepted tender.

Witness.....

Signature of Tenderer.....

Name.....

Name.....

Address.....

Address.....

Date.....

Date.....

ELECTRICAL WORKS		
SL.	DESCRIPTION OF MATERIAL	MAKE OF MATERIAL
01	SWITCH / FUSE	HPL / HAVELLS / M.K., SCHINEIDER,LEGRAND
02	CHANGE OVER SWITCH	HPL / HAVELLS / M.K., SCHINEIDER / LEGRAND
03	MCCB / MCB / MCI	LEGRAND (LEXIC) / HPL (MOELLER)
04	RCCB / RCBO	LEGRAND (LEXIC) / HPL (MOELLER)
05	MCB DB BOX	LEGRAND (LEXIC) / HPL (MOELLER) /
06	CABLE	POLYCAB / FINOLEX / SCHINEIDER, INDO-ASIAN / LEGRAND
07	CABLE SOCKET	DOWELL'S / 3D
08	PVC PIPE & ACESSORIES	POLYCAB / HARSH
09	WIRE (FRLS)	RR / POLYCAB / PHENOLUX / HAVELLS /
10	MODULAR ACESSORIES	CRABTREE (AHTENA) / LEGRAND (MOSAIC)
11	MINI STARTER	GETRON / ELECTRON
12	LIGHT FITTING	GETRON / ELECTRON / PHILIPS / CROMTON
13	NETWORKING SWITCH	IBALL / DELINK
14	JACK PANEL	IBALL / DELINK
15	CABLE MANAGER	IBALL / DELINK
16	LAN CABLE	IBALL / DELINK
17	INFO. OUTLET	IBALL / DELINK
18	PATCH CORD	IBALL / DELINK
19	CONDUIT	CAP/SIEKO (15 MM THICK CONDUIT)
20	FITTING	PHILIPS / CROMTON GREEVES
21	TELEPHONE WIRE	PHENOLUX /HAVELLS/ POLYCAB
22	FAN CROMPTON / HAVELLS	FAN CROMPTON / HAVELLS
CIVIL WORKS		
SL.	DESCRIPTION OF MATERIAL	MAKE OF MATERIAL
01	SAND	BOICHI,HOOGHLY
02	STONE CHIP	PAKUR
03	CEMENT	L.& T
04	MS ROD	TATA
05	VITRIFIED TILES	JOHNSON,ORIENT
06	PAINT	BERGER / ICI
07	PVC PIPE/DOOR	DUROPLAST

Electrical Works

BOQ OF ELECTRICAL WORKS FOR UCO BANK, DUM DUM CANTONMENT BRANCH					
Sl. No.	PARTICULARS	UNIT	QTY.	RATE	AMOUNT
1.	<b>Supply, laying, connection &amp; testing of light:-</b> Supply, laying, connection & testing of light, fan point, wiring by 2 X 1.5mmsq. (2x3/.029) + 1 X 1 mmsq. PVC insulated copper flexible wire maintaining the colour code as per direction in PVC conduit of 20mm with ISI mark 1.5 PVC wall thk. to conceal in wall partition mending good the damage, complete with PVC circular box, bend to be done as per drawing including 3 point ceiling rose where ever required, GI saddle to be used for fixing, PVC conduite/flexible pipe may use if required in partition wall. All PVC pipes should be with ISI mark. No joints will be allowed inside pipe, Light, fan & plug point complete with modular type switch plate & MS box . Including the main circuite line 2 x 2.5 mmsq + 1 x 1.5 mmsq. earth PVC insulated Cu. Wire maintaining the colour code. Circuite line for lighting swith board, 6 Amps plug board are to be drawn from lighting DB to Lighting board & 6A plug point board, 6/16 Amps plug point line are to be drawn from power DB. 3 Nos. lighting board/ 03 Nos. 6 Amps plug are to be connected from one circuite & 02 Nos. 6/16 plug to be connected from one circuit Lighting pint complete with modular type switch, plate, M.S. conceal box.  Point – 1 Light point control by 01 switch. Point – 2 Light point control by 01 switch..	NO	54		
	Point – 2 Light point control by 01 switch..	NO	33		
2.	Exhaust fan point same as item No. 1a complete with modular type switch plate & MS conceal box & 3 pin ceiling rose	NO	2		
3.	Wall bracket point as above complete with modular type switch, plate & M.S. conceal box. Including one 2 pin plug socket, front plate & conceal box at fan end. Ht at 6'6"	NO	10		
4.	Call Bell	NO	3		
5.	<b>RAW POWER WIRING :-</b> Supply, laying of Circuite line 2 x 2.5mmsq. + 1 x 1 mmsq. PVC insulated copper wire form LDB to 6/16A or6 Amps Plug point. Also not that 03 Nos. 06 Amps Plug to be connected from one circuite line. Rest are same as item No. 1	MTS	300		
a	Supply, Fixing & connection of modular type 5 amps plug switch complete with circuit wiring 2 x 2.5 sqmm + 1 x 1 sqmm PVC insulated copper wire through 20mm dia PVC pipe & MS box Socket switch above table at 32"	NO	19		



Electrical Works

BOQ OF ELECTRICAL WORKS FOR UCO BANK, DUM DUM CANTONMENT BRANCH					
Sl. No.	PARTICULARS	UNIT	QTY.	RATE	AMOUNT
	height fr. Floor.				
	-Do- but 16 Amps. 6 pin socket with 16 amps switch for raw / PUS power point. (02 Nos. plug connected from one circuite) rest as item no. 1 (Ht. of plug point as per advice of consultant)				
	<b>TELEPHONE WIRING :-</b> Supply laying & connection of same as item no. 1 but with 2 pair 0.51 mmsq. Tinned CU. conductor through PVC regid ISI mark pipe from telephone point to Korne DB complete with RJ-11 telephone socket modular type in MS conceal box under table at 2" Ht. + one telephone point near NUB Rack	NO	6		
	Supply & fixing & connection of Cat-5 cable from VSNL D.B. to HUB rack through separate pipe for Pease line & ISDN line. (02 Line)	MTS	75		
	-Do- 10 pair .51 mmsq. Copper conductor telephone cable in 20mm dia PVC pipe from VSNL D.B. to 20 pair KORN connector.	MTS	75		
	Supply fixing & connection of 10 pair KRONE connector DB complete with PVC moulded Telephone DB box with locking system.	NO	1 SET		
	<b>SUPPLY, FIXING &amp; CONNECTION OF LIGHT FITTINGS WITH LAPM/FANS :-</b>				
	Supply Installation, testing & commissioning of 2'-0" x 2'-0" LED panel lights of Syska make (SSK-FP-6060-36W 6.5K/4K). To hang from true ceiling by 25 x 2 mm M.S. flat with nuts and bolt as required.	NO	20		
	Supply, Installation testing & commission of 15W 6" dia LED down light of Syska make (SSK-PA-2346E)				
	Supply, Installation testing & commissioning of LED T5 tube 4W 300mm T5 of Syska make (SSK-RA-0401-N) in cash and SW counter.	NO	18		
	225 mm dia heavy duty Exhaust fan 230 volt A.C. (EPC / Crompton make)	NO	2		
	Hi-speed wall mountings fan 400 mm dia 230 volt A.C. (Crompton / Orient)	NO	8		
	Ceiling fan 48" sweep 230 volt A.C. (Crompton / Orient) with "S" hook cutting plastering and cable connection complete.				

Electrical Works

BOQ OF ELECTRICAL WORKS FOR UCO BANK, DUM DUM CANTONMENT BRANCH					
Sl. No.	PARTICULARS	UNIT	QTY.	RATE	AMOUNT
	<b>UPS WIRING :</b> Supply, fixing & connection of UPS circuite line with 2 x 2.5 + 1 x 1.5 mmsq. Through MS conduit 20 mm dia 16 SWG wall tuckness, with ISI mark, to lay from UPS MCB DB to plug point board. Rest same as item no. 1 Two nos point to be connected from One circuite.	MTS	150		
	-Do- but 2 x 6/16, 6 pin socket with 2 x 16A switch to provide near HUB rack & line printer, ATM are to be connected from UPS power	NO	2SET		
	Supply, laying & connection of 4 x 6 mmsq. + 2 x 4 mmsq. PVC insulated copper conductor cable (FRLS) thorough PVC regid/flexible conduit from the UPS incoming MCB box to UPS.	MTS	50		
	Supply, fixing of 2 x 6 Amps 5 Pin socket + 1 x 16 Amps 6 pin socket in single board (under table) + 1 x 16A switch in another board above table as per direction (under table Ht 22")	NO	6SET		
	UPS incoming power to drawn by 6mm 4 core Cu. conductor PVC insulated armored cable with 2 nos. of bare copper wire of 14 SWG	MTS	55		
	Supply, installation & termination of 40 Amps DP MCB with Metal enclosure for UPS out going line (for 5 KVA 2 Nos. UPS unit)	NO	2		
	Supply & installation of UPS incoming 40 Amps 4 pole MCB MDS make in MS enclouser for Incoming line as per instruction of consultant.	NO	2		
	Supply, installation and termination of UPS outgoing power distribution system with 12 Way SPN DB comprising 8x10 Amps SP MCB & 40 Amps DP RCBO 300MA as main. MDS make IP-42 Double Door	NO	2		
	<b>LAYING OF CABLE :</b> Supply, laying & fixing main power with 50mmsq. 3.5 core PVC insulated, PVC sheated Alu. Conductor, 1100 V. grade armoured cable complete with 02 Nos. 8 SWG bear GI wire as running earth. (main power cable) & hardware	MTS	30		
	End termination of 50 mmsq. 3.5 core armoured cable complete with boss	END	4		

Electrical Works

BOQ OF ELECTRICAL WORKS FOR UCO BANK, DUM DUM CANTONMENT BRANCH					
Sl. No.	PARTICULARS	UNIT	QTY.	RATE	AMOUNT
	cable gland, Alu, Lug, PVC tape.				
	<b>Main DB's:-</b> Supply, fixing and connection of prefabricated ready made DB MDS make double door 6 way TPN MCB D.B. for power along with following complete : 6 way TPN MCB DB with 63A 4 pole MCB as main (POWER DB). 20A SPMCB – 8 Nos + 16A SPMCB – 5 Nos. + 10A SPMCB – 5 Nos. including Neutral Bar	NO	1SET		
	Supply, fixing and connection of prefabricated ready made D.B. MDS make double door 4 way TPN MCB D.B. for power along with following complete : 4 way TPN MCB DB with 40A 4 pole MCB as main (LIGHT DB). 10A SPMCB – 8 Nos. + 6A SPMCB – 4 Nos. Including Neutral Bar	NO	1 SET		
	150 x 100 mm enamel Danger board 440 volt. One board to fixed on D.B.	NO.	2		
	Supply, fixing and connection of 63A, 4 pole C/O switch with enclosure side handle operated for lighting DB	NO	1		
	Supply, fixing and connection of 63A 4 pole copper bus bar complete with 440 volt danger board & necessary materials.	NO	1		
	Supply, fixing and connection of 8" x 6" M.S. Box with 3 Nos. sliding fuse + 3 Nos. brass batten holder + 3 Nos. 15W lamp (Red, Yellow & Blue)	NO	2SET		
	Supply, fixing & connection with S.M. housing 4 pole 40A MCB for lighting on and off.	NO	1		
	<b>EARTHING STATION :-</b>  Earthing installation as per I.E. rule conforming to IS 3043-1987 or its latest amendent by making earth station with 600 x 600 x 3mm (minimum) ..... <u>N.B. – The Copper plate to be buried under 3.3 Mts. Depth from ground level, including C.I. Pit 300 x 300mm with necessary brick wall (For UPS earthing).</u>	NO	1 SET		
	Spike Earthing with G.I. Electrode 3 mts. Long x 50mm dia (Class-B) including accessories and providing masonry enclosure with cover 300 x 300mm plate having locking arrangement and watering funnel etc. with charcoal, sand & salt at alternate layer as required for electrical panel	NO	2		

Electrical Works

BOQ OF ELECTRICAL WORKS FOR UCO BANK, DUM DUM CANTONMENT BRANCH					
Sl. No.	PARTICULARS	UNIT	QTY.	RATE	AMOUNT
	earthing.				
	Supply laying 2 x 8 SWG copper bear wire from earth spike to main panal. (Electrolite wire)	MTS	50		
	Supply and fixing of earth bus bar of 25mm (W) x 3mm (Thk.) x 200 mm (L) complete with brass nut bolt washer – 4 nos. and bus insulator.	NO	2		
	Do but with 1 x 16mmsq. Insulated copper wire from earth spike to UPS earth bus bar through PVC regid 20mm dia ISI mark.	MTS	50		
	<b>Out door type Glow Sign Board wiring :-</b> Supply, laying of main line with 2 x 2.5 + 1 x 1.5 mmsq. Through PVC conduit from main panel to glow sign board	MTS	10		
	Supply installation of 16 amps DP MCB at main entrance Glow Sign board complete with timmer & contractor (2 NO + 2NC). 24 Hrs. in original housing	NO	1 SET		
	<b>A/C. electrification :-</b>	MTS	55		
1.	Supply, Installation, Testing & Commissioning of 1.5 TR, Hi-wall Spilt room A.C. unit with refrigerant copper pipong withinsulation upto5 Mts.anddrain pipingup to5 Mts.	Nos.	6		
2.	Supply, installation, Testing & Commissioning of 1.0 TR, Hi-wall spilt room A.C.unitwith refrigerant copper pipingith insulationup to5 Mts.andfrain piping up to5 Mts.(For CBS Room).	---	--		
3.	Supply, Installation, Testing & Commissioning of extra refrigerant copper piping with P.U. insulation.	MTS	12		
4.	Supply, Installation, Testing & Commissioning of extra drain pipingwith 20 mm PVC/HDPE pipe.	MTS	24		
5.	Supply, Installation, Testing & Commissioningof 4 way, TPN, IP-42,D.B. with 1 no. Pole, 63 A, incoming MCB and 9 nos.20 A. S.P. outgoing MCB.	Set	1set		
6.	Wiring with 2 x 4 sq.mm.and 1 x 1.5 sq.mm. PVC insulated sigle core copper flexiblewir in PVC conduit/casing for A.C. points.	MTS	90		
7.	Supply, Installation, Testing & Commissioning of single phase 7.0 Amp to 11.5 Amp. Starter in M.S.box.	Nos.	6		
	<b>Total</b>				

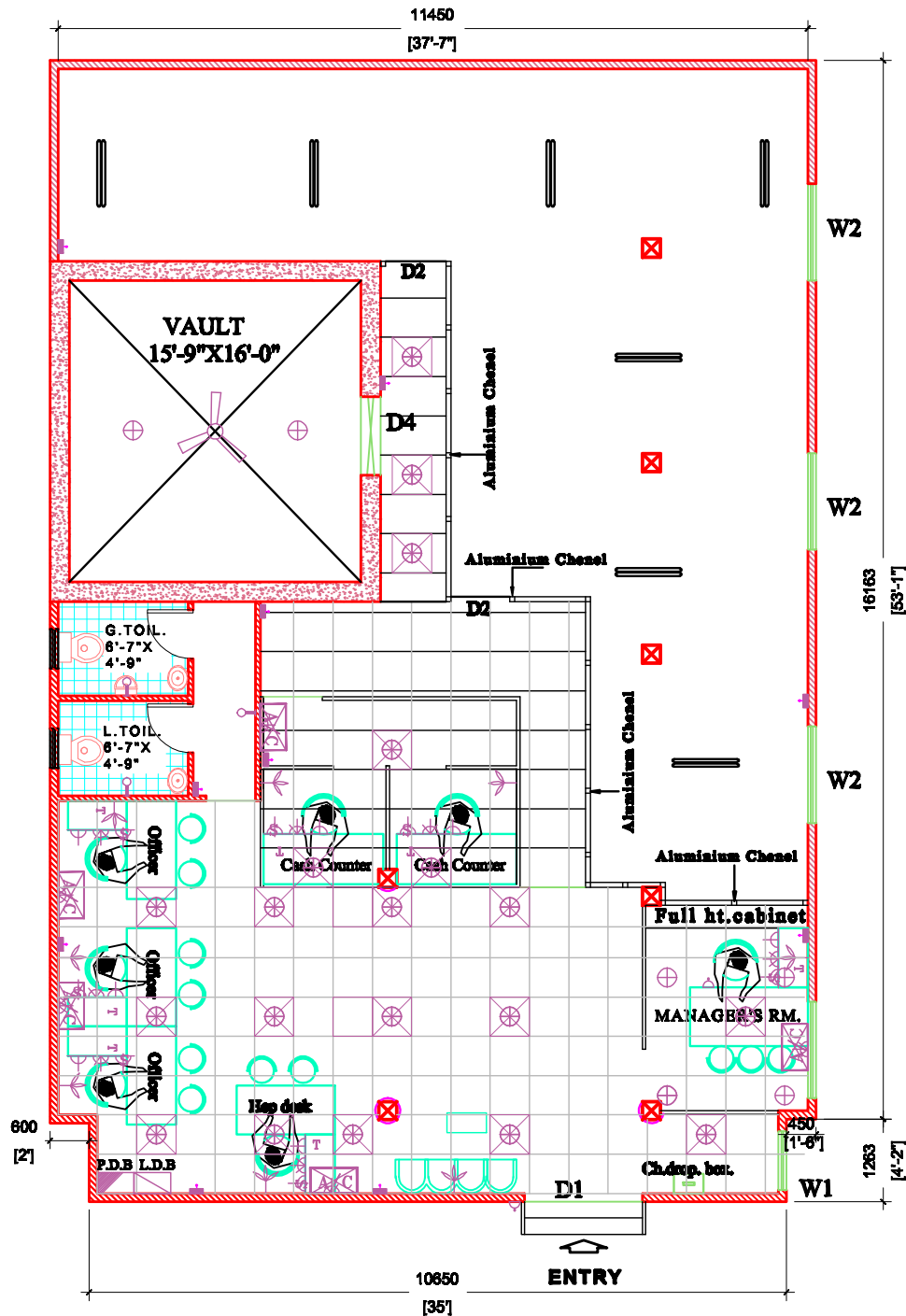

- Credle Point
- Tele Phone
- Ceiling Fan
- Jhar
- Single Bracket
- Ceiling Light
- 6x16 Amp. Power
- 6 Amp. Plug
- Switch
- Foot lamp
- Exhaust Fan
- Air Condition
- Switch Board
- Wall Fan
- T.V
- P.D.B
- Calling Bell
- Double Bracket
- Tube light
- L.D.B

**SCHEMATIC LAYOUT PLAN  
FOR PROPOSED UCO BANK  
DUM DUM CANTONMENT  
BRANCH SITUATED AT 1ST.  
FLOOR, MANUJENDRA  
DUTTA ROAD,  
KOLKATA-700028**

**AREA - 1260 SQ.FT.(APPROX.)**

**CONSULTING DEVELOPMENT SERVICES  
17, KALIBARI LANE JADAVPUR  
KOLKATA-700032  
(M) 9831664630/9330870022  
(O) 033- 24239590**

**UTPAL GANGULY  
B.A.R.C.H.M.C.A.A.I.I.A  
L.B.A.K.M.C.-CA/31/06482**