

ONLY EMPANELED VENDORS CAN APPLY

INVITATION TO TENDER

INSTRUCTION TO TENDERERS

AND

GENERAL CONDITIONS OF CONTRACT

FOR

PARTIAL RENOVATION , REPAIRING & MODIFICATION WORKS

AT

**UCO BANK –
FORT WILLIAM BRANCH & ATM**

NAME & ADDRESS OF THE CONTRACTOR:

.....

**NOTE: THE WORK SHOULD BE CARRIED OUT IN NIGHT SHIFT WITHOUT HAMPERING THE
WORKING OF BRANCH. THERE IS NO EMPTY SPACE IN THE BRANCH. WORKERS WILL
NOT BE ALLOWED TO STAY IN THE BRANCH. ALSO NOTE THAT IT IS A HIGHLY SECURITY
RESTRICTED AREA.**

ARCHITECTS

**DEARCH ARCHITECTS PRIVATE LIMITED
1/98, Naktala, PS: Patuli,
Kolkata – 700 047
CONTACT No.--+91-033- 6500-9098/9830018243**

CONTENTS

<u>SL NO</u>	<u>SECTION NO</u>	<u>DESCRIPTION</u>
1	I	Tender Notice
2	II	General rules and instructions for the guidance of the tenderer
3	III	Form of tender
4	IV	Articles of agreement
5	V	General conditions of contract with appendices.
6	VI	Special conditions
7	VII	Approved make of materials with bill of quantities for above mentioned works.
8	VIII	Summary

SECTION – 1

TENDER NOTICE

Sealed item rate tenders under two bid systems are invited on behalf of **UCO Bank, Zonal Office, Kolkata, 15/1A, Gariahat Road, 1st Floor, Kolkata – 700019** for the following work;

- a) Name of the Work: Partial Renovation, repairing & modification works of the UCO, Fort William branch & ATM.
- b) Location of Work: UCO Bank Fort William branch & ATM.
- c) Time of Completion: 40 days (Forty days)
- d) Earnest Money: Rs.15,000.00/- (Rupees Fifteen Thousand only) to be deposited in the form of Bank Draft/ Pay order drawn in favor of **UCO BANK payable at Kolkata**. [without Earnest Money in proper form Tender will be rejected]
- e) Cost of Tender document: Rs 1000 /-(Rupees One Thousand only) to be deposited in the form of Bank Draft/ Pay order drawn in favor of **UCO BANK payable at Kolkata**. [without Tender Cost in proper form Tender will be rejected]
- f) Availability of Tender Documents: Can be downloaded from bank's website from **24th May 2017 to 30th May 2017** (www.ucobank.co.in). No tender document shall be issued from the office of Zonal Office.
- g) Submission of tenders: At **UCO Bank, Zonal Office Kolkata, 15/1A, Gariahat Road, 1st Floor, Kolkata – 700019** till **02:00 pm on 31st May 2017**.
- h) Opening of Tender: At **03:30 pm. On 31st May 2017** at **UCO Bank, Zonal Office Kolkata, 15/1A, Gariahat Road, 1st Floor, Kolkata – 700019**.
- i) Mode of submission of Tender: The tender documents duly completed in all respect & accompanied with relevant enclosure/ annexure shall be sealed in an envelope of appropriate size & marked as **“Tender for Partial renovation, repairing & modification works for UCO Bank, Fort William branch & ATM”**. The tender documents should invariably include following among others: -
 - a) Envelope marked No.1: Envelope marked no 1 shall contain earnest money deposit, Cost of tender documents, Copy of empanelment with UCO Bank, pre-qualification forms, conditions of contract and technical specifications with covering letter furnished in the specified form.
 - b) Envelope marked no.2: Envelope marked no.2 shall contain the price bid and approved make of materials
 - c) Envelope no 3: Envelope marked no1&2 shall be put in a large envelope of adequate size marked no 3 which shall be properly sealed. This envelope, which shall be endorsed on the outside face.

j) Clarification, if any to be obtained from: **DEARCH ARCHITECTS PRIVATE LIMITED, 1/98, Naktala, PS: Patuli, Kolkata - 700047, CONTACT No- 033-6500-9098/ 9830018243**

k. Defect Liability Period: 12 months from the date of virtual completion of work.

l. Validity of tenders: Three calendar months from the date of submission of tender.

m. Sales Tax, Work Contract Tax or any other tax on materials or on finished work in respect of this contract whether in vogue or likely to be imposed in future, shall be payable by the Contractor and the Employer will not entertain any claim whatsoever in this respect at any time. Rates should include all these taxes ----- Etc. **Only service tax will be paid by the Bank as per Govt. laws. Tenderer must have valid service tax registration No & VAT registration No.**

n. Tenders in which any of the prescribed conditions are not fulfilled or are incomplete in any respect are liable to be rejected. Conditional tenders will be summarily rejected.

o. Delays in submission of tender arising out of the postal or any other irregularities at any stage will not be considered. The Bank will not be responsible for damage in transit incase of postal delivery/ courier service delivery.

p. The employer does not bind it to accept the lowest tender and reserves to itself the right to reject any or all the tenders received without assigning any reason/s thereof. The notification of award of contract will be made to the successful tendered in writing by the Bank.

Yours faithfully

For and behalf of UCO Bank

Sd/-

**Deputy Zonal Head
UCO Bank, Zonal Office, Kolkata,
15/1A, Gariahat Road, 1st Floor,
Kolkata – 700019**

SECTION – II

GENERAL RULES AND INSTRUCTIONS FOR THE GUIDENCE OF TENDERERS

Tenders are invited on behalf of **UCO BANK, ZONAL OFFICE KOLKATA**, for Interior, Civil & Electrical works at **Fort William branch & ATM** document consisting of the plans, specifications, bill of quantities and drawings of various classes of work to be performed and set of conditions of contract to be complied which can be downloaded from bank's website **www.ucobank.co.in**.

1. It is proposed that the intending tenderers may contact at the office of the Architects **M/S Dearch Architects Private limited, 1/98, Naktala, P.S: Patuli, Kolkata – 700 047**. The intending tenderer shall visit the site and make him self thoroughly acquainted with the local site condition, nature and requirements of the work, facilities of the work, facilities of transport condition, effective labour and materials, access and storage for materials and removal of rubbish etc.
2. As the entire work is to be completed in all respects within the stipulated period of **40** days and to achieve the target date of entire completion if be required/ essential, the work for day and night shifts have to be carried out by the tenderer/ contractor, for that at no extra cost, charges shall be paid to the contractor by the employer. While quoting rates, in addition to above, whether mentioned or not the rate shall always include the charges for day to day removal of debris/ spoils from site in conformity with the local Municipal rules. Bank's normal work shall not be jeopardized in any way for undertaking the work. Contractor shall include in his quoted rate for supplying the plastic sheets/ tarpaulin to cover Banks materials as protection against getting damaged either due to dust or water while executing the work. Tenders in only printed forms downloaded from the Bank's website should be placed in sealed covers & submitted. The tenderers should quote in figures as well as in words the rates, and amount. The language for filling tender documents shall be in English. The amount for each item should be marked out and requisite total given. The initials of the tenderers with the seal of the firm shall attest all corrections. In case any discrepancy /difference is found on checking between rates quoted by the contractor in words and figures or in the amount worked out by him, the following procedure shall be followed: -
 - a) When there is a difference between the rates in figures and in words, the rate, which corresponds to, the amounts worked out by the contractor, shall be taken as correct.
 - b) When the contractor does not work out the amount of any item or it does not correspond with the rate written either in figures or in words, then the rate quoted by the contractors in words shall be taken as correct.
 - c) When the rate quoted by the contractor in figures and in words tallies but the amount is not worked out correctly rate quoted by the contractor shall be taken as correct & not the amount.
 - d) Amendments as mentioned above shall be based on the tender marked original only.

4. Special care should be taken to write the rates in figures as well as in words and the amounts in figures only in such way that interpolation is not possible. Amount should be written in figures. In case of figures the words “Rs”. Should be written before the figures of rupees and words paise after the decimal figures, e.g. Rs 2.15 and in case of words, the word “Rupees” should precede and the word “Paise” should be written at the end, unless the rate is in whole rupees and followed by the words “only”, it should invariably be up to two decimal places. While quoting the rate in schedule of quantities, the word “only” should be written closely following the amount and it should not be written in the next line.
5. The acceptance of a tender will rest with the **Zonal Manager, UCO Bank, Zonal Office Kolkata, 15/1A, Gariahat Road, 1st Floor, Kolkata – 700019** which does not bind itself to accept the lowest tender and reserves to itself the authority to reject any or all the tenders received without assignment of any reason. All tenders in which any of the prescribed conditions are not fulfilled or incomplete in any respect are liable to be rejected. The bank reserves the right to accept the tender in full or in part and the tenderer shall have no claim for revision of rates or other conditions if his tender is accepted in parts.
6. Canvassing in connection with tenders is strictly prohibited and tenders submitted by the contractors who resort to canvassing will be liable to rejection.
7. An item rate tender containing percentage below/ above will be summarily rejected. However, when a tenderer voluntarily offers a rebate for payment within a stipulated period, this may be considered.
8. On acceptance of the tender, the name of the accredited representative(s) of the contractor who would be responsible for taking instructions from the Employer Consultant shall be communicated to the Employer /Consultant.
9. Sales Tax, Work Contract Tax or any other tax on materials or on finished work in respect of this contract whether in vogue or likely to be imposed in future, shall be payable by the Contractor and the Employer will not entertain any claim whatsoever in this respect at any time. Rates should include all these taxes ----- Etc.
10. No employee of the Employer is allowed to work as a Contractor for a period of two years of his retirement from Employer services, without the previous permission of the Employer. This contract is liable to be canceled if either the Contractor or any of his employees is found at any time to be such a person who had not obtained the permission of the Employer/ Consultant as aforesaid before submission of the tender or engagement in the Contractor’s service.
11. The tender for work shall remain open for acceptance for a period of 03 months from the date of opening of tenders. If any tenderer withdraws his tender before the said period, then the employer shall be at liberty to forfeit the earnest money paid along with the tender.
12. It will be obligatory on the part of the tenderer to tender and sign the tender in all pages of tender documents.
13. The Earnest money deposit of the contractor whose tender is accepted shall be forfeited in full in case he does not start the work by the stipulated date mentioned in the letter of award.

- 14 The Earnest money deposit of unsuccessful bidders will be refunded to them WITHOUT ANY INTEREST within 03 weeks from the date of award of work to the successful bidder.
- 15 A certificate of completion shall accompany the final bill from the consultant. Payment of final bill shall be made after deduction of retention money as specified which sum will be refunded in the manner as stated conditions. In acceptance of payments of the final bill by the contractor would indicate that he will have no further claim in respect of the work executed.

16 CLEARING SITE ON COMPLETION

On completion of the work the contractor shall clear away and remove from the site all constructional plant, surplus materials, rubbish and temporary work of every kind and leave the whole of the site and the work clean and in workmanlike conditions to the satisfaction of the employer /consultant.

17 TERMS OF PAYMENT

- a) 90% to be released after entire work is completed and handed over to the satisfaction and certification of the consultant.
- b) 10% to be released after the defect liability period of 12 months, without any interest

18 IDLE LABOUR

Whatever the reasons may be no claim for idle labour; additional establishment cost of hire and labour charges of tools and plants would be entertained under any circumstances.

19. LIQUIDATED DAMAGE

The delivery and installation should be adhered to as stipulated time, failing which; liquidated damages @ 01% per week or part thereof subject to maximum of 10 % of the total order value shall be levied.

20. TERMINATION OF CONTRACT BY EMPLOYER

If the contractor being a company go into liquidation whether voluntary or compulsory or being a firm shall be dissolved or being an individual shall be adjudicated insolvent or shall make an assignment or a composition for the benefit of the greater part, in number of amount of his creditors or shall enter into a deed or arrangement with his creditors, or if the Official Assignee in insolvency, or the Receiver of the Contractor in insolvency, shall repudiate the contract or, if a receiver of the contractor's firm appointed by the court shall be unable, within fourteen days after notice to him requiring him to do so, to show to the reasonable satisfaction of the Employer that he is able to carry out and fulfill the contract, and if so required by the Employer to give reasonable security there for, or if the Contractor shall suffer execution to be issued, or shall suffer any payment under this contract to be attached by or on behalf of and of the creditors of the Contractor, or shall assign, charge or encumber this contract or any payments due or which may become due to the contractor, there under or shall neglect or fail to observe and perform all or any of the acts matters of things by this contract, to be observed and performed by the contractor within three clear days after the notice shall have been given to the

UCO –FORT WILLIAM BR.**DEARCH ARCHITECTS (P) LTD.**

contractor observe or perform the same or shall use improper materials or workmanship in carrying on the work or shall in the opinion of the employer not exercise such due diligence and make such due progress as would enable the work to be completed within due time agreed upon and shall fail to proceed to the satisfaction of the employer after three clear days notice requiring the contractor so to do shall have been given to the contractor as hereinafter mentioned or shall abandon the contract, then and in any of the said cases, the employer may not withstanding previous waiver determine the contract by the notice in writing to the effect as hereinafter mentioned but without thereby affecting the powers of the employer of the obligations and liabilities of the contractor the whole of which shall continue in force as fully as if the contract had not been so determined as if the work subsequently executed had been executed by or on behalf of the contractor.

IF THE CONTRACT HAS BEEN TERMINATED THE EMPLOYER RESERVES THE RIGHT TO RECTIFY THE ITEMS AND COMPLETE THE JOB IN THE RISK AND COST OF THE TERMINATED VENDOR BY ANY OTHER APPROVED VENDOR.

SECTION –III
FORM OF TENDER

To

**The Deputy General Manager
UCO Bank, Zonal Office, Kolkata,
15/1A, Gariahat Road, 1st Floor,
Kolkata - 700019**

Sir,

Re: Partial Renovation, repairing & modification works of the UCO, Fort William branch & ATM.

- 1) I. /we refer to the tender notice issued by your consultants M/s. Dearch Architects Private Limited, Architecture, Interior design, HVAC, V-Sat, Me & P,BMD Consultants, 1/98, Naktala, PS: Patuli, Kolkata – 700047 on your behalf for Interior & Electrical work in connection with the above.
- 2) I/We do hereby offer to perform, provide, execute, complete and maintain the work in conformity with drawings, conditions of contract specifications, bill of quantities for the sum of Rs..... at the respective rates quoted in the schedule of quantities.
- 3) I/We have satisfied myself/ ourselves as to the site conditions, examined the drawings and all aspects of the site tender conditions. Subject to above, I/We do hereby agree, should this tender be accepted in whole or in part, to:
 - A: Abide by and fulfill all the terms and provisions of the said conditions annexed hereto:
 - B: Complete the work within **40**days, as stipulated in two or three shifts if considered necessary by the consultants at no extra cost to the Employer.
- 4) I/We have deposited earnest money of RS. _____ In the form of Crossed Demand draft / pay order /Banker's Cheque which, I/We note, will not bear any interest and is subject to forfeiture solely at Bank's discretion:
 - i) If the work is not commenced by me/us within 07 (seven) days from the date of issue of formal work order
 - Or
 - ii) If the offer is withdrawn within the validity period of acceptance.
 - iii) If the contract is not executed within 90 days from award of contract.
- 5) I/We understand that you are not bound to accept the lowest or any tender you receive.

- 6) The acceptance of this tender shall constitute a binding of any contract and any failure as mentioned in item 04. Above shall constitute a breach of contract by us and the tender accepting authority shall be entitled to have the work executed at our risk and to claim extra cost \ expenditure incurred by them from us.
- 7) Our Bankers
i)
ii)
iii)
- 8) Name of partners / directors of our firm :
i)
ii)
iii)
iv)

Yours Faithfully

Signature:

Name:

Designation:

SECTION –IV

ARTICLES OF AGREEMENT

Articles of agreement made the day of between the **UCO Bank, Kolkata Zonal Office, 15/1A, Gariahat Road, 1st Floor, Kolkata – 700019** (Hereinafter called the employer) which expression should include its successors and assignee of the one part and (Hereinafter called the contractor) of the other part, which expression should include its successor and assignee.

Whereas the employer is desirous of executing the Partial Renovation, repairing & modification works of the UCO, Fort William branch & ATM and has caused drawings and specifications describing the work to be prepared by M/s Dearch Architects Private Limited, 1/98, Naktala , P.S : Patuli, Kolkata – 700047 (hereinafter called the consultants) and whereas the said drawings, the technical specifications and the schedule of items and quantities have been signed by and on behalf of the parties hereto. And whereas the contractor has agreed to execute upon & subject to the conditions set forth herein & schedule of items & quantities, general conditions of contract, special conditions including other conditions etc. technical specifications & all correspondences exchanged by or between the parties from the date of tender notice till the award of work, both letters inclusive, (all of which are collectively hereinafter referred to as the said conditions) the work shown upon the drawings & or described in the said specification & included in the schedule of items & quantities at the respective rates therein set forth amounting to the sum as therein arrived at or such other sum as shall become payable there under (Hereinafter referred to as the said contract amount)

NOW IT IS HEREBY AGREED AS FOLLOWS:

1. In consideration of the said contract amount to be paid at the times in the manner set forth in the said conditions, the contractor shall upon and subject to the said conditions execute and complete the work shown upon the drawings and described in the said specifications and the schedule of items and quantities.
2. The employer shall pay the contractor the said contract amount or such other sum as shall become payable, at the times and in the manner specified in the said conditions.
3. The consultant in the said conditions shall mean the said M/S Dearch Architects Private Limited, 1/98, Naktala , P.S : Patuli, Kolkata – 700047 or in the event of their ceasing to be the consultant for the purpose if this contract for whatever reason such other person or persons as shall be nominated for that purpose by the Employer, provided always that the person subsequently appointed to be consultant under this contract shall be entitled to disregard or overrule any previous decision or approval or direction given or expressed in writing by the consultant for the time being.
4. The said conditions and appendices thereto shall be read and considered as forming part of this agreement and the parties here to shall respectively abide by, submit themselves to the said conditions and perform the agreements on their part respectively in the said conditions contained.
5. The plan agreement and documents mentioned herein shall form the basis of this contract.

6. This contract is neither a fixed lump sum contract nor a piece work in respect of the Partial renovation works at Fort William Branch & ATM as per the scope described and to be paid for according to actual measured quantities at the rates contained in the schedule of rates probable quantities or as provided in the said conditions.
7. The employer reserves to itself the right of altering the drawings and nature of the work by adding to or omitting any items of work or having portions of the same carried out without prejudice to this contract.
8. Time shall be considered as the essence of this contract and the contractor hereby agrees to commence the work on the day on which he is instructed to take possession of the site, or from the 7th day after the date of issue of formal work order as provided for in the said conditions whichever is later and to complete the entire work within **40** days subject nevertheless to the provisions for extension of time.
9. All payment by the Employer under this contract will be made only at UCO Bank, Zonal Office, Kolkata.
10. Any dispute arising under this agreement shall be referred to arbitration in accordance with the stipulation laid down in the general conditions of contract.
11. That the several parts of this contract have been read by the contractor and fully understood by the contractor.
12. This agreement can be terminated by either client on giving 03 months notice normally. However, in exigent circumstance, the services of the contractor can be terminated by giving notice of lesser period.

IN WITNESS WHEREOF the parties hereto have hereunto set their hands the day and year first above written.

Signed, and delivered by. ----- By the hands of MR----- (name and designation) it's-----and constituted attorney in the presence of

1. -----

2. -----

Address:

Address:

.....

.....

Witness

Signed and delivered by the hands of MR. ----- Partner of-----in the presence of

1. -----

2. -----

Address:

Address:

.....

.....

SECTION –V

GENERAL CONDITIONS OF CONTRACT

Except where provided for in the description of the individual items in the schedule of quantities and in the specifications and conditions laid down hereinafter and in the drawings, the work shall be carried out as per standard specifications and under the direction of the employer /consultant.

1. **Interpretation:** In construing these conditions, the specifications the schedule of quantities tender and Agreement, the following words shall have the meaning herein assigned to them except where the subject or context otherwise requires.

2. **Employer:** The term employer shall denote **UCO Bank, Kolkata Zonal Office, 15/1A, Gariahat Road, 1st Floor, Kolkata – 700019** or any of its employees representative authorized on their behalf.

3. **Consultant:** The term consultant shall mean M/S Dearch Architects Private Limited, 1/98, Naktala , P.S : Patuli Kolkata – 700047 or in the event of their ceasing to be consultant for the purpose of this contract such other persons /as the employer shall nominate for the purpose.

4. **Contractor:** The term contractor shall mean the individual or firm or company whether incorporated or not, undertaking the work and shall include legal representative of such individual of such firm or company or successors of such firm or company as the case may be m and permitted assigns of such individual of firm or company.

5. **Site:** The site shall mean the site where the work is to be executed at UCO, Fort William branch & ATM. It is a running branch job to be done at night itself.

6. **Drawings:** The work is to be carried out in accordance with drawings, specification, the schedule of quantities and any further drawings, which may be supplied, or any other instructions, which may be given by the employer consultant during the execution of the work. All drawings relating to work given to the contractor together with a copy of specification and schedule of quantities are to be kept at site and the employer /consultant shall be given access to such drawings or schedule of quantities wherever necessary.

In case any detailed drawings are necessary contractor shall prepare such detailed drawings and or dimensions sketches there for and have it confirmed by the employer consultant prior to taking up such work. The contractor shall ask in writing for all clarifications on matters occurring anywhere in drawings, specifications and schedule of quantities or to additional instructions at least 20 days ahead from the time when it is required for implementation so that the employer /consultant may be able to give decision thereon. The work shall mean the work to be executed or done under this contract.

7. **SCOPE:** The work consists of Interior, Civil & Electrical works for UCO BANK, Fort William branch & ATM. In accordance with the drawings, specifications and schedule of items and quantities. It includes furnishing all material, labour, tools and equipment and management necessary for and incidental to the construction and completion of the work. All work during its

progress and upon completion, shall confirm to the lines, elevations and grades as shown on the drawings furnished by the employer /consultant and to furnish by the employer/consultant. Should any detail essential for efficient completion of the work be omitted from the drawings and specification it shall be the responsibility of the contractor to inform the employer /consultants concurrence, so that upon completion of the proposed work the same will be acceptable and ready for use.

Employer/consultant may in their absolute discretion issue further drawings and or written instructions, details, directions and explanations which are here after collectively refereed to as the employer /consultants instructions in regard to:

- A: The variation on modification of the design, quality or quantity of work or the addition or omission or substitution of any work:
- B: Any discrepancy in the drawings or between the schedule of quantities and or drawings and or specification.
- C: The removal from the site of any defective material brought thereon by the contractor and the substitution of any other material thereof.
- D: The demolition removal and /or rejection of any work executed by the contractor /s
- E: The dismissal from the work of any persons employed thereupon.
- F: The opening up for inspection of any work covered up.
- G: The rectification and making good of any defects under clauses hereinafter mentioned and those arising during the maintenance period (retention period)

The contractor shall forthwith comply with and duly execute any work comprised in such employer/consultants instructions provided always that verbal instruction direction and explanations given to the contractor or his representative upon the work by the employer/consultant shall if involving a variation be confirmed in writing to the contractor within seven days. No work for which rates are not specifically mentioned in the priced schedule of quantities shall be taken up without written permission of the employer/consultant. The employer in consultation with the consultant shall fix rates of items not mentioned in the priced schedule of quantities.

8. DETAILED DRAWINGS AND INSTRUCTIONS: The employer through its consultant shall furnish with reasonable promptness additional instructions by means of drawings or otherwise necessary for the proper execution of the work. All such drawings and instructions shall be consistent with the contract documents true developments thereof and reasonably inferable there from.

The work shall be executed in conformity therewith and the contractor shall not work without proper drawings and instructions.

Immediately after receipt of the work order of the contract the contractor shall prepare a program schedule and submit the same to the employer through the consultant for approval which shall indicate the dates for the starting and completion of the various activities at the stages of construction.

9. COPIES FURNISHED: The contractor on the signing hereof shall be furnished by the employer through its consultant free of charge with a copy of the priced schedule of quantities rates, two copies of each of the said drawings and one copy of specifications and two copies of all further drawings issued during the progress of the work. Any further copies of such drawings required by the contractor shall be supplied on payment of the charges thereof by the contractor.

10. OWNERSHIP OF DRAWINGS: All drawing specification and copies thereof furnished by the employer through its consultant are the property of the employer. They are not to be used on other work, and with the execution of the signed contract set are to be returned to the employer on request at the completion of the work.

11. FAILURE BY CONTRACTORS TO COMPLY WITH EMPLOYERS /CONSULTANTS INSTRUCTION: If the contractor after receipt of written notice from the employer and or the consultant requiring compliance within ten days fails to comply with such further drawings and or employer /consultant instructions, the employer through the consultant or other persons, may employ other persons to execute any such work whatsoever that may be necessary to give effect thereto and pay all cost incurred in connection therewith and same shall be recoverable from the contractor by the employer on the certificate of the consultant as a debt or shall have right to deduct same from any money due or to become due to the contractor.

12. TENDERER SHALL VISIT THE SITE: Intending tenderer shall visit the site and make him self thoroughly acquainted with the local site condition, nature and requirements of the work, facilities of transport condition, effective labor and materials, access and storage for materials and removal of rubbish. The tenderer shall provide in their tender for cost carriage, freight and other charges including all taxes etc. as also for any special difficulties and including all taxes etc as also for any special difficulties and including police restriction for transport etc for proper execution of work as indicated in the drawings. The successful tenderer will not be entitled to any claim of compensation for difficulties faced or losses incurred on account of any site condition which existed before the commencement of the work or which in the opinion of the employer /consultant might be deemed to have reasonably been inferred to be so existing before commencement of work.

13. TENDERS: The entire set of tender paper downloaded from bank's website and should be submitted fully priced and also signed on the last page together with initials on every page. Initial/signature will indicate the acceptance of the tender papers by the tenderer.

The schedule of quantities shall be filled in as follows:

- i) The Rate column to be legibly filled in ink in both English figures and English words.
- ii) Amount column to be filled in for each item and the amount for each subhead as detailed in the schedule of quantities.
- iii) All corrections overwriting are to be initialed with the seal of the firm.
- iv) In case of any errors/omissions in the quoted rates, the rates given in the tender marked original shall be taken as the correct rates.

No modification writing or corrections can be made in the tender papers by tenderer.

The employer reserves the right to reject the lowest or any tender and also to discharge any or all of the tenders for each section or to split up each and every item should be correct, workable and self-supporting. If called upon by the employer consultant detailed analysis of any or all the rates shall be submitted. The employer/consultant shall not be bound to recognize the contractor analysis. The work will be paid for as measured work on the basis of actual work done and not as lump sum contract.

All items of work described in the schedule of quantities are to be deemed and paid as complete work in all respects and details including preparatory and finishing work involved, directly, related to and reasonably detectable from the drawings specification and schedule of quantities and no further extra charges will be allowed in this connection. In the case of lumpsum charges in the tender in respect of any item or work, the payment of such time of work will be made for the actual work done the basis of lumpsum charges as will be assessed to be payable by the employer consultant.

The employer has power to add to omit from any work as shown in drawings or described in specifications or included in schedule of quantities and intimate the same in writing but no addition, omission or variation shall be made by the contractor without authorization from the employer no variation shall vitiate the contract.

14. AGREEMENT: The successful contractor shall sign the agreement as per draft agreement within **07 days** from the date of issue of formal work order and he shall pay for all stamps and legal expenses, incidental thereto. However the written acceptance of the tender by the employer /consultant on behalf of employer will constitute a binding contract between the employer and the person so tendering whether such formal agreement is or is not subsequently executed.

15. ROYALTIES & PATENTS: The contractor shall pay all royalties and license fees. He shall defend all suits or claims for infringement of any patent rights and shall save the employer harmless from loss on account thereof.

16. PERMITS AND LICENCES: Permits and licenses for release of materials which are under government control will be arranged by the contractor. The employer will render necessary assistance, sign any forms or applications that may be necessary.

16. GOVERNMENT AND LOCAL RULES: The contractor shall confirm to the provisions of all local to the provisions of all local byelaws and acts relating to the work and to the regulations etc. of the government and local authorities and of any company with whose system the structure is proposed to be connected. The contractor shall give all notices required by the said act, rules, regulations and bye laws etc and pay all fees payable to such authority for execution of the work involved. The cost, if any shall be deemed to have been included in his quoted rates, taking into account all liabilities for licenses, fees for footpath encroachment and restorations etc. and shall indemnify the employer against such liabilities and shall defend all actions arising from such claims or liabilities.

17. TAXES AND DUTIES: The tenderers must include in their tender prices quoted for all duties, royalties, excise, sales tax, work contract tax or any other taxes or local charges if applicable. No extra claim on this account will in any case be entertained.

18. QUANTITY OF WORK TO BE EXECUTED: The quantities shown in the schedule of quantities are intended to cover the entire new structure indicated in the drawings but the employer reserves the right to execute only a part or the whole or any excess thereof without assigning any reason therefore. If at any after the commencement of the work, the employer consultant shall for any reason whatsoever not require the whole work thereof as specified in the tender to be carried out the consultant employer shall give notice in writing of the fact to the contractor who shall have no claim to any payment for compensation whatsoever on account of any profit or advantage with which he might have derived from the execution of the work in full, but which he did not derive in consequence of the full amount of the work not having been carried out, neither shall he have any claim for compensation by reason of any alterations having been made in the original specification ,drawings ,designs and instructions which shall involve any curtailment of the work as originally contemplated.

19. EARNEST MONEY/ SECURITY DEPOSIT & RETENTION MONEY: The tenderer will have to deposit an amount of Rs 15,000.00/- in the form of crossed demand Bank Draft/Pay Order/Banker's cheque drawn in favor of UCO payable at Kolkata from any nationalized Bank at the time of submission of tender as an earnest money. The employer is not liable to pay any interest on the earnest money. The earnest, money of the unsuccessful tenderers will be refunded without any interest 21 days after the award of work or after the expiry of the validity period of the tender, whichever is earlier. In respect of the Successful Tenderer, Earnest money deposited at the time of submission of tender shall be retained as security deposit & returned to the vendor after successful completion of the works.

Retention money @ 10 % will be deducted from final bill of the accepted value of the tender. This retention money shall be refunded to the successful contractor without any interest 14 days after successful completion of the defects liability period of 12 months provided the contractor has satisfactorily carried out all the work and attended to all defects in accordance with the condition of the contract. In case the contractor fails to do so appropriate amount shall be deducted by the Bank from retention money.

20. CONTRACTOR TO PROVIDE EVERYTHING NECESSARY: The contractor shall provide everything necessary for the proper execution of the work according to the intent and meaning of the drawings, schedule of quantities and specifications taken together whether the same may or may not be particularly shown or described therein provided that the same can reasonably be inferred there from and if the contractor finds any discrepancies therein the shall immediately and in writing refer the same to the employer /consultant whose decision shall be final and binding . The contractor shall provide himself for ground and fresh water for carrying out the work at his own cost. The employer shall on no account be responsible for the expenses incurred by the contractor for hired ground of fresh water obtained from elsewhere.

The rates quoted against individual items will be inclusive of everything necessary to complete the said items of work within the contemplation of the contract, and beyond the unit price no extra payment will be allowed for incidental or contingent work, Labour and /or materials inclusive of all tax and duties whatsoever except for specific items, if any stipulated in the tender documents.

The contractor shall supply fix and maintain at his own cost for the execution of any work all tools tackles machinery's and equipment's and all the necessary centering, scaffolding, staging, planking, timbering, strutting, shoring, pumping, fencing, boarding, watching and lighting by night as well as

by day required not only for the proper execution and protection of the public and safety of any adjacent roads, streets, walls houses buildings all other erections matters and things and the contractor shall take down and remove any or all such centering ,scaffolding, planking ,timbering etc shall be required or when so to do and shall fully reinstate and make good all matters and things disturbed during the execution of work to the satisfaction of the employer /consultant.

21. TIME OF COMPLETION, EXTENSION OF TIME AND PROGRESS CHART

A. Time of completion: The entire work is to be completed in all respects within the stipulated period of **40** days, from the date of issue of formal work order. Time is the essence of the contract and shall be strictly adhered to by the contractor.

The work shall not be considered as complete until the employer consultant have certified in writing that this has been completed and the defects liability period shall commence from the date of such certificate. **The work should be carried out in the night shift without hampering the working of branch. There is no empty space in the branch. Workers will not be allowed to stay in the branch. Also note that it is a highly security restricted area. All type of laboures should have Identity Card approved by the Fort William authorities.**

B. PROGRAMME CHART TO BE PROVIDED: During the period of construction the contractor shall maintain proportionate progress on the basis of the program chart submitted by the contractor immediately before commencement of work and agreed to by the employer consultant.

22. CLEARING SITE AND SETTING OUT WORK: The site shown on the plan shall be cleared of all obstruction, loose stone and materials rubbish of all kinds.

23. MATERIALS WORKMENSHP, SAMPLES, TESTING OF MATERIALS: All the materials specified to be maintained and the contractor shall have to carry out tests on materials and workmanship in approved materials testing laboratories or as prescribed by the employer.

24. REMOVAL OF IMPROPER WORK: The employer consultant shall during the progress of the work have power to order in writing from time to time the removal from the work within such reasonable time to times as may be specified in the order of any materials which in the opinion of the employer consultant are not in accordance with specifications or instruction .In case the contractor refuses to comply with the order the employer consultant shall have the power to employ and pay other agencies to carryout the work and all expenses consequent thereon or incidental thereto as certified by the employer consultant shall be borne by the contractor or may be deducted from any money due to or that may become due to the contractor .No certificate, which may be given by the consultant, shall relieve the contractor from his liability in respect or unsound work or bad materials.

25. MEASUREMENT: The consultant shall from time to time intimate to the contractor that he requires the work to be measured, and the contractor shall forthwith attend or send a qualified agent to assist the consultant or the consultants representative/employers representatives in taking such measurements and calculations and to furnish all particulars or to give all assistance required by either of them.

26. ACTION WHERE NO SPECIFICATION: In the case of any class of work for which there is no such specification in technical specification, such work shall be carried out in accordance with the I.S. specification and in the event of there being no I.S. specification, then in such case the work shall be carried out in all respect in accordance with the instructions and requirements of the consultant /employer.

27. CONTRACTOR NOT TO DEPOSIT MATERIALS IN A MANNER THAT MAY CAUSE INCONVENIENCE TO THE PUBLIC: The contractor (s) shall not deposit materials on any site, which will seriously cause inconvenience to the public. The Consultant may require the contractor to remove any materials, which are considered by him to be a danger or inconvenience to the public or cause them to be removed at the contractor's cost.

28. PAYMENTS

- a) All bills shall be prepared by the Contractor in the form prescribed by the Employer/Consultant, format enclosed. In the bill it has to be shown deductions for all previous payments, retention money, etc. Advance / adhoc payment for work actually executed will not be normally made. However, adhoc payment may be made at the discretion of Consultant /Employer in case of exigency.
 - b) The Consultant /Employer shall issue a certificate after due scrutiny of the Contractor's bill stating the amount due to the Contractor from the Employer and the contractor shall be entitled to payment thereof, by the Employer.
29. The contractor shall work in close co ordination with other agencies to avoid rework/damage and ensure timely completion.
30. Any damage to the work before the building is handed over is to be replaced or made good at the contractor expense to the entire satisfaction of the consultant.
31. The quantities indicated are subject to change .The payment of the bill will be made as per actual measurement at site and will be certified by the Consultant and cleared by the employer.
32. The tender shall sign each and every page of the tender documents including the drawings attached hereto.
33. The consultant shall have power to insist to the contractor to submit the sample /color/ test certificate from any Govt. Authorized agent of any materials to be used in the work, where the expenditure is to be borne by the contractor.
34. 10% of the total value of work will be retained as retention money from Contractor's final bill which shall be released without any interest after the defect liability period of twelve months provided the contractor has satisfactorily attended to all defects if any, in this period.
35. In case of any dispute the matter will be referred to the Dy. General Manager, Head Office, Kolkata for an arbitration, whose decision shall be final and binding on both parties.
36. For litigation if any arising there of, the competent court at Bombay alone will have jurisdiction.

SECTION VI

SPECIAL TERMS AND CONDITIONS

1. Name of the work : Partial Renovation, repairing & modification works of the UCO, Fort William branch & ATM.
2. Location : UCO Fort William branch & ATM.
3. Scope of Work : As in 1 & 2 above and as further detailed in instruction to Tender
4. Date of Commencement : Within 07 (seven) days from issue of work order.
5. Defect liability period : 12 (Twelve) months from the date of completion certificate Issued by the consultant/employee.
6. Earnest Money : Rs. 15,000.00 /-
7. Initial security deposit : Initial security deposit amount will be same as EMD amount which will be refunded after satisfactory completion of work.
8. Limit of variation : No extra /additional work should be carried out by the contractors without prior consent approval. Any sample to be made shall be at your cost for approval.
9. Validity of the tender : 03 (Three) months after opening the tender
10. Insurance : Successful contractors shall have to take out statutory labour laws, workmen compensation Act, Insurance policy/ Comprehensive Insurance policy for the duration of the work covering all aspects such as fire hazards, earthquake, third party risk etc. They should submit receipt of premium paid to the UCO BANK, Kolkata Zonal Office prior to commencement of the work.
11. Completion time and Liquidated Damage : The entire job will be completed within 40 days (Forty days) from the date of the work order. In the event of your failure to complete the work In all respects including site clearance and Reinstatement of damaged proportion within The stipulated time. Liquidated damage @ 01% per week of delay or part thereof shall be levied subject to a maximum of 10% of the total order value.
13. Return of EMD to unsuccessful: The Earnest money deposit of Bidders unsuccessful bidders will be refunded to them WITHOUT ANY INTEREST within 21days from the date of award of work to the successful bidder.

13. Force Majeure: Any delay in or failure of the performance of either part hereto shall not constitute default hereunder or give rise to any damage, if any, to the extent such delay or failure of performance is caused by occurrences such as Acts of god or an enemy, expropriation or confiscation of facilities by Government authorities, Acts of war, rebellion, sabotage or fires, floods, explosions, riots or strikes. The contractor shall keep records of the circumstance referred to above and bring these to the notice of the Engineer-in-charge/site – In charge in writing immediately on such occurrences. The amount of time, if any, lost on any of these counts shall not be counted for the contract Period. One decision of the owner arrived. At after consultation with the contractor, Shall be final and binding. Such a determined period of time shall extended By the owner to enable the contractor to complete the job within such extended period of time. If the contractor is prevented or delayed from performing any of his obligations under this agreement by force majeure, the contractor shall owner the circumstance constituting the force majeure and the obligations, performance of which is thereby delayed or prevented, within Seven days of the occurrence of the events.

CERTIFICATE

1. The Measurement on the basis of which the above entries for the running bill no..... were made have been taken jointly on.....and are recorded at pagestoof measurement book no.....

2. The work recorded in the above mentioned measurement has been done at the site satisfactorily as per tender drawings, conditions and specifications.

Signature of the contractor Signature of the consultant Signature of the Employer

Date:

Date:

Date:

Place:

Place:

Place:

We hereby certify that an amount of RS..... (Rupees.....) may be paid to M/Sagainst their bill no Dated.....subject to verification of all other previous payments, if any made to them on this account, cost of materials supplied to the contractor , if any ,and income tax and any other tax deduction as per rule .The Total payment including this should not, however, exceed RS.....

SIGNATURE OF CONSULTANT

PROFORMA FOR APPLICATION FOR EXTENSION OF THE TIME PERIOD

1. Name of the contractor:
2. Name of the work as given in the agreement:
3. Estimated tender amount:
4. Date of commencement of work as per agreement:
6. Period for which extension of time availed previously:
7. Period for which extension is applied for:
8. Hindrances on account of which present extension is applied:
 - a) Nature of hindrance:
 - b) Date of occurrence:
 - d) Period for which it is likely to last:
 - e) Remarks if any:
9. Extension of time required for extra work if any:
11. Details of extra work and the amount involved:
12. Proportionate period of extension of time on estimated amount put to tender:
13. Total extension of time required for 07 & 09:
Submitted to the consultant/ employer

.....

Date.....

Signature of the contractor
Date:

LIST OF APPROVED MATERIALS FOR CIVIL & FURNISHING WORK

<u>SN</u>	<u>ITEMS</u>	<u>APPROVED MAKE</u>
1	False Ceiling / Channels	India Gypsum
1.a)	Grid Ceiling	Armstrong
2	Wood Frame Work / Wood Section : All Wood must be well seasoned, free from knots, other defects decay and defects due to handling and transportation. Wherever necessary, provide with anti – termite Treatment.	Malaysian Sal/Kapoor
3	Wood Skirting / Molding / Lipping / Bidding	White Beach / White Ceader/Teak Wood
a)	Door frame :	Teak wood /Sal Wood
4	Wood Preservative :	STP Pentaphene Pale / Termiseal by PCI / Bison by British Paint
5	Fire Retardant Paint	Industrial grads of Noble / Viper
6	BWR Ply / BWP Block board with ISI mark	Avenger Ply / Green /Century/Satabdi Ply
7	Flush Door	Avenger Ply / Green /Century/Satabdi Ply
8	Laminate (1.0mm thk.)	Sunmica (E-758/1758,1756) / Euromica / Green lam /Merino / Century mica / Royal Touch
9	Door Closure (Heavy Duty)	Godrej / Archi / Sterling (DC 2000)
10	Floor Spring (Heavy Duty)	Godrej / Archi / Sterling (FS 3000)
11	Door Lock (Dead)	Godrej/ Hafele/ Hettich/ Kich/ Doorset/ 4C Acme (ML– REG– SS)
12	Door Handles ('H' Shape)	Godrej / Hafele /Hettich / Kich / Doorset / 4C Acme (PHG – HSS)
13	Drawer / Storage Handle (4”/ 6”)	Kich /Neki / Hassley/EGL (HMS –B – 9122 / 9123)
14	Drawer / Storage Lock (Multipurpose)	Ebco / Hafele /Hettich /Doorset /Godrej/Kombo (502)
15	Night latch	Godrej / 4C Acme (RL – MACHO – OS – SS)
16	Screws	GKW / Nettle fold
17	Hinges	CIEF
18	Sliding Telescopic Drawer Channel	Ebco / Kombo
19	Key Board Tray (Metal)	Ebco / Innofitt Systems (KD 510. M)
20	Telescopic CPU Stand (Metal)	Ebco / Innofitt Systems (CPU MST)
21	Cable Organizer	Ebco / Innofitt Systems (CM 63.C)
22	Adhesive	Fevicol SH / Fevimate TL/ShaktiBandhan
23	Aluminum Door Frame	Jindal
24	Soft Board	Jolly Board
25	Vertical Blinds	Mac / Annums / Window Fashion
26	Glass	Modi /Ashai / Saint Gobain
27	Paints (Synthetic Enamel / Acrylic Emulsion)	Asain Paints (Colour World) / Berger(Colour Bank)

28	PVC Flooring	Krishna Vinyl / Armstrong / LG
29	Texture Paint	Spectrum
30	Mirror	Modi / Ashai / Saint Gobain
31	European WC / Washbasin	Hindware / Parryware
32	Sanitary Fittings	Jaquar / Essco Delux
33	G.I. Pipe	Tata (Medium) / Jindal / Bansal
34	Cement	Ambuja/ Lafarge / ACC
35	Footmat	Birla 3M / Approved Equivalent
36.	Vitrified Tiles	Naveen / Jhonson/Euro
37.	Rectified Ceramic Tiles	Johnson / Naveen/Kajaria
38.	Chairs	Godrej/Methodex/Monarch
39	ACP (Exterior grade/Interior grade)-3mm & 4mm	Alu Décor/ Euro Bond/Alu Bond
40.	Patch Fittings	DORMA
41.	Anti Termite	PCI
41	All other items not covered above	As per sample approved by Employer/Consultant

LIST OF APPROVED MAKE OF MATERIALS FOR ELECTRICAL WORKS

<u>SN</u>	<u>ITEMS</u>	<u>APPROVED MAKE</u>
1	MS pipe ISI mark. 16 SWG	BEC / NIC
2	M.S. fittings (Bend / Elbow / G.I Saddle / 3way circular box)	BEC / NIC
3	Wire PVC insulated copper flexible wire. (FRLS)	Finolex / R.R. Kable / Polycab/Havells
4	A.C. starter	North – West / Crabtree/ MDS Legarand
5	250 Volt 6 Amp Piano reed type switch, socket, modular plate	Kolors/ Anchor
6	250 Volt 6/16 Amps. 3 pin modular type switch, socket	Crabtree / ABB / MDS Legrand / Siemens
7.	Relay	ALSTOM / L & T
8.	Capacitor	Mamal / L&T
9.	Current Transformer	Kappa / L&T / Schneider (CG) A.E.
10.	Changeover Switch	L&T/ HPL / GEC / Havells
11.	Amps meter & Voltmeter. 96 x 96 mm (Analog)	AE / IMP / L&T ALSTOM/ HPL / Havells
12.	Miniature Circuit Breaker & MCB Distribution Boards, RCBO	MDS / ABB / L&T (Hager) / Schneider (CG) / Siemens / LK fuga / Havells
13.	Armoured Cable	NICCO / Fort Gloster / Havells/ CCI/ Polycab
14.	Telephone Socket RJ - 11	Crabtree / ABB / MDS
15.	Telephone Cable (0.51 mmsq) 10/20 pair	National / Delton / Netco / Finolex / Retco
17.	Lugs	Dowells
18.	Terminal Connector	ESSEN
19.	SFU / SPN / TPN Sheet metal housing / Open	L & T / Siemens / Havells

	execution front handle with housing	
20.	Telephone Connector	KORN type
21.	Selector Switch (Rotary type)	Kaycee / A.E./ L& T/ Siemens
22.	Rigid PVC Conduit	Polycab / AKG / Precesion
23.	Sliding fuse / DZ fuse	Bharat Lender / BCH
24.	PVC casing (20 mm)	Precesion / Supreme / Oriplast/Polycab
25.	Clock switch / Time switch	L & T/ MDS / GIC / T & C
26.	PVC Tape	Steel Grip / Anchor
27.	Join box (6" x 4" MS box) heavy type	Local Make
28.	Call Bell	Anchor / Max / Roma
29.	Brass cable gland	Arun (heavy type) / Dowells
30.	LED Indicator (bright type)	Mikadov / L&T / MDS
31.	PVC Flexible pipe	Hanuman / Precesion /AKG/Polycab
32.	Metal Clad socket & plug having scraping earth arrangement	Siemens / L& T/ MDS / Schneider
33.	MCCB	Siemens / L& T/ MDS / Havells
34.	Light fittings	Havells/Wipro / approved equivalent
35.	Exhaust Fan	E.P.C / G.E.C / Crompton
36.	Wall mounting (Osylating Type) Pedestal Fan	Orient / Crompton / Khaitan
37.	All other items not covered above	As per sample approved by Employer/ Consultant

NOTE: The contractor shall use only above mentioned material or equivalent make to be approved by the Consultant. All other materials shall confirm to the specifications laid down. The tenderer shall take this into account while tendering rates / prices. The Consultant/Owner has got every right to select any of the above Makes for the Project. However Owner/Consultant before Execution shall be approved the samples of every material including all fixing accessories.

Summary

FOR UCO BANK –FORT WILLIAM BRANCH AND ATM

CIVIL WORKS FOR BRANCH. - A	Rs
FURNISHING WORKS FOR BRANCH. - B	Rs
ELECTRICAL WORKS FOR BRANCH. - C	Rs
FURNISHING WORKS FOR ATM. - D	Rs
ELECTRICAL WORKS FOR ATM - E	Rs
TOTAL	RS

(Rs.)

Date:

SIGNATURE OF THE CONTRACTOR

Date:

SIGNATURE OF THE ARCHITECT

Date:

**SIGNATURE OF THE
ZONAL MANAGER, UCO BANK,
ZONAL OFFICE, KOLKATA.**

BOQ OF CIVIL WORK FOR UCO BANK ,FORT WILLIAM BRANCH

SL NO.	PARTICULARS	UNIT	QTY	RATE	AMOUNT
A	CIVIL:				
1	SYNTHETIC ENAMEL PAINT FOR WINDOW GRILL, ROLLING SHUTTER & COLLAPSEABLE GATE				
	Providing and applying 2 coats synthetic enamel paint on window grill,rolling shutter and collapsible gate.Before putting final paint scrapping,leveling,preparing the surface and 2 coats primer to be done.The wall to be completed as per the direction of architect.	SFT	1231		
2	PAINTING				
	Providing and applying Acrylic emulsion paints after removing the damaged plaster , applying wall putty 1.2mmthk. to make the necessary smoothness , repairing all damages . Then two coats of Primer of approved make to be applied finished with two or more coats where ever necessary as per Architects instructions of acrylic emulsion paints .The work to be completed as per approval and satisfaction of the Architect.	SFT	4970		
3	VITRIFIED TILES				
	Providing and fixing 2'-0" x 2'-0" vitrified tiles on existing floor using chemicals (approved brand). complete with bi - colours tiles with design and flower pattern/Motiff as per design.The rate is inclusive of Chemicals,backing materials,joint filling compound.The work to be completed in all respect as per design,direction and approval of the Architect.Tiles Basic rate: 60.00/Sft	SFT	250		
a	Skirting (4")	Rft	50		
4	SANITARY ITEM - IVORY				
a	Providing and fixing EWC of Hindware with all accessories like toilet seats Bestolite type,'P'/'S' trap and cistern with all necessary inner fittings and the interconnection all complete.	Nos	2		
b	Providing and fixing Wash basin of 550 x 400 with all internal fittings etc , chain plug and padestal colour Ivory all complete.	Nos	1		
c	Providing and fixing angular stop cock ESSCO S.S. finish	Nos	5		
d	Providing and fixing Bib cock ESSCO S.S. Finish	Nos	2		
e	Providing and fixing Pillar cock ESSCO S.S. finish	Nos	1		
f	Providing and fixing C.I. floor trap	Nos	2		
g	Providing and fixing 5" CP grating	NOS	2		
h	Providing and fixing Soap dispenser	Nos	1		
i	Providing and fixing Towel ring	Nos	1		
j	MIRROR FOR TOILET SIZE 2' -0" x 3'-0"				
	Providing and fixing mirror in toilets made out of 6mm thk. Machine polish glass all over edges mounted over 1/2" thk. Marine ply. The mirror shall be fixed with 1" dia s.s stud.The work to be completed in all respect as per design,direction and approval of the Architect.	Nos	1		
k	Paper holder	Nos	2		
l	Twin peg coat hook	Nos	2		
m	Providing and fixing Flatback Urinal with Partition ,ivory colour	NOS	1		
n	Providing and fixing 3/4" heavy quality of ISI make full way gun metal/ Pit Valve	NOS	5		
5	Removing existing cement mortar from ex-isting walls,raking joints to receive new plas-ter and providing new plaster with Sika latex chemical in 4:2:1 and carting away the debris from site.The rate is inclusive of using blue lamp if necessary.	SFT	500		
TOTAL - A					

NOTE:ALL RATES ARE INCLUSIVE OF DISMANTLING NECESSARY EXISTING ITEMS , REMOVAL AND DISPOSAL FROM SITE TO THE MUNICIPAL DUMPING GROUND.

BOQ OF ELECTRICAL WORKS FOR UCO ATM AT FORT WILLIAM BRANCH

SL.	DESCRIPTION OF WORK / ITEMS	Qty	Unit	Rate	Amount
	Part 1 : light point wiring				
1	Supply,laying, connection &testing of light, point, wiring by 2x1.5mmsq(2x3/.029) + 1x1mmsq PVC insulated copper flexiable wire maintating the colour code as per direction in pre laid PVC conduite of 20mm with ISI mark 1.5mm wall thk. to conceal in wall partition mending good the damage,complete with pvc circular box, bend to be done as per drawing including 3 point ceiling rose wherever required. pvc saddle to be used for fixing,				
a)	Lighting point				
	Point - 1 Light point control by 01 switch.	2.00	Nos		
	Point - 2 Light point control by 01 switch.	3.00	Nos		
b)	single light point to connect from UPS power complete with modular switch plate and M.S. box connect from UPS DB	1.00	No.		
c)	Supply Laying of main Circuite line2x2.5mmsq +1x 1.5 mmsq PVC insulated copper wire maintainning the colour code.	37.00	Mts		
	Total Of Part 1				
2	SUPPLY, FIXING & CONNECTION of LIGHT FITTINGS with Lamp :				
a)	Supply Installation, testing & commissioning of 34W PLUTO NEO 2'-0"x2'-0" LED panel lights of Havells make . To hang fronm true ceiling by 25x3 mm M.S flat with nuts and bolt as required.	2.00	Nos.		
b)	Supply,Instrallation testing & commissioning of 12W 6" dia LED down light of Havells make 5700K (ENDURA DL 12 NEO).	6	Nos.		
c)	Supply,Installation, testing & commissioning of 4'-0" long 22W TL LED tube light of Havells make.	1	Nos		
	Total Of Part 2.				
3	Part : 3, UPS WIRING :				
a)	Supply fixing & connection of UPS circuite line with 2x2.5+1x1.5mmsq through pvc conduite 20mmdia 16 SWG wall tickness, with ISI mark, to lay from UPS MCB DB to plug point board.rest same as item no.1 Two nos separate circuite to be drawn.	35.00	Mts		
b)	- Do - but 2x6/16, 6pin socket with 2nos.16A switch to provide behind ATM at 12" ht. from FFL. to be connected from UPS power.	2.00	Set		
c)	Supply , installation & tremination of 40 Amps DP MCB with Metal enclouser for UPS incoming/out going				

	Line.	2	No.		
	Total Of Part 3.				
4	Out door type Glow Sign board :-				
a)	Supply laying of main line with 2x2.5 +1x1.5				
	mmsq through MS conduite from main panal				
	to glow sign board.	15.00	Mts		
b)	Supply installation of 16 amps DP mcb at main				
	entrance Glow sign board complete with timmer& contractor				
	(2NO + 2NC) 24 Hrs in orginal housing.(230V,A.C Coil)	1.00	Set		
	Total Of Part 4				
5	EARTHING STATION :				
a)	SpikeEarthing with G.I. Electode 3mts. Longx50				
	mm dia (Class - B) including accessories and				
	providing masonary enclosure with cover				
	300x300mm plate having locking arrangement				
	and watering funnel Etc. with charcoal,				
	sand & salt at alternate layer as required				
	for electrical panel earthing.	1.00	Nos.		
b)	Supply, laying of 10sqmm single core PVC insulated copper				
	flexible wire for atm Machine separate earh.	22.00	Mts		
	Total Of Part 5.				
6	Main DB's (one for power and one for UPS)				
a)	Supply,fixing and connection of prefabricated ready				
	made D.B MDS make double door 6way				
	SPN MCB D.B. for Light along with following complete:				
	6way SPN MCB DB with				
	32A DP MCB as main .				
	16A SPMCB - 4Nos +6 A SPMCB - 2 Nos.				
	including Neutral Bar.	1.00	Set		
b)	Supply,fixing and connection of prefabricated ready				
	made D.B MDS make double door 4way				
	TPN MCB D.B. for Light along with following complete:				
	4way TPN MCB DB with				
	40A TPN MCB as main .				
	16A SPMCB - 4Nos +10A SP MCB - 4no, 6 A SPMCB - 4Nos.				
	including Neutral Bar.	1.00	Set		
	Total Of Part 6.				
7	Part : 8, LAYING OF CABLE :				
a)	Supply, laying & fixing power with 6mmsq				
	4 core PVC insulated,PVC sheated CU.				
	Conductor, 1100 v. grade armoured cable				
	complete with 02 nos 10 SWG bear CU.wire				
	as running earth for AC power line.	25.00	Mts		

b)	End termination of 6 mmsq 4 Core				
	armoured cable,complete with brass cable				
	gland , CU. Lug, PVC tape.	2.00	End		
	Total Of Part 7.				
8	Main Switch				
	Supply fixing of 63 Amps TPN HRC type SFU				
	at SEB for main incomming on MS angle.				
	frame & 02 nos Cable end box including				
	connection. for main incoming	1.00	No.		
	Total Of Part 8				
	Summary Sheet				
	Part 1 Light Point wiring.				
	Part 2 Light Fittings.				
	Part 3 UPS wiring.				
	Part 4 Wiring Of Glow Sign Board				
	Part 5 Earthing Station				
	Part 6 Main D.B				
	Part 7 Laying of Cable				
	Part 8 Main Switch				
	Total - E				

BOQ FOR ELECTRICAL WORK OF UCO BANK -FORT WILLIAM BRANCH

SL.	PARTICULAR	Qty	Unit	Rate	Amount
1	Part : 1 RAW POWER WIRING				
a)	Supply, Laying of Circuite line 2x2.5mmsq +1x1mmsq PVC insulated copper wire form LDB to 6/16A or 6Amps Plug point. Also note that 03 Nos 06 amps Plug to be connected from one circuite line. rest are same as item No 1.	60	Mts		
b)	Supply, Fixing & connection of modular type 6 amps Plug switch complete with circui wiring 2x2.5sqmm +1x1sqmm PVC insulated copper wire through 20mm dia PVC pipe & Ms box Socket switch above table at 32" height fr. Floor.	4	No.		
c)	- Do - but 16 Amps 6pin socket with 16amps switch for raw/UPS power point. (02 Nos plug connected from one circuite.)rest as item no 1 (Ht.of Plug point as per advice of consultant).	2	No.		
	Total Of Part 1				
2	Part : 2 SUPPLY, FIXING & CONNECTION OF LED LIGHT FITTINGS WITH LAMP / FANS :				
a)	Supply Installation, testing & commissioning of 1'-0"x1'-0" LED panel lights of Havells make (15w LED 5700K - PLUTO NEO).To hang from true ceiling by 25x3 mm M.S flat with nuts and bolt as required.	32	Nos		
b)	Supply,Installation testing & commissioning of 12W 6" dia LED down light of Havells make 5700K (ENDURA DL 12 NEO).	10	Nos		
c)	Supply,Installation testing & commissioning of 7W 4" dia LED down light of Havells make 5700K (ENDURA DL 7N).	20	Nos		
d)	Supply,Installation, testing & commissioning of 5W LED of Havells make (LUMENO) in cash and SW counter.	4	Nos		
e)	Supply,Installation, testing & commissioning of 4'-0" x 1'-0" long 34W TL LED 5700K of Havells make (PLUTO)	2	Nos		
f)	Supply,Installation, testing & commissioning of 4'-0" long 22W TL LED tube light of Havells make.	6	Nos		
	Total Of Part 2.				
3	Part : 3, UPS WIRING :				
	Supply, fixing & connection of UPS circuite line with 2x2.5+1x1.5mmsq through MS conduite 20mmdia 16 SWG wall tickness, with ISI mark, to lay from UPS MCB DB to plug point board.Rest same as item no.1 Two nos point to be connected from One circuite .	110	Mts		
a)	Suppy, fixing of 2x6Amps 5 pin socket + 1x16				

SL.	PARTICULAR	Qty	Unit	Rate	Amount
	Amps 6 pin socket in single board (under table) + 1 x 16 A switch in another board above table as per direction.(under table Ht22")	4	Set		
b)	Supply, laying & connection of 4x6mmsq +2x4mmsq PVC insulated copper conductor cable (FRLS) through PVC regid/flexible conduit from the UPS incoming MCB box to UPS.	25	Mt.		
c)	Supply, laying & connection of 2x6mmsq +1x4mmsq PVC insulated copper conductor cable (FRLS) through PVC regid/flexible conduit from UPS out going to UPS DB	50	Mt.		
d)	Supply , installation & termination of 40 Amps DP MCB with Metal encloser for UPS out going Line .(for 5KVA 2 nos UPS unit)	2	No.		
e)	Supply & installation of UPS incoming 40 Amps 4 pole MCB MDS make in MS encloser for Incoming Line as per instruction of consultant.	2	No.		
f)	Supply, installation and termination of UPS outgoing power distribution system with 12 Way SPN DB comprising 8x10Amps SP MCB & 40 Amps DP RCBO 300MA as main. MDS make IP -42 Double Door.	1	Nos		
	Total Of Part 3.				
4	Temporary Adjustment on site				
	Removing and refixing the existing light fittings&fixtures, electrical equipment,wires,fire & security wires and equipments, AC wiring,refrigerent piping &cables and necessary items as per the requirement for the make shift arrangement to run the bank without hindrance as instructed by the Architect in all respect.	1	Job		
	Total Of Part 4.				
	NOTE:ALL RATES ARE INCLUSIVE OF DISMANTLING NECESSARY EXISTING ITEMS , REMOVAL AND DISPOSAL FROM SITE TO THE MUNICIPAL DUMPING GROUND.				
	Summary Sheet				
	Part 1 Raw power point.				
	Part 2 Light Fittings.				
	Part 3 UPS wiring.				
	Part 4 Temporary Adjustment on site				
	Grand Total - C				
	Rs :-				

BOQ OF INTERIOR FURNISHING WORK OF UCO ATM AT FORT WILLIAM BRANCH

SL. NO.	Description of item	Unit	Quantity	Rate(in Rs.)	Amount(in Rs.)
1	Painting :- Providing & applying White Plastic Emulsion paint of Asian Paints / ICI Dulux / Berger and sporty Yellow-X104 shade of Royal Luxury Emulsion of Asian Paints in minium 2 coats including scrapping, opening of existing cracks,removing existing distemper, filling up of "V" cracks with epoxy expandable putty to required depths, making good weak plastered / unplastered surfaces with cement plaster wherever required. Item to include POP, oil base primer, putti & making good existing surface to receive new paint including cleaning on completion of painting work etc. complete in all respects.	Sft	250.00		
2	False Ceiling (Gypsum Board):- Providing & fixing in Position false ceiling in Gypboard 12mm thick for horizontals & verticals fixed over G.I framework as specified by india Gypsum Co. Ltd. Including trap doors for A.C unit in 18mm thick M.R Grade Plywood with Stainless Steel hinges & locks with moulding 1" x 1" for edges including finishing with White Plastic Emulsion Paint etc. complete in all respects.	Sft	100.00		
3	CORNICE MOULDING				
	Providing and fixing pop cornice moulding along the periferi wherever the walls/partition meeting the ceiling size 4" x 2" duly painted as per approval of the architect.	Rft	30.00		
4	Solid Full Height Partition :- Providing & fixing in Positioin solid Full Height Partition in frame work including door in 2'x2' grid (horizontally and vertically) comprising of 2"x1 ½" T.W. Section with 6mm thick plywood on both sides finished with 1mm thick laminates of approved make and colour as shown in drawing no. 17.Item to include 2"x2" T.W.member for door frame. A 1'-6" x 6" Aluminium white powder coated louvered to be fixed on both side of the door. All exposed T.W.surfaces to be finished in melamine polish of matching laminate colour as directed including all necessary Stainless Steel finish fittings / harware like door closers (Heavy Duty),Godrej dead locks,door stoppers,key hole cover,10" 'H'shape ss matt finished handle and wood preservative paint etc.as per list of approved material and as approved by the Project Consultant / Bank complete in all respects.(Note: In case of false ceiling, the vertical T.W. members to be fixed with pucca ceiling but the area of partition payable will be below the false ceiling only).	Sft	60.00		
5	DOORS				
	Full Blocked door				
	Providing and fixing solid core flush door of 35 mm thk. Finished with 1mm approved colour laminate .A wooden cover moulding of 3"x3/4" thk.white beech /teak wood with natural polish shall be provided for floor spring fitted door .8mm thk.Modi Guard / Saint Gobain clear float glass with etching (approved design) shall be provided with 1 1/2"x3/4" thk. White beech/teak wood glass moulding (as per approved design) with natural polish for full ht. partly glazed door.In case of vision panel door 18"x9" 8mm thk. clear glass with glass moulding with natural polish to be provided. The rate shall be inclusive of Floor Spring (heavy duty),4" brass hinges,door stopper, screws,10" 'H' shape brass handle (Kitch) ,dead lock of Godrej,key hole cover,night latch, tower bolt,door closer of approved make.All edges of the door to be covered with necessary lipping with natural polish.The work should be completed as per specification ,design and approval of Architect.				

	Note: Wooden door frame fixed to the wall shall have 4" x2 1/2" Teak wood / sal wood (seasoned) section with natural polish.The doors fitted with door clousers shall be provided 3" x 1 1/2" white beech / Teak wood section with natural polish for door frame work.				
	Entry to back area, toilet area and UPS Room with vision panel (2'-6"x7'-0")	Sft	18		
6	MAIN ENTRANCE DOOR				
	Providing & fixing fully glazed pivoted door at the main entrance consists of 6"x2"seasoned white beach/ Teak wood section for bottom rail and 4"x2" seasoned white beach/teak wood section for top rail finished with natural polish. 12mm thk.Modi Guard /Saint Gobain clear float glass with sand blasting/etching (as per design) and finish handle(1'-0" long)of Neki/Hasseley make to be fixed on both sides & proper locking arrangement in bottom rail to be done. The rate should include lipping,moulding,beading & heavy duty floorspring of approved make.The work to be completed in all respect as per design, direction and approval of the architect.	Sft	25.00		
7	VITRIFIED TILES				
	Providing & laying of 2' x 2' Vitrified Tile flooring of approved make & shade viz. of Jhonson Marbonite(Aprecina) or (Tuscania) over necessary leveling screed of 1:3 cement mortar (Avg. 12mm thick) with proper slope wherever required oncluding pointing of the joints with white cement and matching pigments, curing etc. complete in all respects (excluding Toilets).	Sft	100.00		
(a)	Skirting (4")	Rft	25		
(b)	Providing & laying plain cement concrete (4:2:1) with graded stone chip 6 mm size up to 75 mm thk. making proper slope at floor. Item including watre curing minimum 48hrs over floor.	Sft	100.00		
(c)	Chipping of existing all type of floors.	Sft	100.00		
8	WALL PANELLING				
	Providing and fixing in position wall panelling work comprising of 1" x 1 1/2" wooden section with 12mm plywood finished with 1mmthk. Laminate of approved shade & colour.	Sft	210.00		
9	SYNTHETIC ENAMEL PAINT FOR ROLLING SHUTTER				
	Providing and applying 2 coats synthetic enamel paint on rolling shutter .Before putting final paint scrapping,leveling,preparing the surface and 2 coats primer to be done.The wall to be completed as per the direction of architect.	Sft	200.00		
10	ACP PANELLING				
	Providing and fixing wall panelling /facia of entrance including shutter cover by 4mm thk. ACP consisting of 1 1/2" x 1" aluminium box section (1.2mmthk) at maximum 2'-0"C/C both horizontally and vertically. To be fixed screwed on the existing walls.The frame work to be claded with Exterior grade 4.0mm ACP sheet (EXOTIC SILVER) of ALU DECOR make with aluminium foil thickness of 0.50 on both sides and 3.0mm thk. poly ethylene core of approved make and colour to withstand for atleast 15yrs for fading(warranty certificate from manufacturers is to be given for 15yrs against fading,chalking and delaminations etc.).The joint should be finished with silicon based weatherproof sealant of Dow corning 789 make so as to render the panel waterproof.Necessary hardwares like clamp,anchorning bolts,nuts and other fastening materials are to be used of reputed make..The panel should be of PVDF paint coating of bank's approved colourand size. The work to be completed in all respect .	Sqft	110.00		

11	FIXED GLAZING AT ENTRANCE				
	Providing and fixing fixed glazing at entrance consist of 6"x2" white beech/white cedar woden section with natural polish for bottom rail and 4"x2" white beech/white cedar section with natural polish for top rail.12mm thk.modi guard/saint gobain glass with etching to be provided . The work is to be completed as per design, direction and approval of the architect.	Sft	25.00		
12	WRITING LEDGE				
	Providing and fixing writing ledge as per design made out 19mm block board with necessary groove patterns ,1.0mm laminate to be cladded. 18mm thk.approved colour granite with half round moulding at facia to be provided on top of the writing ledge.A divider made of 19mm thk.block board to be provided. Whit beach/ White cedar lipping with natural polish to be used in all exposed areas. Inside of writing ledge to be enamel painted.The work to be completed in all respect.	NO	1.00		
13	CHEQUE DEPOSIT BOX				
	Providing and fixing cheque deposit box made out of 19mm thk block board & finished with 1.0mm thk. Laminate & inside to be synthetic enamel painted.a 1" high slit & small door with key and locking arrangement to be done for dropping & taking out the slips.The work to be completed as per the design,direction & approval of the architect.	NO	1		
	TOTAL - D				

BOQ OF FURNISHING WORK FOR UCO BANK , FORT WILLIAM BRANCH

SL NO.	PARTICULARS	UNIT	QTY	RATE	AMOUNT
B	FURNISHING :				
1	FALSE CEILING (Gypboard)				
	Providing and fixing 12.5mm tapered edge Gypboard (confirming to IS: 2095 - 1982) is then screw fixed to existing ceiling section with 25mm drywall screws at 230mm centers.Screw fixing is to be done mechanically either with screw driver or drilling machine with suitable attachment. The boards are to be jointed and and finished so as to have a flush look which includes filling and finishing the tapered and square edges of the boards with jointing compound. No extra payment will be made for the cutting of light points , stain glass,cove lighting etc. Rate should include the dismantling of existing gypboards and extra perimeter channel,ceiling section and hangers if necessary.				
	The joints to be properly mended with paper tapes and gypsum compound,two coats of Drywall Top Coat all complete. The rate should include the full completion of the ceiling including acrylic emulsion paint finish. At the time of handing over the site all necessary repairing work including necessary frame work to be considered if required. The work to be completed as per specification,drawing and approval of the Architect.	SFT	450		
2	PARTITION				
	Providing and fixing partition consisting of 2 " x 2" finished sal wood section without sap and joints at maximum 2'-0"C/C both horizontally and vertically treated with Pentapehene pale from STP as antitermite & fire retardent from Viper. To be fixed screwed to the floor and celing with M.S. cleats. The frame work will be claded with 6mm thk. BWR plywood both sides and finished with 1.0mm thk. approved shade laminate as per design with approved adhesive.In case of Partly glazed and low ht.(4'-0"& 6'-0") partition 8mm thk. Etched/Frosted glass to be provided fixed with 3"x3/4" white beach/ teak wood moulding with natural polished all complete.In case of Low ht. partition (4'-0") approved colour soft board should be embedded in partition with white beach/white ceader wooden beading with natural polish.				
	The work to be completed as per specification ,design and approval of the Architects.				
	Note: During joint measurement Partition ht. will be considered upto False ceiling level.In event of difference in false ceiling ht. the partition ht. shall be calculated on average ht.				
a	Full ht. Partly Glazed Cash Side's Partition (8'-0" ht.) (Glass ht. will be from 3'-8" to 7'-0")	SFT	160		
b	Full ht. Partly Glazed Cash Rear Partitions including doors (8'-0" ht.)	SFT	54		
c	Full ht. Partly Glazed Partition for branch mgr. chamber (8'-0" ht.)	SFT	141		
d	Full Blocked Partition at branch mgr. chamber's back	SFT	70		
e	Full ht. Partly Glazed Partition with 12mm glass (8'-6" ht.)	SFT	71		
3	12 mm GLASS PARTITION				
	Providing and fixing in position 12mm thk machine polished glass at top of Cash counter front.Necessary 1 1/2" x1/2" white beech/white ceader moulding with natural polish to be provided. The work to be completed in all respect as per design , direction and approval of Architect.	SFT	35		
4	DOORS				
(a)	Full Ht. Partly Glazed / Full Blocked door				
	Providing and fixing solid core flush door of 35 mm thk. Finished with 1mm approved colour laminate .A wooden cover moulding of 3"x3/4" thk.white beech /teak wood with natural polish shall be provided for floor spring fitted door .8mm thk.Modi Guard / Saint Gobain clear float glass with etching (approved design) shall be provided with 1 1/2"x3/4" thk.				

SL NO.	PARTICULARS	UNIT	QTY	RATE	AMOUNT
	White beech/teak wood glass moulding (as per approved design) with natural polish for full ht. partly glazed door.In case of vision panel door 18"x9" 8mm thk. clear glass with glass moulding with natural polish to be provided. The rate shall be inclusive of Floor Spring (heavy duty),4" brass hinges,door stopper, screws,10" 'H' shape brass handle (Kitch) ,dead lock of Godrej,key hole cover,night latch, tower bolt,door closer of approved make.All edges of the door to be covered with necessary lipping with natural polish.The work should be completed as per specification ,design and approval of Architect.Note: Wooden door frame fixed to the wall shall have 4" x2 1/2" Teak wood / sal wood (seasoned) section with natural polish.The doors fitted with door clousers shall be provided 3" x 1 1/2" white beech / Teak wood section with natural polish for door frame work.				
i)	Entry door to cash and Teller counter door without etching (2'-6"x 7'-0")	Nos	2		
ii)	Full Ht. glazed door with etching at Branch head room (3'-0"/2'-6"x7'-0")	Nos	2		
(b)	MAIN ENTRANCE DOOR AT WAITING AREA				
	Providing & fixing fully glazed pivoted door at the main entrance consists of 6"x2"seasoned white beach/ Teak wood section for bottom rail and 4"x2" seasoned white beach/teak wood section for top rail finished with natural polish. 12mm thk.Modi Guard /Saint Gobain clear float glass with sand blasting/etching (as per design) and finish handle(1'-0" long)of Neki/Hasseley make to be fixed on both sides & proper locking arrangement in bottom rail to be done. The rate should include lipping,moulding,beading & heavy duty floorspring of approved make.The work to be completed in all respect as per design, direction and approval of the architect.	SFT	25		
5	TABLE				
	Providing and fixing tables made out of 19mm thk BWR block board for top,sidis and front of approved make cladded with 1.0mm laminate as per design in all visible areas. All the exposed edges to be covered with white beach/teak wooden lippings and table front facia will have 1 1/2"x 1" mouldings with natural polish. The drawers to be made out of 19mm thk block board for front ,sides to be made out of 12mm BWR plywood and bottom and back to be made out of 6mm BWR plywood and it should play in telescopic drawer sliding channels. The inside of the drawer and the table to be synthetic enamel painted (approved colour) . A legrest to be provided duly painted made out of 19mm thk BWR blockboard. A shutter to be made by 19mm BWR Block board cladded with 1.0mm laminate .The necessary godrej multipurpose locks (brass),brass hinges,4" matt finished handles (brass) of approved make to be provided in each drawers and shutters.On top of the Branch managers table 10mm thk glass to be placed edges duly machine				
	polished.The table should have black powder coated readymade key board tray and tea traywith laminate finish.The necessary wire managers to be provided on the tabs and the provision for lights to be kept if required in the front of table.Readymade metal CPU trolley to be provided every where with a provision of castors to be provided. 3" raised portion made of 19mm BWR b/b finished with 1.0mm laminate and 1 1/2"raised portion made of 19mm BWR b/b finished with 1.0mm approved colour laminate as per design to be provided on table front. All the exposed areas to be duly enamel painted. The work to be completed as per design and approval of the Architect.				
(a)	Branch Manager (5'-6"x2'-6")	NO	1		
(b)	Grahak Mitra (4'-0"x2'-0")	NO	1		
6	CASH COUNTER / TELLER COUNTER (4'-9"x2'-9") HT. 3'-8"				

SL NO.	PARTICULARS	UNIT	QTY	RATE	AMOUNT
	Providing and fixing top, front & sides of cash / SW counter made out of 19mm BWR block board as per design cladded with 1.0mm thk laminate & the expose edges to be finished with necessary white beach or teak wood lippings, mouldings(as per design), etc. Special 6" drawer to be made for the cash /teller with dividers of 12mm BWR plywood .The front of the drawer made out of 19mm BWR block board finished with 1.0mm laminate, sides 12mm BWR plywood and bottom,back to be made of 6mm BWR plywood . The inside and sides of the drawer to be synthetic enamel painted .The drawers and shutters to be provided with necessary drawer sliding channels,4" matt finished handles,brass hinges, godrej multipurpose locks etc. A leg rest to be provided made out of 19mm thk BWR block board duly enamel painted. Inside of the unit to be enamel painted in the matching tone.All visible areas to be coverd with white beach or teak wood lippings, mouldings with natural polish.Wire manager approved colour, legrest,Readymade CPU trolly,black powder coated readymade keyboard tray, tea tray finished with 1.0mm laminate to be provided.				
	18mm thk approved colour Granite with bullnosed moulding (double) to be provided at coustomer top at 3' 8" lvl..6" raised portion made of 19mm BWR b/b finished with 1.0mm laminate and 3"raised portion made of 19mm BWR b/b finished with 1.0mm approved colour laminate as per design to be provided as shown in drawing.The work should be completed as per specification,design and approval of the Architects.	RFT	10		
7	SIDE AND BACK UNIT AT BRANCH MANAGER				
	Providing and fixing Side Unit/ Back unit made out of 19mm BWR block board for top, sides and 6mm thk. BWR ply for back finished with 1.0mm laminate . The drawers to be made out of 19mm BWR block board in the front cladded with 1.0mm laminate. sides to be made out of 12mm plywood and bottom,back made out of 6mm plywood and it should play on drawer sliding channels . Drawer and sliding shutters inside to be synthetic enamel painted.The Sliding shutters to be made out of 19mm block board with 1.0mm laminate finished and should play on alluminium channels all four sides. The necessary godrej multipurpose locks,brass hinges ,4"brass matt finished handle,4"brass matt finished sliding handle etc to be provided . Inside of the unit to be synthetic enamel painted in matching tone . All the exposed edeges of the boards/plywoods to be coverd with White beach/teak wood lippings/mouldings with natural polished all complete.side and back unit top will have 1 1/2"x1" white beech/teak wood moulding with natural polish at front facia.The work to be completed as per specification,design and approval of the Architects.	SFT	22		
8	REPAIRING OF STORAGE				
	Repairing , modification & cutting of existing storage as per proposed dwg. with necessary 19mm BWR block board for top,sides & 6mm BWR ply for back finished with 1.0mm laminate wherever is required . The shutters to be made out of 19mm block board with 1.0mm laminate. The necessary godrej multipurpose locks ,6" SS matt finished handles, auto closing hinges etc to be provided wherever is required . Inside of the unit to be synthetic enamel painted in matching tone . All the exposed edeges of the boards/plywoods to be coverd with white beach/white ceader wooden lippings/1 1/2"x1"mouldings duly natural polished to be provided wherever is required in all complete.For full ht. storage file divider made out of 6mm thk ply to be provided if required.The work to be completed as per approval and specifaion of the Architect.				
	Full ht storage 7'0"(deep 1'-6")	SFT	315		
9	VERTICAL BLINDS				

SL NO.	PARTICULARS	UNIT	QTY	RATE	AMOUNT
	Providing and fixing venitian blinds of 100mm thk (Mac/Annums) of approved shade and pattern having handrail made of high strength alluminium alloyed wall thickness of 1.2mm thk. Headrail to have 25mm decorative insert. Control unit shall be of derlin. The runners are also to be a derlin with antiflixtion adeshive. Spacers should be made of stainless steel. Fabric should be polyester viscoted/polyester yarn having protective coating with chemicals for stain resistance & soil repalancy. The rate shall include necessary scoch gurd treatment on both sides. The overlapping should be uniform and adequate.Necessary operative arrangements,frames to be provided. The work to be completed as per specification and approval of the architect.	SFT	150		
10	REPAIRING OF FIXED GLASS				
	Providing and fixing fixed glazing at entrance consist of 6"x2" white beech/white ceader woden section with natural polish for bottom rail and 4"x2" white beech/white ceader section with natural polish for top rail existing 12mm thk.modi guard/saint gobain glass with etching to be reused. The rate is inclusive of taking out existing 12mm thk. glass & refixing the same. The work is to be completed as per design, direction and approval of the architect.	Sft	110		
(a)	FIXED GLAZING AT WAITNG AREA ENTRANCE				
	Providing and fixing fixed glazing at entrance consist of 6"x2" white beech/white ceader woden section with natural polish for bottom rail and 4"x2" white beech/white ceader section with natural polish for top rail.12mm thk.modi guard/saint gobain glass with etching to be provided . The work is to be completed as per design, direction and approval of the architect.	Sft	50		
11	ROLLING SHUTTER ENCASEMENT				
	Providing & fixing rolling shutters encasement fabricated out of 19mm thk. BWR BB finished with 1.0mm thk. laminate for top,sides , front and bottom with necessary openable pallah at bottom, hardware incldg. locks,hinges &handles. The job to be completed as per approval of the Architect.	SFT	100		
12	TEMPORARY ADJUSTMENT ON SITE				
	Removing and refixing the existing partition, tables, other necessasory items as per the requirement for the make shift arrangement to run the bank without hindrance as instructed by the Architect in all respect.	JOB	1		
13	PILLAR CLADDING				
	Providing & fixing in position column cladding consisting of 6mm BWR plywood,1.0mm thk. laminate with salwood ribbing of 1 1/2"x 1" dimension. The rest of the column is to be painted.oikas paint area as shown in drawings.The pillar cladding will have 19mm block board plank ,1.0mm bi colour laminate as shown in drawings. The item is to be completed in all respects as per design,direction & approval of the architect.	SFT	205		
14	ROLLING SHUTTER				
	Providing and fixing rolling shutters of M.S. sheets of 19 gauge. On the top of the system there will be guide on both sides Sq. bar of 20mm x 20mm is fixed with it and the a clamp 'U'shaped is rolled on it . One no. M.S. pipe fixed over the clamp and a spring is attached with it . The whole system is covered by M.S. sheet.There are both way clips to be attahed two consequitive M.S. curved sheets. At the bottom of the shutters there is a 12 gauge M.S. sheets of 6" high for locking arrangements with lock plate and an angle of 40mm x 40mm x6mm is fitted with it .The job to be completed as per approval of the Architect.	SFT	85		

SL NO.	PARTICULARS	UNIT	QTY	RATE	AMOUNT
15	ANTI TERMITE TREATMENT				
	Applying Anti termite treatment in the preimeses with all necessary injection process as per manufacture specification and written gurentee of min. 5years to be given . The work to be completed as per instruction and approval of the architect.	SFT	1700.00		
16	REPLACEMENT OF DOOR ACCESSORIES				
	Taking out of existing acessories & replacing with new one as door closure,door stoper, brass hinges, locks and handle etc.The work to be completed as per specification and approval of the Architect.				
(i)	Size: 3'-0"x7'-0"	NO	5.00		
	TOTAL - B				
NOTE:ALL RATES ARE INCLUSIVE OF DISMANTLING NECESSARY EXISTING ITEMS , REMOVAL AND DISPOSAL FROM SITE TO THE MUNICIPAL DUMPING GROUND.					

PRODUCED BY AN AUTODESK EDUCATIONAL PRODUCT

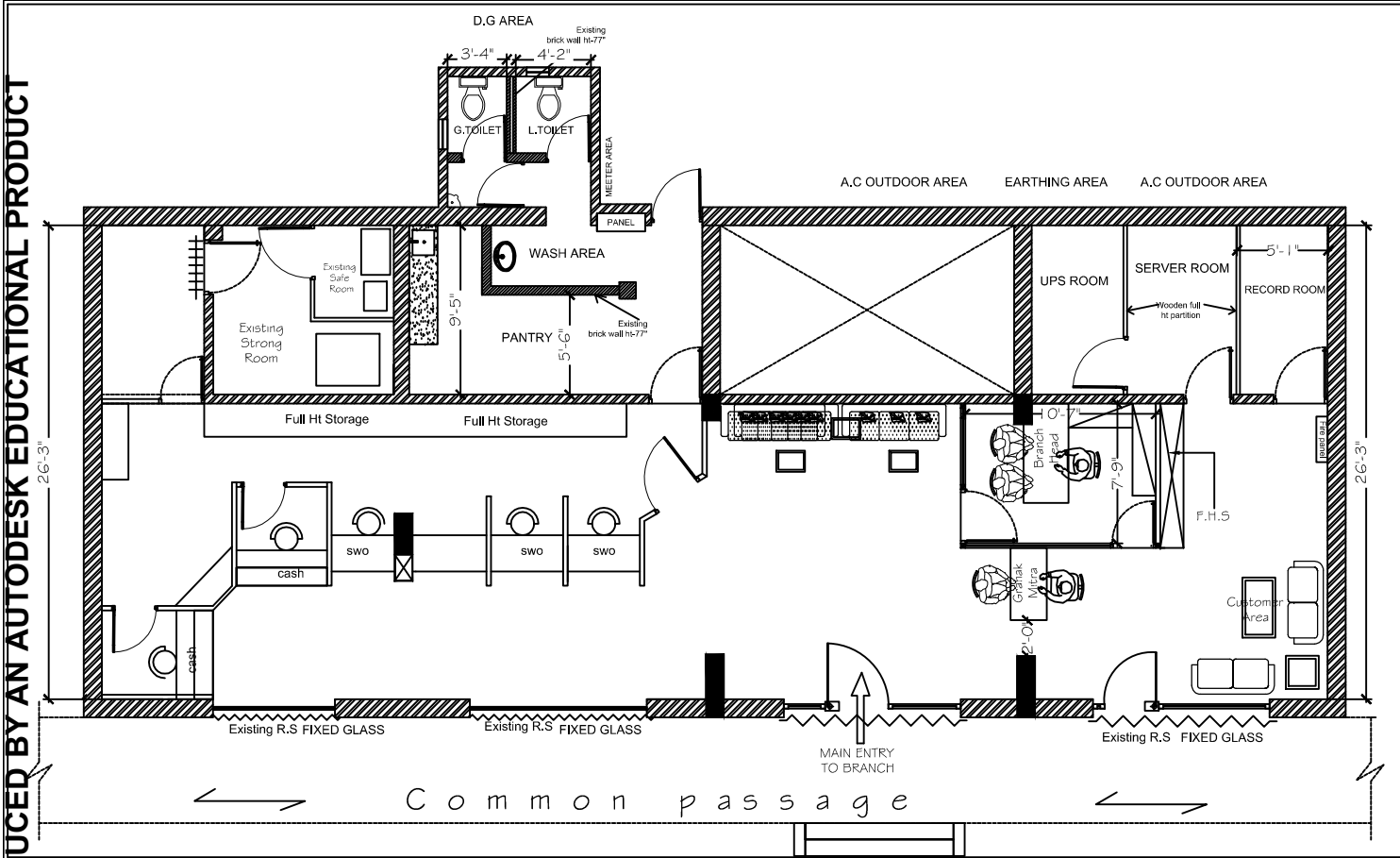

LEGENDS :

Carpet Area = 1615.00 Sft.
(Including Toilet)

REV. NO. -

CHK. BY

DRAWING TITLE :
REVISED FURNITURE LAYOUT OF
UCO BANK - FORT WILLIAM BRANCH



- NOTES :**
1. This drawing is the property of Dearch architects (P) Ltd. & can not be used without their written permission.
 2. Drawing shall not be scaled within dimensions are to be followed.
 3. This drawing to be read along with other relevant drawings.
 4. Any variation between the drawing & the specification should be brought to the notice of the architects in writing prior to the construction.
 5. For R.C.C. details refer structural engineers drawings.



DEARCH ARCHITECTS PRIVATE LIMITED
C-507 Basement, Chittaranjan park,
New Delhi-110019
Fixed line: +91-11-262 72363, 262 72364
Tele Fax: +91-11-262 72347
E-mail : dearchho@rediffmail.com

REVISED FURNITURE LAYOUT OF UCO BANK - FORT WILLIAM BRANCH

APPD. BY : C.C. DATE : 12/05/2017 REV. NO : 6

DRAWN BY : TANUSREE

SCALE : nts REF.: DE ARC / KOUUCO /FW

DELHI KOLKATA MUMBAI KOCHI BANGALORE CHENNAI HYDERABAD

This is the property of DEARCH ARCHITECTS(P) LTD and should be returned after execution. This must not be used by anyone without permission. Any queries in the drawing should be clarified prior to execution.

PRODUCED BY AN AUTODESK EDUCATIONAL PRODUCT

PROJECT

REVISED FURNITURE LAYOUT OF UCO BANK - FORT WILLIAM BRANCH