

DESIGN CELL, ISRO LAYOUT, BANGALORE-78

UCO BANK
ZONAL OFFICE,
PREMISES DEPARTMENT,
K.G. ROAD,
BANGALORE-560009

**TENDER
FOR
PROPOSED INTERIOR, ELECTRICAL WORKS FOR
MAIN BRANCH AND E-LOBBY AT NEW
PREMISES, BANNERGHATTA ROAD, BANGALORE.**

M/S DESIGN CELL,
ARCHITECTS, INT.DESIGNERS &
REGD.VALUERS,
#24, 4TH MAIN, 9TH B CROSS,
DEVARAKERE EXTN, NEXT TO ISRO
LAYOUT, BANGALORE-560078.
MOB: 98861-16685
PH:080-26666713.,
E-MAIL: dezzcel@gmail.com



INDEX

SL.NO.	PARTICULARS
01.	LETTER INVITING TENDER
02.	SUBMISSION OF OFFER
03.	TERMS AND CONDITIONS OF CONTRACT
04.	BILL OF QUANTITIES
05.	DRAWING
06.	ARTICLES OF AGREEMENT.



LETTER OF INVITING TENDER

Sealed tender are invited on behalf of UCO BANK, Zonal office, Premises Department, K.G. Road, Bangalore-560009, for the work as detailed below.

1. Name of Work : Tender for Interior, Electrical and other works (Interior, Electrical works, Air conditioning works)at **New premises and E-Lobby, Bannerghatta Road branch, Bangalore.**
2. Date of issuing of Tender : October 10, 2018 onwards
During office hours (10.30 am to 4.30 pm)
3. Date and time of submission of tender : On or before October 17, 2018 before 3 .00 pm
4. Office at the tender Document to be submitted : The Zonal Manager,
Uco Bank,
Zonal office, Premises Department,
K.G. Road, , Bangalore560009.
5. Date & Time of opening : On October 22, 2018 at 3.30 pm at above said Office.
6. Security Deposit : 5 % of every bill, which will be returned after Defect liability Period.
7. E.M.D. (D.D.only) : Rs.22,500/- (Rupees twenty-two thousand Five hundred only) DD in favor of **UCO BANK,**
payable at **BANGALORE.**
8. Tender Document Fee : **Rs. 1,500/-** by cash or DD in favour of **M/s Design Cell, Bangalore.**
(Non- Refundable)
9. Submission of Tender Documents : The Zonal Manager, Uco Bank,
And address Zonal Office, Premises Department
K.G.Road, Bangalore- 560009.



SUBMISSION OF OFFER

TO,
Zonal Manager,
Uco Bank,
Zonal Office, Premises Department
K.G.Road, Bangalore - 560009.

Dear Sir,

Sub : Tender for Interior, Electrical Work (Interior, Electrical, Air conditioning works)
at **Bannerghatta Road New Premise and E-Lobby, Bangalore .**

We hereby offer to execute the subject work as specified in the tender, after examining site conditions, related drawings, specifications, designs and having acquired the requisite information relating to the tender.

We hereby agree to abide by to undertake the subject of work as per the rates quoted in the tender and to commence the said work within 3 (Three) days of the receipt of work order or as per the intimation of the branch and complete the same on or before _____ (_____) days from the date of the work order.

We also agree to deposit as amount equivalent to 1% of the total cost of the tender as security deposit inclusive of E.M.D.by Demand draft in favour of the bank in default of which we are liable to forfeit the E.M.D.if we fail to fulfill the terms of the contract.

Unless a formal agreements prepared and executed, this tender together with your written acceptance there of shall constitute a binding contract between us and shall be deemed us and shall be deemed to be the contract agreement for all purposes.



TERMS & CONDITIONS OF CONTRACT.

(A) GENERAL

1. Any discrepancies found in the drawings or tender shall be brought to the notice architect before quotation/ execution.
2. The organization/ architect is not responsible for loss of materials, damages to works, injury or loss of life of workers. The contractors themselves are responsible for any liability on these accounts.
3. The organization/ architect is not responsible for the delay in completion due to non-availability of materials or natural calamities or strikes etc. Extension of time may be allowed for valid reasons only.
4. The contractors shall remove all the remaining materials, tools, etc., clean the premises and hand over after completion of the work.
5. The decision of the architect shall be final and binding with regard to the additions or alterations in the designs/ items of work, disputed of measurements, quality, rates etc.,
6. The organization may delete / reduce the items of work at any time of progress or before commencement for which the contractors shall not be compensated.
7. The organization/ architect may terminate the contract during the progress of works, if the quality of workmanship/ materials/ speed are not to the satisfaction of the organization / architect.
8. During the progress of work the premises shall be kept open at any time for inspection by the architect or authorities of the organization.
9. The contractors shall co-operate with other agencies like plumber, electrical contractors etc., in all respects to complete the works effectively and in time.
10. The following specifications of items of works/ measurements/ conditions may be adopted for applicable items of works.
11. If any changes are incorporated by the tenderer in the tender conditions / drawings/ specifications, such tenders are liable for rejection.
12. The contractor shall not sublet the contract works in whole or in part without the permission of the architect/ organization. Work executed by the sub contractor shall also be covered under the agreement and obligation of the main contractor.
13. The contract shall be terminated during the execution of works if the contractor or sub contractor is found to be deviating from the designs/ specifications/ instructions provided by the architect.
14. The architect / organization reserves the right to award the contract in part or whole or may reject any tender or all tenders without assigning any reasons.
15. The drawings shall not be measured. Only the written dimensions shall be followed for quotation / execution.
16. In case of difference between the specifications and the drawing of a particular item of work, specification only should be considered for quotation / execution.
17. **The Tender Document without EMD, with out seal and signature of proprietor / company partners for all pages, without Tender document fee will be summarily rejected.**



SPECIFICATIONS

1. All the materials used shall confirm to BIS or equivalent specifications and standard in quality.
2. **All the materials of works shall be inspected and certified by the architect before use at site and follow as per material list provided.**

WORKMANSHIP

1. All the exposed ends of block / ply / prelaminated boards shall be covered with teak wood beadings of required size and design.
2. All the facing and exposed surfaces of block / ply boards shall be plastic laminated and unexposed surfaces shall be finished with 2 coats of synthetic enamel painting.
3. Any wood used shall be well seasoned and free from defects.
4. All the patch works shall be completed to give matching and finished look and the rates shall be inclusive of the finishing work.
5. The finishing colour and designs of the materials shall be approved by the architect before execution.
6. The entire block / ply / wooden furniture shall be inspected and certified by the architect after fabrication but before painting / polishing or plastic lamination at site.
7. The contractor should coordinate with all other agencies for smooth flow of the work.



MEASUREMENTS, RATES & PAYMENTS

1. The measurement of each work executed and billed shall be as per actuals. **The rates quoted shall be inclusive of wastages, transporations and all taxes.**
2. The organization / architect will not consider the escalations / fluctuations in basic rates of material or labour charges.
3. The tenderer shall affix his signature if any changes / corrections are made for quoted rates.
4. The payments shall be released after deductions as per rules of the income tax department.
5. The COMPLETION PERIOD for works in all respectsd shall be 15 days (Including holidays) from the date of release of work order from the head of the bank / section.
6. Security deposit of 5% (FIVE PERCENT) of the final bill will be deducted before payment. The deposit will be released after the defects liability period without interest.
7. The FINAL BILL shall be submitted by the contractors only after the virtual completion of the works in all respect to the satisfaction of the architect and head of the section / bank. The final bill of the contractors shall be certified after varification of quantities and quality at site within 10 (Ten) days excluding holidays after submission of the bill.
8. The DEFECTS LIABILITY period is 12 (Twelve) months from the date of certification of the final bill by the architect. Any defects found during this period shall be rectified by the contractors at their own cost. If the defects are not rectified by the contractors and if they are rectified by others, the charges of rectification shall be recovered from the contractors.
9. For showcase, wardrobes, etc., the measurements shall be taken as clear inner sizes only.
10. Before quoting the rates, the contractor should read the related drawings carefully.
11. Before execution, pre approval of materials to be taken from bank's architect and follow as per the material list provided.
12. The contractor should quote for all the items. If any items are not quoted, the tender will be **summarily rejected without any notice. The quoted rates are hand written and should be legible.**



Date : 10.10.2018

**ABSTRACT ESTIMATE FOR NEW PREMISES OF M/S UCO BANK
BRANCH AND E-LOBBY, BANNERAGHATTA ROAD, BANGALORE.**

**INTERIOR WORKS OF RS
MAIN BRANCH -part A**

**INTERIOR WORKS OF E- RS
LOBBY - part A**

**ELECTRICAL WORKS OF RS
MAIN BRANCH- part B**

**ELECTRICAL WORKS OF RS
E-LOBBY- part B**

TOTAL RS

ROUNDED TO RS

Rupees only
(inclusive of 18% GST)

BLANK TENDER QUOTATION OF PROPOSED INTERIORS WORK FOR M/S UCO BANK BRANCH NEW PREMISES AND E - LOBBY, BANNERGHATTA ROAD, BANGALORE.						
NOTE : Before quoting the rates, the contractor should go through all the items. The rates should inclusive of all taxes. The make of material should be approved by Architect before execution. All items to be quoted without fail otherwise tender quote will be rejected. All partitions are confirming to BWR / BWP grade.						
MAIN BRANCH INTERIOR WORKS - PART A						
Sl. No.	PARTICULARS OF ITEM	UNIT	QUANTITY	RATE	AMOUNT	REMARKS
	INTERIOR WORKS.					
1	Full Height Glazed Partitions for Manager Cabin, North side partition and East side partition and above Entrance Door for branch Full Height Glazed Partitions:- Providing & fixing in position as per the layout full metal stud dry wall partition with the following specifications: a) supporting system comprising of best locally available make 51 X 35 X 0.55 mm thick G.I. metal studs @ 600 mm c/c and 51 X 32 mm metal tracks at floor, middle, door and ceiling level with joints staggered. The verticals should touch the ceiling with horizontal ceiling channel at slab/beam bottom. The rate should include necessary strengthening with studs/tracks or channel at doors and other openings. b) 9 mm BWR plywood fixed on both sides with 25 mm dry wall screws. c) 1 mm laminate on both sides (dark for bands, light for body) upto false ceiling level. d) 6mm / 8 mm thick clear float glass with etching design as directed between 1050 X 2000 mm level in specified areas fixed with 85 X 15 mm beech wood jamb and 12 X 12 mm beech wood beading. e) All beech wood members to have melamine polish finish. Length X height upto false ceiling will measured for payment. The works to be done as per instructions of architect.	SFT	723.00			
2	Doors in partitions (Manager Cabin, Storage / Record Room/ Stationary Room Doors, UPS ROOM / cash cage area): Providing & fixing 35 mm BWR thick solid core flush with 85 X 15 mm beech wood jamb around and 12 X 12 mm button beading fixed with 1 mm laminate (dark for bands and light for body) on both sides and 8 mm clear float / Plain glass with etching design as directed with 50 X 15 mm beech wood jamb around the glass opening and 12 X 12 mm beech wood beading for fixing of glass on both sides including necessary hardware viz: door stopper, door silencer, Doorset lock (Godrej etc.), handles, brass hinges of approved make & quality, melamine spray polish finish to all beech wood members etc. complete as directed.	SFT	130.00			
3	Low Height Partition with 8mm thick plain glass for Single Window Counters 5'0" (without shutters): Providing and fixing GI metal stud low height partitions with the following specifications. a) Supporting system comprising of best locally available make 51 X 35 mm GI metal studs at 600 mm c/c and 51 X 32 mm metal tracks at floor, middle and at 1200mm level with joints staggered. The rate should included necessary strengthening with studs/tracks or channels at openings. b) 9mm plywood with 1mm laminate (dark for bands and light for body) on both sides c) 85 X 15mm beech wood capping on top and sides of openings. The beech wood members to have melamine polish finish. d) 8 mm glasses with edges polished and with etching design above 2'-6" to 3'-0" to a height of 5'0" height at specified areas as directed by the architect / instructions given at site.	SFT	200.00			

Sl. No.	PARTICULARS OF ITEM	UNIT	QUANTITY	RATE	AMOUNT	REMARKS
4	Backside Door for for SW counters:- : Providing & fixing in position 35 mm Solid Core BWR flush door finished with 1 mm lamination on both the sides and edges covered with beech wood beading. The rate to include for providing 'Godrej' night latch, all hardware etc. complete..	SFT	25.00			
5	7'6" height Partition with 12mm thick toughened glass for Cashier cabin: Providing and fixing GI metal stud low height partitions with the following specifications. a) Supporting system comprising of best locally available make 51 X 35 mm GI metal studs at 600 mm c/c and 51 X 32 mm metal tracks at floor, middle and at 2100mm level with joints staggered. The rate should included necessary strengthening with studs/tracks or channels at openings. b) 9mm plywood with 1mm laminate (dark for bands and light for body) on both sides c) 85 X 15mm beech wood capping on top and sides of openings. The beech wood members to have melamine polish finish. d) 12 mm toughened glasses with edges polished and with etching design above 3'-0" to 7'0" height at specified areas as directed / instructed by architect.	SFT	155.00			
6	Backside Door for for Cashier cabin:- : providing & fixing in position 35 mm Solid Core BWR flush door finished with 1 mm lamination on both the sides and edges covered with beech wood beading. The rate to include for providing 'Godrej' night latch, all hardware etc. complete..	SFT	17.50			
7	Solid full Height partition for Record, Stationary Room upto roof height, Cash cage area in strong room upto 8'6" height but with out door shutter for the same. Providing & fixing in position as per the layout full metal stud dry wall partition with the following specifications: a) supporting system comprising of best locally available make 51 X 35 X 0.55 mm thick G.I.metal studs @ 600 mm c/c and 51 X 32 mm metal tracks at floor, middle, door and ceiling level with joints staggered. The verticals should touch the ceiling with horizontal ceiling channel at slab/beam bottom. The rate should include necessary strengthening with studs/tracks or channel at doors and other openings. b) 9 mm BWR plywood fixed on both sides with 25 mm dry wall screws. c) 1 mm laminate on both sides (dark for bands, light for body) upto false ceiling level. d) All beech wood members to have melamine polish finish. Length X height upto false ceiling will measured for payment etc.complete as per instructions of architect.	SFT	440.00			
8	Wicket Gate: Providing & fixing Wicket Gate made out of 35 mm flush door finished with 1 mm lamination of approved shade on both sides with all necessary hardware such as hinges, tower bolt etc. complete. The edges shall be finished with beech wood beading polished as per instructions of architect.	SFT	15.00			

Sl. No.	PARTICULARS OF ITEM	UNIT	QUANTITY	RATE	AMOUNT	REMARKS
9	<p><u>BM's table (Size 6'-6" X 3'-0" X 2'-6", Side table 3'-6"X1'-6"X2'-6")</u>: Providing, making & placing in position executive table and side table ('L' Shaped) with the following specifications:</p> <p>a) Table top made in 25 mm block board/BWR ply & all other members with 18/19 mm BWR plywood with 1 mm laminate, with all edges to have 20 X 6 mm beech wood lipping.</p> <p>b) One drawer cum shutter unit with necessary hardware viz: drawer channels,handles, locks etc.</p> <p>c) One CPU pedestal.</p> <p>d) One plywood key board tray with channels to be provided</p> <p>e) One foot rest</p> <p>f) Side table with shutters to be made with 25 mm block board/BWR ply with 1mm laminate or top and other members with 18/19 mm BWR plywood & 1 mm laminate with necessary hardware viz: cabinet hinges, handles, locks, tower bolts, etc. and 25 X 40 mm beech wood beading and 20 X 6 mm beech wood lipping etc.</p> <p>g) All the exposed surfaces to have 1 mm laminate of approved shade and brand. All unexposed surfaces to have two coats of enamel paint with putty. All wooden members to have melamine polish and all should be finished as per instructions of architect.</p>	NOS	1.00			
10	<p>Single Window Counters : (2 Nos.(SW) 4'6" x2'6"x 2'6"+ 1 No. 5'0"x2'6"x2'6"): Single Window Counters: 5'-0" (4'-6"to5'-0")X2'- 6"X2'-6", Side table 3'-0"X1'-6") : Providing, making & placing in position SW counter table and side table with the following specifications:</p> <p>a) Table top made in 19 mm block board/BWR ply, the exposed edges to have beech wood beading 1 1/2"X 1" all other members with 18/19 mm BWR plywood with 1 mm laminate, all edges to have 20 X 6 mm beech wood lipping b) The front side of the table to have two pieces of 12 mm toughened glass upto 5'-0" height from floor level with etching design/frosted film with cut out for cash transaction. c) The drawer unit to have three drawers with necessary hardware, viz: drawer channels,handles, locks & denomination partitions, etc.d) One CPU pedestal. e) One plywood key board tray with channels to be provided f) One foot rest g) Side table to have drawer cum cupboard unit be made with 19 mm block board/BWR ply, edges finished with beech wood beading top and other members with 18/19 mm BWR plywood & 1 mm laminate with necessary hardware viz: cabinet hinges, handles, locks, tower bolts, etc. and 1"X1 1/2" beech wood beading and 3/4" X 1/4" beech wood lipping h) All the exposed surfaces to have 1 mm laminate of approved shade and brand. All unexposed surfaces to have two coats of enamel paint with putty. All wooden embers to have melamine polish etc.complete as per instructions of architect.In the drawers suitable partitions to be made for placing of different denomination of currencies.</p>	NOS	2.00			
11	<p><u>Main Door:-</u> Main Door frame made of approved quality Beach/Safeil wood. The Shutter to be 35mm thk BWR Block Board with both side finished with 1mm thk laminate with necessary inlays and grooves as per drawing. The door inlet with 12mm thick toughened glass with etching design as directed. The edges of the door and four side of the glass shall be fixed with beading. The door to be provided with handles, locks of Doorset, door closers and stoppers etc. and other necessary hardware. All beading surface to be finished with melamine polish as instructed by Bank's Engineer/architects, all complete as per drawings. All materials to be approved by Bank's Engineer/architects.</p>	SFT	25.00			

Sl. No.	PARTICULARS OF ITEM	UNIT	QUANTITY	RATE	AMOUNT	REMARKS
12	OFFICER TABLE : 2 Nos. of 5'0"(L)x2'6"(W)x2'6"(H) + side table 3'0"(L)x1'6"(w)x2'6"(h) +1 No. of 4'9"(L)x2'6"(W)x2'6"(H): Providing and placing officers table and credenza(3'0"x1'6") made out of 19mm BWR / BWP ply for horizontal and verticle sides and finished with 1.00 mm thick laminate of approved colour and shade as per design with beach wood moulding beading etc., complete. The internal surfaces inside credenza / drawers are finished with two coats of enamel paint and exposed surfaces polishing and melamine finish. The table is provided with foot rest,Key board Tray of Ebco make, CPU stand, drawers with 2to 3 units with sliding channels with as per instructions of architect.	Nos.	3.00			
13	WORK STATION COUNTER(Next to SW counter and wicket gate) : Providing and placing running counter for work station as per design made out of 19mm BWR ply board for all horizontal, verticle sides and covered with beachwood moulding 1 1/2"x1 1/2" and finished with 1mm thick laminate of approved colour finished for sides The counter lenth shall be of 4'6" in length X 2'6" width X 2'6" depth shall accomodate CPU, Monitor, key board tray of Ebco make with 2 drawers units with sliding channels and below drawer unit one storage unit etc.as per instructions of Architect.The drawer and storage units shall be fixed with necessary fittings etc. complete.The front portion of counter fixed with 8mm thick plain glass for an height of 9" fixed as per instructions of architect.	RFT	4.50			
14	Specification same as Branch Manager table but for cashier cabin with size 5'0"(L) x 2'6"(W)x2'6"(D) with side table of size 3'0"x1'6"x2'6".In the drawers suitable partitions to be made for placing of different denomination of currencies.	NOS	1.00			
15	EXHAUST FAN FRAME Providing & fixing 18mm th. BWR / BWP ply for exhaust fan with 1 1/2" x 1 1/2" wooden frame with necessary net bolts,3 coats of enamel paint including round cut out for exhaust fans per instruction of architect .	NOS	3.00			
16	ENAMEL PAINTING FOR ROLLING SHUTTER / COLLAPSIBLE GATE AND SECURITY GRILL Providing and painting to Rolling shutter and collapsible gate using synthetic enamel painting two or more coats over a coat of steel primer appropriately (steel/wood) surface with sand papering to get smooth surface and cleaning etc.complete.					
16	PAIN GYPSUM FALSE CEILING FOR BANK HALL AT 2 LEVELS INCLUSIVE OF VERTICALS Providing and fixing Concealed Grid suspended ceiling system of 12.5mm India Gypsum Plaster Boards fixed to Frame Work of the company, Metal System concealed grid key lock suspended ceiling system consisting of 5mm suspension rod, adjustable spring loaded suspension clip, top cross rail of 3000mm long of 0.55BMT and furring channel 4000mm long made of 0.5mm BMT the top cross rail to be suspended from ceiling at every 1200mm and furring channel to be fixed to top cross rail at every 600mm to make a grid of 1200 x 600m. All the above components are to be made of galvanized steel. The rates to include cutouts for lighting fixtures / AC grilles / Fire Alarm Detectors etc., along with necessary strengthening and supports for fixing of these. The board joints are to be flush finished with jointing compound and paper tape etc., complete as directed. The ceiling to be painted with two coats of white emulsion paint over a coat of primer, finished completely.	SFT	1850.00			
		SFT	900.00			

SI. No.	PARTICULARS OF ITEM	UNIT	QUANTITY	RATE	AMOUNT	REMARKS
17	GRID FALSE CEILING 2'-0"X2'-0" Silhouette Grid False Ceiling:- Providing and fixing in true horizontal level false ceiling grid system of Armstrong World Industries/Insula/Daikin etc.. The suspension system shall be 2'-0"X2'-0" plain grid system with 15mm wide flanges main runners and cross tees to have mitred ends with "birds mouth " notches to provide mitred cruciform junctions. Main runners to be spaced at 4'-0" fixed by using 2mm pre-straightened GI wire. Main tee, rotary stitched of size 15mm x 44mm x 3600mm at every 4'-0" c/c maximum and 4'-0" cross tee of size 15mm x 44mm x 1200mm at every 2'-0" c/c maximum and 2'-0" cross tee of size 15mm x 44mm x 600mm at every 4'-0" c/c maximum and 19mm x 19mm x 3000mm wall angle around the wall to form grid size of 2'-0" x 2'-0" and suspending the grid using 2mm pre-straightened GI wire and 6mm nylon rawl plug at every 4'-0" intervals at the main tee and laying of 15 mm thick mineral fiber tiles manufactured by Armstrong/Insula/Daikin etc. of size 2'-0"X 2'-0" 15mm over the formed grid etc., complete as directed.	SFT	550.00			
18	Plastic emulsion paint : Cleaning the surface of the wall & applying two coats of Altek putty followed by one coat of primer and applying a minimum of two coats of acrylic emulsion paint of Asian or equivalent make of approved shade to give neat uniform finish. Rate to included cost of all materials, labour, brushes, scaffolding etc. complete.	SFT	3200.00			
19	COLUMN PANELLING : Providing & fixing GI metal stud column panelling with the following specification: a) Supporting system comprising of best locally available make 51 X 35 X 0.55 mm thick GI metal studs @ 600 mm c/c and 51 X 32 mm metal tracks at floor, middle, door level and ceiling level with joints staggered. The verticals should touch the ceiling with horizontal ceiling channel at slab/beam bottom. b) 9 mm BWR plywood fixed on one side with 25 mm dry wall screws for the entire height of panelling. c) 1 mm laminate (dark for bands, light for body) upto false ceiling level. Length X height up to false ceiling will be measured for payment.	SFT	200.00			
20	ROLLING SHUTTER COVER : Providing and fixing Rolling shutter cover with 19mm BWR ply and covered with 1.00mm thick approved colour laminate with necessary fittings etc. complete.	SFT	15.00			
21	LOW HEIGHT STORAGE(upto 2'6" ht.) : Providing, making and placing in position low height storage units upto 2'-6" height or height as directed and 1'-6" deep made with 18/19 mm BWR plywood front sides and middle shelf and back side with 6 mm BWR ply covered with 1 mm laminate (dark for bands and light for body) at all exposed surfaces except on top which shall have Corian top item no.18 (and will be paid separately). Inner/unexposed surfaces to painted with two or more coats of enamel paint with putty finish including melamine polish finish for all wooden members. The rate to include cost of all necessary hardware viz., cabinets hinges, locks, handles, tower bolts etc. The unit should have beech wood beading 25 X 40 mm at top and edge lipping 20 X 6 mm complete. Length X height will be measured for payment.	SFT	60.00			

Sl. No.	PARTICULARS OF ITEM	UNIT	QUANTITY	RATE	AMOUNT	REMARKS
21A	Low height storage same specification as item No.21 but fixed 19mm polished granite in dry pantry area with bull nosing, finishing etc.complete as per instructions of architect.(Basic rate of Granite Rs.90/sft)	SFT	25.00			
22	FULL HEIGHT STORAGE(upto 7'0" ht.) : Providing, making and placing in position Full height storage units upto 7'0" height or height as directed and 1'-6" deep made with 18/19 mm BWR plywood front sides and middle shelf and back side with 6 mm BWR ply covered with 1 mm laminate (dark for bands and light for body) at all exposed surfaces except on top which shall have Corian top item no.18 (and will be paid separately). Inner/unexposed surfaces to painted with two or more coats of enamel paint with putty finish including melamine polish finish for all wooden members. The rate to include cost of all necessary hardware viz., cabinets hinges, locks, handles, tower bolts etc. The unit should have beech wood beading 25 X 40 mm at top and edge lipping 20 X 6 mm complete. Length X height will be measured for payment.	SFT	250.00			
23	Vertical Blinds:- Supplying & fixing in position of vertical Blinds of "Vista" or "Touch".	SFT	150.00			
24	WRITING LEDGE : Providing and placing writing ledge made out of 18mm /19mm BWR /BWP ply with all top, verticle and horizontal sides and below shutters with hinges, drawers and handles and godrej locks and finished with 1.00mm thk laminate with approved colour and shade and beach wood moulding and top fixed with 12 mm thick plain glass with bevel edge with space below is for leaflets as per design. Size 4'0"(W) 4'-0"(H) and 1'6" (D) as shown in interior layout plan.	Nos.	1.00			
25	NOTICE BOARD : Providing notice board with pin up board covered with tapestry cloth of size 4'-0" x 3'-0" and below the cloth the notice board made of 19 mm ply board and finished the exposed edges with and teak wood frame of size 3" x 1" frame with glass shutter and lock as per direction of arhcitect.	Nos.	1.00			
26	CHEQUE COLLECTION BOX : Providing & fixing Cheque collection box by 19mm BWR / BWP ply board & finished with 1.00mm thick laminate of approved colour.	Nos.	1.00			
27	SUGGESTION BOX: Providing and fixing suggestion box of size 0'9"x1'0"x0'6" made out of 19mm ply board with 1.00mm thick laminate of approved colour and necessary fittings provided as per architect's instructions.	Nos.	1.00			
28	COMPLAINT BOX	Nos.	1.00			
29	PIGEON HOLE BOX IN STORAGE / STATIONARY / RECORD ROOM AREA : Providing and fixing pigeon hole box with 6mm thick BWR plyboard at wall area and 19mm bwr ply wood with 6"x6" x 1'0" depth equal space and finished with synthetic enamel paint of 2 coats over a coat of wood primer as per instructions of architect.	Sft	50.00			
30	VITRIFIED TILES FLOORING : Cutting/ Removing existing vitrified tiles floor wherever necessary as per construction drawing and as per architects instructions Providing and laying Double charged vitrified tiles flooring 2'x2' of approved brand over a base of CM of propn. 1:4 propn. With joints neatly finished and curing etc. complete. (Basic cost Rs.60/ sft)	Sft	100.00			
31	Removal of existing False ceiling roof at existing branch and transport the debris away from site to bank specified area.	Sft	2000.00			
			TOTAL			

E - LOBBY AREA INTERIOR WORKS - PART B						
Sl. No.	PARTICULARS OF ITEM	UNIT	QUANTITY	RATE	AMOUNT	REMARKS
I	INTERIOR WORKS.					
1	GYPSUM FALSE CEILING WORK WITH 2 LEVELS : Providing and fixing Concealed Grid suspended ceiling system of 12.5mm India Gypsum Plaster Boards fixed to Frame Work of the company, Metal System concealed grid key lock suspended ceiling system consisting of 5mm suspension rod, adjustable spring loaded suspension clip, top cross rail of 3000mm long of 0.55BMT and furring channel 4000mm long made of 0.5mm BMT the top cross rail to be suspended from ceiling at every 1200mm and furring channel to be fixed to top cross rail at every 600mm to make a grid of 1200 x 600mm. All the above components are to be made of galvanized steel. The rates to include cutouts for lighting fixtures / AC grilles / Fire Alarm Detectors etc., along with necessary strengthening and supports for fixing of these. The board joints are to be flush finished with jointing compound and paper tape etc., complete as directed. The ceiling to be painted with two coats of white emulsion paint over a coat of primer, finished completely.	SFT	55.00			
2	GRID FALSE CEILING 2'-0"X2'-0" Silhouette Grid False Ceiling:- Providing and fixing in true horizontal level false ceiling grid system of Armstrong World Industries/Insula/Daikin etc.. The suspension system shall be 2'-0"X2'-0" plain grid system with 15mm wide flanges main runners and cross tees to have mitred ends with "birds mouth " notches to provide mitred cruciform junctions. Main runners to be spaced at 4'-0" fixed by using 2mm pre-straightened GI wire. Main tee, rotary stitched of size 15mm x 44mm x 3600mm at every 4'-0" c/c maximum and 4'-0" cross tee of size 15mm x 44mm x 1200mm at every 2'-0" c/c maximum and 2'-0" cross tee of size 15mm x 44mm x 600mm at every 4'-0" c/c maximum and 19mm x 19mm x 3000mm wall angle around the wall to form grid size of 2'-0" x 2'-0" and suspending the grid using 2mm pre-straightened GI wire and 6mm nylon rawl plug at every 4'-0" intervals at the main tee and laying of 15 mm thick mineral fiber tiles manufactured by Armstrong/Insula/Daikin etc. of size 2'-0"X 2'-0" 15mm over the formed grid etc., complete as directed.	SFT	36.00			
3	E-LOBBY ENTRANCE DOOR: Main Door:- Main Door frame made of approved quality Beach/Safeli wood. The Shutter to be 35mm thk BWR Block Board with both side finished with 1mm thk laminate with necessary inlays and grooves as per drawing. The door inlet with 12mm thick toughened glass with etching design as directed. The edges of the door and four side of the glass shall be fixed with beading. The door to be provided with handles, locks of Doorset, door closers and stoppers etc. and other necessary hardware. All beading surface to be finished with melamine polish as instructed by Bank's Engineer/architects, all complete as per drawings. All materials to be approved by Bank's Engineer/architects.	SFT	21.00			
3A	E-LOBBY Glass partition next to entrance door with toughened glass of 12mm thick with patch fitting upto false celing with necessary support from the ceiling as per instructions of architect.	SFT	110.00			

Sl. No.	PARTICULARS OF ITEM	UNIT	QUANTITY	RATE	AMOUNT	REMARKS
4	PANELING WITH LAMINATE FINISH FOR WALL UPTO 9'0"HEIGHT IN E-LOBBY AREA Providing & fixing GI metal stud wall panelling with the following specification: a) Supporting system comprising of best locally available make 51 X 35 X 0.55 mm thick GI metal studs @ 600 mm c/c and 51 X 32 mm metal tracks at floor, middle, door level and ceiling level with joints staggered. The verticals should touch the ceiling with horizontal ceiling channel at slab/beam bottom. b) 9 mm BWR plywood fixed on one side with 25 mm dry wall screws for the entire height of panelling. c) 1 mm laminate (dark for bands, light for body) upto false ceiling level. Length X height up to false ceiling will be measured for payment.	SFT	300.00			
5	POSTER DISPLAYS Provision of poster displays on rear and one side of E-Lobby entrance. Sandwich type display board of size of 18"x24" made up of two acrylic sheets fixed to wall with stainless steel stud screw of 3/4" in diameter and 2" in length as per instruction of architect.	Nos.	2.00			
6	ACRYLIC LOGO OF Uco Bank Size 12" x12"	Nos.	3.00			
7	ACRYLIC LEAF LET STAND	Nos.	1.00			
8	SS DUSTBIN	NOS	1.00			
9	PROVIDING AND FIXING ENTRANCE ROLLING SHUTTER COVERAGE BOX FINISHED WITH LAMINATION	SFT	12.00			
10	Providing and fixing of 12mm thick toughened glass partition with necessary fittings and fixing with edge polish ATM MACHINE, CHEQUE DROP MACHINE, PASS BOOK PRINTER MACHINE, CURRENCY DEPOSIT MACHINE	NO	2.00			
11	VITRIFIED TILES FLOORING : Cutting/ Removing existing vitrified tiles floor wherever necessary as per construction drawing and as per architects instructions Providing and laying Double charged vitrified tiles flooring 2'x2' of approved brand over a base of CM of propn. 1:4 propn. With joints neatly finished and curing etc. complete. (Basic cost Rs.60/ sft)	SFT	20.00			
TOTAL						

BLANK TENDER QUOTATION FOR ELECTRICAL WORKS FOR M/S UCO BANK BRANCH NEW PREMISES AND E-LOBBY, BANNERGHATTA ROAD , BANGALORE.

NOTE : Before quoting the rates, the contractor should go through all the items. The rates should inclusive of all taxes. The make of material should be approved by Architect before execution. All items to be quoted without fail otherwise tender quote will be rejected.

MAIN BRANCH ELECTRICAL WORKS - PART B					
SL.NO	DESCRIPTION	UNIT	QTY	RATE	AMOUNT
1	Supply, installation, testing & commissioning (SITC) of wall mounted 4 WAY MCB power distribution board of approved make with all incidental work with the following items: Incomer: 1 no . 63 A TPNMCB outgoings: 32 A TPMCB'S - 2nos.16/20/25A SP MCBs- 12 nos 40 A 2 SPN , 32 SPN 1 NO.	Nos.	1.00		
2	Supply, installation, testing & commissioning (SITC) of wall mounted 12 WAY SPN computer distribution board of approved make with all incidental work with the following items Incomer: 1 no . 40 A TPN MCB outgoings: 12 nos 6/10/16A SP MCB	Nos.	1.00		
3	SITC wall mounting type UPS out put panel comprising the following Main copper Bus bar of suitable rating & all other incidental materials & works etc complete Incomer : 1 no. 32 A TPN MCB outgoing : 2 nos. 32 A DP MCBs with other items such as blank gland plates, copper earth bus etc	nos	2.00		
4	SITC of 32 A DP Modular control switches with in suitable control boxes and 32 A 3 pin socket in a separate box for Split A.C. units including all incidental materials & works complete (wiring will be paid seperately)	Nos.	4.00		
5	SITC of 40 A SP MCB control with suitable sheet steel enclosre for single phase UPS power point including all incidental materials & works complete (wiring will be paid seperately)	Nos.	3.00		
6	SITC of 6/16 A SP Modular socket outlet with 16 A SP Switch in a suitable MS control box for glow sign boards/power points including all incidental materials & works complete (wiring will be paid seperately)	Nos.	6.00		

SL.NO	DESCRIPTION	UNIT	QTY	RATE	AMOUNT
7	<p>POINT WIRING</p> <p>Point wiring with 1100 V grade 3 nos. single core 1.5 sq.mm. (1 for phase, 1 (black colour) for common neutral by looping method and 1 (green colour) for common earth by looping method) PVC insulated flexible FRLS copper conductor cable (IS:694) through suitable size rigid PVC. conduit (ISI marked embossed on conduit surface) complete with junction box, circular box, elbows, bends, couplers and other accessories on surface above false ceiling or concealed by chase cutting on wall from light & fan switch board to light, fan & 6A socket outlet on the same switch board or separately mounted switch board.</p> <p>The work includes supply and fixing of all materials such as North-West./MDS / Woods make modular type 6A switch for each light and fan point, 6A 2/3 pin shuttered socket outlet with switch, 3 plate ceiling rose / angle or batten holder etc. as required. The point wiring also includes circuit wiring with 1100 V grade 2 nos. single core 2.5 sq.mm. (1 for phase and 1 (Black colour) for neutral) + 1 no. single core 1.5 sq.mm. (Green colour for earth) PVC insulated flexible (FRLS) copper conductor cable (IS:694) through suitable size rigid PVC conduit as described above from DB to switch board, interconnection, mending good all damages to original finish, painting etc. as required to be completed in all respect.</p>				
a	Light points (all types)	nos.	40.00		
b	Exhaust fan point	nos.	3.00		
c	Ceiling / wall mounted fan point with supply and fixing of Electronic Regulator (2 module step , 280 watt (mtn.)	nos.	15.00		
d	Call bell point with bell push	nos.	1.00		
e	Display board/Interest board point	nos.	2.00		
f	1 x 6A 2/3 pin shuttered socket with switch on separate switch board other than light/fan switch board/on work station with connection of maximum 3 nos. sockets in one circuit by looping method	nos.	18.00		
g	2 x 6A 2/3 pin shuttered socket outlet with individual controlling switch on separate switch board other than light/fan switch board	nos.	10.00		
h	1x 6 A 2/3 pin shuttered socket outlet with switch on light and fan switch board	nos.	10.00		

SL.NO	DESCRIPTION	UNIT	QTY	RATE	AMOUNT
	SUB MAIN WIRING CIRCUITS				
8	Same as above in item no 7 but with 4 nos. 10 Sqmm + 1nos. Of 4 Sqmm for UPS from main switch board	MTR	150.00		
9	Same as above but with 2 nos. 6 Sqmm + 1nos. Of 2.5 Sqmm from UPS out going to computer distribution board	MTR	45.00		
10	same as above but with 2 nos. 2.5 Sqmm + 1 no. 1.5 Sqmm copper earthing wire from UPS computer DB to UPS computer points	MTR	175.00		
11	same as above in the item no. 8 but using 2 run of 2.5 Sqmm PVC insulated stranded copper cable wiring along with 1 run of 1.5 sqmm copper cable earthing wire in 20/25 mm dia rigid PVC conduit pipes of ISI marked approved make with all specials including terminations complete as per standards for power points/other points as per requirement	MTR	175.00		
12	Same as above in item no. 10 but with 2 runs of 4 Sqmm 2.5 Sqmm along with 2.5 Sqmm copper cable earthing wire for 15 A power points/ AC points	MTR	175.00		
	<u>UPS /COMPUTER POINTS</u>				
13	SITC of the following items with all connections, wiring & incidental work for computer work stations 1 nos. 6A/10 A 5 pin modular type shutterd socket 1 no 6A/10 A moudular type controlling switch & socket	nos	16.00		
14	same as above but as under 2 nos. 6A/10A 5 pin modular type shuttered socket ; 2 nos.6A/10A modular type controlling switch ; 1 no. Front cover of suitable size ; 1 no. Mounting box of suitable size . 1no. Mounting box of suitable size	nos.	9.00		
15	Same as above but as under 3 nos. 6A/10 A 5 pin modular type shutterd socket 1 no 16 A moudular type controlling switch 1 no. mounting box 1 no. Front cover of suitable size ; (control switches to be provided above the table/counter as per site conditons and sockets below counter as directed)	nos.	9.00		
15A	Same as above but for ATM	nos.	3.00		
16	same as above but 6A/16A modular socket outlet point with 16 A one way SP switch	nos.	1.00		

SL.NO	DESCRIPTION	UNIT	QTY	RATE	AMOUNT
17	<p><u>EARTHING (COMPUTER)</u></p> <p>Earthing the installation as per I.E. rules conforming to IS:3043-1987 or its latest amendment by making earth station with 600mm x 600mm x 6mm (minimum) thick copper plate electrode to be installed such that its top edge shall be at a minimum depth of 3.0 metre below ground level after preparation of ground with charcoal and salt and connecting the 25mm x 6mm copper earth lead-in-strip (upto 10 metre length) by bolting and then brazing to the copper plate complete with copper bolts of suitable length double nuts and washers including supply and fixing of 50mm dia. partly perforated G.I. pipe with funnel for watering arrangement.</p> <p>The copper earth lead-in-strip shall be PVC sleeved / insulated throughout the total length and the underground portion to be laid through suitable size heavy duty rigid PVC conduit (ISI mark embossed on conduit surface) at an average depth of 500mm below ground level. The earthing installation should be provided with 300mm x 300mm and 300mm depth inside dimension masonry inspection pit with C.I. hinged cover having locking arrangement, test link of size 150 mm length x 25mm x 6mm copper flat connected to copper earth lead-in-strip and restoring the surfaces duly rammed.</p>	No.	3.00		
18	Extra for earth lead-in-strip exceeding 10 metre length as mentioned in item no. 3.5.1. with supply and fixing of 25mm x 6mm copper strip having PVC sleeved / insulated to be fixed on wall surface with tinned copper bar saddles / clamps at an interval of 300mm etc. as required to be completed in all respect. Minimum clearance between wall surface and copper earth lead-in-strip should be 6mm.	RFT	160.00		
19	Supplying, Installation, testing & commissioning of 1'x4' watt fixture T8 LED completed fittings as per architects instructions for Record room, strong room, stationary area etc.complete.	nos	11.00		
20	SITC of 2/2 LED 36 Watt Lighting Fixture with Electronic inbuilt driver. Complete makes RLT Make:OLBER 40W-Best in class LED with high levels of efficiency or any eql (Wipro/Philips /Bajaj)	nos.	14.00		

SL.NO	DESCRIPTION	UNIT	QTY	RATE	AMOUNT
21	Installation, testing and commissioning of heavy duty type ISI marked 300mm dia. Exhaust fan suitable for 250V single phase 50 Hz. A.C. supply complete with louvre, interconnection between fan points and fan with 3 nos. single core/3 core 1.5sq.mm PVC insulated flexible FRLS copper conductor cable, making suitable size holes on wall to accommodate the fan, mending good to the original finish, painting etc. as required. .	nos.	3.00		
22	SITC of 18 Watt LED Down lighter fixture Electronic driver. RLT Make-LEXELL FD 20W-Best in class LED, with high levels of efficiency (Wipro/Havells/RLT make)	nos.	15.00		
23	Supplying, Assembling, installation testing and commissioning of ceiling fan (4' and 2' Dia size) complete with all accessories (Usha / Crompton) for Record, stationary, strong room area	nos.	6.00		
24	Supplying, Assembling, installation testing and commissioning of Wall mounted fan complete with all accessories (Bajaj/Crompton make)	nos.	9.00		
25	Supplying and fixing on wall call bell buzzer (approved by Consultant) suitable for 230 volt single phase A.C.supply including interconnection, etc. as required .	nos.	1.00		
26	<u>SUPPLYING AND LAYING OF P.V.C. CONDUIT FOR TELEPHONE AND DATA CABLES</u> Supplying and laying of heavy duty rigid PVC conduit (ISI marked) complete with junction box, circular box, elbows, bends, couplers and other accessories as required by chase cutting on <u>floor/ wall/ through partition or over false ceiling</u> . The work includes making good all damages to original finish, painting etc. as required including fixing of pull out boxes/junction boxes etc as directed.				
a	20 mm dia rigid PVC pipes of ISI mark	MTR	100.00		
b	25 mm dia rigid PVC pipes of ISI mark	MTR	200.00		
c	25 mm dia PVC Casing and capping	MTR	40.00		
27	Supply and fixing of 25 pair telephone junction box "Krone" make on wall /furniture/partition with hinged cover and screwed type tag strips complete with chase cutting, mending good, painting etc. as required.	nos	1.00		
28	Supply & fixing on wall/furniture/partition recessed type telephone modular socket outlet (RJ 11) with mounting box & front plate as shown in drawing complete with chase cuttingm, mending good etc as required	nos.	9.00		
29	<u>TELEPHONE WIRING</u> a Supplying and laying of 2 -pair 0.61 mm dia. PVC insulated telephone cables through pre-laid rigid PVC conduit as shown in the drawing or otherwise as directed by the consultant from Telephone Junction Box to Telephone socket outlet including interconnection mending good etc. as required to be completed in all respect.	MTR	200.00		

SL.NO	DESCRIPTION	UNIT	QTY	RATE	AMOUNT
b	Supplying & laying of 10 pair 0.61 mm dia Armoured Teleohone cable in underground or on wall surface as per site requirement .	MTR	75.00		
30	Supply & laying of computer (LAN) socket wiring with four pair CAT -6 unsheilded twisted pair(UTP) cable of D LINK through pre laid PVC conduit /PVC Casing capping etc complete	MTR	700.00		
31	Supply & fixing of LAN information outlet UTP CAT 6E shuttered flush mounted with face plate and GI/PVC mouning box including termination with dual plate/connection	nos.	14.00		
32	Supply of CAT 6 Patch/mounting card				
a	2 meter long	nos.	14.00		
b	1 meter long	nos.	14.00		
33	supply & fixing of LAN patch panel CAT -6, 24 PORT jack panel and terminating CAT -6 LAN cables from information outlets	nos.	1.00		
34	6 U Rack	nos.	1.00		

GRAND TOTAL

E-LOBBY AREA ELECTRICAL WORKS - PART B					
Sl. No.	PARTICULARS OF ITEM	UNIT	QTY	RATE	AMOUNT
I	ELECTRICAL WORKS.				
1	Supply and fixing of light points with 3 Nos. of 1.00 sq.mm pvc insulated copper conductor wire including commissioning, testing etc.complete	Nos.	5.00		
2	Supply and fixing of Power points with MS box, sheet and 16 amp. Switch modular type and socket	Nos.	5.00		
3	Supplying and fixing UPS OUTPUT TERMINAL BOX WITH 1 No.of 16 amp pin socket modular type and 2 nos. 6 amp 5 pin socket.	Nos.	5.00		
4	Supply and fixing of 2 Nos. 2.50 Sqmm and 1 No. of 1.50 sq.mmpvc insulated copper conductor wires	Rmt	85.00		
5	S/F of 10 watt LED DOWN LIGHTER (philips) make with suitable power driver	Nos	4.00		
6	SITC of 2/2 LED 36 Watt Lighting Fixture with Electronic inbuilt driver. Complete makes RLT Make:OLBER 40W-Best in class LED with high levels of efficiency or any eq! (Wipro/Philips /Bajaj)	Nos	1.00		
7	Supply and fixing of 32 amp metal clad socket	Nos	7.00		
8	Supply and fixing on wall interconnection factory fabricated MCB DB 4 way TPN with 63 amp TPN MCB as incomer	Nos	1.00		
8a	Same as above but 2 x4.00 sq.mm and 1 X 2.5 sqmm for AC Circuits	Rmt	50.00		
9	Supply and fixing 4 way PN DB with 1 nos. fo 40 amp DP MCB and 2 Nos. SP MCB for output for UPS and Light	Nos.	6.00		
10	Supply and fixing 4 Nos. of 10 sq.mm aluminium armoured cable	Rmt	50.00		

SI. No.	PARTICULARS OF ITEM	UNIT	QTY	RATE	AMOUNT
11	Supply & laying of computer (LAN) socket wiring with four pair CAT -6 unsheilded twisted pair(UTP) cable of D LINK through pre laid PVC conduit /PVC Casing capping etc complete	Rmt	50.00		
12	Supply & fixing of LAN information outlet UTP CAT 6E shuttered flush mounted with face plate and GI/PVC mouning box including termination with dual plate/connection	Nos.	5.00		
13	Supply of CAT 6 Patch/mounting card				
a	2 meter long	Nos.	5.00		
b	1 meter long	Nos.	5.00		
14	supply & fixing of LAN patch panel CAT -6, 24 PORT jack panel and terminating CAT -6 LAN cables from information outlets	Nos.	1.00		
15	Providing and fixing of 6 U Rack	Nos.	1.00		
TOTAL					

EXISTING ROLLING SHUTTER OUT SIDE TO BE REMOVED AND 6" THICK SOLID CONCRETE BLOCK WALL TO BE CONSTRUCTED

EXISTING ROLLING SHUTTER OUT SIDE TO BE ALTERED TO REDUCED SIZE AND PROPOSED MS SECURITY GRILL OF 12MM X 12MM WITH SPACING 4" C/C WITH PROPER MS BOX SECTION & INNER SIDE PARTLY GLAZED AND WOODEN PARTITION

CROSS ROAD

PROPOSED 6" SOLID CONCRETE BLOCK WALL

EXISTING ROLLING SHUTTER FOR E-LOBBY PORTION TO BE ALTERED & INSIDE PROPOSED MS SECURITY GRILL WITH 12mm THICK TOUGHENED GLASS PARTITION.

OUTSIDE EXISTING ROLLING SHUTTER INSIDE FULLY GLAZED WOODEN PARTITION

PROPOSED MAIN ENTRY FOR E LOBBY

PROPOSED MAIN ENTRY FOR BRANCH

PROPOSED COLLAPSIBLE GATE AFTER EXISTING OUTSIDE ROLLING SHUTTER AND INSIDE GLASS AND WOODEN DOOR (COLLAPSIBLE GATE FIXED TO MS BOX SECTION / PILLAR TO DETAIL)

OUTSIDE EXISTING ROLLING SHUTTER INSIDE MS GRILL AND INNER SIDE PARTLY GLAZED WOODEN PARTITION

EXISTING ROLLING SHUTTER OUTSIDE AND PROPOSED MS SECURITY GRILL & INNER SIDE WITH PARTLY GLAZED WOODEN PARTITION

EXISTING ROLLING SHUTTER TO BE REMOVED AND 6" THICK SOLID CONCRETE BLOCK WALL TO BE CONSTRUCTED

MAIN ROAD

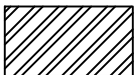
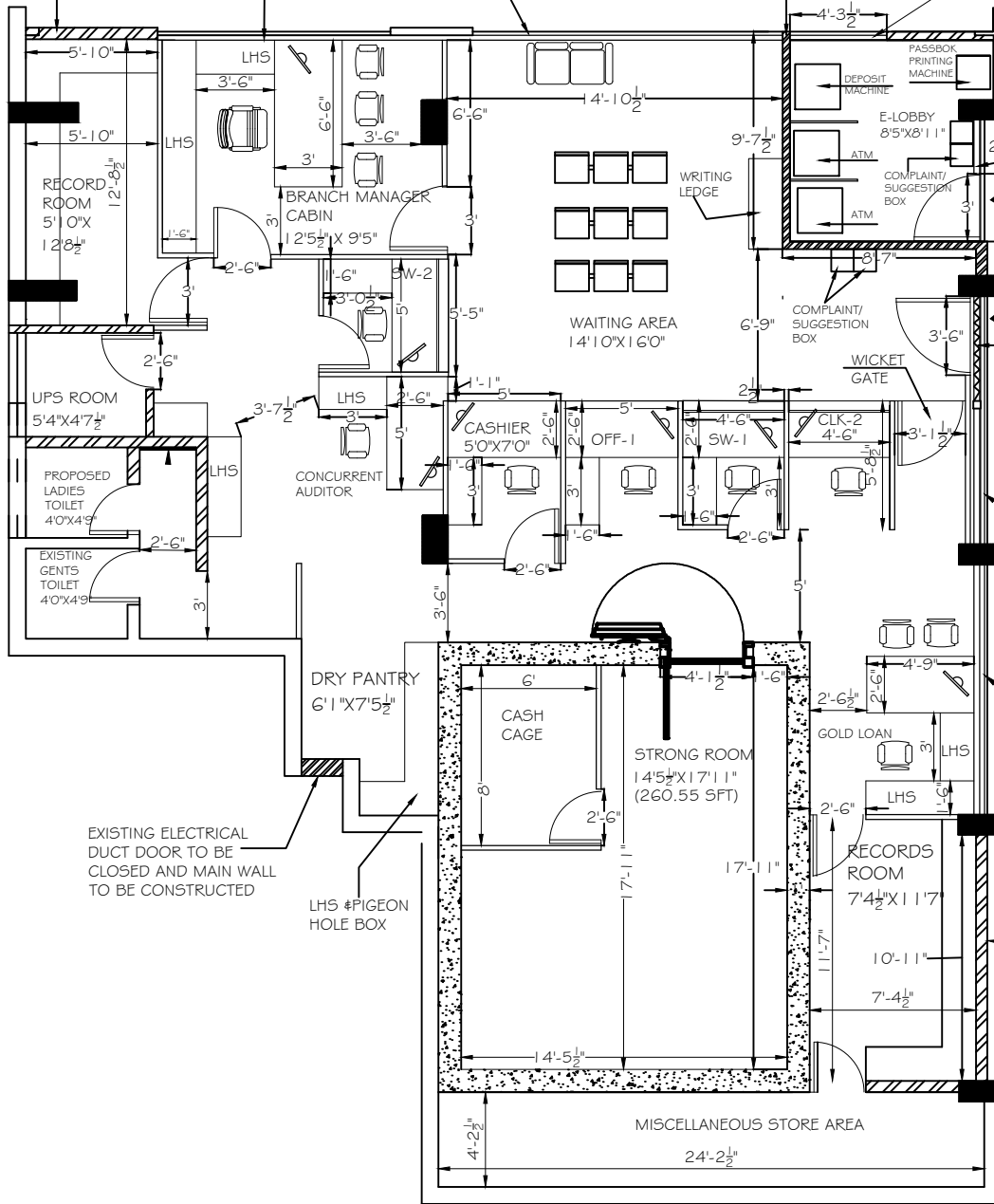

HATCHED PORTION INDICATES AS CONSTRUCTION OF NEW WALL

PROPOSED INTERIOR LAYOUT PLAN FOR M/S "UCO BANK" BRANCH AT BANNERAGHATTA ROAD, BANGALORE.

DATE : 05 - 10 - 2018

DRAWN: Prasanna

CHKD : M.K.N.PRASAD



DESIGN CELL

ARCHITECTS, INT DESIGNERS, ENGINEERS & REGD VALUERS, #24, 4th Main, 9th B Cross, Devarakere Extn., Next to ISRO Layout, Bangalore-560078.

Email id: dezzcel@gmail.com

Phone: 080-2666 6713

Mob: 98861-16685

GENERAL SPECIFICATIONS

LIST OF APPROVED MANUFACTURERS / NATURAL SOURCES OF MATERIALS TO BE USED IN THE INTERIOR WORKS SUBJECT TO THE APPROVAL OF SAMPLES BY THE CONSULTANT BASED ON THE BANKS APPROVED MAKES.

CARPENTRY / WOOD WORKS:

PLYWOOD	: Greenply / Hunsur / Century (BWR grade IS :303)
LAMINATES	: Formica / Greenlam / Century / Decolam (grade IS :2046-1995)
VENEERS	: Greenply / Euro / Durian /Hunsur
BINDING MATERIALS	: Fevicol / Araldite / jivanjhod
HARDWARE: LOCKS,	: Godrej / Earlbihari / Dorset
CHANNELS	: EarlBihari / Efficient Gardgets / Etalica
KEY BOARDS CHANNELS	: Earl Bihari
HANDLES, FITTINGS	: Kircheff / Dorset / Hatrdwin / Kich
KNOBS	: Kircheff /Doorset / Hatrdwin / Kich
LOCKS	: Godrej
GLASS	: Float / Saint Gobian / Modi Guard wave free float glass.
VERTICAL BLINDS	: Vista levlor / Mac / Marc.
LAPPAM	: Altek / Birla
PAINTS	: Asian / Berger / ICI / Jenson & Nicholson
DOOR CLOSERS / FLOOR	: Hardwin / Everite / Dorma / Efficient Gadgets.
SPRINGS	
GYPSUM BOARDS	: Indian Gypsum / Boral / Lafarge
GRID CEILINGS	: Armstrong / Nittobo / Insula (Minwool Rock FibresLtd)
PRELAMINATED SHEETS	: Novopan / Egwood
SANITARY FITTINGS	: Hindustan / Parryware / Hindware / Plumber ISI marked / Jaguar
WATER SUPPLY FITTINGS	: Tata / Oswal / Zenith
VITRIFIED TILES	: Naveen / Asian /Euro / Marbonite / Granolite /Jhonson / NITCO
CERAMIC TILES	: Asian, Naveen, Somani, Orient, Jhonson
	: Bic / NEKO / NEC

CI FITTINGS

GI VALVES : Zoloto / Rani

CEMENT : Ultra tecc / ACC / Orient / Ramco

WATER PROOFING MATERIAL : Dr. Fixit / FOSROC

SCREWS : GKW / Nettlefold

PRIMERS : ICI / Asian Paints / Wooderite

MELAMINE POLISH : ICI / Asian

CORNICES : Boral / India Gypsum.

MDF BOARD : NUWUD

PATCH FITTING : DORMA OR EQUIVALENT APPROVED QUALITY

NOTE :

The contractor shall use only above mentioned material or equivalent make to be approved by the Consultant. All other materials shall confirm to the specifications laid down. The tenderer shall take this into account while tendering rates / prices.

LIST OF APPROVED MAKES OF MATERIALS

All materials to be used for Electrical work is to be of following approved make, manufacturers other than listed below may also be considered at the discretion of the Architect / Employer.

<u>MATERIAL</u>	<u>MANUFACTURER/BRAND NAME</u>
Cables (ISI mark 1100 V Grade)	: CCI/ Finolex /Skytone
Wiring 1100V grade ISI FRLS Only	: Finolex / Polycab/Havells
M.S. Conduit ISI make	: BEC / AKG / NIC
Cabling, capping & accessories.	: Precision / Modi / Asian
Trunkings	: Precision / modi,
P.V.C conduits	: AKG / Setia
MCB ,D.B, ELCB	: MDS / Havells / Indo Asian
Switches, sockets, plates	: MDS / MK Modular / crab tree/North West
Electrical fixtures fluroscent LED light fixture etc.	: Philips / Crompton/ Wipro
Fan & Exhaust fans	: Crompton / G.E.C./ Bajaj
Brass Cable glands.	: Siemens / Havells.
Telephone wires	: Delton / Finolex.
MCCB's	: MDS, Havells.
Selector switch& indication Light.	: Kaycee / Siemens / L&T.
Distribution Boards	: Double Door - HAVELLS/ MDS