

UCO BANK
ZONAL OFFICE - BURDWAN

Vendors enlisted for composite work can apply

**PROPOSED INTERNAL FURNISHING & ELECTRICAL WORKS
(COMPOSITE)
FOR DURGAPUR MAIN BRANCH WITH E-LOBBY**

Date of submission of Tender : 16.12.2015 at 5.00 pm

Date of opening of Tender : 17.12.2015 at 01.00 pm

Name of the Tenderer :

Address :

Architectural Consultant :-

Sanjoy Paul and Associates.

House no- 40, 1st Avenue,
Sepco Township, Durgapur-713205

1965architectsanjoy@gmail.com

Mob: 9333921690

UCO BANK
ZONAL OFFICE - BURDWAN

**PROPOSED INTERNAL FURNISHING WORKS
FOR DURGAPUR MAIN BRANCH WITH E-LOBBY**

CONDITIONS OF TENDERING

- 1 Notice inviting tendering
- 2 Tender form
- 3 General Conditions Of Contract
- 4 Schedule of Quantities and Specifications

When the work is awarded and the letter of intent issued, these documents shall become an integral part.

- 1a Attested copies of upto date Contractor's Trade License, Income Tax, Value added tax, Professional tax clearance certificates, Service tax certificate will also have to be submitted along with the Tender.
- b. The **tender shall remain valid for three months** from the date of opening of the tender.
- c. The tender is to quote his rate in ink in both English figures and in English word.
- d. All corrections in the tender should be initiated by the tender before submission of the tender.
- e. Each page of the tender documents must be signed by the tenderer .All rates and prices quoted shall be in ink only.
- f. Canvassing in any form is strictly prohibited and any tenderer found to have resorted to canvassing should be liable to have his tender rejection summarily.
- g. In the event of the tender being submitted by a firm, it must be signed by a person holding a power of attorney authorizing him to do so, such power of attorney should be produced along with the tender.
- h. **Time** is the essence of this contract and preference is likely to be given to a tender who will be in a position to complete the works in all details within the shortest possible time. ***Maximum time permitted is 45 calendar days from the date of issuing Work Order. If the work is not completed within the stipulated period of time an amount of Rs 1000=00(Rupees one thousand only) to be deducted for each 2 days of delay subject to maximum of 10% of the amount of work order.***

Zonal Manager

UCO BANK
ZONAL OFFICE - BURDWAN

**PROPOSED INTERNAL FURNISHING WORKS
FOR DURGAPUR MAIN BRANCH WITH E-LOBBY**

TENDER NOTICE NO₂ :- UCO –ZO-BDN/ Tender / Int.Furnishing/ DGP MAIN BRANCH /11-15
Dated : 30-11-15

DETAILED NOTICE INVITING TENDERS

1. Sealed tenders in the prescribed form are invited by the **ZONAL MANAGER ZONAL OFFICE, BURDWAN**, from the **enlisted Furnishing Contractors of UCO Bank ,Burdwan Region** on item rate basis for **PROPOSED INTERNAL FURNISHING & ELECTRICAL WORKS OF DURGAPUR MAIN BRANCH AT GROUND FLOOR.**
2. Tender documents with all relevant papers (**prepared by M/s Sanjoy Paul and Associates**, address enclosed in the drawing, who are the **Consultant** of this Project) consisting of this Notice, Conditions of Tendering, Tender Form, General Conditions of Contract, Scheduled of Quantities and Specifications.
3. Tender Documents for the work can be purchased from the Zonal office on payment of **Rs. 500/- (Rupees Five hundred only)** per set on any weekday on or from 01-**12-2015 to 16-12-2015** between 11 a.m to 5 p.m. The amount is to be paid through Demand Draft.
4. Tenders should always be placed in sealed covers with the name of work written on the envelope shall be received upto **5.00 p.m** on **16-12-2015** at the office of **The Zonal Head, Zonal office, Burdwan** and will be opened **on 17-12-2015 at 01.00 p.m.** at the above office in presence of attending tenders or their authorized representative (not more than two at a time). Tender Documents will not be issued on the date fixed for the opening of the Tender and Tender documents will not be issued by post.
5. The Bank does not bind itself to accept the lowest tender and reserve the right to split up the order as and when necessary and accept or reject any or all Tenders without assigning any reason whatsoever.

Zonal Manager

TENDER FORM

TO

Tender Notice No. : -----

Date -----

***Name of work* : PROPOSED INTERNAL FURNISHING WORKS
FOR DURGAPUR MAIN BRANCH WITH E-LOBBY**

I/We the undersigned have examined the tender documents and the site of works as hereby submit this tender amounting the sum of **Rs.**

and should the same be accepted hereby undertake to execute complete and maintain all works as set forth in the schedule of quantities and Specifications in accordance with the conditions of Tendering, General Conditions of Contract, and the rates quoted by us in the aforesaid schedule of quantities all here to annexed or in default thereof to forfeit and pay to **UCO Bank** the sum of money mentioned in the aforesaid Documents.

I/We agree to abide by this Tender for the period of **three months** from the date fixed for opening of the same .

I/We undertake to complete and deliver the whole of the works covered under this tender within a period of **45 Calendar days** from the date of issue of work order.

I/We shall be bound by the terms and conditions of the tender documents and our accepted tender.

Dated

Witness

Signature of Tenderer

Name

Name

Address

Address.....

GENERAL CONDITIONS OF CONTRACT.

Unless otherwise provided for in the contract Documents, these general conditions shall apply to the work of all the specification attached herewith.

1. The contractor shall provide all the necessary supervision during the execution of the works as long thereafter as the architect may consider necessary (which approval may at any time be withdrawn) is to be constantly on the works and shall give his whole time to the supervision of the same. Such authorized agent or representative shall receive on behalf of the contractor directions and instructions from the Architect or Architect's representatives.
2. The contractor shall employ in and about the execution of the only such persons as are careful skilled and experienced in their trade and calling and the Architect's shall be at liberty to object to and require the contractor to remove from the site any person employed by the contractor in or about the execution of the work who in the opinion of the Architect misconduct's himself or is incompetent or negligent in the proper performance of his duties and such persons shall not be again employed upon the works without permission of the Architect.
3. The contractor shall inspect and examine the site and its surrounding and shall satisfy himself before the submission of his tender as to the nature of the site, the quantities of the nature of the work and materials necessary for the completion of the works and in general shall obtain all necessary information's like risks contingencies which may influence or effect his tender.
4. Rate quoted shall cover in all the items like transport, octroi, value added tax, incidental Charges, duties, ,any other statutory govt. taxes, etc. for completing the works. No claim will be entertained by the bank due to any fluctuation in the rate of labour, material, Freights, taxes, duties etc. at any stage.
The rate quoted will be firm during the entire period of work. Only service tax will be paid by bank as per govt. laws. Tenderer must have valid service tax registration no.and VAT registration no.
The contractor has to arrange photo passes in prescribed Proforma for the man working in the site. The contractor has to pay all legal dues to the workman engaged by him during the work as per law in force.
Contractor labour (Regulation & Allowance 1970, P.P.Act 1952, Bonus Act 1965, Est. Act 1972, West Bengal House Rent Allowance Act 1974, Gratuity Act 1972, and latest amended Acts are to be complied to the labourers for the execution of the work.
5. If the contractor fails to pay legal dues to labour or any workmen, bank will reserve the right to deduct such due, from the final bill of the contractor and arrange for disbursement to the concerned labour or workmen.
6. Work has to be carried out at the site without affecting the normal activities of the Bank . The contractor will be responsible for any damage caused during the period of work and has to pay damage.

7. **Payment upon the Architect's Certificates** be made by **UCO Bank** to the contractor after such certificate has been delivered to the Regional Manager.
8. If the contractor does not complete the work within the stipulated time, the contractor Rs 1000=00 for each 2 days of delay subject to maximum of 10% of the amount of work order.
9. Material and workmanship shall confirm to relevant ISI specification. Contractor has to follow the instruction of the Architect or this authorized representatives during the period of work.
10. The quantities given in the schedule are approximate and may vary as per requirement of the site. Payment shall be made on the basis of actual measurement of the work to be certified by Architect.. Measurement shall be made as per relevant IS code. **No discounts are allowed on the overall amount. Any discount to be given in the item wise rate only.**
11. MAXIMUM time to complete is **45** Calendar days from the date of issue of work order.
12. The contractor will get the bill amount after completion of work only.
No advance money will be given prior to the start of work. or dumping materials at site.
13. The contractor has to clear all the materials, tools, tackles, scaffoldings etc. after completion of work without any extra charge.
14. The Bank shall not be liable for or in respect of any damage compensation payable at law in respect or in consequence of any accident or injury to any workmen or other person in the employment of the contractor and the contractor shall indemnify and keep indemnified the bank against all such damages and compensation(save and except as aforesaid) and against all claims, demands, proceeding costs, charges and expenses in respect thereof or in relation thereto.
15. ***5-10% escalation in prices may be allowed.***

SIGNATURE OF TENDERER

**MATERIAL SPECIFICATIONS FOR INTERIOR WORKS FOR
UCO BANK**

1.A. HARD WOOD

All wood must be well seasoned,
Free from Knots, other defects,
Due to handling and transportation
Wherever necessary, provide with
Anti-terminate treatment.
Door & Door frames Lipping.

KAPOOR /
SAL / BADAM

1.B. PLY WOOD -----CENTURY / GREENPLY / MAYUR / SYLVAN

2. LAMINATE ----- SUNMICA / FORMICA / GREENLAM
(As per banks approved laminate colour)

3. ADHESIVE-----FEVICOL

4. GLASS -----MODI GUARD / SAINT GOBAIN

5. MORTICE LOCK, FITTING-----GODREJ

6. WOOD PRESERVATIVE -----TERMINATION TOR (Pidilite)
STP – PENTAPHENE PALE

7. PAINT :- ENAMEL / EMULSION -----BERGER , ASIAN PAINT / ICI

8. VITRIFIED TILES FOR FLOORING -----KAJARIA / ORIENT TILES / JOHNSON

9. FLOOR SPRING & DOOR CLOSER -----GODREJ / OZONE

10. FALSE CEILING -----INDIA GYPSUM , ARMSTRONG

11. VERTICAL BLINDS (VISTA LEVER)-----VISTA / MAC

ARCHITECT		UCO BANK DGP.
SANJOY PAUL & ASSOCIATES		MAIN BRANCH

SCHEDULE OF SPECIFICATIONS AND QUANTITIES FOR INTERNAL FURNISHING AND CIVIL WORKS OF **DURGAPUR MAIN** BRANCH -- UCO BANK

	PARTICULARS	QTY	UNIT	RATE	AMOUNT
1.	FALSE CEILING (Gypsum board and 2'x2' grid ceiling)				
	A.FALSE CEILING (GYPSUM BOARD) : Providing & Fixing gypsum board false ceiling system in 2 steps / In combination the grid ceiling Armstrong tiles ceiling vertical profile using 12.5mm gypsum plaster board on G.I.metal frame work. The frame work made up of perimeter channels of 20 x 27x 30x 3657mm fixed on wall & partitions and ceiling sections of 80 x 26 x 0.5x 3657mm as a cross member provided at 457mm c/c and the intermediate channel of 15x 45x.09 x 3657mm as a main runner at 1220mm c/c suspended by means of G.I.angle 25 x 25 x .05 mm from the existing ceiling by means of M.S. rawl plug with bolts/screws at 1200 mm c/c max. The joints of gypsum board to be taped 3 times and sealed with jointing compound. Finished with one coat of primer and min 3 coats colour or matching spectrum colour complete as per detail and specifications in drawing incl. all lights, diffuser cuttings complete. Rate to include the drops also.	850	sft		
	B. FALSE CEILING (GRID) : Providing & fixing Grid false ceiling (Armstrong) with 12mm thick mineral fibre acoustic tiles with crisp finely granulated surface in bright colour Prima regular Fine Fissured RH 99 with Arm strong TL 24mm exposed grid Tee section, exposed face shall be powder coated (white), main runner shall be Tee-shape section with single rotary stitching of size 24 x 38mm , 3.6m long with cross runner of tee shape section with single rotary stitching of size 24x30mm @1.2m with 24 x 25mm runner @ 0.60m c/c, with Armstornng suspenders, perimeter channel of size 22 x 22mm (white) all complete in all respect as per manufacturer's specifications.	310	sft		
2.	PARTITION				
	Providing and fixing partition in position as per design with 2"x 1 1/2" sal wood finished section frame work @2'-0" c/c both ways screwed to the floor and ceiling with M.S. Cleats and to be treated with anti termite oil. The measurement will be taken up to the false ceiling visible height in case of full height partition. The frame work will be cladded with 6mm thk. BWP and termiteproof plywood both side and to be finished with approved 1.0 mm laminate as per design with approved band adhesive, extra frame work to be fixed for fixing glass. in the glazed partition 12 mm thk. Modiguard/Saint Gobain clear float glass with Etching/ sand blusting/ granular blasting to be provided duly fixed with white beach/white ceader lipping 50 mm x 25 mm all complete duly				

	reddish brown/ rose wood colour polish with melamine finish. The work should be completed as per specification, design & approval of the Architect. For the door 32 mm solid core bwp Flush door with a frame work of white beach/ white ceader size 75 mm x 62.5 mm with necessary hold fast fixed to the wall/partition, finished with 1.0 mm laminate and lipping in all sides and 1.5" x 1.5" white beach/ white ceader wooden moulding to be provided along the periferi of the door frame. supplying and fixing door accessories as door closure, brass hinges, Cylindrical / Night latch locks and s.s handle. (Laminated skirting of 4" ht. as per approved colour to be placed all around the partition)				
2.A.	Partly glazed partition				
1	PARTLY GLAZED PARTITION UPTO 4'6" ht	150	sft		
2	Glazed Partition upto full ht .at the entrance (upto 3' ht. solid,from 3' ht to 7' ht. glass and from 7' ht to ceiling lvl. solid	160	sft		
3	PARTLY GLAZED PARTITION UPTO 9' ht with door for MANAGERS CABIN	230	sft		
4	Partly glazed partition upto 4'-6" ht for CASH CABINS	180	sft		
5	BLOCK PARTITION. Upto full height	350	sft		
6	BLOCK PARTITION . Upto 7' ht with wicket gate	210	sft		
7	12 mm th.. TOUGHEND GLASS at cash counter at front with 3" dia central gap for communication and 2.5" gap throughout at the bottom of the glass .	27	sft		
3.	Main Entrance Door				
	Providing and fixing glass door -1 way -3' x 7' for main entrance. .A white beach wood frame size-6" x 2" as top and bottom rail with a decorative handle of 600 mm of approved brand, floor spring , locks, etc all complete. 12 mm thk. etched glass and UCO Bank logo to be provided and edge should be machine beveled polished. the work to be completed as per design and specification of the architect all complete. the wooden portion to be duly melamine polished.	21	sft		
	TABLE				
4	Providing and fixing tables made out of 18 mmth. blockboard of approved make cladded with 1.0mm laminate (color with vertical grain) as per design in all visible areas. All the exposed edges to be covered with wooden lippings and mouldings to be reddish brown or rosewood colour polish with melamine finish. The drawers are to be made out of 18 mm thk. plywood duly 1.0 thk.				
	laminated in the front, sides to be made out of 18 mm blockboard and bottom to be made out of 6 mm BWP and termiteproof plywood and it should play in drawer telescopic sliding channels. The inside of the drawer and the table to be duly polished. A legrest to be provided duly polished made out of 18mm thk.blockboard. A shutter to be made by 18mm th. blockboard cladded with 1.0mm laminate. The necessary locks handles to be provided in each drawers and shutters. The table should have key board tray and ups trolley. The necessary wire managers to be provided on the tables and provision for lights to be kept in the front of the table. CPU to be fixed with the table at the bottom and it should not be placed on the floor or on the trolley.				

	The work to be completed as per design and approval of the Architect. 12 mm th. clear glass on top of branch manager table				
a	Branch Manager (6' x 3') -- 1 no	18	sft		
b	Officers table --- (2'-3" x 4'-6") --- 2 nos.	21	sft		
5.	Cash / Open Counter				
a	Providing and fixing top, front & side of cash counter made out of 18 mm BWP and termite proof blockboard as per design cladded with 1.0 mm thk. Laminated on side and front & the edges to be finished with necessary white beach or white ceader lippings, mouldings, etc. Special 6" drawer to be made for the cash with dividers of 12 mm plywood. the front of the drawer made out of 18mm blockboard finished with 1.0 mm laminate, sides 12 mm th. plywood and bottom to be made of 6 mm plywood. the inside and sides of the drawer to be duly polished. The drawers and shutters to be provided with necessary drawer sliding channels, hinges, locks etc. A leg rest to be provided made out of 18 mm thk. blockboard duly polished. Inside of the unit to be polished in the matching tone. All visible areas to be covered with beach or ceader lippings, mouldings with reddish brown colour polish. Wire manager, CPU trolley, keyboard tray to be provided. 4" ht. laminated skirting to be provided in all visible ares and 12 mm thk. x 18" wide Plain Glass to be provided at counter top customer face horizontally at 3'-9" lvl. The work should be completed as per specification. Cash counter -- 9 rft Open counter -- 27 rft (spce. same as above). For cash cabins aluminium grill to be used at the two sides and back of cabin	9	rft		
b		27	rft		
6.	Side Units : Low ht. Cabinet				
	Providing and fixing Side Unit/Back Unit made out of 18 mm th. blockboard finished with 1.0mm laminate in all exposed areas. The drawers to be made out of 18 mm blockboard in the front cladded with 1.0 mm laminate, side to be made out of 12 mm plywood and bottom made out of 6mm plywood duly painted in matching tone and it should play on drawer sliding channels. The shutters to be made out of 18mm blockboard and should play on drawer sliding castors on powder coated channels. The necessary locks, handles, etc to be provided. 4" laminated skirting to be provided all along the visible areas. Inside of the unit to be enamel painted in matching tone. All the exposed edges of the boards/plywoods to be covered with wooden lippings/mouldings duly polished all complete. The work to be completed as per approval and specification of the Architect. (7' x 4 nos) x 3'ht + 3' - 3"x 2'-6"ht. -- low ht.	101	sft		
7.	Standing Writing Ledge				
	Providing and fixing writing ledge with 10" wide as per design made out 18mm blockboard with necessary groove patterns 1.0mm laminate (color, vertical grain) to be cladded. 12 mm thk. machine polished glass to be provided on top of the writing ledge. Small boxes to be made out of 18 mm th. blockboard to be made on top of the writing ledge finished with 1.0 mm laminate , inside enamel painted. The ledge finished with 1.0mm laminate, inside enamel painted. The work to be completed as per design and approval of the Architect. - 5' x 2 nos	10	rft		
8	Synthetic Door Mat				
	Providing and fixing synthetic door mat 6 mm thk. As per approval of the Architect.	6	sft		

9	Notice board				
	Providing and fixing soft board with necessary frame work with 12 mm bwr plywood on top jolly board to be fixed finished with fabric @ Rs. 100, with necessary moulding duly polished along the periferi.	36	sft		
10	Complain and Cheque drop box				
	Providing & fixing Sal wood frame, fixing of 12 mm plywood with 1 mm thk. laminate finish, openable shutter for outside area. 8"wide x 18" length x 15"ht x 2 nos	24	sft		
11	Painting on Walls				
	Providing and applying oil bound distemper paint finish to make the surface necessary smoothness by putty, scraping, leveling & preparing the surface. One coat of Primer of approved make to be applied finished with two or more coats of oil bound distemper paint. The work to be completed as per approval and direction of the Architect. Waterproofing compound of SIKAQUALCRETE to be used where the external wall needs to be waterproofed.	3850	sft		
12	Wall panelling-upto 4' ht				
	Providing and fixing partition for wall and column paneling as per design with 2" x 1.5" sal wood frame work fixed to the column and wall. The frame work will be clad with 6 mm thk. BWP and termite proof plywood and to be finished with approved 1.0 mm laminate as per design with approved band adhesive, extra frame work to be fixed for fixing glass. In the glazed partition 6 mm thk. Modiguard / Saint Gobain clear mirror glass to be provided duly fixed with White beach/White cedar lipping 50 mm x 25 mm all complete duly reddish brown colour polished with Melamine finish. The work should be completed as per specification, design & approval of the Architect. Wall ---Mirror portion - 40 sft	490	sft		
TOTAL FURNISHING					
CIVIL WORKS					
13	VITRIFIED TILES FLOORING WITH SKIRTING				
	Supplying, fitting and fixing 2' x 2' vitrified tiles of approved shade as per banks specification (Perlato shade) of Marbonite / Johnson /Kajaria brand with chipping the floor , fixing the tiles with adhesive as approved , filling the joints with white cement and necessary pigment to match the colour of the tiles , including labour and lifting the tiles	1500	sft		
		TOTAL			
14	BUY BACK (-)				
	Contractor has to take away all the existing partitions, counters and give back money to the bank	L.S	L.S	L.S	
NET TOTAL					

(Rupees

No discounts are allowed on the total amount

ARCHITECT		UCO BANK DGP. MAIN BRANCH			
SANJOY PAUL & ASSOCIATES					
SCHEDULE OF SPECIFICATIONS AND QUANTITIES FOR INTERNAL FURNISHING AND CIVIL WORKS OF DURGAPUR MAIN BRANCH ---E LOBBY -- UCO BANK					
	PARTICULARS	QTY	UNIT	RATE	AMOUNT
1 .	FALSE CEILING (Gypsum board and 2'x2' grid ceiling)				
	A.FALSE CEILING (GYPSUM BOARD) : Providing & Fixing gypsum board false ceiling system in 2 steps / In combination the grid ceiling Armstrong tiles ceiling vertical profile using 12.5mm gypsum plaster board on G.I.metal frame work. The frame work	330	sft		
	made up of perimeter channels of 20 x 27x 30x 3657mm fixed on wall & partitions and ceiling sections of 80 x 26 x 0.5x 3657mm as a cross member provided at 457mm c/c and the intermediate channel of 15x 45x.09 x 3657mm as a main runner at 1220mm c/c suspended by means of G.I.angle 25 x 25 x .05 mm from the existing ceiling by means of M.S. rawl plug with bolts/screws at 1200 mm c/c max. The joints of gypsum board to be taped 3 times and sealed with jointing compound. Finished with one coat of primer and min 3 coats colour or matching spectrum colour complete as per detail and specifications in drawing incl. all lights, diffuser cuttings complete. Rate to include the drops also.				
	B. FALSE CEILING (GRID) : Providing & fixing Grid false ceiling (Armstrong) with 12mm thick mineral fibre acoustic tiles with crisp finely granulated surface in bright colour Prima regular Fine Fissured RH 99 with Arm strong TL 24mm exposed grid Tee section, exposed face shall be powder coated (white), main runner shall be Tee-shape section with single rotary stitching of size 24 x 38mm , 3.6m long with cross runner of tee shape section with single rotary stitching of size 24x30mm @1.2m with 24 x 25mm runner @ 0.60m c/c, with Armstorng suspenders, perimeter channel of size 22 x 22mm (white) all complete in all respect as per manufacturer's specifications.	100	sft		
2 .	PARTITION				
	Providing and fixing partition in position as per design with 2"x 1 1/2" sal wood finished section frame work @2'-0" c/c both ways screwed to the floor and ceiling with M.S. Cleats and to be treated with anti termite oil. The measurement will be taken up to the false ceiling visible height in case of full height partition. The frame work will be clad with 6mm thk. BWP and termiteproof plywood both side and to be finished with approved 1.0 mm laminate as per design with approved band adhesive, extra frame work to be fixed for fixing glass. in the glazed partition 12 mm thk. Modiguard/Saint Gobain clear float glass with Etching/ sand blusting/ granular blasting to be provided duly fixed with white beach/white ceader lipping 50 mm x 25 mm all complete duly				

	reddish brown/ rose wood colour polish with melamine finish. The work should be completed as per specification, design & approval of the Architect. For the door 32 mm solid core bwp Flush door with a frame work of white beach/ white cedar size 75 mm x 62.5 mm with necessary hold fast fixed to the wall/partition, finished with 1.0 mm laminate and lipping in all sides and 1.5" x 1.5" white beach/ white cedar wooden moulding to be provided along the periferi of the door frame. supplying and fixing door accessories as door closure, brass hinges, Cylindrical / Night latch locks and s.s handle. (Laminated skirting of 4" ht. as per approved colour to be placed all around the partition)				
2.A.	Partly glazed partition				
1	PARTLY GLAZED PARTITION UPTO 4'6" ht	140	sft		
2	Glazed Partition upto full ht .at the entrance (upto 3' ht. solid,from 3' ht to 7' ht. glass and from 7' ht to ceiling lvl. solid	85	sft		
3.	Main Entrance Door				
	Providing and fixing glass door -2 way -5' x 7' for main entrance. .A white beach wood frame size-6" x 2" as top and bottom rail with a decorative handle of 600 mm of approved brand, floor springs on both side , locks, etc all complete. 12 mm thk. etched glass and UCO Bank logo to be provided and edge should be machine beveled polished. the work to be completed as per design and specification of the architect all complete. the wooden portion to be duly melamine polished.	35	sft		
4	Painting on Walls				
	Providing and applying oil bound distemper paint finish to make the surface necessary smoothness by putty, scraping, leveling & preparing the surface.One coat of Primer of approved make to be applied finished with two or more coats of oil bound distemper paint. The work to be completed as per approval and direction of the Architect. Waterproofing compound of SIKAQUALCRETE to be used where the external wall needs to be waterproofed.	1000	sft		
5	Wall panelling-upto 4' ht				
	Providing and fixing partition for wall and column paneling as per design with 2" x 1.5" sal wood frame work fixed to the column and wall. The frame work will be cladded with 6 mm thk. BWP and termite proof plywood and to be finished with approved 1.0 mm laminate as par design with approved band adhesive, extra frame work to be fixed for fixing glass. In the glazed partition 6 mm thk. Modiguard / Saint Gobain clear mirror glass to be provided duly fixed with White beach/White cedar lipping 50 mm x 25 mm all complete duly reddish brown colour polished with Melamine finish. The work should be completed as per specification, design & approval of the Architect.	250	sft		
	TOTAL FURNISHING				
	CIVIL WORKS				
6	VITRIFIED TILES FLOORING WITH SKIRTING				
	Supplying, fitting and fixing 2' x 2' vitrified tiles of approved shade	500	sft		
	TOTAL				
(Rupees					

No discounts are allowed on the total amount

LIST OF MATERIAL OF APPROVED BRAND/MANUFACTURER FOR ELECTRICAL WORKS FOR UNION BANK BRANCHES	
---	--

SWITCH FUSE	HPL / HAVELLS
CHANGE OVER SWITCH	HPL / HAVELLS
MCCB / MCB / MCI	LEGRAND (LEXIC) / HPL (MOELLER)
RCCB / RCBO	LEGRAND (LEXIC) / HPL (MOELLER)
MCB DB BOX	LEGRAND (LEXIC) / HPL (MOELLER)
CABLE	POLYCAB / FINOLEX
CABLE SOCKET	DOWELL'S / 3D
PVC PIPE & ACESSORIES (MEDIUM)	POLYCAB / HARSH
WIRE (FRLS)	RR / POLYCAB
MODULAR ACESSORIES	CRABTREE (AHTENA) / LEGRAND (MOSAIC)
MINI STARTER	GETRON / ELECTRON
FAN	CROMPTON / HAVELLS
LIGHT FITTING	PHILIPS / THORN
TELEPHONE WIRE	RR / POLYCAB
NETWORKING SWITCH	IBALL / DELINK
JACK PANEL	IBALL / DELINK
RACK	VALRACK / EPI
CABLE MANAGER	IBALL / DELINK
LAN CABLE	IBALL / DELINK
INFO. OUTLET	IBALL / DELINK
PATCH CORD	IBALL / DELINK

Note: First make should be used. If first make not available then second make may be used with prior approval of Architect/Consultant

PROPOSED INTERNAL LAYOUT PLAN AT
DURGAPUR MAIN BRANCH OF UCO BANK

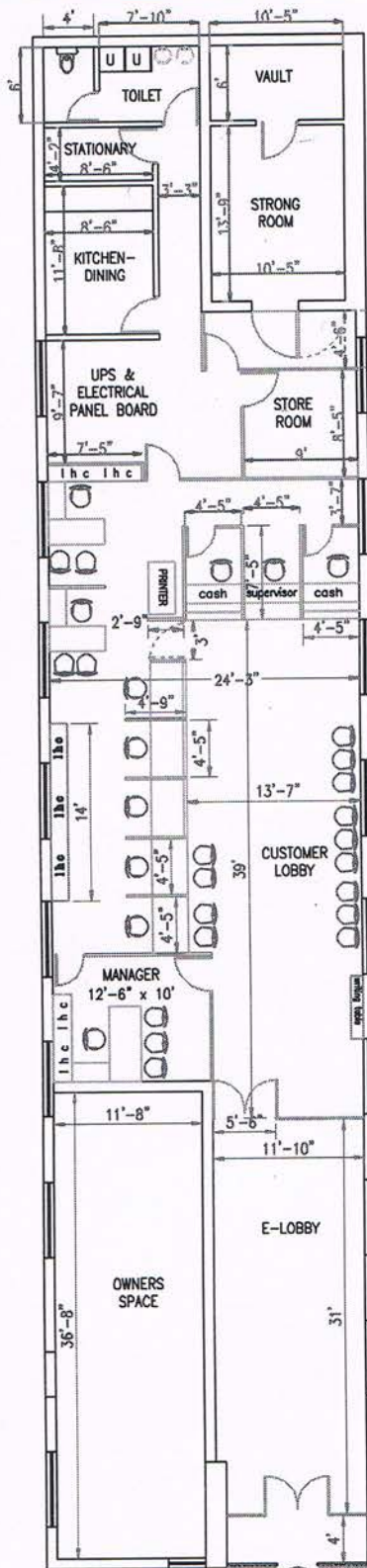

ROAD ENTRY
SCHEME -- 1A revised (20.06.2015)
GROUND FLOOR PLAN

BRANCH AC AREA ---1185 sft
E-LOBBY AC AREA ---361.75 sft

ARCHITECT
SANJOY PAUL AND ASSOCIATES
HOUSE-NO-40, 1st AVENUE, SEPCO TOWNSHIP,
DURGAPUR-713205 Mob: 9333921690

Approved
[Signature]